

WHAT'S IN THE BOX

- 1x Quad Lock® Motorcycle Wireless Charging Head
- 1x 50cm and 1.5m USB-A to USB-C cable
- 1x SAE to USB-A Powerbox with Surge Protection
- 1x 20cm SAE to battery terminal cable
- 1x M5 35mm screw
- 5x Zip ties
- 1x Allen key

INSTALLATION

REMOVE EXISTING MOUNTING HEAD

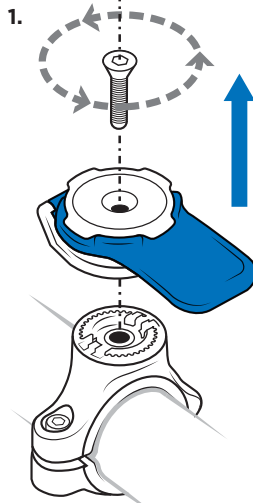

NOTE.
Motorcycle Handlebar Mount shown as example. Mount not included

ATTACH WIRELESS CHARGING HEAD

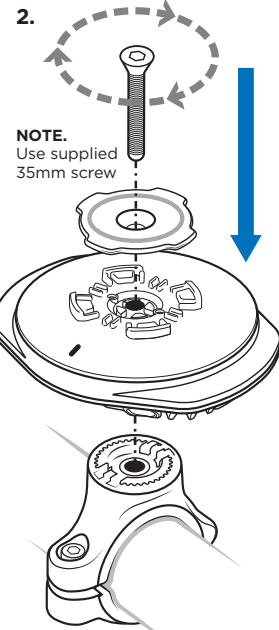

NOTE.
Use supplied 35mm screw

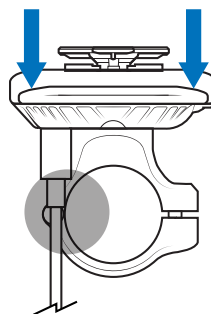

CABLE CLEARANCE
When installing your Wireless Charging Head ensure the cable doesn't interfere with any aspects of the motorcycle

WIRING OPTION 1 - FACTORY USB-A PORT

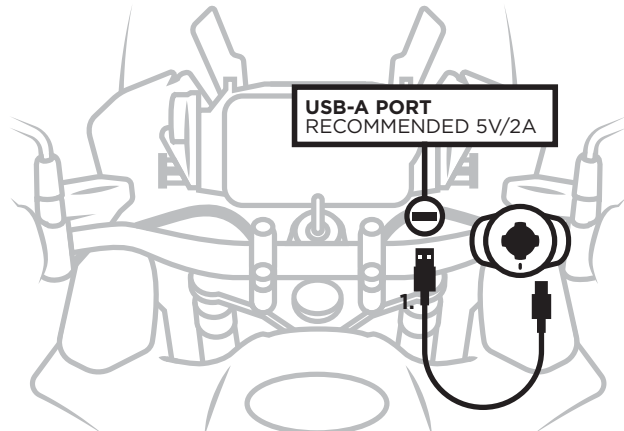

NOTE.
The location of your USB-A port may differ from shown

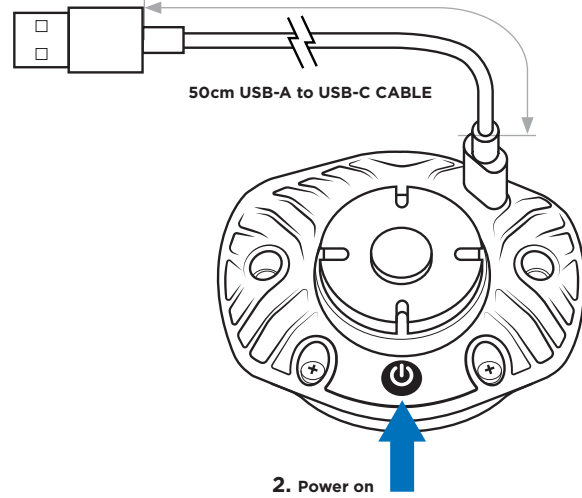

WIRING OPTION 2 - CONNECT WITH RING TERMINALS

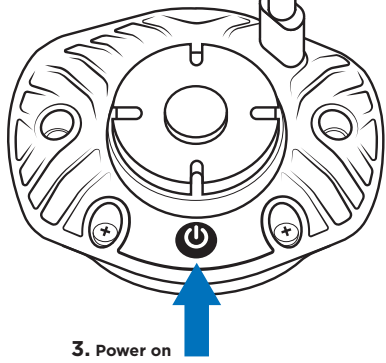
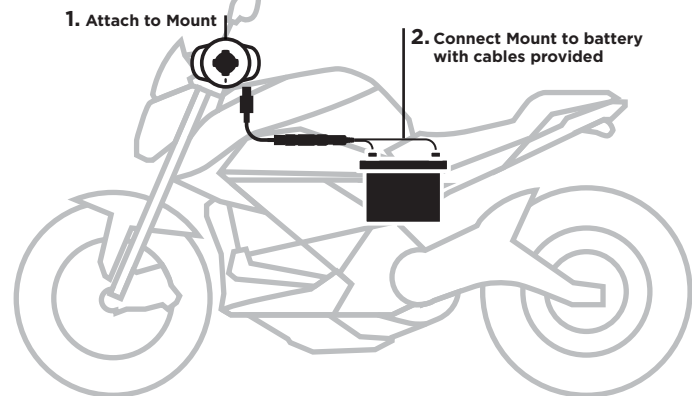
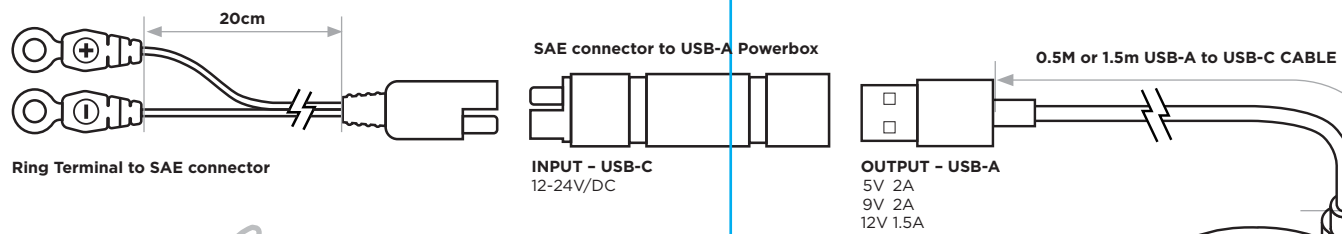

ATTACHING YOUR PHONE

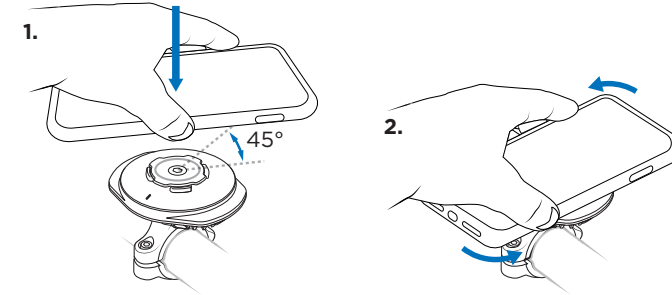

DETACHING YOUR PHONE

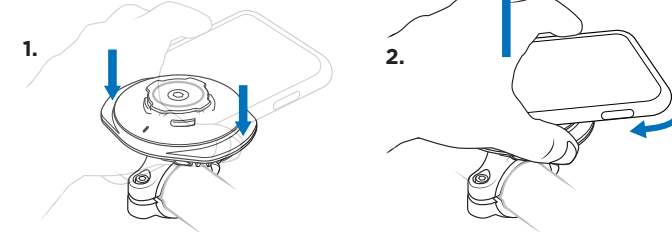

LED STATES

	POWER ON
	ERROR MODE
	CHARGING
	LOW INPUT POWER MODE <5W (5V/1A)
	FULL CHARGE
	WIRELESS CHARGER OVER HEATING

The phone may reach 100% charge but in some instances it may take a long time for the cyan light to show.



MOTORCYCLE WIRELESS CHARGING HEAD

KEEP IN TOUCH

- QUADLOCKCASE
- @QUADLOCKCASE
- @QUADLOCKCASE

QUADLOCKCASE.COM

NOTE. We highly recommend installation be carried out by a qualified mechanic or technician

