



Let's get started. →

What's in the box.



What you'll need.



The Rachio 3 Sprinkler Controller is designed for indoor installation. If outdoor installation is required, you'll need our weather-resistant enclosure. Learn more at rachio.com/outdoors.

Need some help?



Not sure what to do with your old controller? We'll recycle it for free! Visit rachio.com/recycle.

STEP 1

Out with the old!

Test your old system to ensure everything works properly. Photograph or note the wiring inside your existing controller to reference during installation. Remove your old controller from the wall.



STEP 2

Mark screw locations.

Use the Mounting Template at the end of this guide to mark where you want to install your Rachio 3.

For Drywall Installation:

Drill holes at marked locations for the anchors. Use a 3/16 inch bit to drill through the drywall, then use a hammer to gently tap each anchor into place.

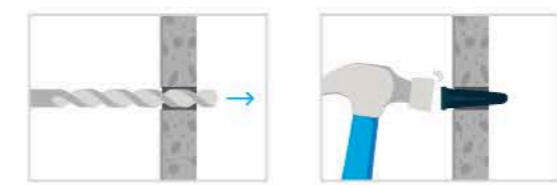

STEP 3

Mount your new controller.

Remove the Rachio 3's magnetic faceplate. Screw the controller onto the wall using the provided screws.

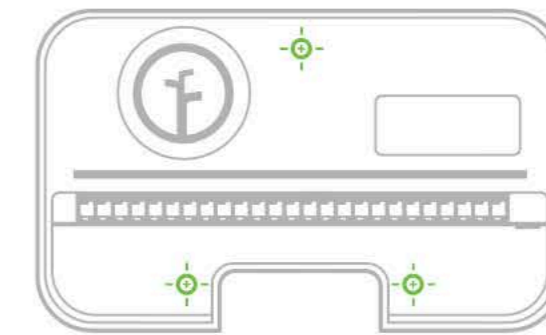

Mounting Template

Ensure the lower holes are level, and use a pencil to mark the center of each hole.

Make sure your wires have enough slack to reach the drill icon above!

STEP 4

Connect your wires.

While referencing the photo of your previous wiring, re-insert the wires into the appropriate terminals. Things not matching up? Visit rachio.com/wiring for tips on advanced wiring.

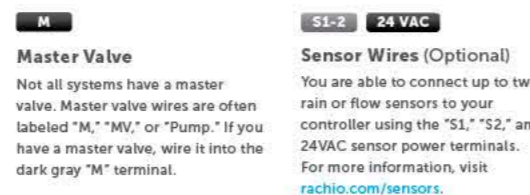
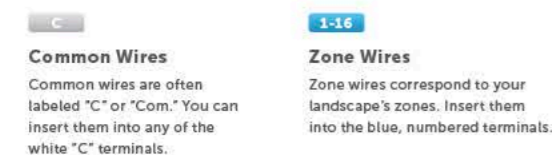

Insert the power connector upward into the power jack located at the bottom right of the wiring bay. Then, plug the power adapter into the outlet.

Tear here to detach the mounting template.

STEP 5

Create an account.

Find the Rachio app in the Apple App Store, on Google Play or by visiting rachio.com/download. Once the app is installed, create your account.



STEP 6

Connect to Wi-Fi.

Open the Rachio app and select "Add Controller." The app will guide you through this process.



STEP 7

Complete setup on the app.

Now that the controller is online, use the app to customize your zones and create a schedule.



Congrats, you did it!

Want to learn more about what you can do with your new Rachio 3?



Visit rachio.com/more.

Manual Controls

Zones can be run directly from the controller, if needed. Use the forward and back buttons to select a zone on the light bar, then select play.

