

ET300F Dual Wireless Charging Pad

User Manual
CE FC RoHS

User Manual

Thanks for choosing us!
This is a smart phone wireless charger that allows you enjoy the fun of digital products easily.
Please kindly read the user manual before using and keep it for future reference.

Specification

TYPE-C Input: 9V/3A
Wireless Output (Standard Model): 5V/1.0A (5W max)
Wireless Output (Fast Model): 9V/1.1A (10W max)
4 Coils (2 Coils X 2PCS)
Charging 2 devices at the same time
Charging Distance: ≤ 8 mm
Frequency: 120-205KHz
Standard: Qi
Size: 186*97*11mm

Product Outline

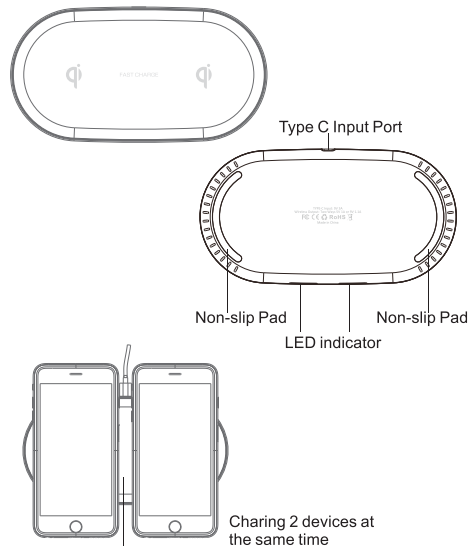

Connect to Power Adapter

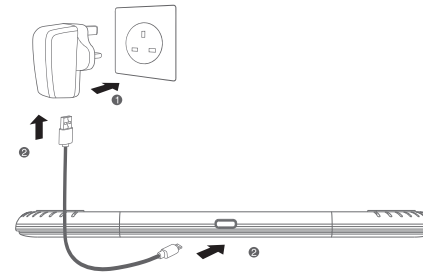

- ① Connect the power adapter to socket.
- ② Connect adapter to the USB2.0 interface, the other micro USB to the wireless charger.

Indicator information:

1. Red LED Indicator for standby state
2. Blue LED Indicator for charging state
3. Two led lights indicate the charging state of the two phones respectively

Only 9V/3A and Qualcomm QC2.0/3.0 adapter support the fast charging model. Adapter must be purchase separately.

Notes:

1. Do not squeeze or collid.
2. Do not disassemble or throw into fire or water, to avoid causing a short circuit leakage.
3. Do not use wireless charger in severely hot, humid or corrosive environments, to avoid circuit damage and occur leakage phenomenon.
4. Do not place too close with magnetic stripe or chip card (ID card, bank card, etc.) to avoid magnetic failure.
5. Please keep the distance at least 20cm between implantable medical devices (pacemakers, implantable cochlear, etc.) and the wireless charger, to avoid potential interference with the medical device.
6. To take care of the children, to ensure that they won't play the wireless charger as a toy, to avoid unnecessary accidents.
7. Please keep the charger away from water or other

This device complies with Part 15 of the FCC Rules. Operation is subject to the following two conditions:
(1) this device may not cause harmful interference, and
(2) this device must accept any interference received, including interference that may cause undesired operation.

NOTICE:

Changes or modifications not expressly approved by the party responsible for compliance could void the user's authority to operate the equipment.

The involved images are sketch maps, end-products subject to the object entity.
Includes: wireless charger, charging cable, user's manual.
*AC adapter is excluded, please buy separately or use the mobile phone original adapter if need.