

Wireless Charger



User Manual

Thanks for choosing us!
ET200 is a smart phone wireless charger which allows you enjoy the fun of charging wirelessly.
Please kindly read this user manual before using and keep it for further reference.

Specification

Input: TYPE-C Input: 5V/2A, QC2.0/ QC3.0 or PD adaptor
Output: 5W
Charging Efficiency: $\leq 80\%$
Charging Distance: 3-8mm
Frequency: 110-205 KHZ
Standard: WPC/Qi 1.2.4
Size: Φ *H=99*6.2mm

Product Outline

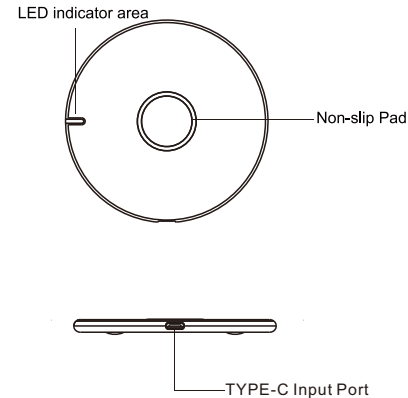

Connect to Power Adapter

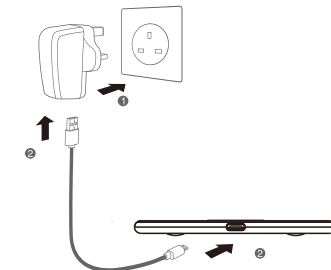

- ① Connect the power adaptor to power socket
- ② Plug in the power adaptor to USB2.0 interface, the other Type-C to the wireless charger
- ③ Put your cellphone on the wireless charger, the blue LED on, wireless charging works

Indicator:

Standby	Red LED on
Wireless Charging	Blue LED on
Full Charge	Red LED flash
Protection	Blue LED flash

What you get

- 1* wireless charging pad
- 1* 1m Type-C charging cable
- 1* user manual
- 1*AC adaptor is not included

Notes:

This device complies with part 15 of the FCC Rules. Operation is subject to the following two conditions:
(1) This device may not cause harmful interference, and
(2) this device must accept any interference received, including interference that may cause undesired operation. This equipment has been tested and found to comply with the limits for a Class B digital device, pursuant to part 15 of the FCC Rules. These limits are designed to provide reasonable protection against harmful interference in a residential installation. This equipment generates, uses and can radiate radio frequency energy and, if not installed and used in accordance with the instructions, may cause harmful interference to radio communications. However, there is no guarantee that interference will not occur in a particular installation. If this equipment does cause harmful interference to radio or television reception, which can be determined by turning the equipment off and on, the user is encouraged to try to correct the interference by one or more of the following measures:
—Reorient or relocate the receiving antenna.
—Increase the separation between the equipment and receiver.
—Connect the equipment into an outlet on a circuit different from that to which the receiver is connected.
—Consult the dealer or an experienced radio/TV technician for help. Caution: Any changes or modifications not expressly approved by the party responsible for compliance could void the user's authority to operate the equipment. This equipment complies with FCC radiation exposure limits set forth for an uncontrolled environment. This equipment shall be installed and operated with minimum distance 20cm between the radiator & body.