

GLUCONEXT™ UNIVERSAL GLUCOSE METER TRANSMITTER













ABOUT

The GLUCONEXT™ is a wireless data transmitting device, which can be connected with most of the Blood Glucose Meters with audio jacks (2.5 mm / 3.5 mm). The blood glucose records, which include testing date, time, and blood glucose level, can be transmitted through a Bluetooth connection to the DIABNEXT® APP on your smartphone/tablet for you to easily access and review in your digital logbook.

PRECAUTION

- ▲ **BEFORE USING GLUCONEXT™, CAREFULLY READ ALL INSTRUCTIONS AND THE “TERMS OF USE” ON THE MOBILE APP.**
- ▲ Check the device for any physical damage each time before use.
- ▲ The device must be paired with a mobile device with Bluetooth 4.0.
- ▲ Install the DIABNEXT® APP on your mobile device.
- ▲ If you have any questions about the GLUCONEXT™ or its operation, please contact customer service for more information.

COMPATIBLE MODELS



Breeze® 2 Contour® Contour® plus Contour® next EZ Contour® XT ONETOUCH® UltraEasy® ONETOUCH® UltraMini® ONETOUCH® Ultra® 2 FreeStyle Freedom Lite® FreeStyle Lite® TRUEbalance™ TRUEtrack®

Breeze® and Contour® are registered trademarks of Ascensia Diabetes Care Holdings AG. ONETOUCH®, UltraEasy®, UltraMini®, and Ultra® are registered trademarks of Johnson & Johnson Services, Inc. FreeStyle Freedom Lite® and FreeStyle Lite® are registered trademarks of Abbott Laboratories. TRUEbalance™ and TRUEtrack® are registered trademarks of Trividia Health, Inc.

AND MANY OTHER MODELS...

Scan the following QRcode for the list of all compatible blood glucose meters.



CAUTION

- Transfer your records regularly from your BGM to the DIABNEXT® APP by pairing and synchronizing your connected BGM and your phone.
- During data transmission, **DO NOT** test your blood glucose level, press the GLUCONEXT™ button, or detach the GLUCONEXT™ from the BGM.
- DO NOT** place the GLUCONEXT™ more than 10 meters away from your smartphone/tablet during data transmission.
- DO NOT** disassemble the GLUCONEXT™ by yourself. If you have any questions, please see the “Troubleshooting” section or contact customer service.
- Detach the GLUCONEXT™ and the cable from your BGM after your data have been transmitted.
- Each GLUCONEXT™ should only be used on one BGM as sharing the GLUCONEXT™ will lead to unidentifiable data.
- The date and time of your glucose data is taken from your glucometer. Please adjust the time on your glucometer before testing your glucose levels. The GLUCONEXT™ and DIABNEXT® APP can not adjust time if your BGM time is not correctly set.

CLEANING INSTRUCTIONS

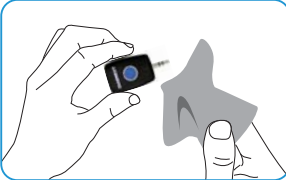



Use a dry cloth to wipe the outer surface of GLUCONEXT™.

- ▲ **Do NOT** immerse GLUCONEXT™ in any fluids.
- ▲ **Do NOT** spray any fluids at or into GLUCONEXT™.
- ▲ **Do NOT** use GLUCONEXT™ with any acid or alkaline solutions.
- ▲ Cleaning, disinfecting, or testing liquid may damage GLUCONEXT™.

WARNING

- DO NOT** use if any part of your GLUCONEXT™ appears damaged.
- DO NOT** operate or store GLUCONEXT™ under improper environmental conditions.
* refer to the “GLUCONEXT™ Description” and “Storage & Transportation” sections
- Keep out of reach of children, as small parts may be swallowed and pose a choking hazard.

GLUCONEXT™ DESCRIPTION



Blue button (Validation & Transmission)

LED (Red/Green)

Battery cover

Blood Glucose Meter connector

Model No: GA1

Wireless connection	Bluetooth Smart
APP operating system	iOS / Android
Connection method	Audio jack port (2.5mm/3.5mm)
Transmission range	10 meters
Battery type	Lithium coin cell battery (CR2032)
Battery life	Over 1000 transfers
Shelf life	2 years
Device size	L 53mm x W 27mm x H 14mm
Device weight	10 grams
Operating temperature	5°C ~ 40°C (41°F ~ 104°F)
Relative humidity	10% ~ 90% R.H.
Frequency range	2.4GHz ~ 2.48GHz
RF output power	0 dBm

DEVICE LED SIGNAL DESCRIPTION

Green light	Slow Blinkings (5 seconds)	Waiting for Bluetooth connection
	Quick Blinkings (1 second)	Connected to mobile phone or tablet
Red light	5 Blinkings (0.25 second)	Battery Level Low

After you see the low battery LED indication for the first time, the device will allow you to perform over 100 times of transmissions. Replace the battery CR2032 as soon as possible to avoid any loss of data storage.

STORAGE & TRANSPORTATION

- ▲ Store this device in -20°C ~ 70°C (-4°F ~ 158°F)
- ▲ Relative Humidity: 10% ~ 90% R.H.
- ▲ Avoid storing the device under direct sunlight.
- ▲ Keep out of reach of children.

DISPOSAL

- This product contains a button battery CR2032.
- Recycle or dispose of the device and the battery separately, in accordance with applicable federal, state, and local regulations.

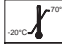

Temperature Limit: -20°C ~70°C (-4°F ~158°F)



Keep Away From Sunlight



Manufacturer



Authorized Representative in the European Community

HOW TO TRANSMIT YOUR DATA FROM BGM

1. BEFORE FIRST USE

- A** Install the DIABNEXT® APP on your mobile device.



- B** Turn on the Bluetooth function of your mobile device and open the DIABNEXT® APP.
- C** Click “More” and select “Get Started”.
- D** Select the brand name and the corresponding BGM model of your device.
- E** Follow the instructions on the APP.
- Click the blue button of the GLUCONEXT™ to pair with the APP.

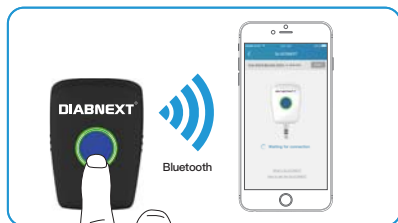

- It will take a few seconds to connect.

2. SETUP

- A** Connect the GLUCONEXT™ with your BGM by plugging it into the audio jack port when the GLUCONEXT™ and your BGM are off.
- For **Ascencia** BGM models, the BGM should be **TURNED ON BEFORE** connecting with GLUCONEXT™.

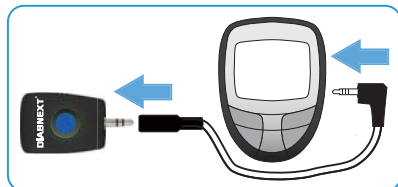

- Ensure the GLUCONEXT™ is completely plugged into the cable, and the cable is completely plugged into the BGM.
 - Before powering on the GLUCONEXT™, plug it into the BGM.
 - PLUG-IN FIRST
 - POWER ON SECOND
- B** BGM will show “PC” or transmission display.

3. VALIDATE & TRANSMIT

- A** Click the GLUCONEXT™ blue button to activate the transmission.

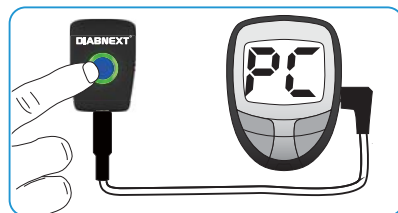

- During the connecting period, the LED will flash with green light slowly (5 seconds).
- B** Enable the Bluetooth function on your mobile device.
- C** Open the DIABNEXT® APP.
- D** Click the blue button of the GLUCONEXT™ for data transmission.
- The green light will be quick blinking (1 second) to signal that the GLUCONEXT™ is connected to DIABNEXT® APP.

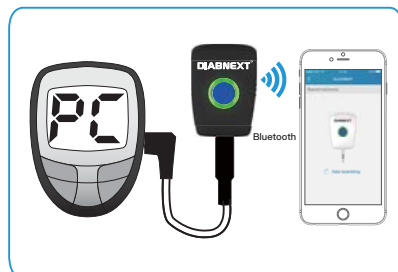

- E** Your glucose data will be transferred automatically, and can be reviewed on your mobile device in your digital logbook.

4. REMOVE

- A** After data transmission, detach the GLUCONEXT™ and the cable from your BGM.

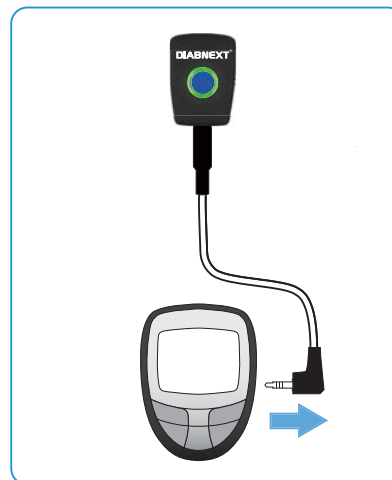

- The GLUCONEXT™ will automatically shut down and disconnect after 30 seconds of inactivity.

BATTERY

BATTERY REPLACEMENT

- A** Turn the GLUCONEXT™ to its back side and open the battery compartment.



- B** Replace the old battery with a new one.

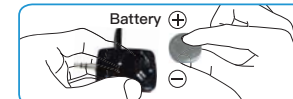

- C** Close the battery compartment.

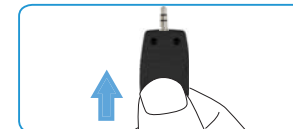

- Slide the battery cover to a **COMPLETE CLOSE** of the GLUCONEXT™.

- D** Click the button of GLUCONEXT™ to check the status.



FCC STATEMENT

This device complies with part 15 of the FCC Rules. Operation is subject to the following two conditions:

- This device may not cause harmful interference, and
- This device must accept any interference received, including interference that may cause undesired operation.

NOTE:

This equipment has been tested and found to comply with the limits for a Class B digital device, pursuant to part 15 of the FCC Rules.

These limits are designed to provide reasonable protection against harmful interference in a residential installation. This equipment generates, uses and can radiate radio frequency energy and, if not installed and used in accordance with the instructions, may cause harmful interference to radio communications. However, there is no guarantee that interference will not occur in a particular installation.

If this equipment does cause harmful interference to radio or television reception, which can be determined by turning the equipment off and on, the user is encouraged to try to correct the interference by one or more of the following measures:

- Reorient or relocate the receiving antenna.
 - Increase the separation between the equipment and receiver.
 - Connect the equipment into an outlet on a circuit different from that to which the receiver is connected.
 - Consult the dealer or an experienced radio/TV technician for help.
- Changes or modifications not expressly approved by the party responsible for compliance could void the user's authority to operate the equipment.

TROUBLESHOOTING

If there is no LED light feedback, please follow the steps below:

- Check if there is any physical damage to the GLUCONEXT™. If yes, stop using this device and replace it with a new one.
- If no, replace the battery and check LED light of GLUCONEXT™ again.
- If the problem persists, contact customer service.

If the GLUCONEXT™ cannot connect with the DIABNEXT® APP, please follow the steps below:

- Check if there is any physical damage to the GLUCONEXT™. If yes, stop using this device and replace it with a new one.
- If no, reboot the Bluetooth of your mobile device, then try to connect with GLUCONEXT™ again.
- If rebooting the Bluetooth function does not resolve the issue, reinstall the APP, then try to connect with GLUCONEXT™ again.
- If the problem persists, contact customer service.

If the GLUCONEXT™ is connected but is unable to upload the data to the DIABNEXT® APP, please follow the steps below:

- Check if there is any physical damage to the GLUCONEXT™. If yes, stop using this device and replace it with a new one.
- If no, reboot the Bluetooth of your mobile device, then try to connect with GLUCONEXT™ again.
- If rebooting the Bluetooth function does not resolve the issue, reinstall the APP, then try to connect with GLUCONEXT™ again.
- If the problem persists, contact customer service.

SIMPLIFIED EU DECLARATION OF CONFORMITY

Hereby, ShengHuo Technology Ltd. declares that the radio equipment type GLUCONEXT is in compliance with Directive 2014/53/EU.
The full text of the EU declaration of conformity is available at the following internet address:
<https://diabnext.com/gluconext>

SUPPORT INFORMATION



ShengHuo Technology Ltd.
11F, No. 31, Section 3, Zhongshan North Road, Zhongshan District, Taipei City 104, Taiwan
Tel: +886 2 25869597
Website: www.diabnext.com



Mdi Europa GmbH
Langenhagener Str. 71, D-30855 Langenhagen, Germany
Tel: +49-511-3908 9530 Web: www.mdi-europa.com
E-mail: michael.sander@mdi-europa.com