

# onn.

## Wireless Charging Stand

Model: WIABLK100030328

## USER MANUAL

March 31,2021\_V1

## Important Safety Instructions



Please refer to the electrical and safety information before installing or operating the product.

- Avoid dropping.
- Do not disassemble.
- Do not expose to liquids.
- For the safest and fastest charge, use original or certified cables.
- This product is suitable for moderate climates only.
- The maximum ambient temperature during use of this product must not exceed 40°C.
- Open flame sources, such as candles, must not be placed on this product.
- Only use a dry cloth or brush to clean this product.

### FCC Statement

This device complies with Part 15 of the FCC Rules. Operation is subject to the following two conditions: (1) This device may not cause harmful interference, and (2) this device must accept any interference received, including interference that may cause undesired operation.

Warning: Changes or modifications not expressly approved by the party responsible for compliance could void the user's authority to operate the equipment.

Note: This equipment has been tested and found to comply with the limits for a Class B digital device, pursuant to Part 15 of the FCC Rules. These limits are designed to provide reasonable protection against harmful interference in a residential installation.

This equipment generates, uses, and can radiate radio frequency energy and, if not installed and used in accordance with the instructions, may cause harmful interference to radio communications. However, there is no guarantee that interference will not occur in a particular installation. If this equipment does cause harmful interference to radio or television reception, which can be determined by turning the equipment off and on, the user is encouraged to try to correct the interference by one or more of the following measures: (1) Reorient or relocate the receiving antenna. (2) Increase the separation between the equipment and receiver. (3) Connect the equipment into an outlet on a circuit different from that to which the receiver is connected. (4) Consult the dealer or an experienced radio / TV technician for help.

### Radiation Exposure Statement

This equipment complies with FCC radiation exposure limits set forth for an uncontrolled environment. This equipment should be installed and operated with a minimum distance of 20cm between the radiator and your body.

Product Name: Wireless Charging Stand

Model: WIABLK100030328

The following importer is the responsible party (for FCC matters only).

Company Name: Walmart Inc.,

Address: Bentonville, AR72716

Telephone: 1-888-516-2630

## What's in the Box?

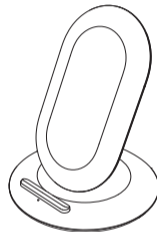

Wireless Charging Stand

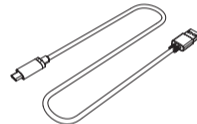

USB Charging Cable

## Using Your Charging Stand

Compatible with:

- iPhone 12 Pro Max, iPhone 12 Pro, iPhone 12, iPhone 12 Mini, iPhone 11 Pro Max, iPhone 11 Pro, iPhone XS Max, iPhone XR, iPhone XS, iPhone X, iPhone 8, iPhone 8 Plus;
- Samsung Galaxy S20/S10/S9+/S9/S8+/S8/S7 Edge/S7/S6 Edge+, Note20/Note10/Note9/Note8/Note5;
- Google Pixel 4, Google Pixel 4XL, Google Pixel 3, Google Pixel 3XL;
- Other Qi-enabled devices

1. Connect the Charging Stand to a USB wall charger (5V / 2A) with the Micro USB cable, then plug the USB wall charger into a power outlet.

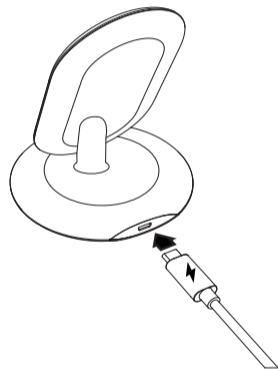

Need help?

We're here for you every day from 7 a.m. - 9 p.m. CST.

Give us a call at 1-888-516-2630

We'd love to hear from you. Scan with your Walmart app and let us know what you think.



2. Place your Qi-certified device onto the center of the Charging Stand.

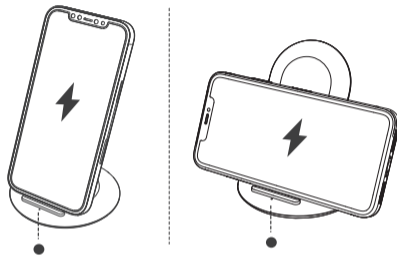

- Do not connect to a USB port on a computer as it may affect the wireless charging function.
- Using an ultra-thick protective phone case or a case with a magnetic/metal plate is not recommended as it may affect the wireless charging function.
- Do not place any foreign objects between your smartphone and the wireless charger's surface, including metal pads on a car mount, credit cards, keys, coins, metal objects, or NFC cards, as it may cause overheating.

| LED Indicator                            | Status                  |
|--|-------------------------|
| Solid blue for 3 seconds, then turns off | Connected to power      |
| Solid blue                               | Charging                |
| Flashing blue                            | Foreign object detected |

### Specifications

|               |                |
|---------------|----------------|
| Input         | 5V $\equiv$ 2A |
| Maximum power | 5W             |

