



USER MANUAL

Video Doorbell Chime



Anker Innovations Limited. All rights reserved. eufy and the eufy logo are trademarks of Anker Innovations Limited, registered in the United States and other countries. All other trademarks are the property of their respective owners.

51005002240 V01

Table of Contents

| | |
|--|-----------|
| What's in the Box | 02 |
| What's Required for Installation? | 02 |
| Installation | 03 |
| Replacing the Power Connector | 03 |
| Notice | 05 |
| Customer Service | 07 |

WHAT'S IN THE BOX

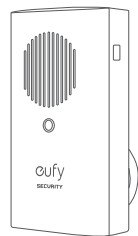

Doorbell Chime
Model: T8740



Power Connector
(Pin type may vary
in different regions)



Doorbell Chime USB
Dongle for HomeBase 2
Model: T8741

WHAT'S REQUIRED FOR INSTALLATION?

This Doorbell Chime is an accessory exclusive to the eufy Security Video Doorbell 2K (Battery-Powered).

The USB dongle enables eufy HomeBase 2 to connect to doorbell chimes. One USB dongle can control up to 4 doorbell chimes.

The USB dongle can only work with HomeBase 2 when a eufy video doorbell is connected to this HomeBase 2 and the doorbell is pressed.

INSTALLATION

Step 1. Fix the Power Connector to the Doorbell Chime.

- A. Place the Power Connector over the Chime in the direction the arrows indicate.
- B. Align the raised slots of the Power Connector with the notch on the base of the Doorbell Chime.
- C. Rotate clockwise to lock the Power Connector in place.

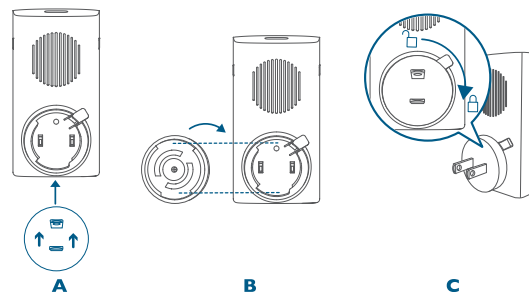

Step 2. Plug the Doorbell Chime into an AC power supply at your desired location.

Step 3. Plug the USB dongle into the USB port on the back of the HomeBase 2.

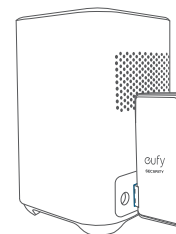

Step 4. In the eufySecurity App, go to Doorbell Settings - Indoor Chime. Follow the onscreen instruction to add the Chime to your existing Video Doorbell.

Step 5. You may select the ringtone and adjust the volume level by using the Music and Volume buttons located on the side of the Doorbell Chime.

There are 8 ringtones and 3 volume levels selectable. Each Chime can play a different ringtone according to your setting.



REPLACING THE POWER CONNECTOR

1. Press the Lock button and twist the Power Connector counterclockwise at the same time to remove it from the Doorbell Chime base.

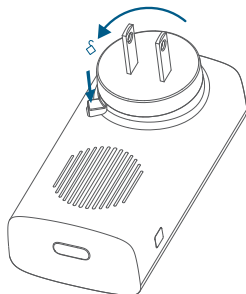

2. Install the new Power Connector onto the Doorbell Chime following the same procedure mentioned at the start of the guide.

03 English

NOTICE

CE This product complies with the radio interference requirements of the European Community.

Declaration of Conformity

Hereby, Anker Innovations Limited declares that this device is in compliance with the essential requirements and other relevant provisions of Directive 2014/53/EU. For the declaration of conformity, visit the Web site <https://www.eufylife.com/>.

Do not use the Device in the environment at too high or too low temperature, never expose the Device under strong sunshine or too wet environment.

The suitable temperature for the product and accessories is 0°C - 45°C.

RF exposure information: The Maximum Permissible Exposure (MPE) level has been calculated based on a distance of d=20 cm between the device and the human body. To maintain compliance with RF exposure requirement, use product that maintain a 20cm distance between the device and human body.

433MHz Frequency Range: 433.92MHz; 433MHz Max Output Power: 7.303dBm

The following importer is the responsible party (contact for EU matters only)

Importer: Anker Technology (UK) Ltd

Importer Address: Suite B, Fairgate House, 205 Kings Road, Tyseley, Birmingham, B11 2AA, United Kingdom



This product is designed and manufactured with high quality materials and components, which can be recycled and reused.



This symbol means the product must not be discarded as household waste, and should be delivered to an appropriate collection facility for recycling. Proper disposal and recycling helps protect natural resources, human health and the environment. For more information on disposal and recycling of this product, contact your local municipality, disposal service, or the shop where you bought this product.

FCC Statement

This device complies with Part 15 of the FCC Rules. Operation is subject to the following two conditions: (1) this device may not cause harmful interference, and (2) this device must accept any interference received, including interference that may cause undesired operation.

English **04**

Note: This equipment has been tested and found to comply with the limits for a Class B digital device, pursuant to Part 15 of the FCC Rules. These limits are designed to provide reasonable protection against harmful interference in a residential installation.

This equipment generates uses and can radiate radio frequency energy and, if not installed and used in accordance with the instructions, may cause harmful interference to radio communications. However, there is no guarantee that interference will not occur in a particular installation. If this equipment does cause harmful interference to radio or television reception, which can be determined by turning the equipment off and on, the user is encouraged to try to correct the interference by one or more of the following measures: (1) Reorient or relocate the receiving antenna. (2) Increase the separation between the equipment and receiver. (3) Connect the equipment into an outlet on a circuit different from that to which the receiver is connected. (4) Consult the dealer or an experienced radio/TV technician for help.

FCC Radio Frequency Exposure Statement

The device has been evaluated to meet general RF exposure requirements. The device can be used in fixed / mobile exposure condition. The min separation distance is 20cm.

The following importer is the responsible party

Company Name: POWER MOBILE LIFE, LLC

Address: 400 108th Ave NE Ste 400, Bellevue, WA 98004-5541

Telephone: 1-800-988-7973

This device complies with Industry Canada licence-exempt RSS standard subject to the following two conditions:

- (1) this device may not cause interference, and
- (2) this device must accept any interference, including interference that may cause undesired operation of the device."

Le présent appareil est conforme aux CNR d'Industrie Canada applicables aux appareils radio exempts de licence. L'exploitation est autorisée aux deux conditions suivantes:

- (1) l'appareil n' doit pas produire de brouillage, et
- (2) l'utilisateur de l'appareil doit accepter tout brouillage radioélectrique subi, même si le brouillage est susceptible d'en compromettre le fonctionnement."

Warning: Changes or modifications not expressly approved by the party responsible for compliance could void the user's authority to operate the equipment.

CUSTOMER SERVICE

• Warranty

12-month Limited Warranty

• Call Us

United States +1 (800) 988 7973 Mon-Fri 9AM-5PM (PT)

United Kingdom +44 (0) 1604 936 200 Mon-Fri 6AM-11AM (GMT)

Germany +49 (0) 69 9579 7960 Mon-Fri 6:00-11:00

• Email Us

Customer Support: support@eufylife.com



@EufyOfficial



@EufyOfficial



eufyofficial

Anker Innovations Limited

Room 1318-19, Hollywood Plaza, 610 Nathan Road, Mongkok, Kowloon, Hong Kong

