



Anker Innovations Limited. All rights reserved. **eufy** and the **eufy** Logo are trademarks of Anker Innovations Limited, registered in the United States and other countries. All other trademarks are the property of their respective owners.



# QUICK START GUIDE

EUFYCARE BABY  
MONITOR 2 COMPLETE

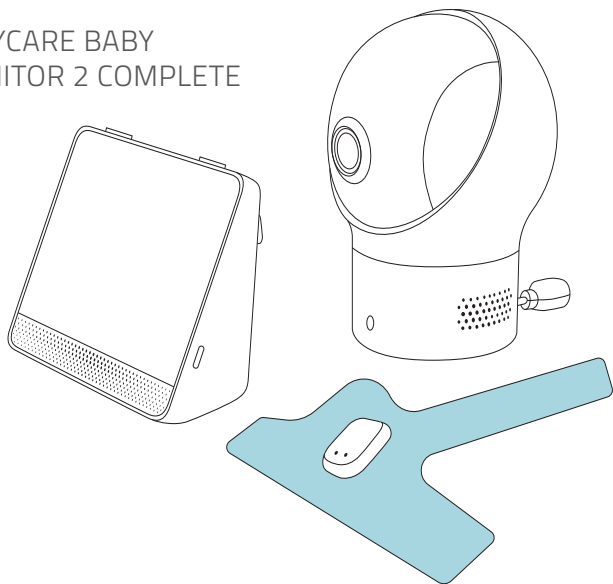

Sock for eufyCare Baby Monitor 2 Complete only



# Table of Contents

SAFETY INSTRUCTIONS	01
HOW THE PRODUCT WORKS	01
GETTING STARTED	02
SETTING UP YOUR DISPLAY, CAMERA, AND SOCK	05
DOWNLOADING EUFYCARE APP	05
MOUNTING THE CAMERA	05
WRAPPING YOUR BABY'S FOOT WITH THE SOCK	07
NOTICE	10

## SAFETY INSTRUCTIONS

**Strangulation Hazard:** Children get **STRANGLED** in cords. Keep cords out of the reach of children (more than 1m / 3ft away). Never use extension cords with AC adapters. Only use the AC adapters provided.

**NOTE:** eufyCare Baby Smart Sock is not a medical device and is not intended for diagnosis prevention, or treatment of any disease or condition.

## HOW THE PRODUCT WORKS

The product includes a camera allowing you to watch your baby, and provides real-time monitoring of heart rate and blood oxygen level via the smart sock worn on the baby's foot. In case of emergency, you can get alarms from the display and your phone through the eufyCare app.

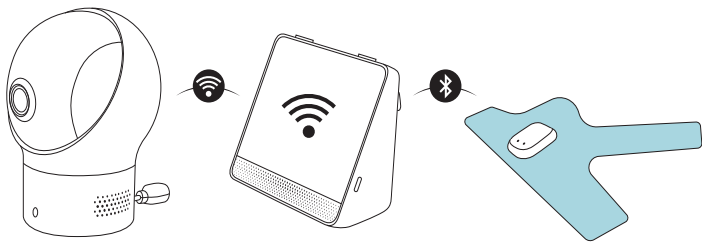

## GETTING STARTED

Power on the Display:

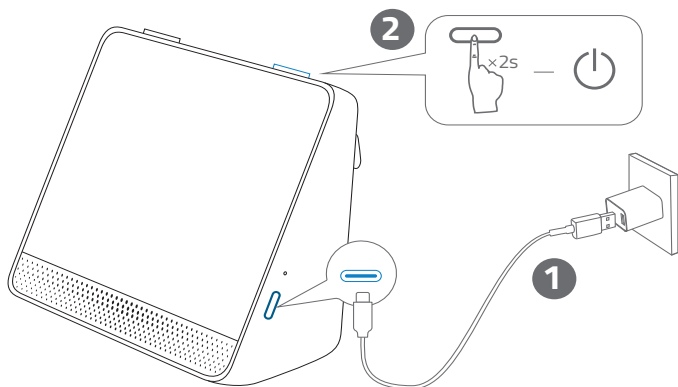

Power on the Camera:

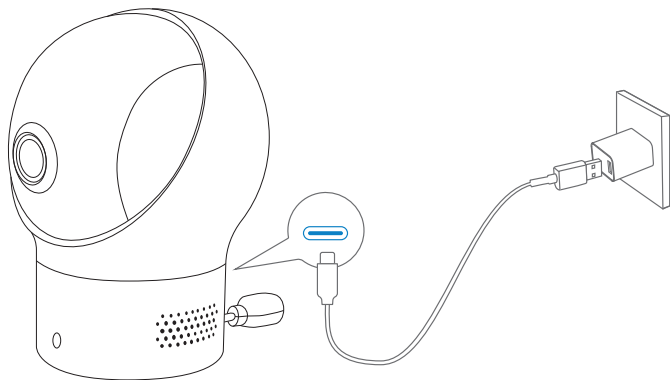

Charge the sock, and then it can be detected and connected to the display  
(for eufyCare Baby Monitor 2 Complete only):

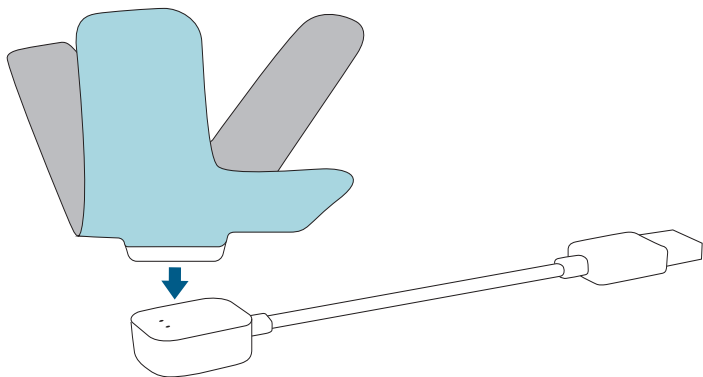

Item	Status LED	Description
Display	Solid red	Charging
	Solid white	Fully charged
	Flashing red	Low battery
Camera	Solid white	Connected
	Flashing white	Waiting to pair
	Flashing white fast	No connection
Sock	Flashing red	Charging and waiting to connect
	Solid red	Charging and connected
	Solid green	Fully charged and connected



## SETTING UP YOUR DISPLAY, CAMERA, AND SOCK

After powering on your display, follow the on-screen instructions to complete the initial setup.

### DOWNLOADING EUFYCARE APP

For remote access, download the eufyCare app from Google Play or App Store. Scan the QR code on the display using your eufyCare app to complete the setup.



### MOUNTING THE CAMERA

You have three options to mount the camera: on the wall, in the corner, or on the crib.

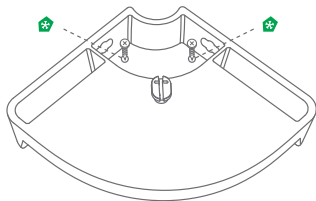
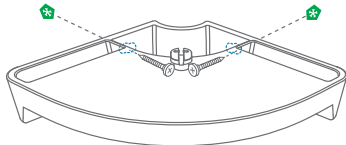

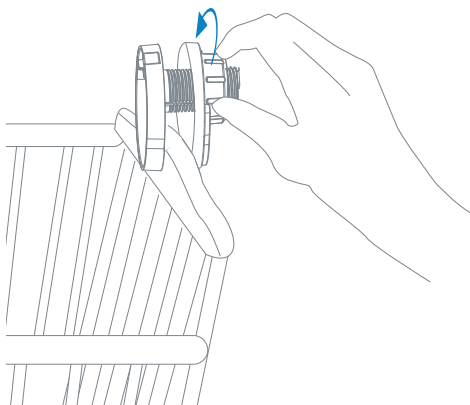
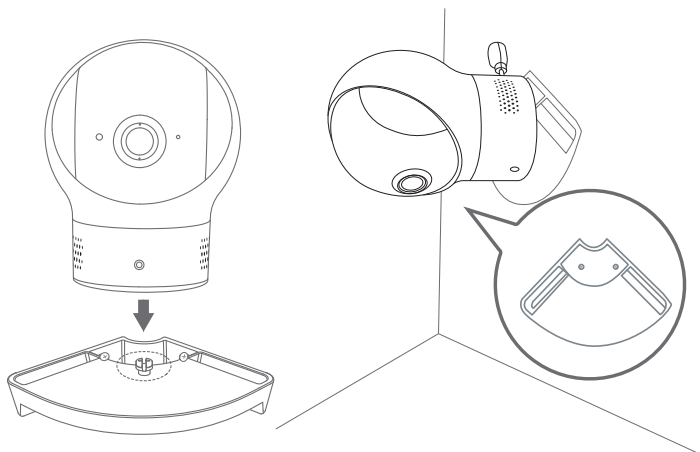

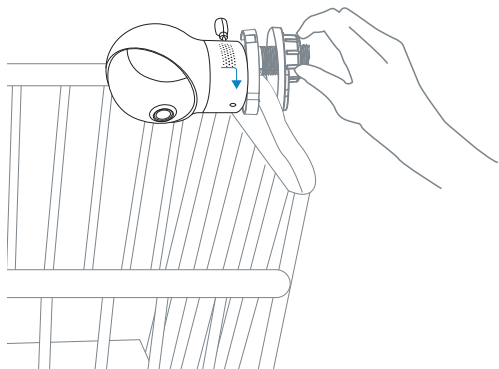

## WRAPPING YOUR BABY'S FOOT WITH THE SOCK

Choose the right size for your baby. The sock with the pre-installed sensor is for babies at 4-12 lbs. To install the sensor on the bigger sock (12-30 lbs):

1. Remove the original sensor from the sock.

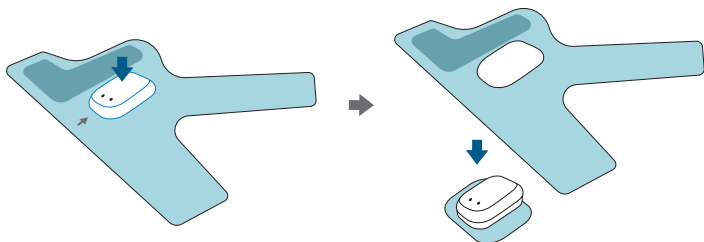

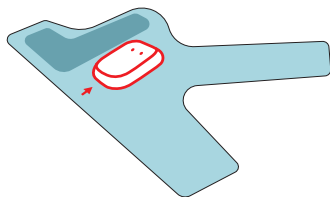
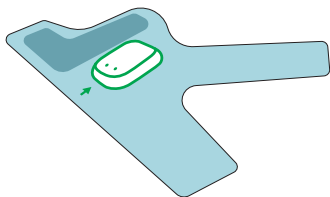

2. The sock can be worn on either foot. Place the sock sensor on the foot as illustrated (do not overtighten the strap).

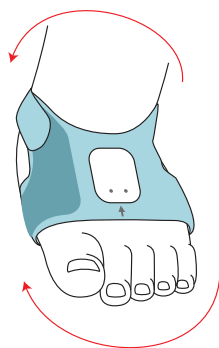
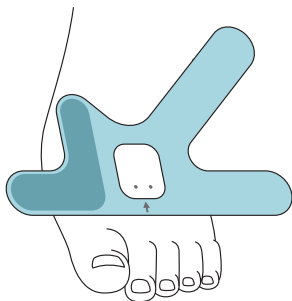

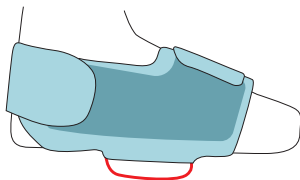
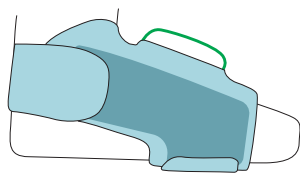

# NOTICE

## FCC Statement

This device complies with Part 15 of the FCC Rules. Operation is subject to the following two conditions: (1) this device may not cause harmful interference, and (2) this device must accept any interference received, including interference that may cause undesired operation.

Warning: Changes or modifications not expressly approved by the party responsible for compliance could void the user's authority to operate the equipment.

Note: This equipment has been tested and found to comply with the limits for a Class B digital device, pursuant to Part 15 of the FCC Rules. These limits are designed to provide reasonable protection against harmful interference in a residential installation.

This equipment generates uses and can radiate radio frequency energy and, if not installed and used in accordance with the instructions, may cause harmful interference to radio communications. However, there is no guarantee that interference will not occur in a particular installation. If this equipment does cause harmful interference to radio or television reception, which can be determined by turning the equipment off and on, the user is encouraged to try to correct the interference by one or more of the following measures: (1) Reorient or relocate the receiving antenna. (2) Increase the separation between the equipment and receiver. (3) Connect the equipment into an outlet on a circuit different from that to which the receiver is connected. (4) Consult the dealer or an experienced radio/ TV technician for help.

## FCC Radio Frequency Exposure Statement

T8340 has been evaluated and following general RF exposure requirement. The device can be used in portable exposure condition without restriction. The min separation distance is 0cm.

T8350 has been evaluated and following general RF exposure requirement. The device can be used in portable exposure condition without restriction. The min separation distance is 0cm. **SAR: 0.757 W/Kg**

T8360 has been evaluated to meet general RF exposure requirements. The device can be used in fixed/mobile exposure condition. The min separation distance is 20cm.

Notice: Shielded cables

All connections to other computing devices must be made using shielded cables to maintain compliance with FCC regulations.

The following importer is the responsible party

Company Name: POWER MOBILE LIFE, LLC

Address: 400 108th Ave NE Ste 400, Bellevue, WA 98004-5541

Telephone: 1-800-988-7973

 This product complies with the radio interference requirements of the European Community.

## Declaration of Conformity

Hereby, Anker Innovations Limited declares that this device is in compliance with the essential requirements and other relevant provisions of Directive 2014/53/EU. For the declaration of conformity, visit the Web site: <https://uk.eufylife.com/>.

This product can be used across EU member states.

The adapter shall be installed near the equipment and shall be easily accessible. Do not use the Device in the environment at too high or too low temperature, never expose the Device under strong sunshine or too wet environment. The suitable temperature for the product and accessories is 32°F to 95°F / 0°C to 35°C.

When charging, please place the device in an environment that has a normal room temperature and good ventilation.

It is recommended to charge the device in an environment with a temperature that ranges from 5 ~25 .

Please ensure to use only the charger offered by the manufacturer. Using unauthorized charger may cause danger and violate the authorization of the projector and the guarantee article.

The chargers are for indoor use only. The plug considered as disconnect device of adapter.

The charger for T8340 type is TEKA-UCA10EU, output voltage/current is 5Vdc/1A.

The charger for T8350 type is TEKA-UCA20EU, output voltage/current is 5Vdc/2A.

The charger for T8360 type is TEKA-UCA20EU, output voltage/current is 5Vdc/2A.

CAUTION RISK OF EXPLOSION IF BATTERY IS REPLACED BY AN INCORRECT TYPE. DISPOSE OF USED BATTERIES ACCORDING TO THE INSTRUCTIONS

RF exposure information:

The Maximum Permissible Exposure (MPE) level has been calculated based on a distance of d=20 cm between the device and the human body. To maintain compliance with RF exposure requirement, use product that maintain a 20cm distance between the device and human body.

T8340 Bluetooth Operating Frequency Range:2402~2480 MHz; Bluetooth Max Output Power:8 dBm(EIRP) .

T8350 Wifi Operating Frequency Range:2412~2472 MHz(2.4G); Wifi Max Output Power:19 dBm(ERIP );Bluetooth Operating Frequency Range:2402~2480 MHz; Bluetooth Max Output Power:8 dBm(EIRP) .

T8360 Wifi Operating Frequency Range:2412~2472 MHz(2.4G); Wifi Max Output Power:19 dBm(ERIP );Bluetooth Operating Frequency Range:2402~2480 MHz; Bluetooth Max Output Power:8 dBm(EIRP) .

T8350 was tested for typical body-worn operations with the back of the handset kept 0 mm from the body. The SAR limit of Europe is 4.0 W/kg.

this product has also been tested against this SAR limit. The highest SAR value reported under this standard during product certification for use at the limb is 1.707W/kg .

This device was tested for typical hand held operations with the back of the device kept 0mm from the Limb.

Anker Innovations Deutschland GmbH | Georg-Mueller-Strasse 3, 80807 Munich, Germany



This product is designed and manufactured with high quality materials and components, which can be recycled and reused.



This symbol means the product must not be discarded as household waste, and should be delivered to an appropriate collection facility for recycling. Proper disposal and recycling helps protect natural resources, human health and the environment. For more information on disposal and recycling of this product, contact your local municipality, disposal service, or the shop where you bought this product.



This product complies with the radio interference requirements of the United Kingdom

## Declaration of Conformity

Hereby, Anker Innovations Limited declares that this product is in compliance with Radio Equipment Regulations 2017. The full text of the UK declaration of conformity is available at the following internet address: <https://uk.eufylife.com>

The charger is for indoor use only. The plug is considered a disconnect device of the adapter.

The charger for T8340 type is TEKA-UCA10BS, output voltage/current is 5V DC/1A.

The charger for T8350 type is TEKA-UCA20BS, output voltage/current is 5V DC/2A.

The charger for T8360 type is TEKA-UCA20BS, output voltage/current is 5V DC/2A.

Anker Technology (UK) Ltd I Suite B, Fairgate House, 205 Kings Road, Tyseley, Birmingham, B11 2AA, United Kingdom

## IC Statement

This device complies with Industry Canada licence-exempt RSS standard(s). Operation is subject to the following two conditions: (1) this device may not cause interference, and (2) this device must accept any interference, including interference that may cause undesired operation of the device."

Le présent appareil est conforme aux CNR d'Industrie Canada applicables aux appareils radio exempts de licence. L'exploitation est autorisée aux deux conditions suivantes: (1) l'appareil ne doit pas produire de brouillage, et (2) l'utilisateur de l'appareil doit accepter tout brouillage radioélectrique subi, même si le brouillage est susceptible d'en compromettre le fonctionnement."

This Class B digital apparatus complies with Canadian ICES-003.

Cet appareil numérique de la classe B est conforme à la norme NMB-003 du Canada.



**IC RF Statement:**

T8340 has been evaluated and following general RF exposure requirement. The device can be used in portable exposure condition without restriction. The min separation distance is 0cm.

Le T8340 a été évalué et conforme aux exigences générales d'exposition aux RF. L'appareil peut être utilisé dans des conditions d'exposition portable sans restriction. La distance de séparation minimale est de 0 cm.

T8350 has been evaluated and following general RF exposure requirement. The device can be used in portable exposure condition without restriction. The min separation distance is 0cm.

Le T8350 a été évalué et conforme aux exigences générales d'exposition aux RF. L'appareil peut être utilisé dans des conditions d'exposition portable sans restriction. La distance de séparation minimale est de 0 cm.

When using T8360, maintain a distance of 20cm from the body to ensure compliance with RF exposure requirements.

Lors de l'utilisation du T8360, maintenez une distance de 20 cm du corps afin de vous conformer aux exigences en matière d'exposition RF.

## CUSTOMER SERVICE

### ▪ Warranty

---

12-month limited warranty

### ▪ Call Us

---

United States +1 (800) 988 7973 Mon-Fri 9AM-5PM (PT)

United Kingdom +44 (0) 1604 936 200 Mon-Fri 6AM-11AM (GMT)

Germany +49 (0) 69 9579 7960 Mon-Fri 6:00-11:00

### ▪ Email Us

---

Customer Support: [support@eufylife.com](mailto:support@eufylife.com)





