

Quick Start Guide

Nebula Soundbar—Fire TV Edition

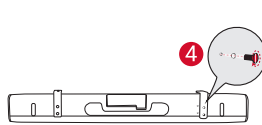

HDMI (ARC)

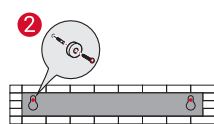
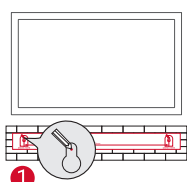
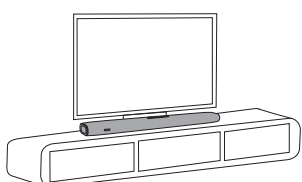
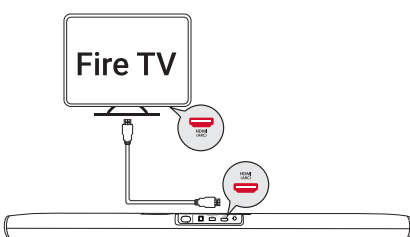

OPTICAL

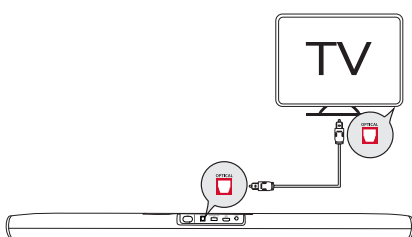

AUX

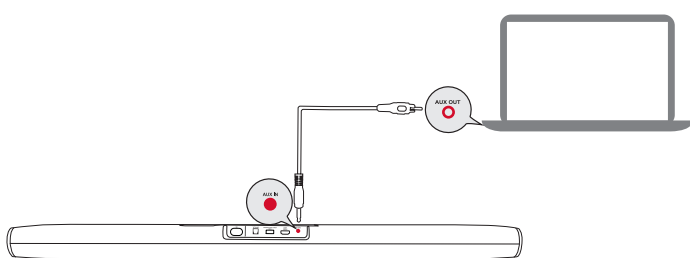

1

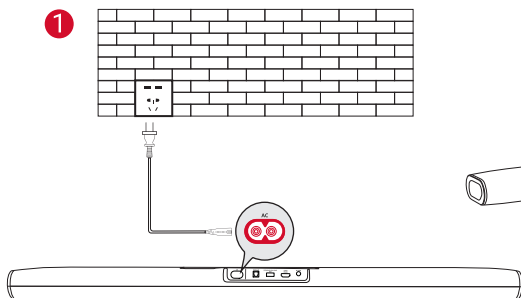

2

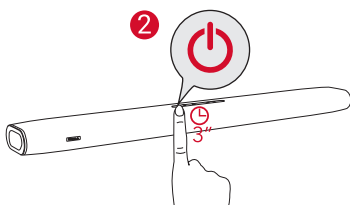

3



1

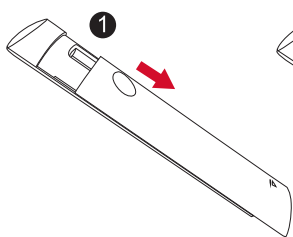

2

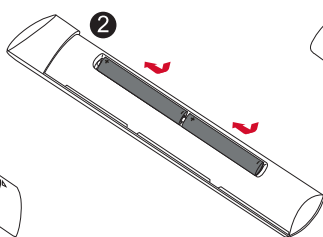

3

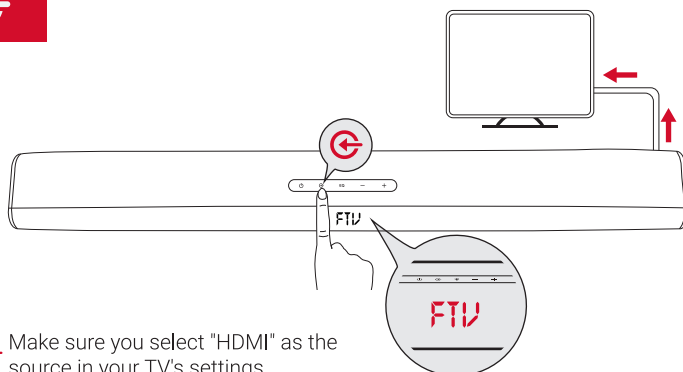
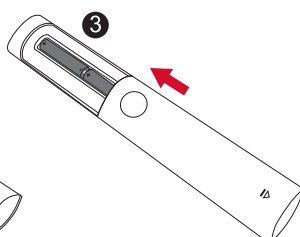

FTV



Make sure you select "HDMI" as the source in your TV's settings.

NEBULA

For FAQs and more information, please visit:

www.SeeNebula.com

✉ support@SeeNebula.com

+1 (800) 988 7973 (US) Mon-Fri 9:00am - 5:00pm (PT)

+44 (0) 1604 936200 (UK) Mon-Fri 6:00 - 11:00 (GMT)

+49 (0) 69 9579 7960 (DE) Mo-Fr 6:00 - 11:00

+81 03 4455 7823 (日本) 月 - 金 9:00 - 17:00

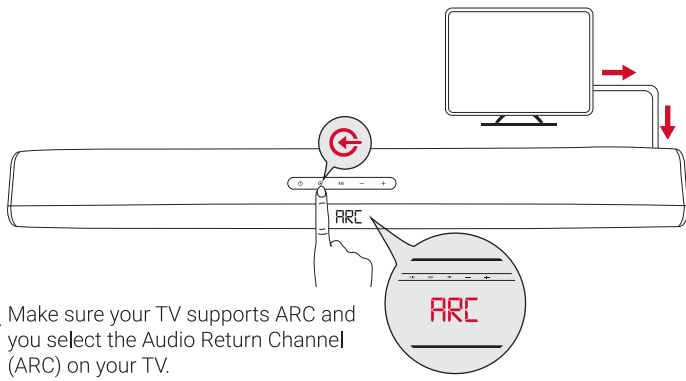

Make sure your TV supports ARC and you select the Audio Return Channel (ARC) on your TV.

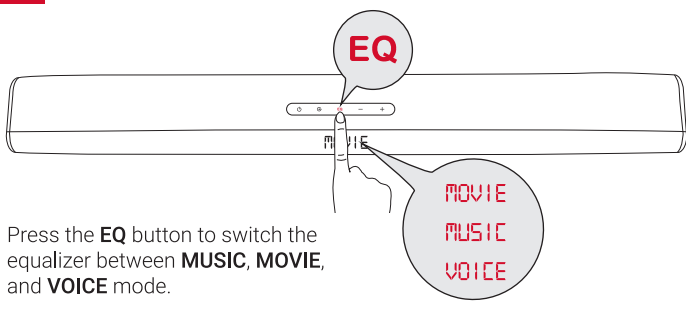
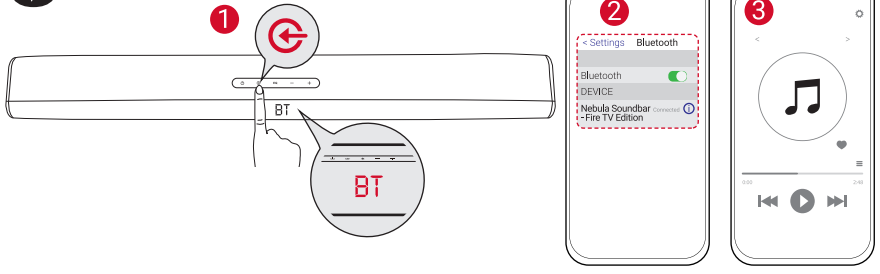

Press the **EQ** button to switch the equalizer between **MUSIC**, **MOVIE**, and **VOICE** mode.

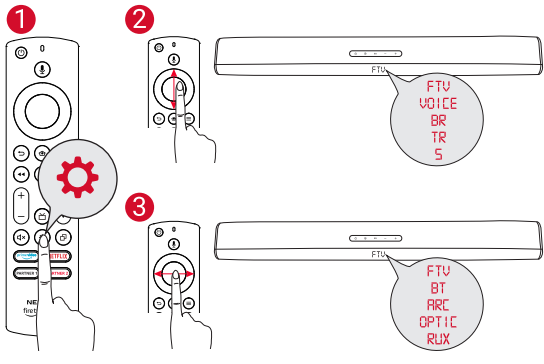

1. Press button on the remote control to access the soundbar's settings.
2. Press the navigation button up or down to navigate the settings menu. Switch between Source Mode, EQ, Surround, Bass, and Treble modes.
3. Press the navigation button left or right to switch between options within each mode. Press to select the option.



Download the Nebula Connect app to control the soundbar from your phone and download firmware updates.

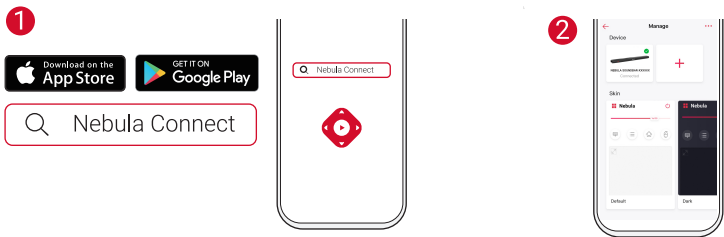

Safety Instructions

- Avoid dropping.
- Do not disassemble.
- Do not submerge in water.
- Avoid extreme temperatures.
- Do not use the device outdoors during thunderstorms.
- Use original or certified cables.
- Do not place dangerous items on top of this device (e.g. liquid-filled containers, lit candles).
- Use original or certified cables.
- Clean with a dry, soft lint-free cloth. Do not use any corrosive cleaner or oil.
- To avoid hearing damage, do not listen for extended periods at high volume.
- Do not expose the batteries to extreme heat sources such as direct sunlight or open flames.
- The ideal operating temperature for this product and its accessories is between 5°C-35°C.
- The adapter should be installed near the device and should be easily accessible.
- Do not use this product in environments of extreme heat or cold. Never expose this device to strong sunshine or wet environments.

Notice

This product complies with the radio interference requirements of the European Community.

Declaration of Conformity

Hereby, Anker Innovations Limited declares that this device is in compliance with the essential requirements and other relevant provisions of Directive 2014/53/EU. For the declaration of conformity, visit the Web site: www.seenebula.com.

RF exposure information: The Maximum Permissible Exposure (MPE) level has been calculated based on a distance of d=20 cm between the device and the human body. To maintain compliance with RF exposure requirement, use a product that maintain a 20cm distance between the device and human body.
CAUTION RISK OF EXPLOSION IF BATTERY IS REPLACED BY AN INCORRECT TYPE. DISPOSE OF USED BATTERIES ACCORDING TO THE INSTRUCTIONS
 Wifi Operating Frequency Range: 2412~2472MHz(2.4G); 5150~5250MHz, 5725~5850MHz (5G)
 Wifi Max Output Power: 19dBm(2.4G); 15dBm(5G)
 Bluetooth Operating Frequency Range : 2402~2480MHz; Bluetooth Max Output Power: 8dBm
 5150~5250 MHz can be used indoor only.

The following importer is the responsible party (contact for EU matters only)
 Importer: Anker Technology (UK) Ltd
 Importer Address: Suite B, Fairgate House, 205 Kings Road, Tyseley, Birmingham, B11 2AA, United Kingdom

	AT	BE	BG	HR	CY	CZ	DK
	EE	FI	FR	DE	EL	HU	IE
	IT	LV	LT	LU	MT	NL	PL
	PT	RO	SK	SI	ES	SE	UK

This product is designed and manufactured with high quality materials and components, which can be recycled and reused.

This symbol means the product must not be discarded as household waste, and should be delivered to an appropriate collection facility for recycling. Proper disposal and recycling helps protect natural resources, human health and the environment. For more information on disposal and recycling of this product, contact your local municipality, disposal service, or the shop where you bought this product.

FCC Statement

This device complies with Part 15 of the FCC Rules. Operation is subject to the following two conditions: (1) This device may not cause harmful interference, and (2) this device must accept any interference received, including interference that may cause undesired operation.

Warning: Changes or modifications not expressly approved by the party responsible for compliance could void the user's authority to operate the equipment.

Note: This equipment has been tested and found to comply with the limits for a Class B digital device, pursuant to Part 15 of the FCC Rules. These limits are designed to provide reasonable protection against harmful interference in a residential installation.

This equipment generates, uses and can radiate radio frequency energy and, if not installed and used in accordance with the instructions, may cause harmful interference to radio communications. However, there is no guarantee that interference will not occur in a particular installation. If this equipment does cause harmful interference to radio or television reception, which can be determined by turning the equipment off and on, the user is encouraged to try to correct the interference by one or more of the following measures:

- (1) Reorient or relocate the receiving antenna.

- (2) Increase the separation between the equipment and receiver.
- (3) Connect the equipment into an outlet on a circuit different from that to which the receiver is connected.
- (4) Consult the dealer or an experienced radio/TV technician for help.

FCC Radio Frequency Exposure Statement

The device has been evaluated to meet general RF exposure requirements. The device can be used in fixed/mobile exposure condition. The min separation distance is 20cm.

Notice: Shielded cables
 All connections to other computing devices must be made using shielded cables to maintain compliance with FCC regulations.

FCC ID: 2AOKB-D3000
 The following importer is the responsible party
 Company Name: Fantasia Trading LLC
 Address: 9155 Archibald Avenue, Suite 202, Rancho Cucamonga, CA, 91730, US
 Telephone: +1 (909) 484 1530

Customer Service

12-month limited warranty
 lifetime technical support

Anker Innovations Limited
 Room 1318-19, Hollywood Plaza, 610 Nathan Road, Mongkok, Kowloon, Hong Kong