

NEBULA  
by Anker

# QUICK START GUIDE

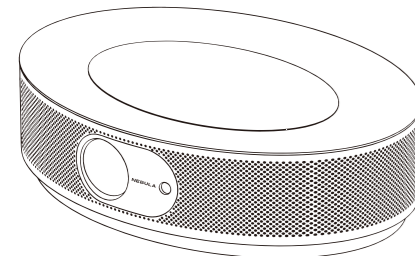

FCC ID:2AOKB-D2150  
IC:23451-D2150

Nebula Cosmos Max

- 01 Charge Your Projector
- 02 Prepare Remote Control
- 03 Power On / Off
- 04 Adjust the Focus
- 05 Control Buttons
- 06 Download Nebula Connect App
- 07 Chromecast™
- 08 Play Video from HDMI / USB Devices

- 01
- 02
- 03
- 04
- 05
- 06
- 07
- 08

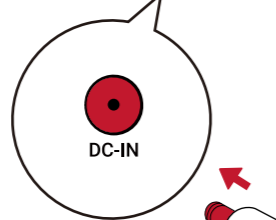
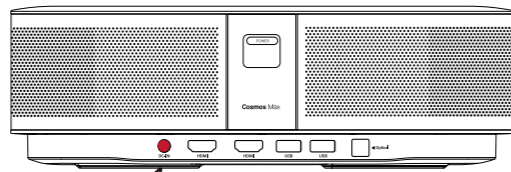

Charge Your Projector

01

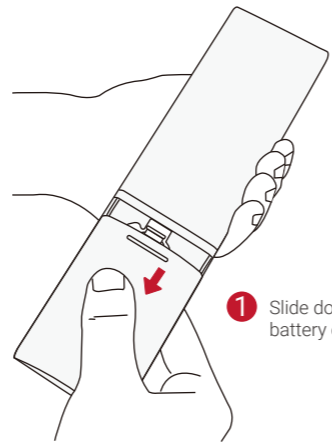

1 Slide down to open the battery compartment.

2

Insert new batteries, matching the polarity (+ / -) as indicated.

02

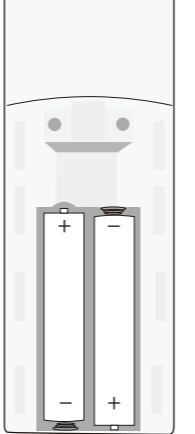

Press **POWER** to power on. Press and hold **POWER**. A menu pops up. Select Power Off to turn off the projector.

When the projector is in standby mode, press **POWER** to turn on / off the projector.

03

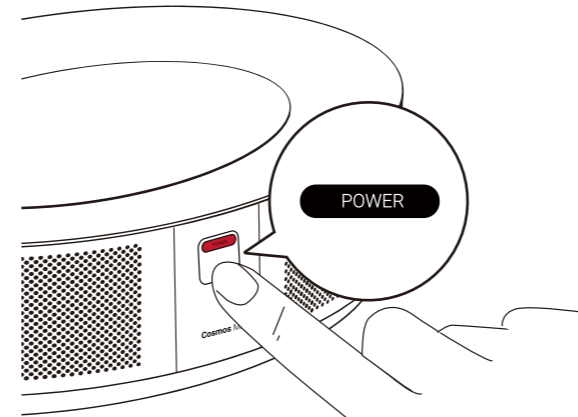

03

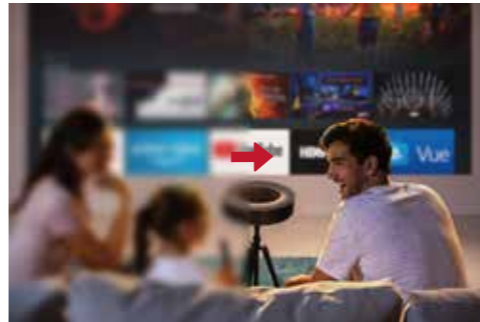

Press the **FOCUS** button on the remote control to adjust focus.

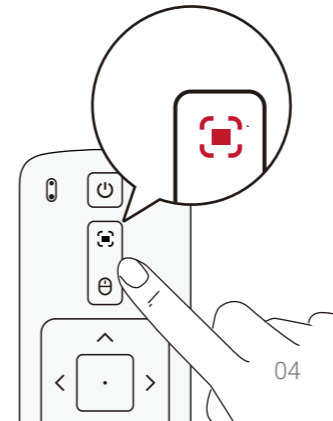

04

Adjust Focus

Navigation

Back

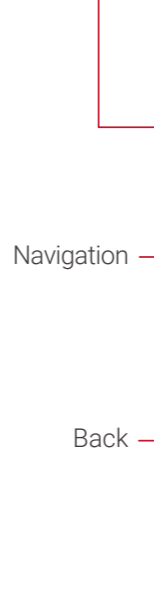

Power On / Off

Press to activate Google Assistant

Confirm the selected content

Home

System Settings

Volume Up / Down

Remote Control: Nebula RC  
Model: D0413

05

- 1 Download the Nebula Connect app from the App Store (iOS devices) or Google Play (Android devices) to control your projector.
- 2 Enable Bluetooth on your smartphone.
- 3 Open the **Nebula Connect** app, and follow the on-screen instructions to complete the connection setup.

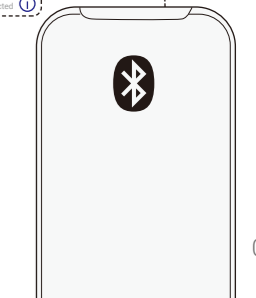
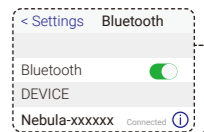

06

# NEBULA

For FAQs and more information, please visit:

[www.SeeNebula.com](http://www.SeeNebula.com)

✉ support@SeeNebula.com

+1 (800) 988 7973 (US) Mon-Fri 9:00am - 5:00pm (PT)

+44 (0) 1604 936200 (UK) Mon-Fri 6:00 - 11:00 (GMT)

+49 (0) 69 9579 7960 (DE) Mo-Fr 6:00 - 11:00

+81 03 4455 7823 (日本) 月 - 金 9:00 - 17:00

©Anker Innovations Limited. All rights reserved. NEBULA and the NEBULA logo are trademarks of Anker Innovations Limited, registered in the United States and other countries. Anker Innovations Limited Room 1318-19, Hollywood Plaza, 610 Nathan Road, Mongkok, Kowloon, Hong Kong

Model: D2150 51005002294 V01

Wirelessly cast movies, games, and music from your phone to Nebula Cosmos Max.

- 1 Play a video clip on your phone and then tap the cast icon  on the video screen.
- 2 Select the device "D2150" you want to cast to.
  - This projector will mirror the screen of the connected phone or computer.



Make sure Nebula Cosmos and your phone are connected to the same wireless network.

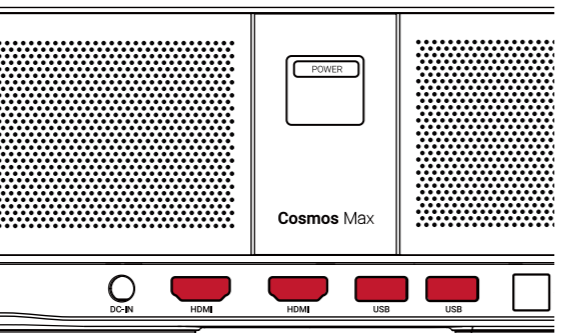
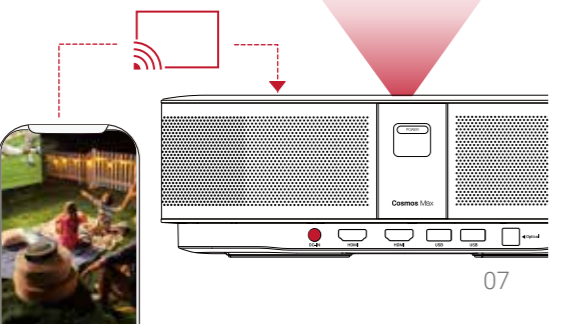

The HDMI port and USB port cannot be used to simultaneously stream video and audio content.

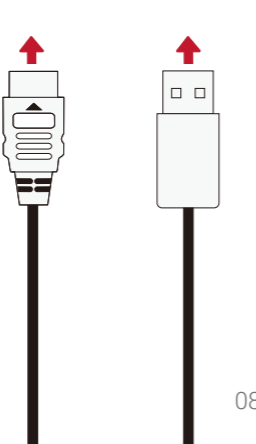

## Important Safety Instructions

- Due to the enclosure material, the product must only be connected to a USB 2.0 or higher.
- The adapter should be installed near the equipment and must be easily accessible.
- Do not use the device in an environment where the temperature is too high or too low. Never expose the device to strong sunshine or wet environments.
- The ideal temperature range for this product and its accessories is 41°F - 95°F / 5°C - 35°C.
- When charging, place the device in an environment with a temperature that ranges between 41°F - 77°F / 5°C - 25°C as well as good ventilation.
- Only use the charger provided by the manufacturer. Using unauthorized chargers may cause danger and violate the projector's guarantee.
- This charger is for indoor use only.
- The charger type is HKA18019095-6C with output voltage / current of DC19V/9.47A. The plug of the adapter is considered as the disconnect device. Once unplugged, the charger is considered as disconnected from the power source.

## Notice

**CE** This product complies with the radio interference requirements of the European Community.

**Declaration of Conformity**  
 Hereby, Anker Innovations Limited, declares that this device is in compliance with the essential requirements and other relevant provisions of Directive 2014/53/EU. For the Declaration of Conformity, visit the website: [www.SeeNebula.com](http://www.SeeNebula.com).

RF exposure information for D2140: The Maximum Permissible Exposure (MPE) level has been calculated based on a distance of d=20 cm between the device and the human body. To maintain compliance with RF exposure requirements, use products that maintain a 20cm distance between the device and human body. Bluetooth BT Maximum output power: 6.858 dBm(EIRP); Bluetooth Operating BT Frequency band: 2402~2480 MHz;

Wi-Fi Max Output Power: 18.97 19 dBm (EIRP for 2.4G); 13.1415 dBm (EIRP for 5G);

Wi-Fi Frequency Band: 2412~2472 MHz (2.4G); 5150~5250 MHz, 5725~5850 MHz (5G).

5150~5250 MHz can be used indoor only.

	AT	BE	BG	HR	CY	CZ	DK
	EE	FI	FR	DE	EL	HU	IE
	IT	LV	LT	LU	MT	NL	PL
	PT	RO	SK	SI	ES	SE	UK

The following importer is the responsible party (contact for EU matters only)

Importer: Anker Technology (UK) Ltd

Importer Address: Suite B, Fairgate House, 205 Kings Road, Tyseley, Birmingham, B11 2AA, United Kingdom

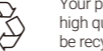
 Your product is designed and manufactured with high quality materials and components, which can be recycled and reused.

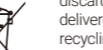
 This symbol means the product must not be discarded as household waste, and should be delivered to an appropriate collection facility for recycling. Proper disposal and recycling helps protect natural resources, human health and the environment. For more information on disposal and recycling of this product, contact your local municipality, disposal service, or the shop where you bought this product.

### FCC Notice

This device complies with the FCC rules, Part 15. Operation is subject to the following two conditions: (1) This device may not cause harmful interference, and (2) This device must accept any interference received, including interference that may cause undesired operation.

**Warning:** Changes or modifications not expressly approved by the party responsible for compliance could void the user's authority to operate the equipment.

**Note:** This equipment has been tested and found to comply with the limits for a Class B digital device, pursuant to Part 15 of the FCC Rules. These limits are designed to provide reasonable protection against harmful interference in a residential installation.

This equipment generates, uses and can radiate radio frequency energy and, if not installed and used in accordance with the instruction manual, may cause harmful interference to radio communications. However, there is no guarantee that interference will not occur in a particular installation. If this equipment does cause harmful interference to radio or television reception, which can be determined by turning the equipment off and on, the user is encouraged to try to correct the interference by one or more of the following measures:

- Reorient or relocate the receiving antenna.
- Increase the separation between equipment and receiver.
- Connect the equipment into an outlet on a circuit different from that to which the receiver is connected.
- Consult the dealer or an experienced radio/TV technician for help.

### FCC Radiation Exposure Statement:

This equipment complies with FCC radiation exposure limits set forth for an uncontrolled environment. This equipment should be installed and operated with a minimum distance of 20cm between the radiator and your body. This transmitter must not be co-located or operated in conjunction with any other antenna or transmitter.

### Notice: Shielded cables

All connections to other computing devices must be made using shielded cables to maintain compliance with FCC regulations.

The following importer is the responsible party.  
 Company Name: Fantasia Trading LLC  
 Address: 5350 Ontario Mills Pkwy, Suite 100, Ontario, CA 91764  
 Telephone: 1-800-988-7973



**HIGH-DEFINITION MULTIMEDIA INTERFACE**  
 HDMI, and HDMI logo and High-Definition Multimedia Interface are trademarks or registered trademarks of HDMI licensing LLC in the United States and other countries.

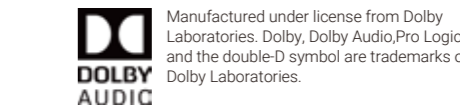

Manufactured under license from Dolby Laboratories. Dolby, Dolby Audio, Pro Logic, and the double-D symbol are trademarks of Dolby Laboratories.

To get a full user manual, you can get it from the Nebula Connect APP or website:

[www.seenebula.com/downloads](http://www.seenebula.com/downloads)

Pour obtenir un manuel d'utilisation complet, vous pouvez l'obtenir à partir de l'application Nebula Connect ou de Webstie:

[www.seenebula.com/downloads](http://www.seenebula.com/downloads)

Um ein vollständiges Benutzerhandbuch zu erhalten, können Sie es über die Nebula Connect APP oder den Webstie herunterladen:

[www.seenebula.com/downloads](http://www.seenebula.com/downloads)

Per ottenere un manuale utente completo, puoi scaricarlo dall'APP Nebula Connect o dal webstie:

[www.seenebula.com/downloads](http://www.seenebula.com/downloads)

Para obtener un manual de usuario completo, puede obtenerlo de la aplicación Nebula Connect o del sitio web:

[www.seenebula.com/downloads](http://www.seenebula.com/downloads)

: أو موقع الويب Nebula Connect للحصول على دليل مستخدم كامل ، يمكنك الحصول عليه من تطبيق

[www.seenebula.com/downloads](http://www.seenebula.com/downloads)

Para obter um manual completo do usuário, você pode obtê-lo no aplicativo ou no aplicativo Nebula Connect:

[www.seenebula.com/downloads](http://www.seenebula.com/downloads)

Om een volledige gebruikershandleiding te krijgen, kunt u deze verkrijgen via de Nebula Connect APP of website:

[www.seenebula.com/downloads](http://www.seenebula.com/downloads)

完全なユーザーマニュアルを入手するには、Nebula Connect APPまたはウェブサイト:

[www.seenebula.com/downloads](http://www.seenebula.com/downloads)から入手できます。

완전한 사용자 설명서를 얻으려면 Nebula Connect APP 또는 웹 사이트에서 얻을 수 있습니다 :

[www.seenebula.com/downloads](http://www.seenebula.com/downloads)