

# A3954\_soundcore Liberty 4 Pro\_User Guide\_Beta Test

## 1. APP



Google Play and the Google Play logo are trademarks of Google Inc.



Apple and the Apple logo are trademarks of Apple Inc.



Download the soundcore app to experience noise canceling levels adjustment, adaptive EQ settings, Spatial Audio, HearID sound, charging box settings, firmware update, and more exciting features.

If your earbuds cannot connect with the soundcore app, re-install the app or update it to the latest version in your mobile app store.

Click this link to download: <http://dl-soundcore.soundcore.com/qcdl?flow=soundcore>

## 2. OVERVIEW

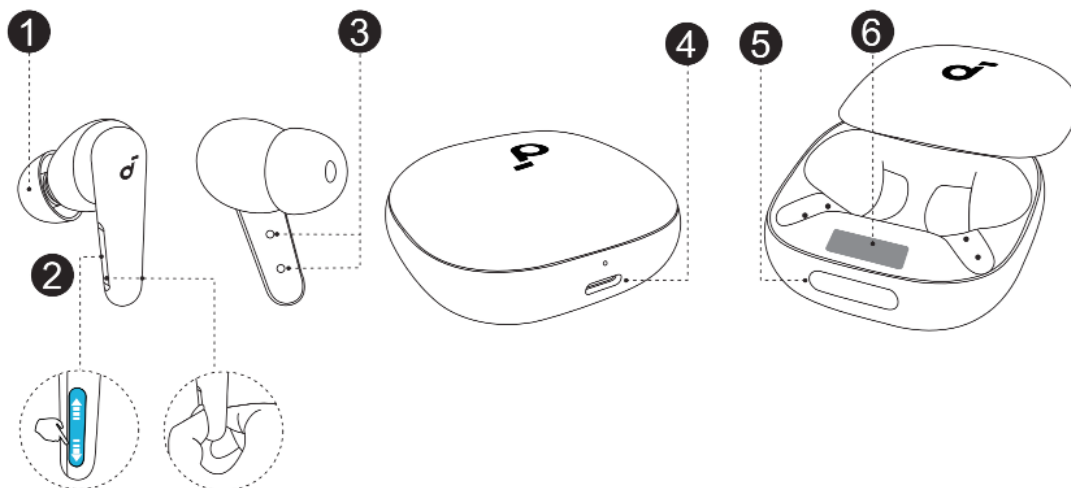

1. Eartip
  - M-size eartips come attached to the earbuds at the time of purchase.
2. Touch Control Area
  - You can slide up & down as well as pinch the touch control area for different operations.
3. Charging Contactors
4. USB-C Charging Port
5. Charging Box Touch Bar
  - You can control the Smart Screen via the touch bar.
6. Smart Screen

### 3. WEARING

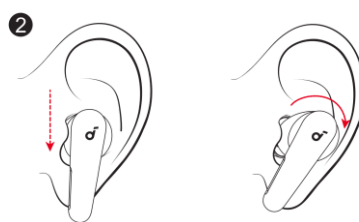
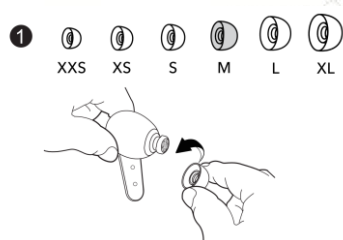

1. Try on different eartips until you find the ones that fit your ears best.
2. Insert the earbuds into your ear canal and gently rotate for a snug fit.
3. Take a fit test in the soundcore app to ensure you get the best ANC performance.

• Dust, earwax or other debris can accumulate in the earbuds. To maintain optimal sound quality, regularly clean your earbuds via using a cotton swab slightly

moistened with rubbing alcohol to gently wipe the metal mesh filter under the rubber ear tips. Finally, ensure the alcohol on the metal mesh filter has completely dried.

## 4. POWERING ON & PAIRING

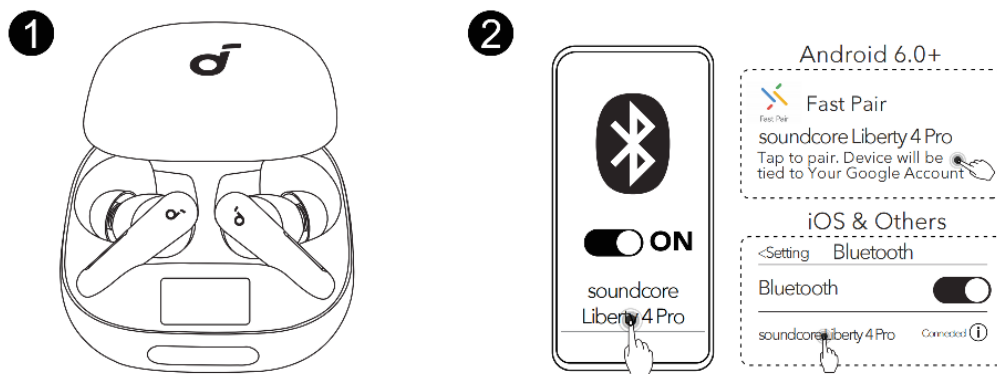

1. Slide open the charging box. The earbuds will automatically power on and enter Bluetooth pairing mode.

**\*Google Fast Pair Supported:** Enjoy instant pairing with your Android smartphone (running Android 6.0 and above) via Fast Pair enabled by Google.

2. Select "**soundcore Liberty 4 Pro**" on your device's Bluetooth list to connect. Upon successful connection, the Bluetooth icon on the Smart Screen will stay on for 3 seconds and then disappear.

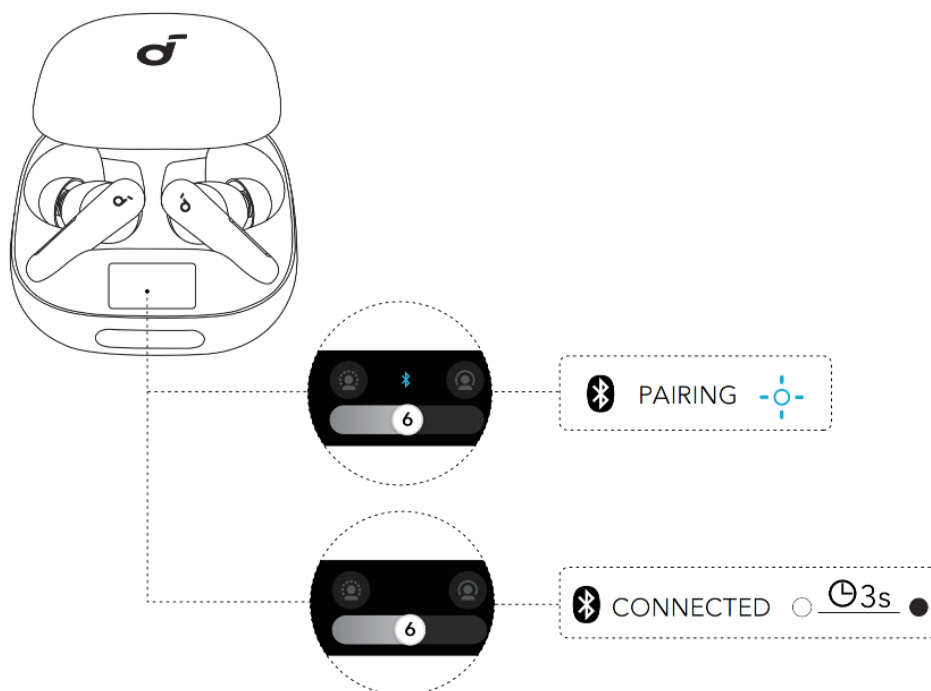

- Once connected successfully, the earbuds will automatically reconnect to your device every time you slide open the charging box, as long as you haven't deleted the pairing history from your device.

## 5. CHARGING

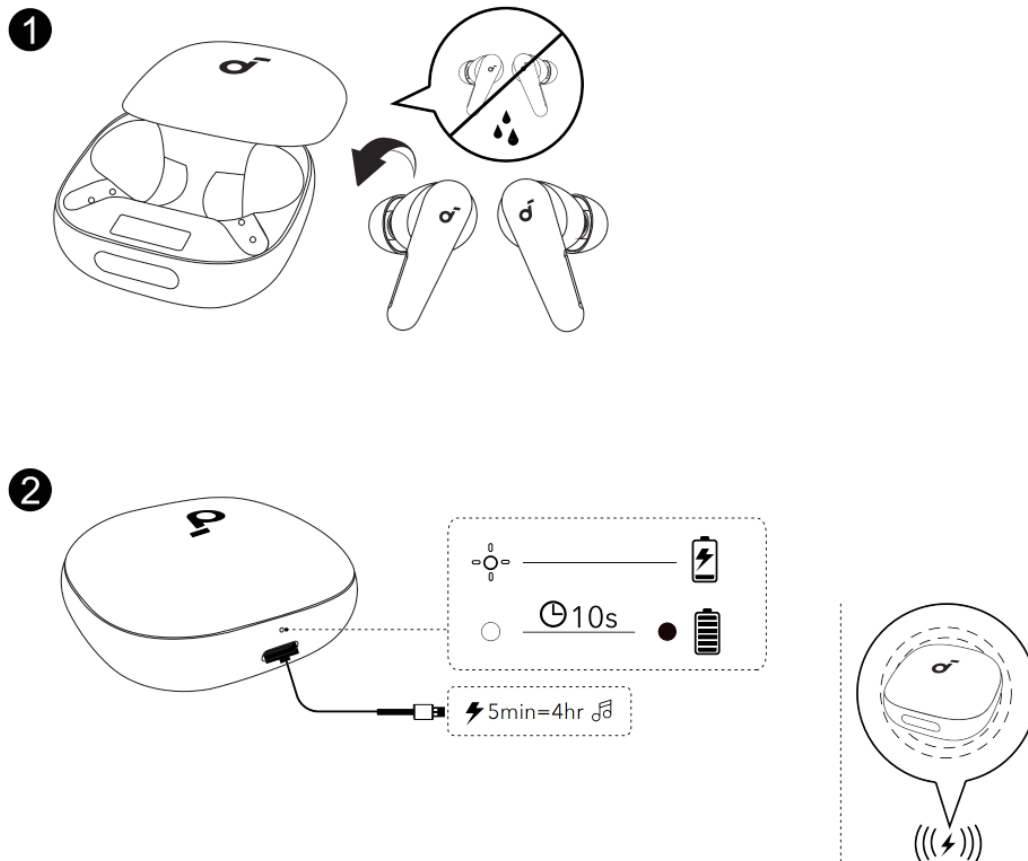

1. Place the earbuds in the charging box and close it.
  - Fully dry off the earbuds and the USB-C charging port before charging.
2. Connect the charging box to the power supply by using the provided USB-C charging cable. Alternatively, position the charging box at the center of your wireless charger for wireless charging.
  - A full battery recharge of the charging box(without earbuds) with the cable takes 2.5 hours and 3 hours via wireless charging; 5 minutes of charging for the earbuds offers 4 hours of playtime.

- When the battery level of the charging box falls below 10%, it will stop charging the earbuds.

## 6. TOUCH BAR & SMART DISPLAY

The touch bar on the charging box allows for effortless control of noise cancelling levels and more features.

- Tap the touch bar once for confirmation.

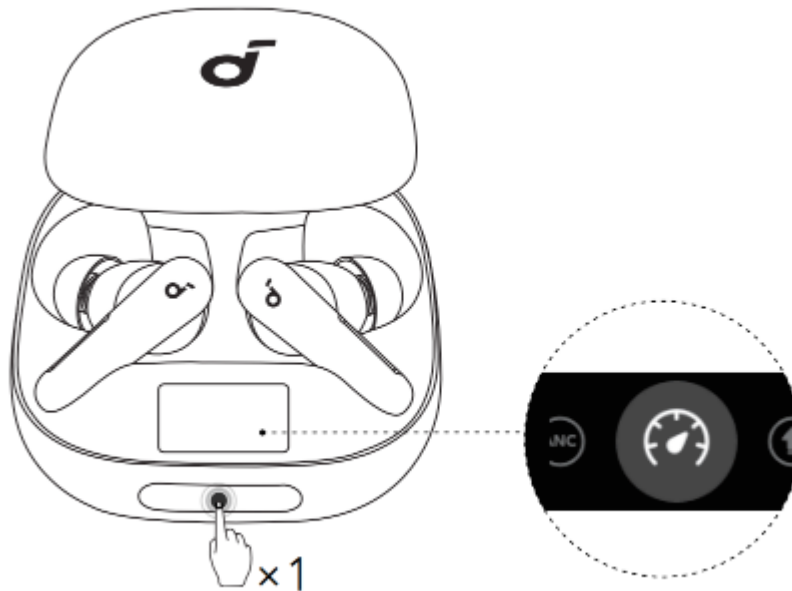

- Tap the touch bar twice to enter the feature menu or return.

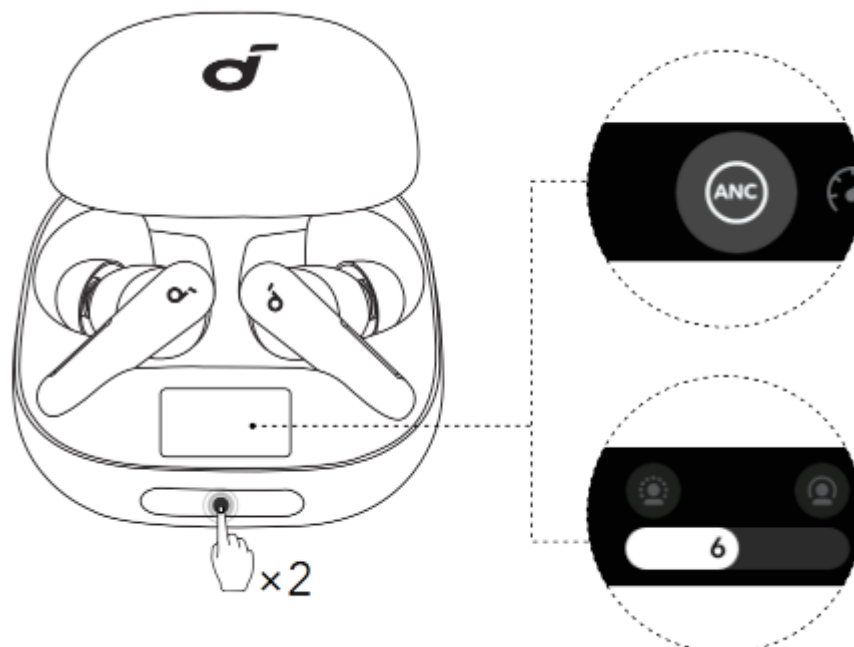

- Tap and hold the touch bar for 5 seconds to reset Bluetooth settings. If you tap "Yes", the device will automatically disconnect and re-enter Bluetooth pairing mode.

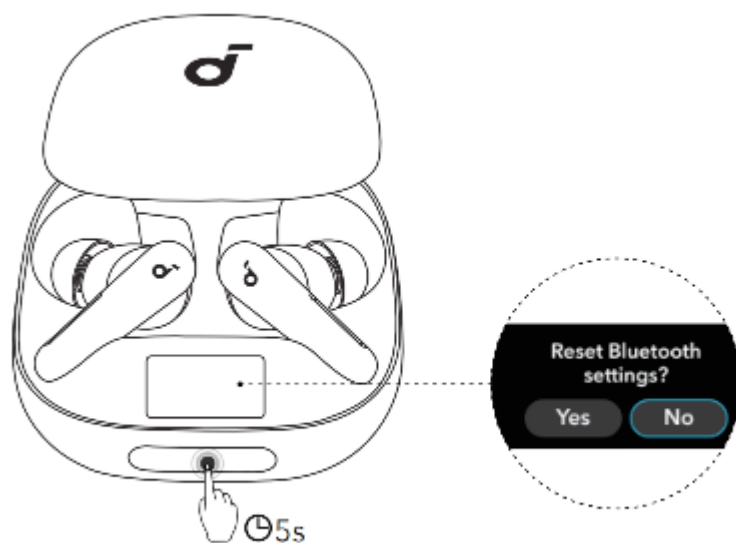

- Tap and hold the touch bar for 10 seconds to reset.

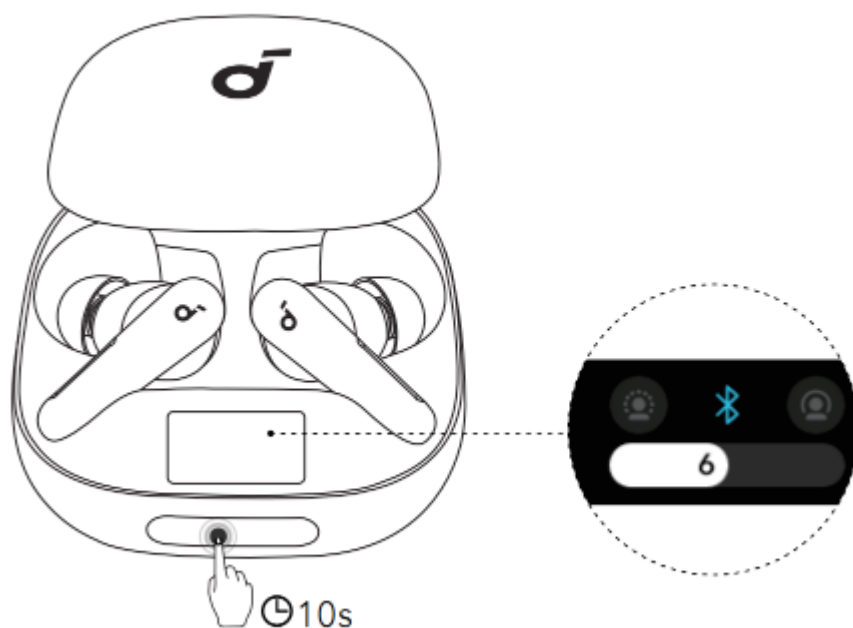

- Slide left or right on the touch bar to select ambient sound levels( from level 1 to level 11) or features.

Taylor Liang 0638

Taylor Liang 0638

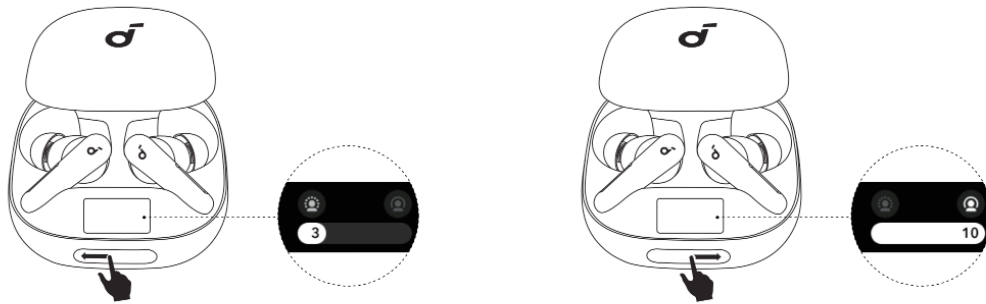

## 7. CHARGING BOX FEATURES

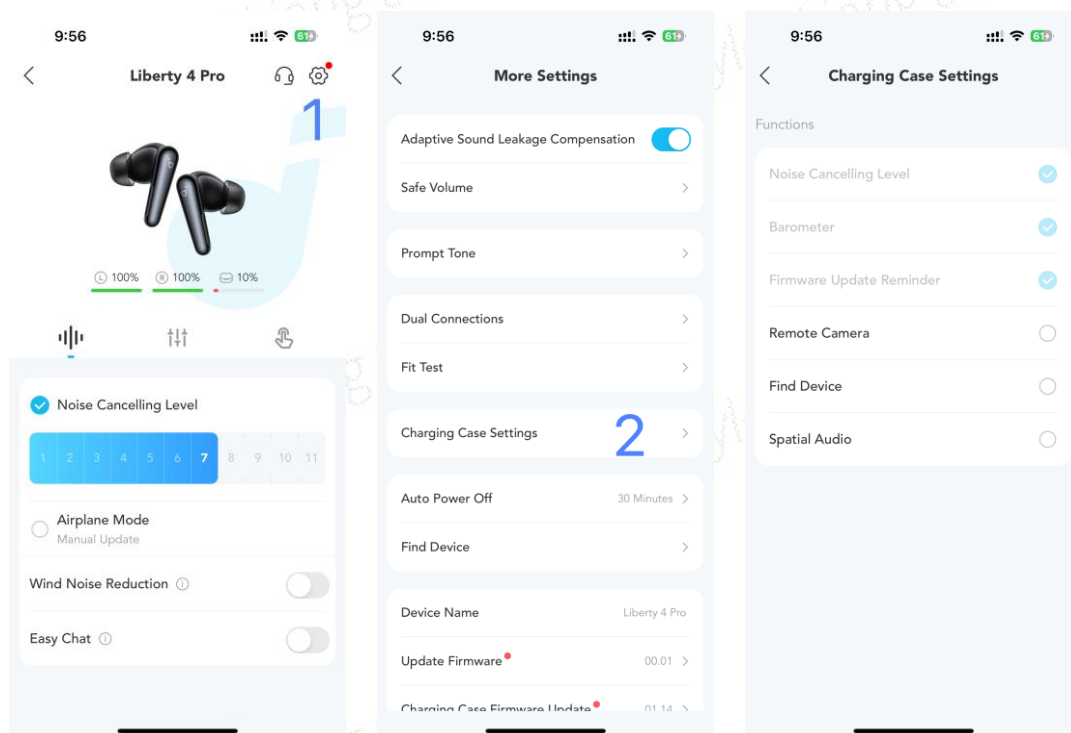

In the soundcore app, you can determine the features you wish to appear on the charging box menu.

There are in total six features available for smart control via the charging box.

**Ambient Sound Level:** Adjust the level of noise cancellation to suit your environment and preferences, ensuring an optimal listening experience.

**Barometer:** Monitor the atmospheric pressure in your surroundings and adjust noise cancelling effect according to atmospheric pressure changes.

**OTA Reminder:** Receive notifications for over-the-air (OTA) updates, ensuring your device is always up to date with the latest features and improvements. When a new version is detected, a red dot will appear on the icon. You will then need to upgrade through the app.

**Remote Camera:** Use the charging box to remotely control your smartphone's camera.

**Find Devices:** Locate your misplaced earbuds within the Bluetooth range through enabling the earbuds to sound alerts.

**Spatial Audio:** Experience immersive 3D sound that adjusts dynamically based on your head movements, providing a more realistic audio experience.

## 8. DUAL CONNECTIONS

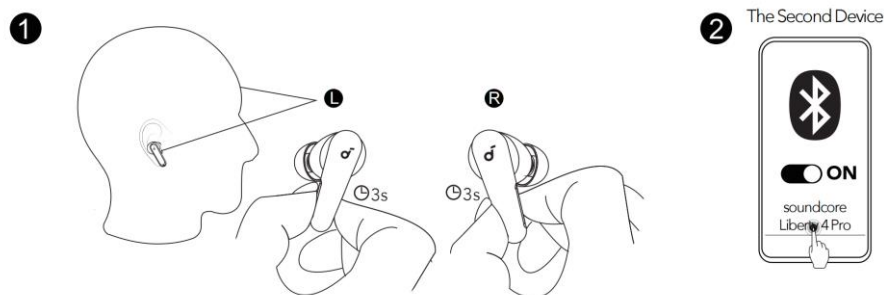

Dual Connections feature is enabled by default.

With one device connected to the earbuds, you can press and hold the touch control area on both earbuds for 3 seconds until you hear a voice prompt of entering pairing mode. Then you can proceed to pair with the second device.

You can also choose to turn off the default settings in soundcore app. Tap on the **Settings** icon located at the upper right corner of the app's interface. Then select **Dual Connections > Disable Dual Connections**.

## 9. CONTROLS

\*You can customize controls in the soundcore app.





		TWS mode	Mono mode
🎵	Play / Pause	Squeeze once (L/R)	Squeeze once
	Next track	Squeeze twice (R)	Squeeze twice
	Previous track	Squeeze twice (L)	/
☎️	Answer a call	Squeeze once (L/R)	Squeeze once
	Reject a call / End a call	Tap and hold for 2 seconds (L/R)	Tap and hold for 2 seconds
👂	Switch ambient sound modes (ANC /Transparency)	Tap and hold for 2 seconds (L/R)	Tap and hold for 2 seconds

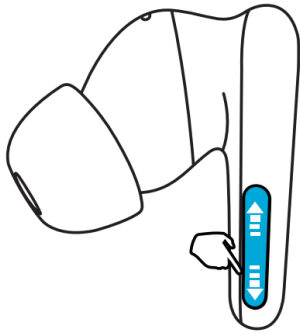

		TWS mode	Mono mode
	Volume up	Slide up (L/R)	Slide up
	Volume down	Slide down (L/R)	Slide down

## 10. SPATIAL AUDIO

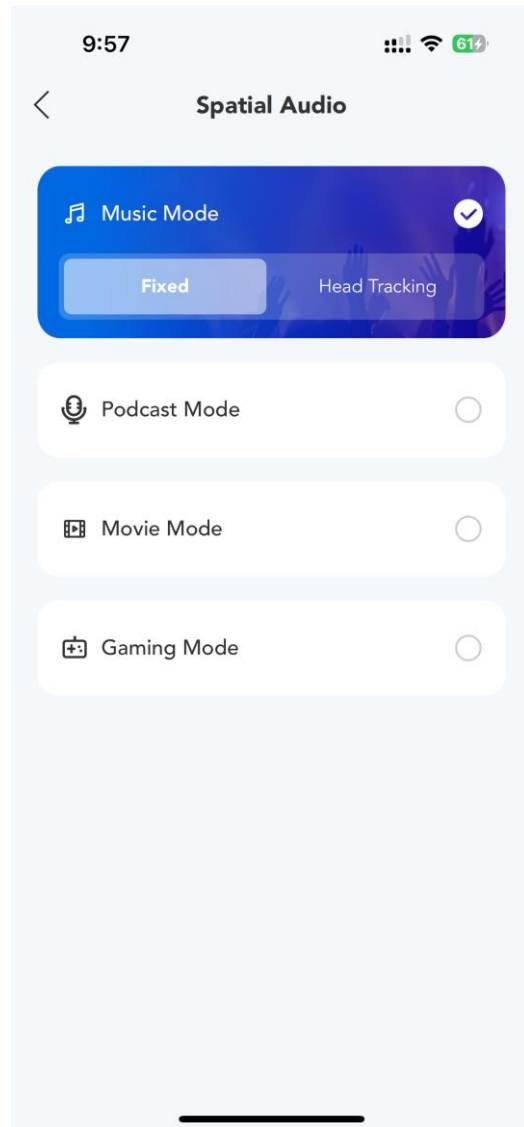
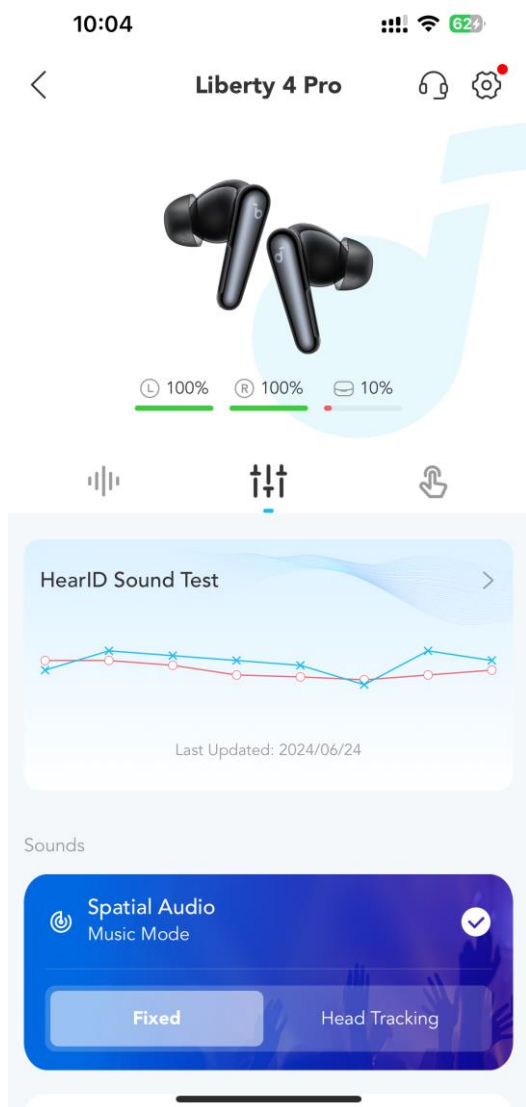

Spatial Audio places sound all around you to create an immersive listening experience. You can choose between four Spatial Audio modes in the soundcore app.

#### Music Mode:

- **Head Tracking:** Hear surround sound that follows your head movement.
- **Fixed:** Listen to Spatial Audio without head tracking.

**Podcast Mode:** Optimized listening experience for clear and focused vocal delivery, making it ideal for listening to spoken content.

**Movie Mode:** Enhanced cinematic experience with rich, immersive audio that brings the action to life.

**Game Mode:** Precise audio cues for an edge in gaming, allowing you to hear every detail and react quickly.

## 10. AMBIENT SOUND

### Control with Touch Bar



You can easily switch from different ambient sound levels by sliding left or right on the touch bar.

### Control with App

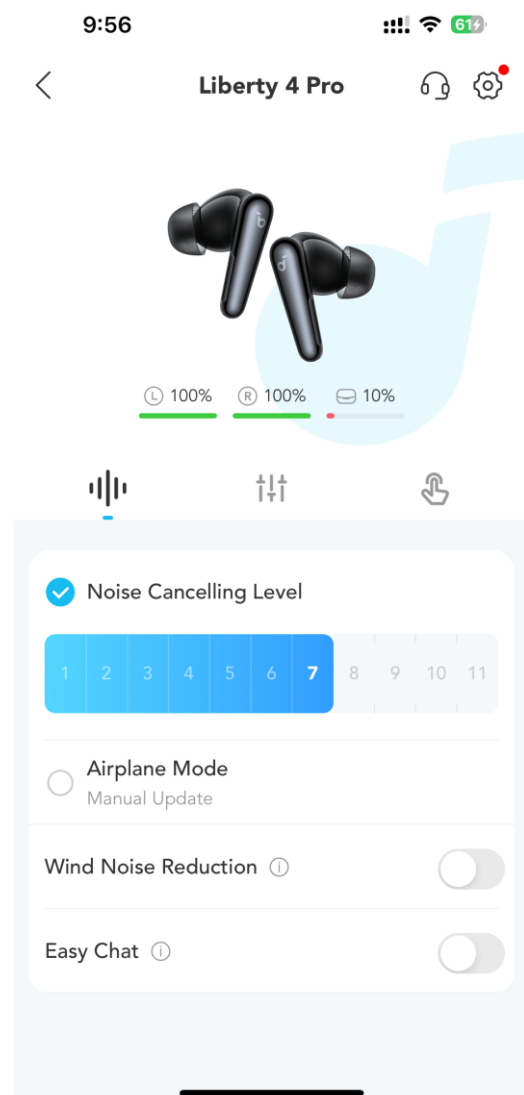

You can select noise cancellation, normal, or transparency mode in the soundcore app.

- **Adaptive ANC (Level 7 to 11):** Optimize noise cancellation by adapting to your ears and environment.
- **Normal (Level 6):** Enjoy balanced sound without any noise cancellation.
- **Transparency (Level 1 to 5):** Stay aware of your surroundings while listening to music.

## 11. EASY CHAT

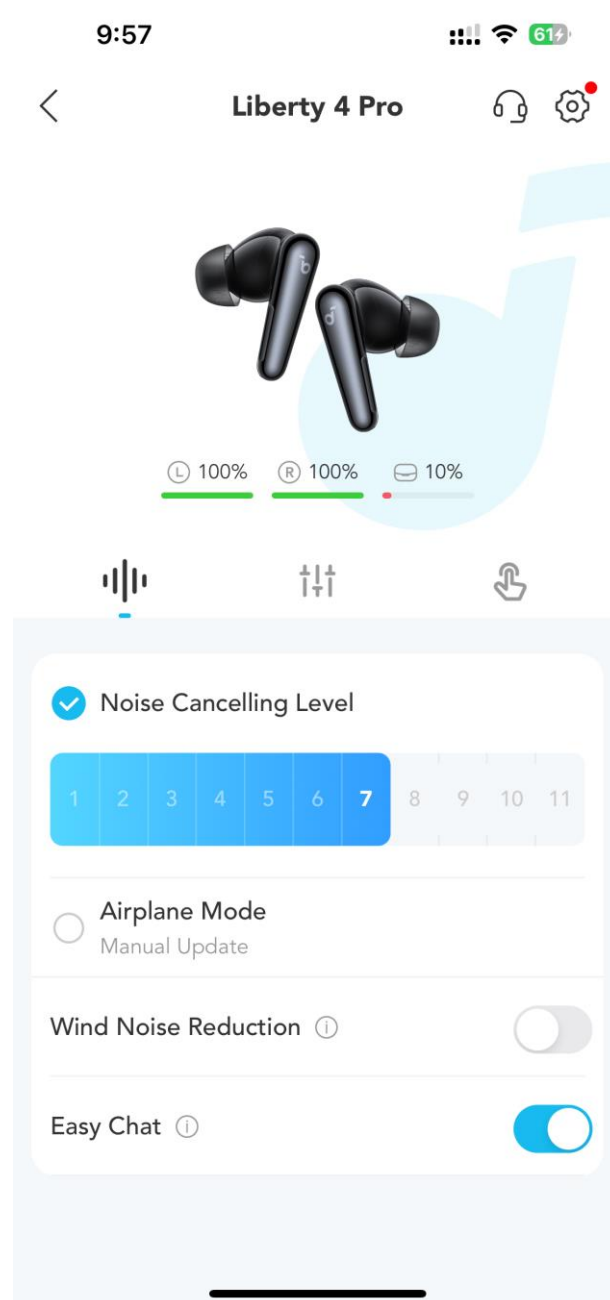

Easy Chat mode automatically lowers the volume of music and enables transparency

mode so that you can communicate without taking the earbuds off.

Please note that Easy Chat will only be available in ANC mode. When you have stopped talking, your earbuds will automatically exit Easy Chat mode and resume the original ANC level and volume.

- This feature needs to be enabled via soundcore app.

## 12. LDAC

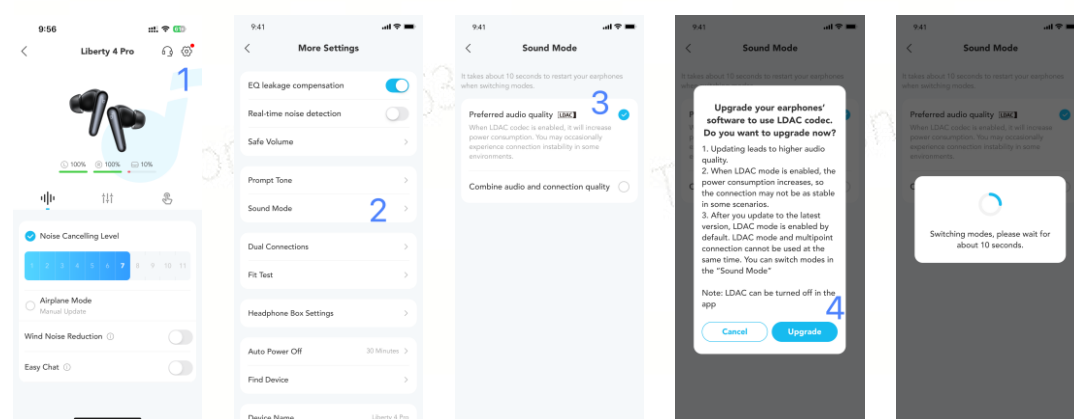

- Use devices powered by Android 8.0 or later to experience LDAC quality sound.
- LDAC provides higher quality sound, increases power consumption, and reduces playtime.
- Enable LDAC in a low-interference environment to ensure a stable Bluetooth connection.

In the soundcore app:

1. Select **"Sound Mode"**.
2. Click on **"Preferred audio quality"**.
3. You will be notified that the earbuds do not support LDAC when connected to two devices. Select **"Upgrade"** to continue.
4. It takes about 10 seconds to switch audio codecs. You may be requested to update the earbuds' firmware if available.

- When LDAC is enabled, Spatial Audio will not be supported.

## 13. WEARING DETECTION

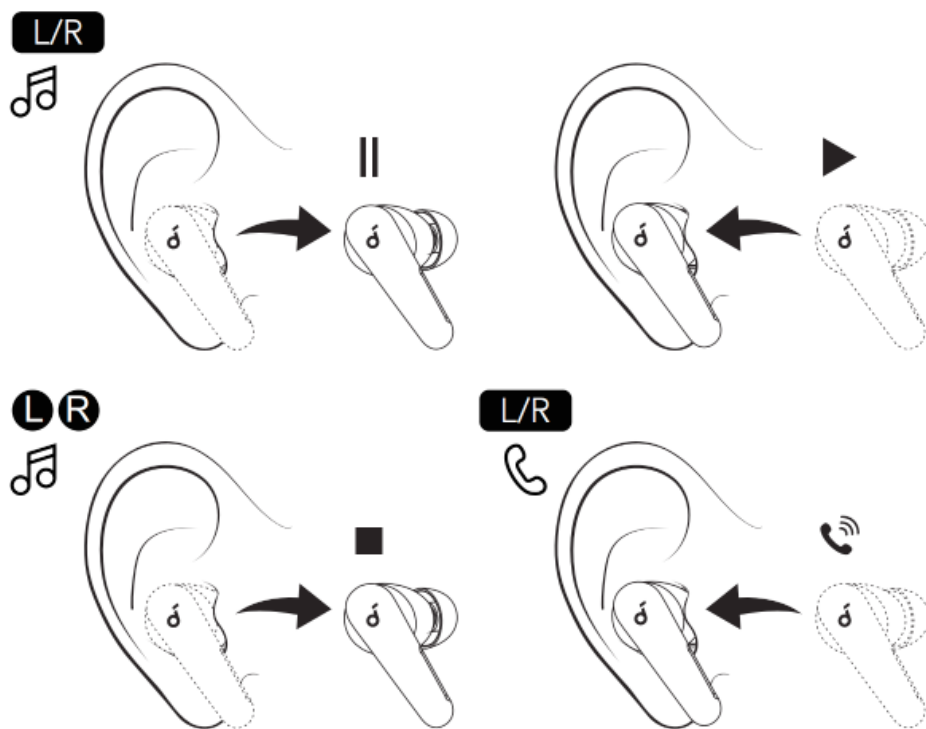

Playback will automatically pause when an earbud is removed and will resume again once you wear it. Wear either earbud to automatically answer an incoming call.

## 14. POWERING OFF

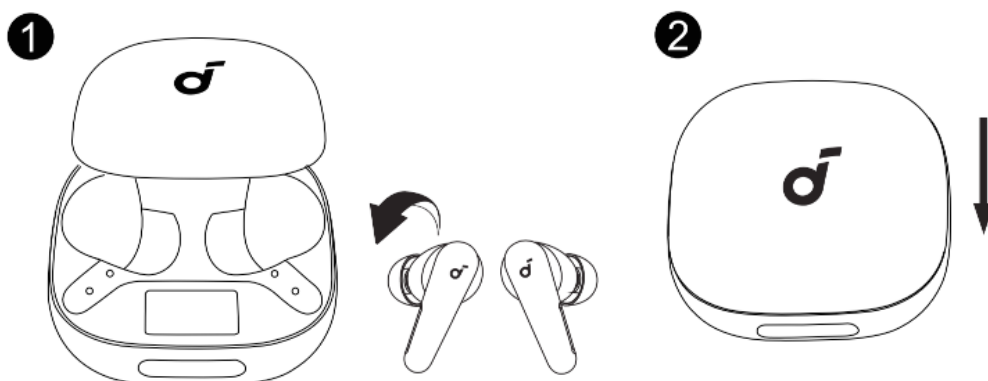

To power off, return the earbuds to the charging box and close it.

- When taken out, the earbuds will automatically power off after 30 minutes if they are not connected to any device. The duration can be set in the soundcore app.

## 15. RESET

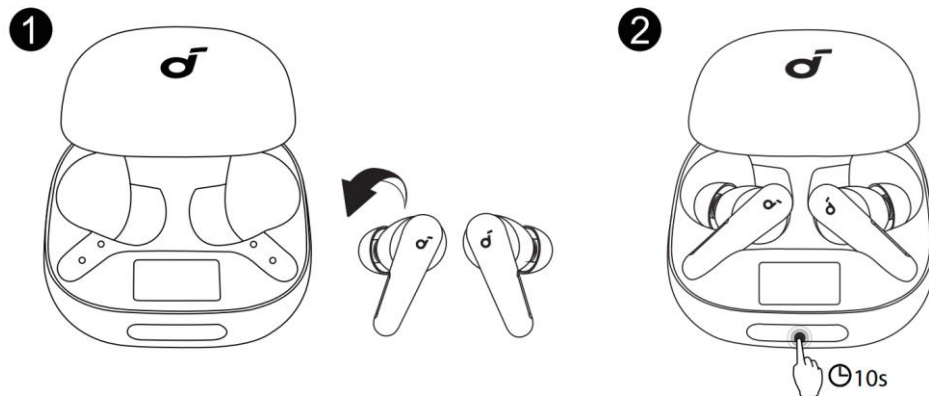

Reset if the earbuds have issues pairing with each other or with other devices.

Delete the pairing history from your Bluetooth device first. Place the earbuds in the charging box and leave the box open. Press and hold the touch bar of the charging box for 10 seconds until the Bluetooth connection indication reappears on the screen.

Upon a successful reset, the smart screen will briefly black out and then light up again. You will also hear a notification sound.

## 16. FIRMWARE UPDATE



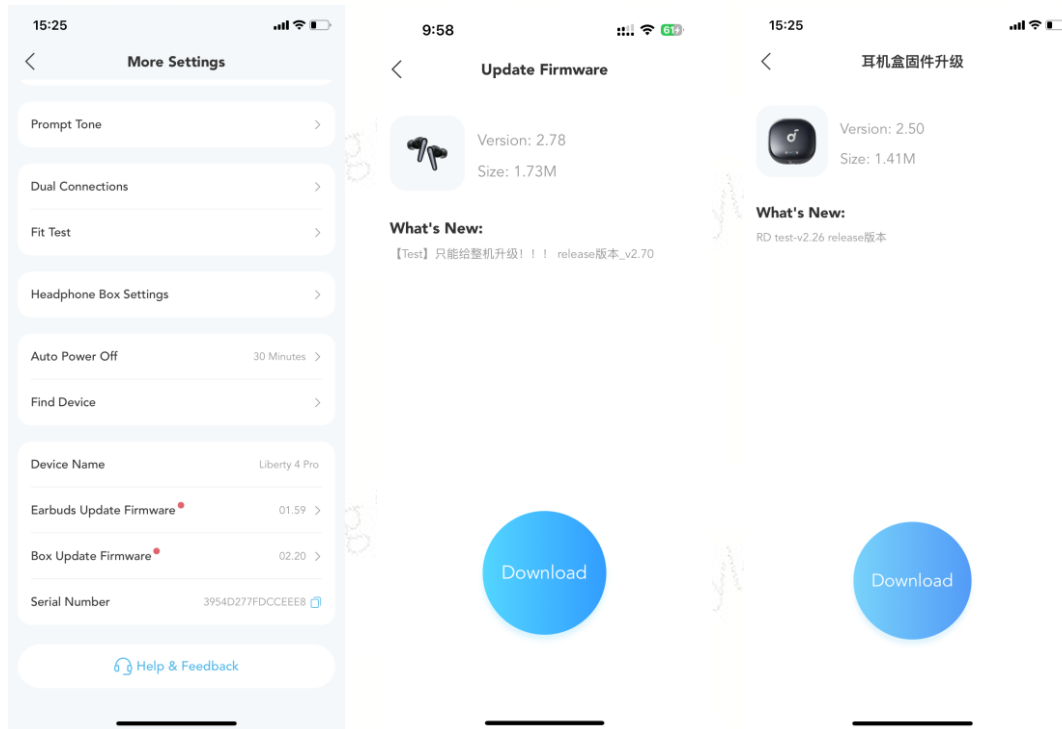

You will be informed once a new firmware version for the earbuds or charging box is detected when you connect the earbuds to the app. Ensure the earbuds are placed in the charging box and the box remains open until the firmware update is complete. During the update, ensure the earbuds are being charged and avoid any usage.

- Firmware update applies to both the earbuds and the charging box.

## 17. SPECS

Specifications are subject to change without notice.

Input	5V = 1A
Rated output power	20mW
Battery capacity	56mAh × 2 (Earbuds); 580mAh (Charging Box)
Charging time	Up to 40min (Earbuds) Up to 3 hours(Charging Box+Earbuds)

Playtime (with ANC off)	Up to 10 hours (40 hours in total with the charging box)
Playtime (with ANC on)	Up to 7.5 hours (30 hours in total with the charging box)
Driver unit	10.5mm + 4.6mm dynamic driver
Frequency response	14Hz - 40kHz
Impedance	15.3Ω+10.3Ω
Waterproof rating (earbuds)	IPX5
Bluetooth version	5.3
Bluetooth range	10m