

1 INSTALLING

1. Spread through the light strip straight and power on to test whether it lights normally.

Make sure to correctly connect the control box with the light strip.

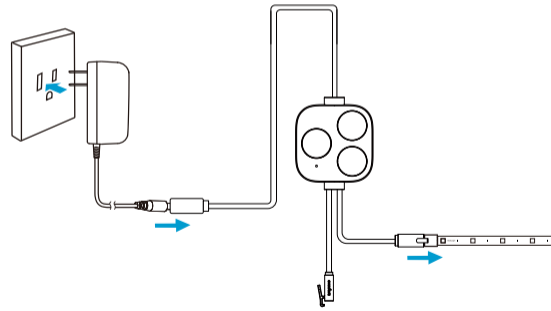

2

2. Choose a dry, clean and smooth surface and wipe off the dust with alcohol prep pads.



3. Tear off the adhesive tape and paste the light strip on the chosen surface immediately. Avoid bending on the LED beads.



4. Press firmly to remove the air between the light strip and the surface.



5. Use the provided clips and screws to reinforce it if necessary.



3

6. Connect to the power adapter and then the power supply.

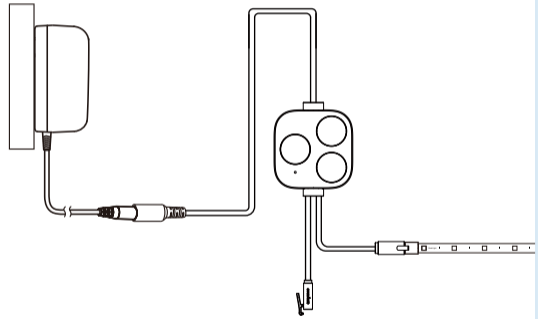

4 CONTROL BOX

Press to enter/exit PartyCast mode.

Press to switch light patterns.

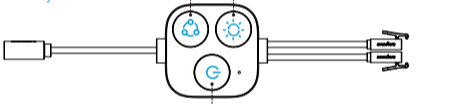

Press to power on or off.

5 APP SOUNDSCORE APP

Download the Soundcore app to enhance your experience.

- Check product information;
- Adjust and manage light patterns;
- Customize unique light effects;
- Enter PartyCast mode to sync with your PartyCast-enabled speakers;
- Bluetooth connection;
- Set the timer for the lights to automatically turn on and off.
- Upgrade firmware.



6 SPECIFICATIONS

Power adapter	Input: 100-240V~50/60Hz, 0.8A Output: 12V = 2A
Input	12V = 2A
Power consumption	24W
Length	10m/32.8ft
Bluetooth version	5.0
Bluetooth range	100m

For FAQs and more information, please visit :

[soundcore.com/support](https://www.soundcore.com/support)



@SoundcoreAudio



@soundcoreaudio



@soundcoreaudio

Important Safety Instructions

Read all the instructions before using the product, refer to the information on the exterior bottom enclosure for electrical and safety information before installing or operating the product.

- Store the product in a cool and dry place.
- Do not store the product in a hot or humid environment.
- This product should not be exposed to dripping or splashing or submerge in water.
- Keep out of the reach of children.
- Do not touch the product for a long time when powered on.
- Power off and unplug the adapter when not use for an extended period of time.
- Do not connect the rope light to the supply while it is in the packing or wound onto a reel.
- Do not use the rope light when covered or recessed into a surface.
- Keep away from any sharp objects. Do not open or cut or bend the rope light.
- Use of a power supply or charger not recommended or sold by the product manufacturer may result in a risk of fire or injury to persons.
- Operating temperature should be between 0°C to 40°C.
- Do not disassemble the product or make unauthorized alterations to the product; doing so may compromise safety, regulatory compliance, system performance, and may void the warranty.
- Do not leave or dispose of the product, including the batteries (battery pack or batteries installed) in both extremely low air pressure and extreme heat such as sunshine, fire, or the like.
- Do not clean the product with harmful chemicals or detergents.
- Misuse, dropping or excessive force may cause product damage.
- When disposing of secondary cells or batteries, keep cells or batteries of different electrochemical systems separate from each other.
- Be aware the discharged battery may cause fire or smoke, tape the terminals to insulate them.
- Do not subject the product to mechanical shock, crushing, or cutting.
- Do not short-circuit the product or be short-circuited by other metal objects.
- Do not use any cell or battery which is not designed for use with the equipment.
- Do not put fingers or hands into the product.
- Do not use the product in excess of its output rating. Overload outputs above rating may result in a risk of fire or injury to persons.
- Do not use the product that is damaged or modified. It may exhibit unpredictable behavior resulting in fire, explosion, or risk of injury.
- Do not connect the chain to the supply while it is in the packaging.
- Replace failed lamps immediately by lamps of the same type as delivered or of a type specified by the manufacturer.
- Have servicing performed by a qualified repair person using only identical replacement parts. Servicing is required when the apparatus has been damaged in any way: such as power supply or cord is damaged; liquid has been spilled or objects have fallen into the apparatus; the apparatus has been exposed to rain or moisture, does not operate normally, or has been dropped.

7

- Do not install this equipment near any heat sources or in a confined or building-in space such as a bookcase or similar unit, and remain in good ventilation conditions at an open site.
- Only suitable for safe use in areas below 2000m above sea level. Suitable for safe use in tropical and non-tropical areas.
- Attention should be drawn to the environmental aspects of battery disposal.
- Protect the power supply or cord from being walked on or pinched, particularly at plugs, convenience receptacles, and the point where they exit from the apparatus. Unplug this apparatus during lightning storms or when unused for long periods of time.

8

- Disposal of a battery into fire or a hot oven, or mechanically crushing or cutting of a battery, that can result in an explosion.
- Leaving a battery in an extremely high temperature surrounding environment that can result in an explosion or the leakage of flammable liquid or gas.
- A battery subjected to extremely low air pressure that may result in an explosion or the leakage of flammable liquid or gas.

WARNING: Use only power supplies/attachments/accessories specified by the manufacturer. Use only adapters below by Dong Guan Royal Intelligent Co.,Ltd. according to different area.
Model(s) for US & Canada: BI24G-120200-AdU
Model(s) for JP: BI24G-120200-AdJ

CAUTION: RISK OF EXPLOSION IF BATTERY IS REPLACED BY AN INCORRECT TYPE. DISPOSE OF USED BATTERIES ACCORDING TO THE INSTRUCTIONS.

- Do not touch the light strip when in mono-color mode. Doing so may lead to partially light off due to electrostatic discharge. You need to reset the light strip via the remote control or the control box. It is normal and within the expectation of the manufacturer.

 This product complies with the radio interference requirements of the European Community.

Declaration of Conformity

Hereby, Anker Innovations Limited declares that the product type A3561 is in compliance with Directives 2014/53/EU. The full text of the EU declaration of conformity is available at the following internet address: <https://www.soundcore.com/products>
Maximum output power: 11.63 dBm
Frequency band: 2.4G band (2.402GHz-2.480GHz)
Anker Innovations Limited
Room 1318-19, Hollywood Plaza, 610 Nathan Road, Mongkok, Kowloon, Hong Kong
Importers for EU and UK

9

ANKER TECHNOLOGY (UK) LTD
Suite B, Fairgate House, 205 Kings Road, Tyseley, Birmingham, B11 2AA, United Kingdom
Anker Innovations Deutschland GmbH
Georg-Muche-Strasse 3, 80807 Munich, Germany



Indoor use only.



This symbol means the product must not be discarded as household waste, and should be delivered to an appropriate collection facility for recycling. Follow local rules and never dispose of the product and rechargeable batteries with normal household waste. Correct disposal of old products and rechargeable batteries helps prevent negative consequences for the environment and human health.

GB Declaration of Conformity

This product complies with the radio interference requirements of the United Kingdom. Hereby, Anker Innovations Limited declares that the product type A3561 is in compliance with Radio Equipment Regulations 2017(RER 2017 (SI 2017/1206)). The full text of the UK declaration of conformity is available at the following internet address: <https://www.soundcore.com/products>

FCC Statement

NOTE: This equipment has been tested and found to comply with the limits for a Class B digital device, pursuant to part 15 of the FCC Rules. These limits are designed to provide reasonable protection against harmful interference in a residential installation. This equipment generates uses and can radiate radio frequency energy and, if not installed and used in accordance with the instructions, may cause harmful interference to radio communications. However, there is no guarantee that interference will not occur in a particular installation. If this equipment does cause harmful interference to radio or television reception, which can be determined by turning the equipment off and on, the user is encouraged to try to correct the interference by one or more of the following measures:
- Reorient or relocate the receiving antenna.
- Increase the separation between the equipment and receiver.

10

- Connect the equipment into an outlet on a circuit different from that to which the receiver is connected.
 - Consult the dealer or an experienced radio/TV technician for help
- Changes or modifications not expressly approved by the party responsible for compliance could void the user's authority to operate the equipment. This device complies with Part 15 of the FCC Rules. Operation is subject to the following two conditions:
(1) this device may not cause harmful interference, and (2) this device must accept any interference received, including interference that may cause undesired operation.
- RF Exposure Warning Statements:
This equipment complies with FCC radiation exposure limits set forth for an uncontrolled environment. This equipment shall be installed and operated with minimum distance 20cm between the radiator & body.
Company Name: Fantasia Trading LLC
Address: 5350 Ontario Mills Pkwy, Suite 100, Ontario, CA 91764
Telephone: +1 (800) 988 7973

This device contains licence-exempt transmitter(s)/receiver(s) that comply with Innovation, Science and Economic Development Canada's licence-exempt RSS(s). Operation is subject to the following two conditions:
(1) This device may not cause interference.
(2) This device must accept any interference, including interference that may cause undesired operation of the device.

L'émetteur/récepteur exempt de licence contenu dans le présent appareil est conforme aux CNR d'Innovation, Sciences et Développement économique Canada applicables aux appareils radio exempts de licence. L'exploitation est autorisée aux deux conditions suivantes :
(1) L' appareil ne doit pas produire de brouillage;
(2) L' appareil doit accepter tout brouillage radioélectrique subi, même si le brouillage est susceptible d' en compromettre le fonctionnement.

Radio Frequency Exposure Statement for IC
This equipment complies with IC exposure limits set forth for an uncontrolled environment. The device can be used in portable exposure conditions. This equipment shall be installed and operated with minimum distance 20cm between the radiator & body.
Cet équipement est conforme aux limites d'exposition IC établies pour un environnement non contrôlé. L'appareil peut être utilisé dans des conditions d'exposition portables. Cet équipement doit être installé et utilisé avec une distance minimale de 20 cm entre le radiateur et le corps.

11

12

13

14

15

16

17

18

19

20

21

22

23

24

25

26

27

28

29

30

31

32

33

34

35

36

37

38

39

40

41

42

43

44

45

46

47

48

49

50

51

52

53

54

55

56

57

58

59

60

61

62

63

64

65

66

67

68

69

70

71

72

73

74

75

76

77

78

79

80

81

82

83

84

85

86

87

88

89

90

91

92

93

94

95

96

97

98

99

100

101

102

103

104

105

106

107

108

109

110

111

112

113

114

115

116

117

118

119

120

121

122

123

124

125

126

127

128

129

130

131

132

133

134

135

136

137

138

139

140

141

142

143

144

145

146

147

148

149

150

151

152

153

154

155

156

157

158

159

160

161

162

163

164

165

166

167

168

169

170

171

172

173

174

175

176

177

178

179

180

181

182

183

184

185

186

187

188

189

190

191

192

193

194

195

196

197

198

199

200

201

202

203

204

205

206

207

208

209

210

211

212

213

214

215

216

217

218

219

220

221

222

223

224

225

226

227

228

229

230

231

232

233

234

235

236

237

238

239

240

241

242

243

244

245

246

247

248

249

250

251

252

253

254

255

256

257

258

259

260

261

262

263

264

265

266

267