

# Antenna Specification

Design Specifications	Typical	Units
天线形式 (Antenna Type)	WiFi: FPC GPS: Ceramics	
工作频率 (working Frequency)	WiFi: 2400-2500 GPS: 1559-1610	MHz
增益 ( Gain )	WiFi Max Gain: 2.85 GPS Max Gain: 2.73	dBi
天线效率 ( Antenna efficiency )	Refer to page 4&5	%
电压驻波比 ( VSWR )	Refer to page 3	
极化方式 (Polarization)	N/A	N/A
轴比 (Axial Ratio)	N/A	N/A
馈电阻抗 (impedance)	50 ohm	
天线尺寸 (Overall dimensions)	Refer to last page	mm
工作温度 (Operatin Temp)	-30 ----- 70	°C
储存温度 (Storing Temp)	-30 ----- 70	°C

---

WiFi Antenna Photo



GPS Antenna Photo

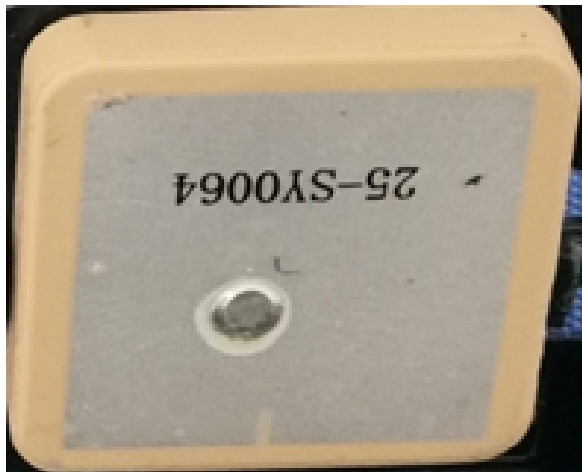

# 1. S11 参数(S11 Parameter)

## WIFI Antenna

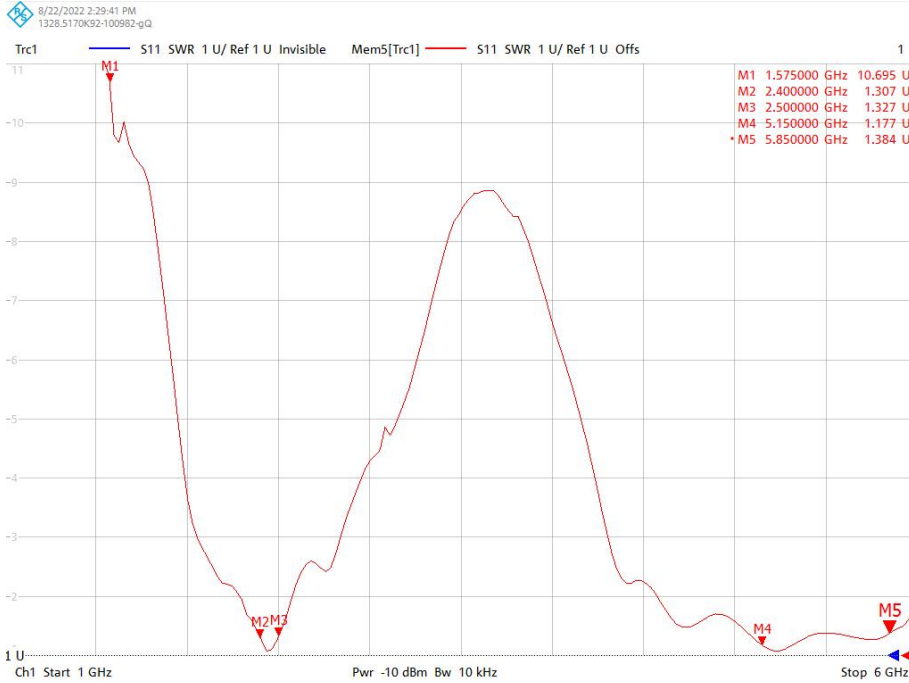

Main Antenna	
Freq. (MHz)	VSWR
2400	1.307
2500	1.327

## GPS Antenna

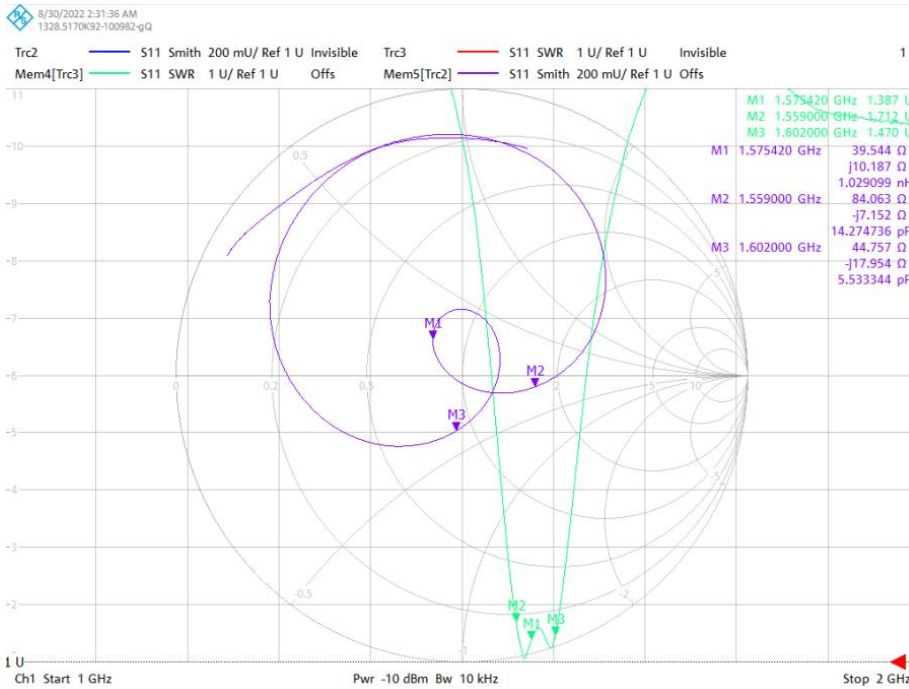

Main Antenna	
Freq. (MHz)	VSWR
1559	1.712
1575	1.387
1602	1.470

## 2. 无源测试数据 (Passive test data)

### WiFi Antenna Efficiency

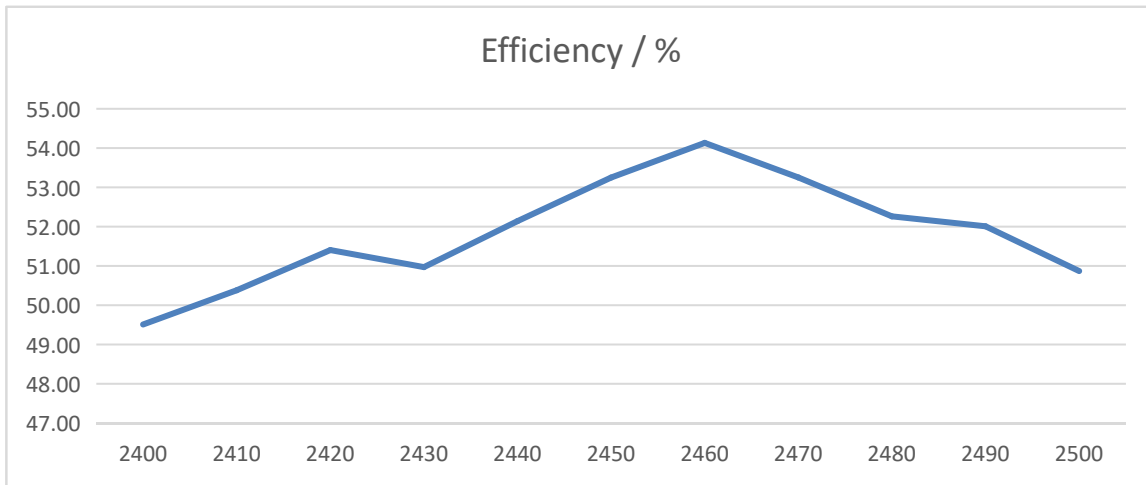

Freq. (MHz)	2400--2500		
	MIN	MAX	AVG
Effi (%)	50.11	55.13	52.78
Effi (dB)	-3.01	-2.59	-2.77

### WiFi Antenna Gain

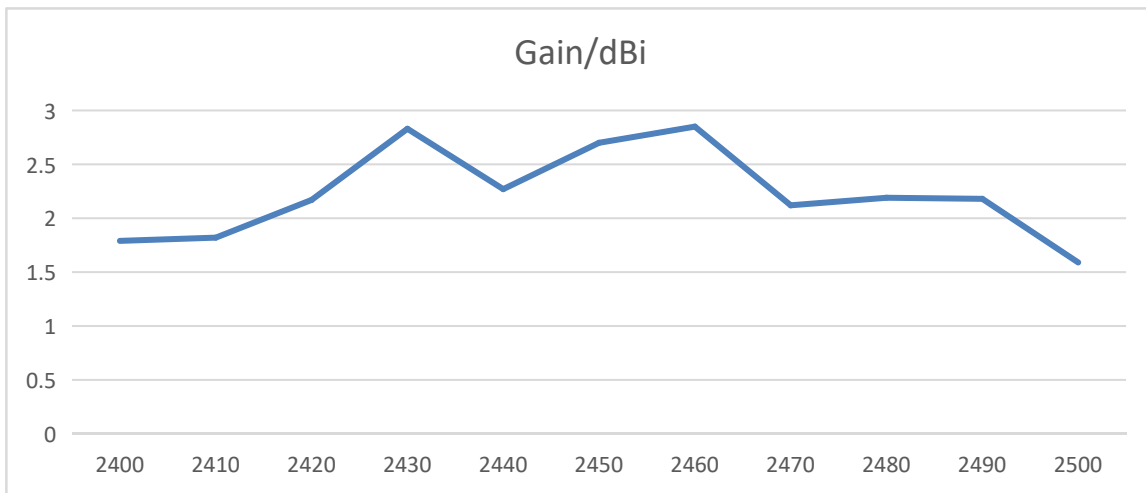

Freq. (MHz)	2400--2500		
	MIN	MAX	AVG
Gain (dBi)	1.59	2.85	2.23

## GPS Antenna Efficiency

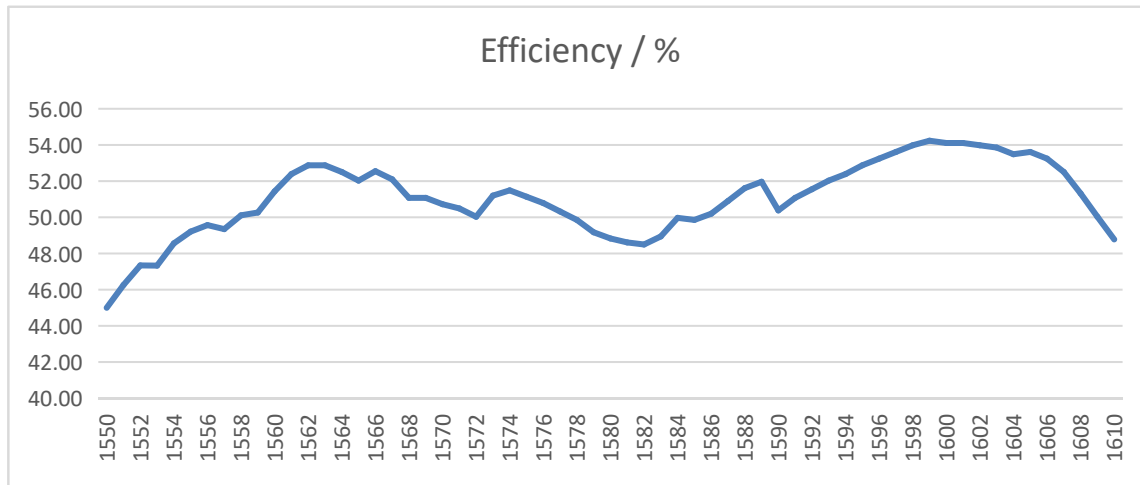

Freq. (MHz)	1559	1575.42	1602
Effi (%)	50.27	51.14	53.98
Effi (dB)	-2.99	-2.91	-2.68

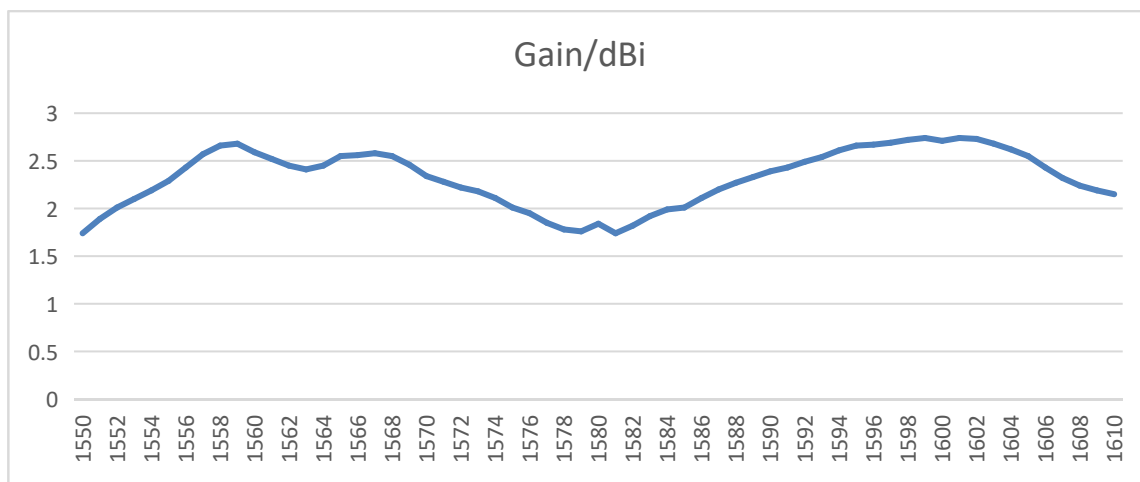

Freq. (MHz)	1559	1575.42	1602
Gain(dBi)	2.68	2.11	2.73

### 3. Radiation Pattern Plot

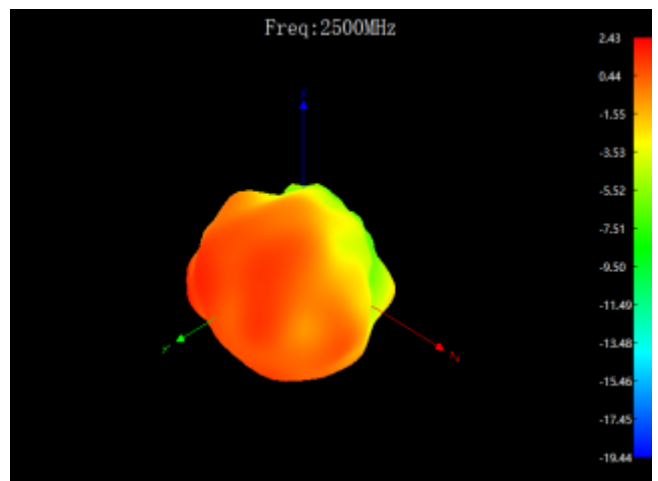
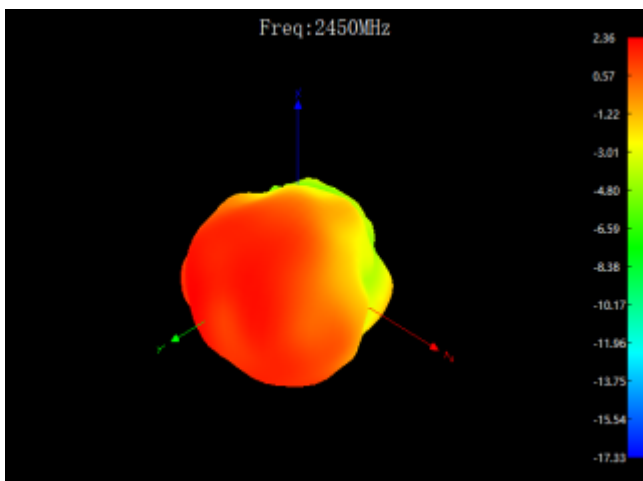
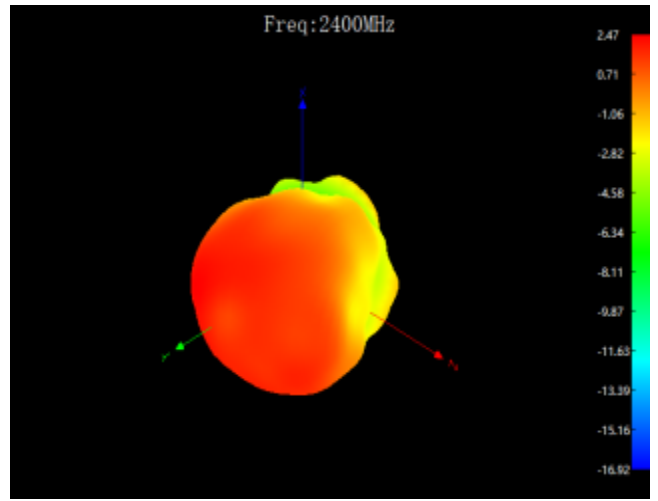
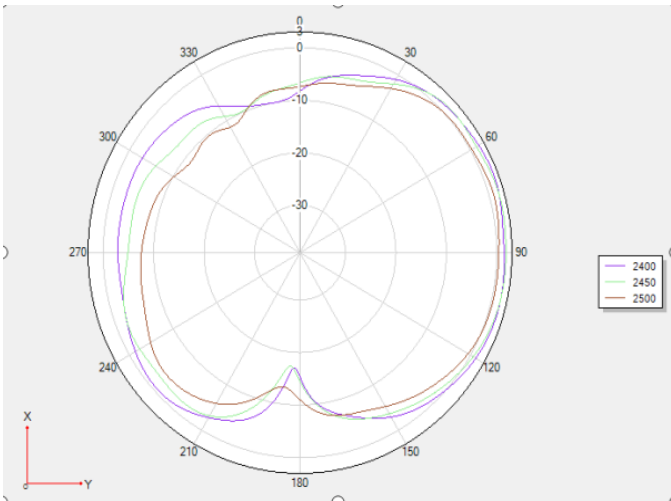
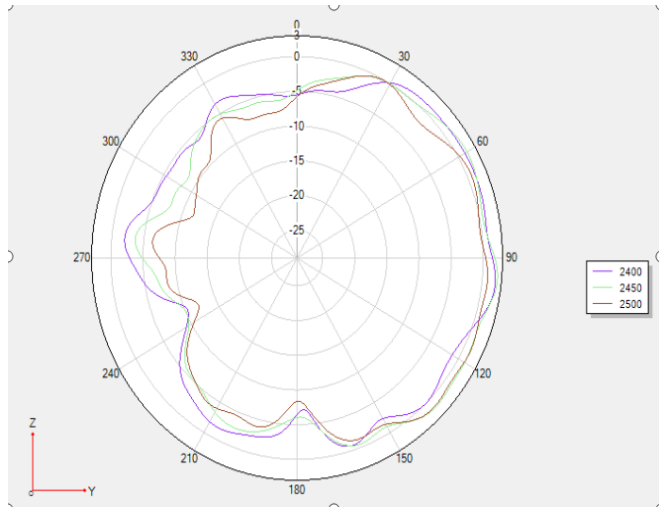
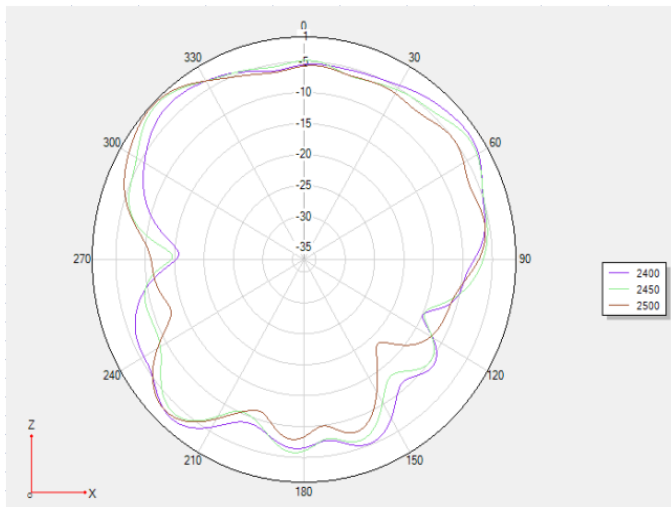

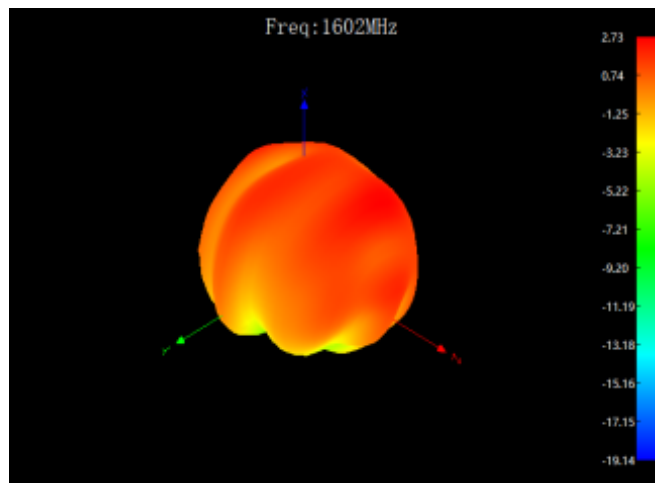
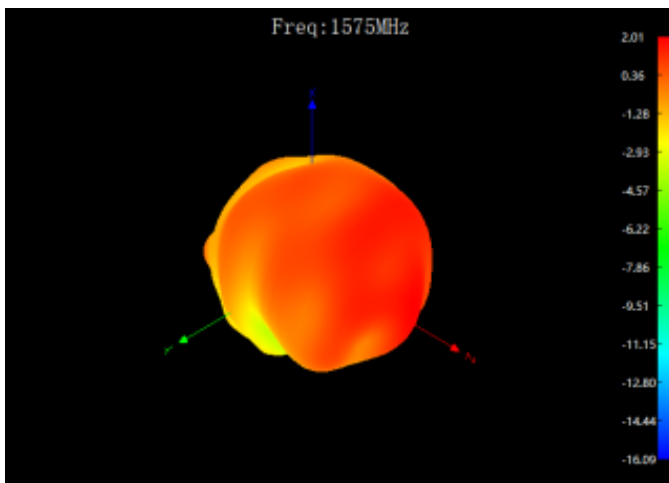
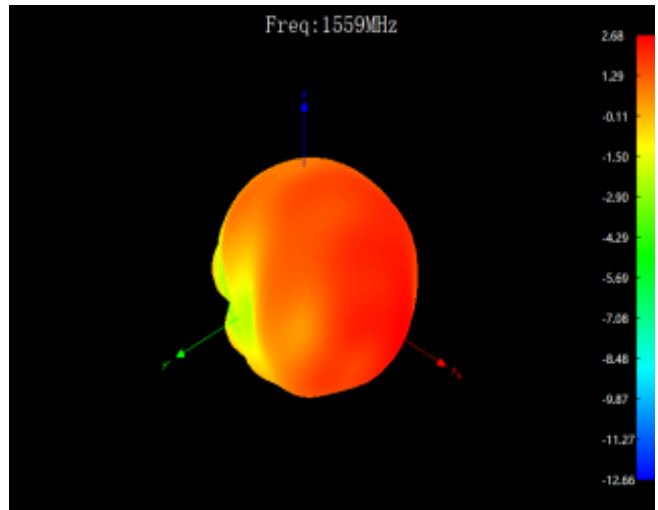
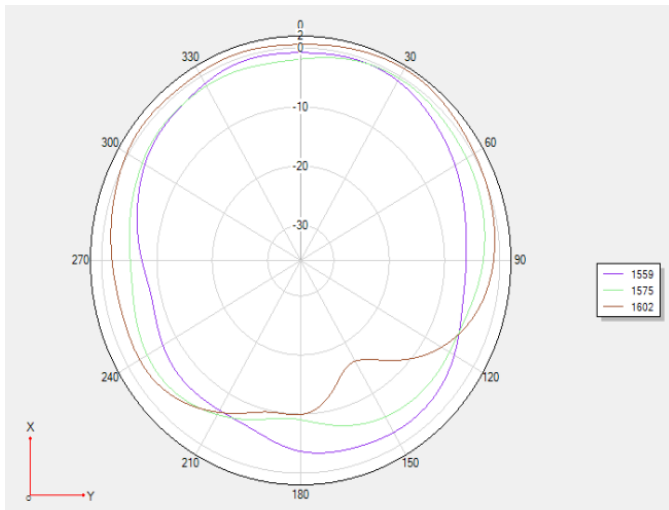
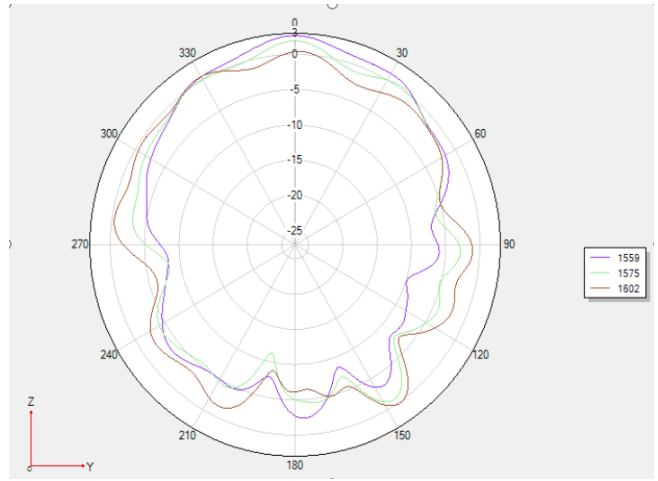
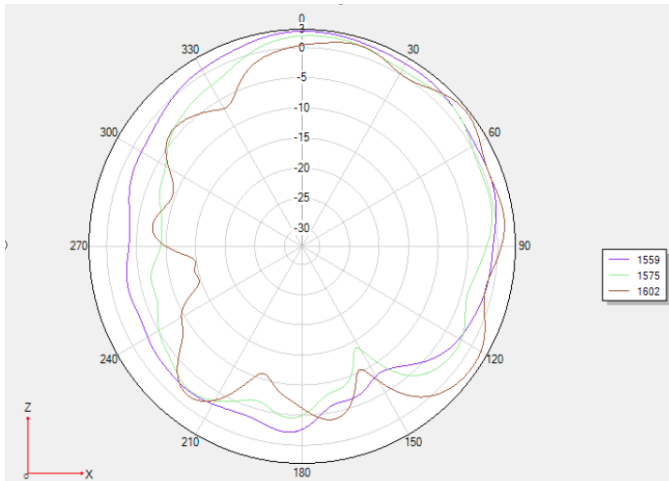

版本	修改内容	修改人	日期

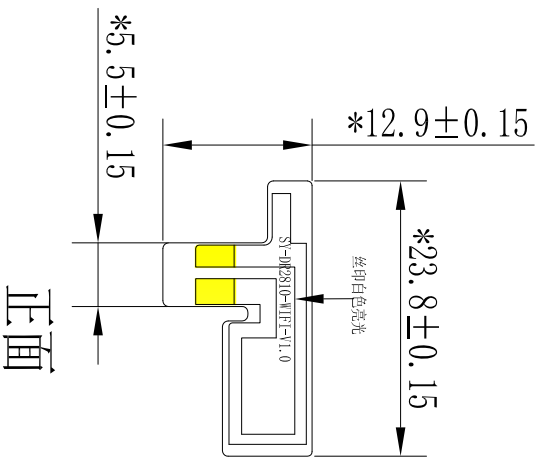

正面

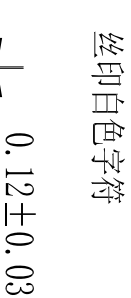

丝印白色字符

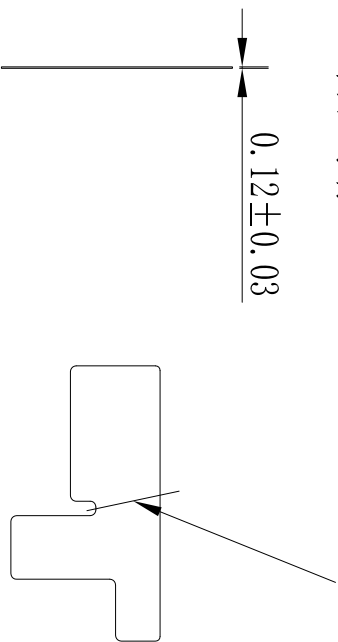

背胶切断线

背胶面

- 技术要求
1. 出货包装要求：（微黏膜包装出货）
  2. 铜泊表面涂黑/白色油墨；
  3. 油墨要均匀；
  4. 带"\*"符号尺寸为重点尺寸；
  5. 背胶用3M9471；
  6. 基材使用PI T=0.5Mil；
  7. 铜箔厚0.5oz；
  8. 镀金区域的镀金黄色厚度为0.5u"，盐雾测试过24H；
  9. 未注倒圆角均为0.2，工艺沿边为0.2mm；
  10. 未注公差按一般公差表；
  11. 产品符合RoHS2.0要求。

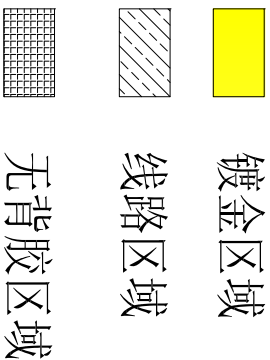

镀金区域

线路区域

无背胶区域

上海尚远通讯科技有限公司

TOLERANCE		PART NAME: WIFI天线 (DR2810)	
X.X ±0.20	PART NO: SH220761B75		DATE: 2022-10-10
.XX ±0.10	MATERIAL: FPC		DRAWN: zhangyuanfang
.XXX±0.05	FINISHING:		CHECKED: yujiang
ANGULAR ≤±0.5°	APPROVED:		
UNIT: mm	COLOUR: 黑色	SCALE: 1:1	REV: RA



版本			

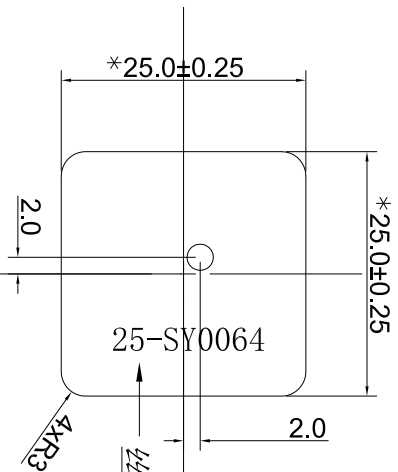

丝印黑色字体

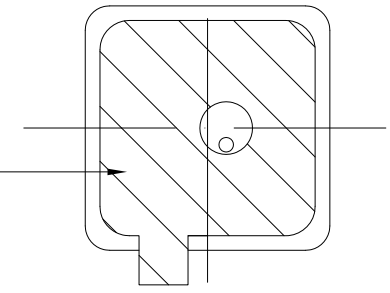

背胶3M9448A

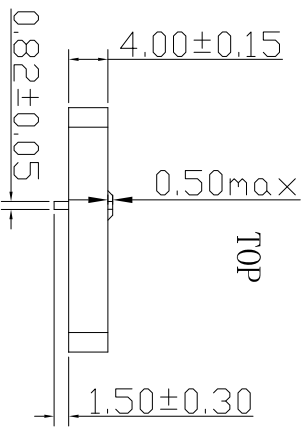

TOP

SIDE

未注明公差：±0.2mm  
单位：mm

- 注：
- 1、“打”★”为严格控制尺寸（必测等级A）
  - 2、“打”\*”为重要尺寸（制作模具要控制，模具验收必测等级B），其它为设计参考尺寸等级C；
  - 3、产品形状模具尺寸要严格控制；
  - 4、表面无油污，杂质，毛刺等；
  - 5、不经过守远公司确认，材料不能随意更改；
  - 6、包装方式为托盘真空包装

上海尚远通讯科技有限公司

		PART NAME :GPS天线 DR2801		DATE: 2022. 5. 11	
TOLERANCE X. X ±0. 25 . XX ±0. 15 . XXX±0. 05 ANGULAR ≤±0. 5°		PART NO : SH220761A93		DRAWN : zhangyuanfang	
UNIT : mm		MATERIAL :		CHECKED : yujiang	
COLOUR :		FINISHING :		APPROVED :	
SCALE : 1:1		REV : LS01			