

illumino  
WallMote 7  
ZWA022-A

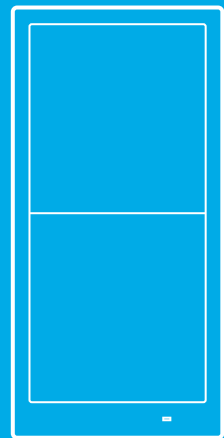

Used in this guide.

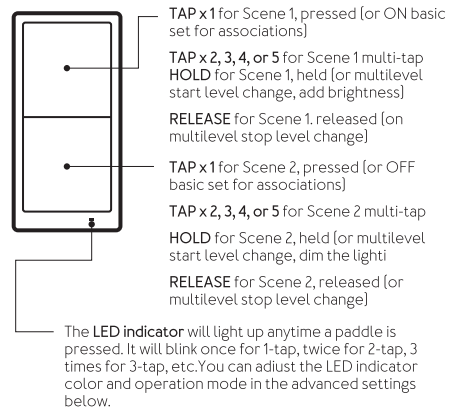
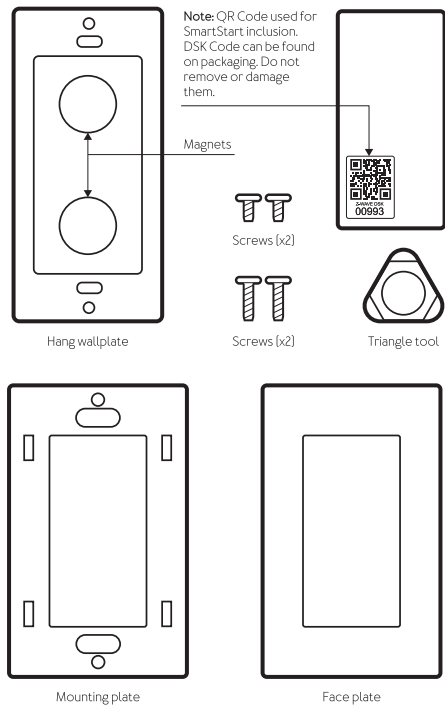

Important safety information.

Please read this and the online guide(s) at [support.aeotec.com/wallmote7](http://support.aeotec.com/wallmote7) carefully. Failure to follow the recommendations set forth by Aeotec Limited may be dangerous or cause a violation of the law. The manufacturer, importer, distributor, and / or reseller will not be held responsible for any loss or damage resulting from not following any instruction in this guide or in other materials.

illumino WallMote 7 is intended for indoor use in dry locations only. Do not use it in locations with direct water contact.

Contains small parts; keep away from children.

Power the device.

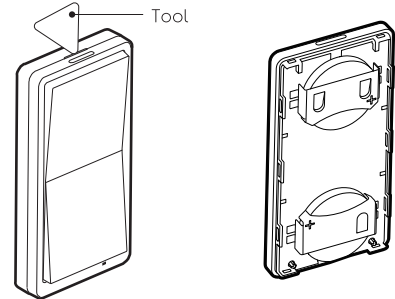

- Use the tool to open the remote, place the tool in and push in to separate the 2 halves.
- Remove the battery tabs
- Immediately your WallMote 7 should flash its LED to indicate it is powered.

Connect illumino WallMote 7 to a hub.

- If using **Aeotec AutoPilot**:
  - Select **Devices**.
  - Select **+ Add new**.
  - Select **+**.
  - Select **+ Add**.
  - Tap the top or bottom switch of illumino

- WallMote 7 once. The LED will flash a white LED while attempting to connect.
- If prompted by AutoPilot, enter the 5 digit DSK or scan WallMote 7's QR code.
- If using **Aeotec Smart Home Hub** or **SmartThings**:
    - Open **SmartThings** app.
    - Tap **+**.
    - Tap **Device**.
    - Find and select **Aeotec**.
    - Tap **Remote / button**.
    - Tap **Aeotec Wallmote**.
    - Tap **Start**, then follow the remaining instructions to pair illumino WallMote 7.
    - When prompted by your hub, **tap the top or bottom switch** of illumino WallMote 7 once. The LED will flash a white LED while attempting to connect.
    - If prompted, enter the 5 digit DSK if on browser or scan WallMote 7's QR code.
  - If using **Z-Stick Gen5** or **Z-Stick Gen5+**:
    - Unplug Z-Stick Gen5**, then **press it's Action Button** to put it into its 'add device' mode.
    - Tap the top or bottom switch of illumino WallMote 7 once. The LED will flash a white LED while attempting to connect.
  - SmartStart QR code scanning**:
    - If your Z-Wave gateway supports SmartStart you can scan the QR code on illumino WallMote 7 using the gateway's app. Your sensor will join your Z-Wave network automatically.
  - For most **other hubs**:
    - Set your Z-Wave hub to connect new Z-Wave devices.
    - Tap the top or bottom switch of illumino

- WallMote 7 once. The LED will flash a white LED while attempting to connect.
- If prompted, Scan the QR code or 5 digit DSK number on your WallMote 7.

Connection LED states.

If the connection steps were followed correctly, the LED will change from a flashing white to one of these LED states depending on success or failure.

- Success:** LED will be solid green LED for 2 seconds.
- Fail:** LED will be solid red LED for 2 seconds..

Not connecting? Try these steps;

- If possible move your hub or illumino WallMote 7 closer together.
- Set hub to remove Z-Wave Devices.
- Tap top or bottom WallMote 7 6x times within 2 seconds.
- The LED will blink purple to indicate it is attempting to remove itself.
  - If successful, the LED will fade in and out to indicate it is ready to be connected to a new hub.
- Try connecting illumino WallMote 7 again.
- Get further help and tutorials at [help.aeotec.com](http://help.aeotec.com)

Install on a wall.

You may use adhesives or screws when affixing WallMote 7 directly to your wall if you are installing WallMote 7 in an area without an available gangbox.

A. Using Adhesives.

- Peel off the adhesive protective sheet located on the back of the Hang wallplate.
- Apply pressure to the wall in the desired installation location for 5 seconds.
- Grab a screwdriver and 2 small screws, and then screw the Mounting Plate into the Hang wallplate.
- Place the Face plate over the Hang wallplate and Hang Plate.
- Place WallMote 7 into the center.

B. Using Screws.

- Place WallMote 7 plate against the area you wish to install it.
- Using a pencil, create 2 markings within the inner holes of the Hang wallplate. Then place the Hang wallplate to the side.
- Use a small drill bit, drill a small hole into the middle of your pencil markings.
- Grab a screwdriver, 2 long screws, and Hang wallplate; then screw the Hang wallplate over the 2 inner drilled holes.
- Grab the 2 small screws and screw the Mounting Plate into the Wall Plate.
- Place the Face plate over the Hang wallplate and Mounting plate.
- Place WallMote 7 into the center.

## Install in a gang box.

Using WallMote 7's mounting plate, it's possible to install it within a single or multiple gang box. This is achieved by affixing the Mounting plate to the Hang wallplate, and then screwing them into the gang box utilising the inner screw holes. For a detailed step-by-step guide, visit [support.aeotec.com/wallmote7](http://support.aeotec.com/wallmote7).

## Using your illumino WallMote 7:

Scan these QR Codes to get more help on how to use illumino WallMote 7 with these specific hubs.



AutoPilot



Smart Home Hub / SmartThings



Home Assistant

## Need more assistance with a specific hub?

Scan this QR code or visit [help.aeotec.com](http://help.aeotec.com) to get more help with hubs and software including Home Assistant, Hubitat, and SmartThings



Don't see what you need? Contact us.

## Need help? Contact us.

Contact our support teams at [aeotec.com/support](http://aeotec.com/support).

## Having trouble?

- Can't add WallMote 7 to your hub?
  - Try power cycling your WallMote 7, remove both batteries for 6 minutes, then re-insert both batteries.
  - Try removing your WallMote 7, these steps can be carried out even if it isn't paired.
  - Try moving your WallMote 7 closer to your hub for its connection/pair process.

## Gateway compatibility.

To see if your remote is known to be compatible with your Z-Wave gateway, please refer to [support.aeotec.com/compat](http://support.aeotec.com/compat).

Manufactured for the importer by Aeotec Limited [#704, Bright Way Tower, 33 Mong Kok Rd, Mong Kok, Hong Kong] contactable via [aeotec.com/contact](http://aeotec.com/contact). Imported into the European Union by Aeotec Group GmbH [Große Johannisstraße 7, Hamburg 20457, Germany]. The importer and / or distributor of this device can both be reached separately with the company from whom you have purchased this device from responsible for warranty, technical support, and compliance related queries.

IOT Holdings, LLC, dba Aeotec Americas, is the exclusive licensee for Aeotec products in North America. All products sold by Aeotec Americas through and to their authorized resellers in the United States are also covered by one or more claims of patents: <http://sipcollc.com/patent-list/>

All rights reserved.

**Disposal guidelines and WEEE.** Aeotec devices may contain batteries; remove when not in use. Do not dispose of device as unsorted municipal waste, use separate collection facilities. Contact your local government for further information.

**One-Year Limited Warranty.** Aeotec Limited warrants included Aeotec branded hardware device when purchased new and delivered in new condition and in its original container against defects in materials and workmanship for one year from the date of original purchase from an authorized reseller when purchased and used in the region of original export. In line with the terms of sales between Aeotec and the authorized importer / reseller of this device, any claims against the foregoing warranty are to be handled by the authorized distributor / reseller directly. The foregoing warranty is subject to the proper installation, operation, and maintenance of the device in accordance with installation instructions and the operating manual supplied to customer and further documentation made available digitally. Liquid damage, including, but not limited to, internal liquid damage caused by improper use, closure or affixing of the hardware, is not covered by this warranty. Splash, water, and dust resistance are not permanent conditions and resistance might decrease as a result of normal wear. Not warranted for damage from open flames and heat, and exposure to sun. Not warranted for battery

leak damage; always remove all batteries from products that not being used. Aeotec does not warrant against normal wear and tear, nor damage caused by accident or abuse. Please be sure to read this device's support notes, digital materials, and quick start guide fully. Subject to the full terms of obtaining service within 30 days of the manifestation of a problem, if you submit a valid claim under this warranty, Aeotec shall provide further information in obtaining warranty services from the authorized importer and / or seller of this device. The full warranty, including warranty exclusions and liabilities, are available at [support.aeotec.com/warranty](http://support.aeotec.com/warranty) Aeotec's English language warranty and instructional information is paramount to translations provided in any other language and prevails over any such translations.

**FCC Notice.** The edition of this device made and certified for the US market and marked as such complies with part 15 of the FCC rules. Operation is subject to the following two conditions: [1] this device may not cause harmful interference, and [2] this device must accept any interference received, including interference that may cause undesired operation. The manufacturer is not responsible for any radio or TV interference caused by unauthorized modifications to this equipment. Such modifications could void the user's authority to operate the equipment. This equipment has been tested and found to comply with the limits for a Class B digital device, pursuant to part 15 of the FCC Rules. These limits are designed to provide reasonable protection against harmful interference in a residential installation. This equipment generates uses and can radiate radio frequency energy and, if not installed and used in accordance with the instructions, may cause harmful interference to radio communications. However, there is no guarantee that interference will not occur in a particular installation. If this equipment does cause harmful interference to radio or television reception, which can be determined by turning the equipment off and on, the user is encouraged to try to correct the interference by one or more of the following measures: [1] Reorient or relocate the receiving antenna. [2] Increase the separation between the equipment and receiver. [3] Connect the equipment into an outlet on a circuit different from that to which the receiver is connected. [4] Consult the dealer or an experienced radio/TV technician for help [5] Ensure this device and its antenna(s) are not co-located or operating in conjunction with any other antenna or transmitter.

**RF Exposure Statement.** The device has been evaluated to meet FCC / CE general RF exposure requirement. The device can be used without restriction.

**California Proposition 65. WARNING:** This product contains a chemical known to the State of California to cause birth defects or other reproductive harm. Use only for intended purposes. Do not use for other purposes including, but not limited to, the consumption of food and drinks.

**Specifications.** Z-Wave devices operate between 908.42 MHz depending on local restrictions. It uses up to -10.45dBm ERP transmit power, enabling wireless connectivity. Full information on device specifications and certifications at [support.aeotec.com/wallmote7/specs](http://support.aeotec.com/wallmote7/specs)

While the information in this guide has been compiled with care, it may not be deemed an assurance of device characteristics. All information, including, but not limited to, information regarding the functionality, features, and / or device specifications are subject to change. Aeotec Limited reserves all rights to revise or update its products or documentation without any obligation to notify any individual or entity. Aeotec Limited shall be liable only to the degree specified in the terms of sale and delivery.



FCC ID: 2AOGIZWA037



© & ™ Aeotec Limited.

Version: AL501002200001 - AA

Aeotec is a ® Registered Trademark of Aeotec Limited amongst other intellectual property. A non-exhaustive list can be found at [aeotec.com/legal](http://aeotec.com/legal). All rights reserved. Z-Wave is a ® Registered Trademark of Aeotec Group GmbH and / or its subsidiaries. All rights reserved. Aeotec Americas operates under exclusive license from Aeotec Limited. Aeotec Limited is the owner of Aeotec, the Aeotec logo, and a number of other patents and trademarks utilised by products distributed by Aeotec Americas. Products and services offered by Aeotec Americas which utilise wireless communications technology may be covered by one or more claims of patents viewable at <http://sipcollc.com/patent-list/> and <http://intusiq.com/patent-list/>

In Europe, contact Aeotec via Aeotec Group GmbH; Große Johannisstraße 7, 20457 Hamburg, Germany

Aeotec

✉ [service@aeotec.com](mailto:service@aeotec.com)

@ [www.aeotec.com](http://www.aeotec.com)