

FCC

The devices comply with part 15 of the FCC Rules. Operations subject to the following two conditions :
(1) The devices maynot cause harmful interference , and
(2) the devices must accept any interference received, including interference that may cause undesired operation .
The equipments have been tested and found to comply with the limits for a Class B digital devicpursuant to part 15 of the FCC Rules . These limits are designed to provide reasonable protection against harmful interferencein a residential installation . The equipments generate,use and can radiate radio frequency energy and , if not installed and used in accordance with the instructions , may causeharmful interference to radio communications . However there is no guaranteee that interference will not occur in a particular installation. If the equipments do cause harmful interference to radio or television reception , which can be determined by turning the equipments off and on , the user is encouraged to try to correct the interference by one or more of the following measuress: Reorient or relocate the receiving antenna. Increase the separation between the equipments and receiver. Connect the equipment into an outlet on a circuit different from that to which the receiver is connected. Consult the dealer or an experienced radio / TV technician for help.
CAUTION : To comply with the limits of the Class B digital device,pursuant to Part 15 of the FCC Rules , the devices must be used with certified peripherals and shielded cables . All peripherals must be shielded and grounded . Operation with non-certified peripherals or non-shielded cables may result in interference to radio or reception.
Caution : Any changes or modifications not expressly approved by the party responsible for compliance could void the users authority to operate the equipment .

3 in 1 Wireless Charging Stand

USER MANUAL | Model: C3

Preface

Dear users, thank you for purchasing CYSPO products.In order to further understand the product, please read this manual carefully before use.Wish you a pleasant experience.

Product Details

• Charging stand

- Magnetic charging output
- Watch output
- Earphone output
- Indicator lamp
- USB-C interface

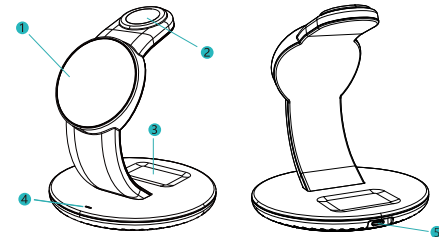

• USB-C Charging Cable



Instructions for use

- Power connected ,the device enters the standby state;
- Put the mobile phone that supports wireless charging on the corresponding charging area for wireless charging;
- Place the Apple Watch in the Magetic charging area to conduct wireless charging;
- Put the earphone that supports wireless charging on the corresponding charging area for wireless charging;

Indicator light description

- When power connected , the green indicator lights up for 2 seconds and then off and enters the standby state;
- When charging the device, the indicator light flashes for three times and then goes off to enter the charging state;
- When the device is fully charged, the indicator light is off;
- When the wireless charging output is abnormal or a foreign body is detected, the green indicator light will continue to blink;

How to solve abnormal charging

- Please confirm whether your mobile phone has wireless charging function before use;
- Check whether the phone deviates from the wireless inductive charging area of the charger;
- Whether a non-metallic protective case is used for charging mobile phones, and the thickness of the protective case is recommended not to exceed 4mm;
- When metal objects touch the charging area, the charger will automatically identify and provide power off protection;
- When the temperature of the charger is too high, it will automatically start the protection.Please unplug the power supply first and use it after the charger recovers the temperature;

Q & A

- Q:Why is there heating in the charging of wireless charging inductive products?
A:During the charging process, there will be a certain loss of magnetoelectric conversion, which will be converted into heat, causing the mobile phone and charger to generate heat, which is a normal phenomenon;
Suggestions:
• When the device is fully charged, disconnect it from charging in time to avoid a long cycle of charging, which may lead to continuous heating of the device and charger;
• It is recommended to stop running the background software when charging the phone;

Safety Notes

- Use indoor or under dry environment, avoid placing or using in the environment of high temperature, humidity, strong static electricity and strong magnetic field;
- For your safety, please do not use wet hand plug and unplug electrical appliances;
- Avoid putting it in a place easily accessible to infants and children;
- Do not use the product if it is contaminated with water or dirt;
- Non-professional personnel are not allowed to open and repair without authorization;

Specifications

- Input interface: USB-C
- Input: 9V=3A 12V=2A
- Magnetic charging output: 15W Max
- Watch output: 3W Max
- Earphone output: 5W Max
- Size: 141*123*123MM

Package Contents

- Wireless charger x1
- Cable x1
- User manual x1