

89 mm

152 mm

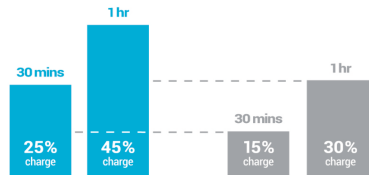

COMPACT WIRELESS CHARGER CONNECTS TO LAPTOPS AND POWER BANKS



TYLT
Full charge in 2 hrs 45 mins*

OTHERS
Full charge in 4 hrs 5 mins

wireless charging pad

Charges Qi devices up to 10W • FAST charges compatible Apple and Samsung devices up to 2x faster • Plugs into any Type-C port • Thin low profile • Works through most cases and covers • Built-in 2" cable

TYLT has partnered with One Tree Planted to help with reforestation efforts across the world. To learn more, visit www.tylt.com/cares

Includes:
Medallion

Made For:
Wireless Qi Compatible Devices
iPhone 8, 8 Plus, X, Xs, Xs Max, Xr, 11, 11 Pro, 11 Pro Max
AirPods*, AirPods Pro™
Samsung Galaxy S9, S9+, Note9, S10, S10+, Note10, Note10+

* Requires a 18W USB-C port. Charge time may vary. Charging data shown depends on the device, device capabilities, phone usage at the time of charging, ambient temperature and when plugged into the wall.



WARNING: Batteries, battery posts, battery terminals, and related accessories can expose you to chemicals including lead and lead compounds, which are known to the State of California to cause cancer and birth defects or other reproductive harm. For more information go to www.P65Warnings.ca.gov.

Limited 1 year warranty. To receive a free 1 year warranty extension (2 years total), register your product at: www.tylt.com/warranty
iPhone, AirPods and AirPods Pro are trademarks of Apple Inc., registered in the U.S. and other countries.
Samsung is a trademark of Samsung Electronics Co, Ltd. Other marks are the property of their respective owners.
© 2020 Tylt. Tylt and the logo are trademarks of Tylt Inc. Made in China. Designed in the U.S.A. in Simi Valley, CA.
PB0497

TYLT



QIMEDBK-T



152 mm

89 mm

TYLT

+ / medallion

Wireless Charging Pad

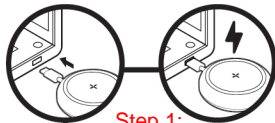

Step 1:
Take out the folding cable and
connect it to the computer

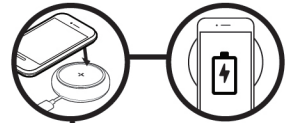
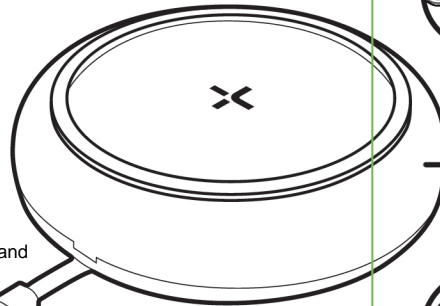
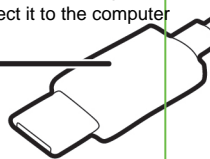
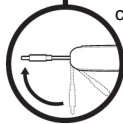

Step 2:
Place the charging device in
the charging area for charging

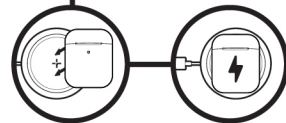

152 mm

89 mm

FCC Statement

This device complies with Part 15 of the FCC rules.

Operation is subject to the following two conditions:

- 1) this device may not cause harmful interference, and
- 2) this device must accept any interference received, including interference that may cause undesired operation.

Note: This equipment has been tested and found to comply with the limits for a Class B digital device, pursuant to part 15 of the FCC Rules. These limits are designed to provide reasonable protection against harmful interference in a residential installation. This equipment generates uses and can radiate radio frequency energy and, if not installed and used in accordance with the instructions, may cause harmful interference to radio communications. However, there is no guarantee that interference will not occur in particular installation. If this equipment does cause harmful interference to radio or television reception, which can be determined by turning the equipment off and on, the user is encouraged to try to correct the interference by one or more of the following measures:

- Reorient or relocate the receiving antenna.
- Increase the separation between the equipment and receiver.
- Connect the equipment into an outlet on a circuit different

from that to which the receiver is connected.

--Consult the dealer or an experienced radio/TV technician for help.

Changes or modifications not expressly approved by the party responsible for compliance could void the user's authority to operate the equipment.

Radiation Exposure Statement

This equipment complies with FCC radiation exposure limits set forth for an uncontrolled environment. This equipment should be installed and operated with minimum distance of 20 cm between the radiator & your body.