

Ankee smart lighting

Ankee USA, Inc.

Logo

Ankeepprimary bulb is the bulb with white ring. It can be controled by the wall light switch, the Ankee dimming remote or Google/Amazon Alexa speaker. Other bulbs with silver rings perform after the Ankee primary bulb.

To connect your new Ankee primary bulb, select the installation instruction (A or B) which is applicable to you. You can go to [www. ankeesmart.com](http://www.ankeesmart.com) or www.youtube.com (search Ankee smart lighting/Ankee bulbs) to learn more about the installation and the products.

- (A) 1. Power your Ankee bulbs and turn off your wall light switch.
2. Press and hold the “ON/OFF” button for 10 seconds until the red light of the Ankee dimming remote flashes.
3. Turn on your wall light switch and wait for 5-10 seconds.
4. Now you can use the Ankee dimming remote to control your Ankee bulbs.

- (B) 1. Download “Ankee app” from Apple App Store or Google Play Store. Power your Ankee bulbs and turn off your wall light switch.
2. Open Ankee app, then click”Add New Device”

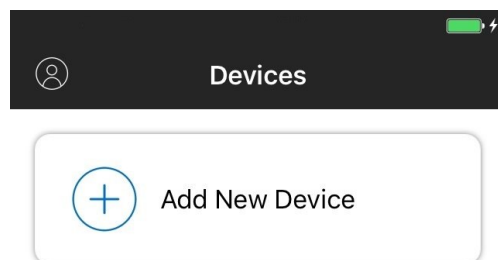

3. In the setup mode, press and hold both “+” and “ON/OFF” buttons on the Ankee dimming remote until the Ankee bulbs flash. Click “NEXT”

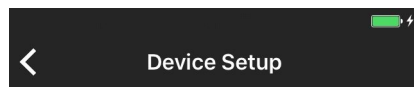

Enter setup mode

Press and hold both “+” and “on/off” buttons on the remote until the light bulb flashes.

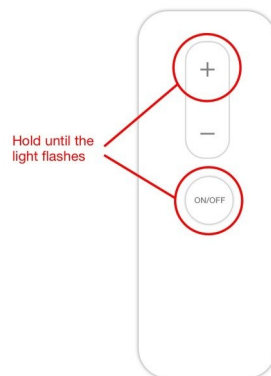

Next

4. To connect your Ankee bulbs to your phone, go to the wifi setting on your phone, click and connect “ANKEE_XXXX” to wifi.

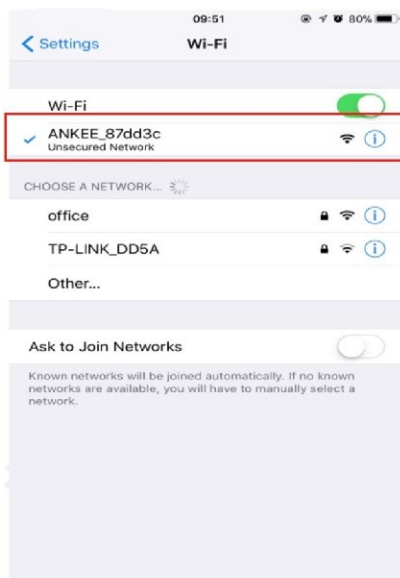

5. Go back to Ankee app, click “Next”.

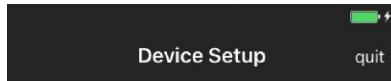

Connect your device

Go to Wi-Fi setting on your phone and connect to a Wi-Fi network that begins with "ANKEE".



Once connected, go back to this app to continue the setup.

Previous

Next

6. To connect your Ankee bulbs to wifi, enter your wifi account name and password, then click "NEXT".

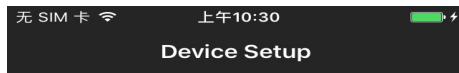

Connect your device to Wi-Fi

Please enter the name and the password of your Wi-Fi network.

NOTE: The device is only compatible with a 2.4G Wi-Fi. If your router supports both 5G and 2.4G. Please make sure that you are **NOT connecting your device to the 5G Wi-Fi.**

show password

Previous

Next

7. You can rename your bulb when the setup is successful. To finish the setup, click "COMPLETE".



Setup successful!

ANKEE_87823c is now connected to your Wi-Fi. It is now added to your device list. We recommend you to rename your device.

Your device name should be recognizable for voice controls.

ANKEE_87823c

Good Naming ✓ Bad Naming ✗

• bedroom light
• bedroomlight
• bedroom light
• bedroom light
• bedroom LIGHT



8. Click the bulb name to adjust the brightness of the bulb.

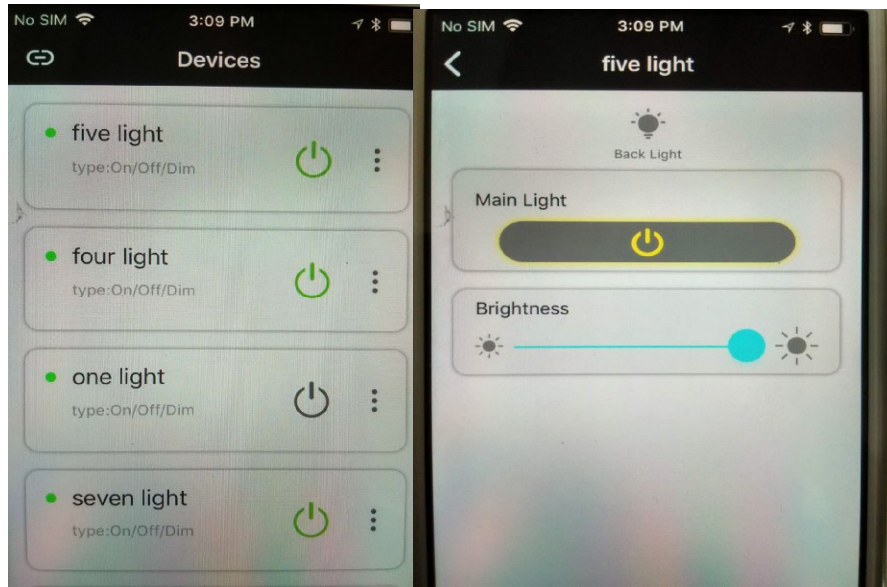

account linking setup

1. If you want to share the Ankee bulbs setup to other user, click personal setting(人头图案) and go to the account linking mode.
2. The new user need to download Ankee app first, then click personal setting(人头图案) and go to the account linking mode.
3. Click “Scan Account” from the new user, then scan the QR code on your account linking page.
4. The new user will get the same link code as yours. Now both of you can control the Ankee bulbs by Ankee app.

反面第 1-3 页西班牙文说明书。

反面第 4 页 写认证，注意事项，质保，清洗事项。

Please go to www.ankeesmart.com to learn more about Ankee bulbs or search “Ankee smart lighting” or “Ankee bulbs” on www.youtube.com for user instruction.

Certification:



- I This device is not a toy for children.
- I Only install in operating environments between -10C 摄氏度符号 and +40C 摄氏度符号
- I Do not clean the device when it is on and connected to the power supply. To avoid scratching device, clean only with a soft dry cloth. Do not use cleaning agents to clean the device.

Ankee warrants that this device will be free from defects in material and workmanship and will operate for 5 years based on up to 3 hours average usage per day/7 days per week, when used as directed. If the device does not conform to the warranty, Ankee will send you, at its election, a replacement device or refund your original purchase price upon receipt of the returned device, register receipt and proof of purchase.

FCC Caution:

This device complies with part 15 of the FCC Rules. Operation is subject to the following two conditions: (1) This device may not cause harmful interference, and (2) this device must accept any interference received, including interference that may cause undesired operation.

Any Changes or modifications not expressly approved by the party responsible for compliance could void the user's authority to operate the equipment.

Note: This equipment has been tested and found to comply with the limits for a Class B digital device, pursuant to part 15 of the FCC Rules. These limits are designed to provide reasonable protection against harmful interference in a residential installation. This equipment generates uses and can radiate radio frequency energy and, if not installed and used in accordance with the instructions, may cause harmful interference to radio communications. However, there is no guarantee that interference will not occur in a particular installation. If this equipment does cause harmful interference to radio or television reception, which can be determined by turning the equipment off and on, the user is encouraged to try to correct the interference by one or more of the following measures:

- Reorient or relocate the receiving antenna.
- Increase the separation between the equipment and receiver.
- Connect the equipment into an outlet on a circuit different from that to which the receiver is connected.
- Consult the dealer or an experienced radio/TV technician for help.

This equipment complies with FCC radiation exposure limits set forth for an uncontrolled environment. This equipment should be installed and operated with minimum distance 20cm between the radiator & your body.