

# AFQ05

## Smart Nursery Light User Manual



**Thank you for purchasing the Smart Nursery Light. Please read this manual carefully before using the product and keep it in a safe place.**

### 1. Matters needing attentions

1. Power supply voltage: the output voltage of the power adapter should not be less than 5V/1A, otherwise the light may shake or be abnormal.
2. Environment in use: this product can not be in the environments with stressed external force, long-term direct sunlight, or high temperature, ect.
3. Dis-assembly and maintenance: non-professionals should not disassemble without authorization. Owners should ask professional and technical maintenance personnel for maintenance and prevent metal or liquid from flowing into the product during maintenance.
4. Power cord: please avoid it being stepped on or squeezed by heavy objects, and do not pull the power cord.
5. Maintenance: if you do not use this product for a long time, please turn off the power switch, unplug the power plug, and store it in a dry place.
6. Wi-Fi version: This product only supports 2.4G HZ Wi-Fi, not 5G HZ Wi-Fi.

### 2. Product Overview



Serial number	Part name	Function Description	Precautions
①	LCD screen	The working status of the smart nursery light, including temperature, time, child lock, Wi-Fi, alarm ring, time system and other information	1. Wake-up mode: time frame is 6:00-17:00 the sun, butterfly, and sunflower will blink 3 times dynamically every 5 minutes. This action is not executed during snooze mode. 2. Sleep mode: time frame is 18:00-5:59, and the surrounding 12 patterns. 3. Sleep mode: flash 5 times in sequence every half an hour.
②	Snooze button	1. When the alarm bell rings, short press to enter the snooze mode. 2. Long press 3S to adjust brightness in cycle 1%~10%.	1. When entering the snooze mode, the alarm bell will pause, and it will ring again in 10 minutes. The 12 small patterns around it keep flashing in the snooze state. 2. When the alarm rings, you can operate either way or turn off the alarm.
③	Temperature mode	1. Short press to switch Celsius and Fahrenheit degree. 2. Long press for 3S to choose time setting, alarm clock option confirmation, and short press to exit the setting.	1. The default temperature readings are Fahrenheit degree. 2. The temperature deviation of ±3 degrees is normal.
④	Time system	1. Short press to switch 12/24 hour time system. 2. Long press for 3S to enter the Wi-Fi pairing mode. 3. When entering time or alarm setting, short press to switch options or adjust parameters	1. The default time system is a 12-hour time system (if the time is 12-hour time system, AM and PM will be displayed in the time system area, and if the 24-hour time system is selected, the time area will not display AM and PM). 2. The device will enter the network pairing mode once it is powered on for the first use.
⑤	speaker	The sound will come out here.	
⑥	Power supply interface	Equipment power supply adopts TYPE-C interface DC 5V/1A	It is recommended to use original standard adapters. Replacing other non-original adapters may affect product performance.
⑦	Child lock	1. On device side, press key ⑥ and key ⑦ at the same time for 3 seconds to use child lock functions and press the same two keys at the same time for 3S to close it, which is to prevent children from touching it by mistake. 2. On the APP, enter the application interface to do settings.	When the child lock function is activated, there will be a child lock icon on the LCD display.

### 2.1. Setting time on device

1. Long press the bottom button ⑥ for 3S to enter setting, and the AM/PM/24 time system icon on the LCD display starts to flash;
2. Short press the bottom button ⑥ to confirm the set time, and the LCD hour value icon starts to flash;
3. Short press the bottom button ⑥ to set the hour value, short press the bottom button ⑥ to confirm the hour parameter setting, and the minute value starts to flash;
4. Short press the bottom key ⑥ to set the minute value, short press the bottom key ⑥ to confirm the minute parameter setting, and exit the setting after the time is set.

### Note:Local device

1. There is no need to set the time when it's connected to the Internet, the device will automatically obtain the Internet time and temperature.
2. The local time setting is required when there is no Internet, but temperature cannot be displayed.
3. When the device is connected to the Internet, the button cannot be used to set the time, only the alarm clock can be set.

### 2.2. Setting alarm clock on device

1. Long press the bottom button ⑥ for 3S to enter the setting, and the AM/PM/24 system icon on the LCD display starts to flash;
2. Short press the bottom button ⑥ and the alarm clock icon starts to flash, short press the bottom button ⑥ to confirm the setting of the alarm, and the LCD alarm hour value icon starts to flash;
3. Short press the bottom button ⑥ to set the hour value, short press the bottom button ⑥ to confirm the hour parameter setting, and the minute value starts to flash;

4. Short press the bottom button ⑥ to set the minute value, short press the bottom button ⑥ to confirm minute parameter setting. When the alarm time is set, exit the setting.

### 3. Application

- 3.1. Connecting with "tuyasmart" APP  
Make sure your device is connected to a secure 2.4GHz network.

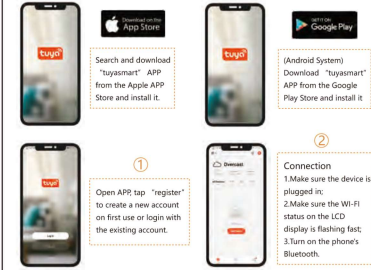

### 3.2. Lighting Application

Serial number	Part name	Function Description	Precautions
①	Equipment editing	Product name can be edited according to needs. There is a one-key operation to operate Alexa connection, offline reminder, device sharing, network check, etc.	1. This menu does not need to be edited under normal circumstances. 2. Click the "smart" key on the "tuyasmart" APP homepage and then click "+" to operate One-key operation.
②	Light on/off	It's to turn on or off the backlight of the LCD display.	This switch can only turn off the display light and cannot turn off the playing sound.
③	LCD brightness adjustment	Slide up and down to adjust the brightness of the LCD display, supporting 1~100%.	You may need to operate in the light % ratio circle during adjustment.
④	LCD color adjustment	Adjustable LCD display color	
⑤	Sound effect selection	Pull up to choose different sound effects.	This device has a total of 16 sound effects for selection.
⑥	Volume	Swipe to adjust volume value.	
⑦	Play / Pause	Short press to switch between Pause and Play.	For the first use, select the sound effect, click the play button and the device will enter into the sound effect playlist.

### 3.3. Scenario Application

Serial number	Part name	Function Description	Precautions
①	Scene mode editing	Recommended mode and custom mode	The recommended mode is not editable, and the custom mode is editable.
②	Recommended mode	10 modes for options: sleep aid, breathing, warmth, colorful lights, entertainment, soothing, night, companionship, holiday.	In the recommended mode, the color of the LCD display, sound effect and volume cannot be edited.
③	Custom mode	Add scenes, custom background picture, scene name. Set custom LCD display color. Set sound effects. Set playback volume	1. 8 sets of scenes can be customized. 2. Can delete custom scenes.

### 3.4. About Alarm clock

Serial number	Part name	Function Description	Precautions
①	Alarm setting	To choose sleep alarm or wake-up alarm	The recommended mode is not editable, and the custom mode is editable.
②	Sleep alarm	Editable time, repeat, note, light color, brightness, on/off sound effect, sound effect volume, duration	1. Support 4 groups of sleep alarm. 2. Slide to the left to choose the delete button to delete the alarm setting.
③	Wake up alarm	Editable time, repeat, note, light color, brightness, on/off sound effect, sound effect volume, duration	1. Support 4 groups of wake-up alarm. 2. Slide to the left to choose the delete button to delete the alarm setting.

### 3.5. Application Settings

Serial number	Part name	Function Description	Precautions
①	Delay off	It can be set to delay the off time.	
②	Time system	"off" means the 12-hour clock system, "on" the 24-hour clock system.	The default setting is 12-hour clock system.
③	Light name	Can be awakened by voice control	
④	Synchronize network time	1. The device will automatically obtain the network time and temperature after it is turned on. 2. If it's "off", the network time cannot be obtained, you need to set the time by yourself.	The temperature cannot be displayed after it is turned off.
⑤	Child lock	It can prevent children from operation after opening.	
⑥	Temperature switch	Can switch between Fahrenheit and Celsius degree.	The default setting is Fahrenheit degree.

### 4. Troubleshooting

Serial number	Situation	Advice
①	Disconnected to the APP	1. Please check whether the current Wi-Fi is 2.4GHz. If so, please proceed to the next step; otherwise, please follow the APP application steps to set Wi-Fi to 2.4GHz. 2. Please check whether the Wi-Fi indicator flashing frequency of the device is fast flashing (0.5 seconds/time), and then check whether the fast flashing is selected on the APP network configuration page, because they should be on the same flashing speed. If not select the fast flashing on APP, the Wi-Fi indicator flashing frequency is slow flashing (2 seconds/time). Please select slow flashing on the APP network configuration page before connecting to the distribution network.
②	Indicator light of Wi-Fi normally lights up, but the APP is still on "Internet connecting" page	Light-up indicator light of Wi-Fi indicates that the device has already connected to Wi-Fi and you may sign up an account and install the device. Then, you can enter the APP operation page after finish "log in". Please turn to APP Application page for reference.
③	No light comes out	Check if the light on/off is off.
④	No sound comes out	1. Select the sound effect and click the play button to play the sound effect.

### 5. Parameter

Input voltage	AC100-240V, 50/60Hz	Output voltage	DC5V/1A
Powered by	Android 5.0 or IOS 9.0 and above versions	Wireless connections	Wi-Fi IEEE 802.11 b/g/n 2.4GHz
Audio power	3W Max.	Color temperature range	2700K
Luminous flux	350lm±10% (±95700K)	Lifespan	25000 Hrs

### 6. Packing list

Smart Nursery Light x1 User Manual x1  
USB Charging Cable Adapter x1

### FCC Warning

This device complies with part 15 of the FCC rules. Operation is subject to the following two conditions: (1) this device may not cause harmful interference, and (2) this device must accept any interference received, including interference that may cause undesired operation.

Changes or modifications not expressly approved by the party responsible for compliance could void the user's authority to operate the equipment.

NOTE: This equipment has been tested and found to comply with the limits for a Class B digital device, pursuant to part 15 of the FCC Rules. These limits are designed to provide reasonable protection against harmful interference in a residential installation. This equipment generates uses and can radiate radio frequency energy and, if not installed and used in accordance with the instructions, may cause harmful interference to radio communications. However, there is no guarantee that interference will not occur in a particular installation. If this equipment does cause harmful interference to radio or television reception, which can be determined by turning the equipment off and on, the user is encouraged to try to correct the interference by one or more of the following measures:

- Reorient or relocate the receiving antenna.
  - Increase the separation between the equipment and receiver.
  - Connect the equipment into an outlet on a circuit different from that to which the receiver is connected.
  - Consult the dealer or an experienced radio/TV technician for help.
- Radiation Exposure Statement  
To comply with FCC RF exposure compliance requirements, this grant is applicable to only mobile configurations. The antennas used for this transmitter must be installed to provide a separation distance of at least 20cm from all persons and must not be co-located or operating in conjunction with any other antenna or transmitter.