

i-box  
**Ellipsis**

**WIFI Speaker  
79210PI**



## Introduction

Your new Ellipsis plug in Wi- Fi Speaker is a voice-controlled smart speaker with Amazon's intelligent Alexa voice assistant. Just say the wake word "Alexa" and your Ellipsis speaker will play music, control your smart home devices, answer your questions, set calendars, report the weather, news, traffic and more.

The 2W built in speaker delivers dynamic audio and room-filling sound, so you can truly enjoy your favourite playlists from subscription streaming services such as Spotify and Amazon Music as well as many free services such as TuneIn.

Setup is easy with the free "i-box Player" app. Use the "i-box Player" app to access 10000+ skills and services.



### Safety information

**Important** - Please read these instructions fully before installing or operating your speaker.

Keep away from flame sources such as lighted candles.

Do not expose to dripping or splashed fluids. Objects filled with liquids, such as vases, must not be placed close to the speaker.



The unit should not be exposed to direct sunlight, very high or low temperature, moisture, vibrations, strong magnetic fields, high frequencies and dusty environments.

Do not place the product in enclosed bookcases or racks without proper ventilation. Ventilation should not be impeded by covering the ventilation openings with items, such as newspapers, table-cloths, curtains, etc.

Never attempt to insert wires, pins or other such objects into the vents or openings of the unit.

Do not disassemble or modify the Speaker, there are no user serviceable parts.

If the Speaker is damaged in anyway or malfunctions do not use. Consult a qualified service engineer.

Do not use abrasives, benzene, thinner or other solvents to clean the surface of the unit. To clean, wipe with clean soft cloth and a mild detergent solution.

Do not dispose of this product with household waste at the end of its life cycle; hand it over to a collection centre for the recycling of electrical and electronic appliances.



|  |     |
|--|-----|
| <b>1. Safety information</b>                         |     |
| Safety information                                   | 2-3 |
| <b>2. Getting to know your Alexa plug in speaker</b> |     |
| Controls and features                                | 6   |
| Control button functions                             | 6   |
| LED indications                                      | 6   |
| <b>3. Getting started</b>                            |     |
| Before getting started -                             |     |
| Downloading essential apps                           | 7   |
| Phone/Tablet network connection                      | 7   |
| Mains connection                                     | 7   |
| Speaker connection main setup                        | 7-9 |
| Alternate connection setup                           | 10  |
| Naming your speaker                                  | 11  |
| Signing into Amazon                                  | 11  |
| <b>4. Operation</b>                                  |     |
| Using the Amazon Alexa app                           | 12  |
| Alexa - Things to try                                | 13  |
| Alexa - Voice control your tunes                     | 14  |
| Spotify Connect                                      | 15  |
| Additional control key functions                     | 15  |
| Grouping speakers                                    | 16  |
| Radio presets  | 17  |
| Speaker reset  | 18  |
| <b>5. Other information</b>                          |     |
| Troubleshooting                                      | 18  |
| Specifications                                       | 19  |
| Disclaimer   | 19  |
| Declaration of conformity                            | 19  |
| Technical support                                    | 19  |



# 1. Getting to know your Ellipsis Speaker

## Controls and features

1. Action key : Mic-tap to talk
2. Mic mute key: switches mic on/off
3. Volume + key: increases volume
4. Volume - key: reduces volume
5. LED indicator ring
6. Mics

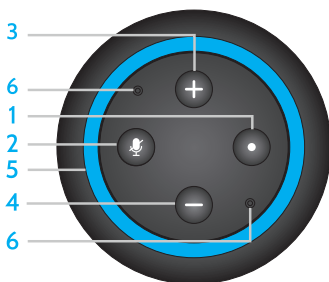

## Control button functions

| Control Buttons                                   | Long Press                             | Short Press  |
|---|--|--|
| 1. Mic-Tap to talk                                | -                                      | Activate Mic to talk to Alexa without saying Alexa first |
| 2. Mic On/Off                                     | -                                      | Switch Mic/Alexa On/Off                                  |
| 3. Volume +                                       | Increase Volume                        | Increase Volume - step by step                           |
| 4. Volume -                                       | Reduce Volume                          | Reduce Volume - step by step                             |
| 5. Vol + & Vol - Press both down at the same time | WPS function (Hold down for 3 seconds) |  |

## LED Indications

| Indicates | Idle     | Listening  | Thinking       | Speaking       | Mic off    | Syst. Error/<br>Setup Mode | Vol +/-    |
|-----------|----------|------------|----------------|----------------|------------|----------------------------|------------|
| LED       | ●        | ●          | ●●             | ●●             | ●          | ●                          | ○          |
| Colour    | No Light | Cyan       | Cyan/Blue      | Cyan/Blue      | Red        | Orange                     | White      |
| Action    | -        | 100% Solid | Fast Alternate | Smooth Pulsing | 100% Solid | 100% Solid                 | Gradual On |

## Before getting started

1. Download and install the i-box player app from Play Store or the App Store to your phone/tablet (Search for i-box)
2. Download and install the Amazon Alexa app from Play Store or the App Store to your phone/tablet (Search for Alexa)

i-box player  
App Icon



Amazon Alexa  
App Icon



## Getting started

1. Make sure your phone is connected to the same Wi-Fi network as you wish to connect your speaker to.  
***This must be a 2.4GHz network - not 5GHz.***
2. Plug your Ellipsis speaker into a suitable mains socket and switch on the mains socket\*. The LED ring will light up orange and after a few seconds you will hear a tone to indicate the speaker is ready to connect to Wi-Fi.
3. Open the i-box Player on your phone/tablet, screen (A) will appear showing searching for i-box wireless Hi-Fi system.

\*Please Note: Your Ellipsis Speaker is supplied with three slide-in pin adaptors for the UK, USA and Europe. Select the correct version for your country and slide it into the back of the Ellipsis until it locks into position.

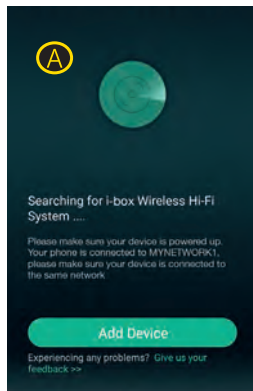

## Setup continued

4. Screen (B) will now open, tap on the device drop down menu and select i-box Ellipsis and screen (D) will open. Tap “Next” to enter SETUP menu (E).

5. Tap “Settings” to enter your phone Wi-Fi settings menu (F) and connect to the Ellipsis speaker (G) then return to the i-box app, screen (H).

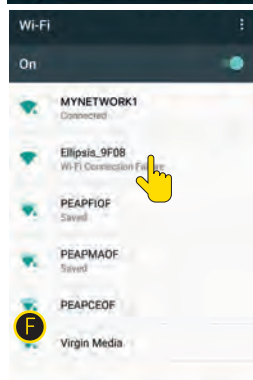
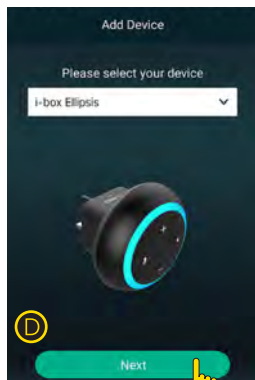



## Setup continued

6. The SELECT NETWORK screen will now open. Select your Wi-Fi network, enter the password and tap “Continue” you will hear a voice prompt “waiting for Wi-Fi connection” and screen (I) will appear then you will hear “Wi-Fi connected” and the Orange LED will stop flashing, screen (K) will open tap “Next”. Go to page 11 to continue.

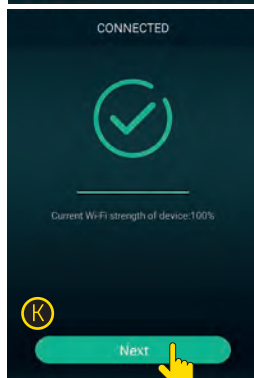
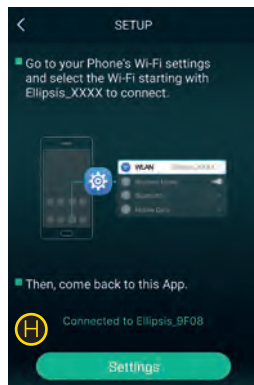
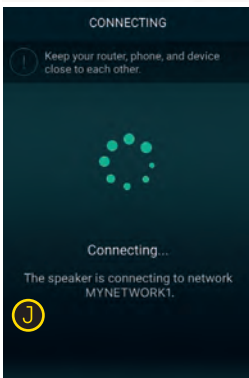
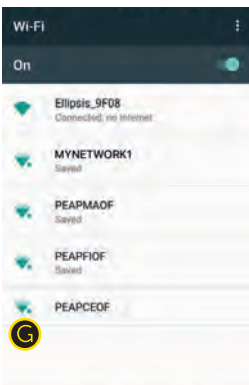
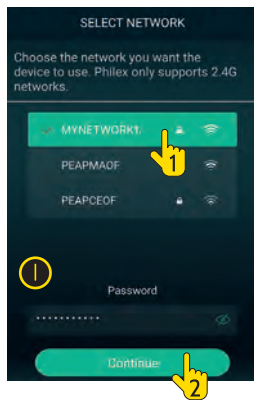

## Alternative Setup

If in step 5 your i-box player app is unable to connect to your Ellipsis speaker or find it, then return to the i-box player app, screen (H) and tap on "Could not find Ellipsis\_XXXX". Screen (L) will open, follow the instructions (Press and hold both Volume + and Volume - buttons together for 3 seconds to activate network setup mode. Then select "Next" to continue).

This will open your phone Wi-Fi settings menu (F) connect to the Ellipsis speaker and you will hear a "Connected to speaker" voice prompt then return to the i-box player app, screen (H) and follow step 6. on the previous page to connect the speaker to your Wi-Fi network.

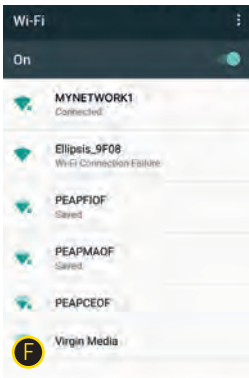
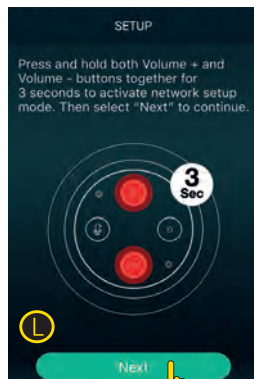

## Naming your speaker

After Wi-Fi connection the NAME DEVICE screen (M) allows you to name your speaker, enter a name or choose from the room list. Speaker default name is Ellipsis\_XXXX. Tap next to enter screen (N) tap on "Sign in with Amazon"

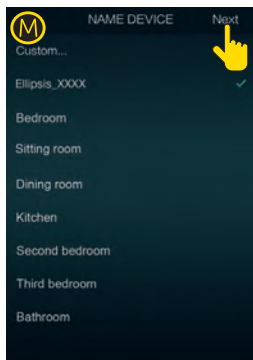

## Signing into Amazon to use Alexa

To use Amazon Alexa you will need an Amazon account. If you don't already have an account go to "www.amazon.com" (in the USA) or "www.amazon.co.uk" (in the UK) to register. Sign in to Amazon using the sign in screen (O).

The next step is to choose your preferred language for Alexa using screen (P). If for example you live in the UK select "English (United Kingdom)" and follow the on screen instructions.

This will enable Alexa to speak with a British accent and give more relevant answers to your questions.

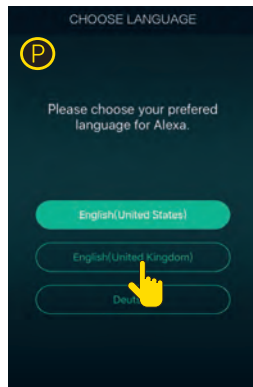
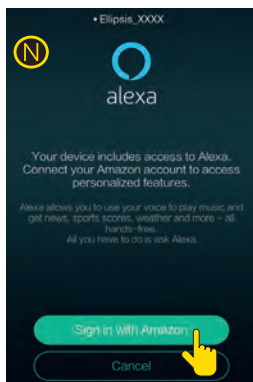

## Using Alexa

After setup Screen (Q) will open with suggested questions to ask Alexa.

**Always say Alexa first** then ask your question/request.

To get the full benefit of Alexa open the Alexa app and sign in (screen R).

Many of Alexa's services are location dependent and the default location is Seattle in the USA.

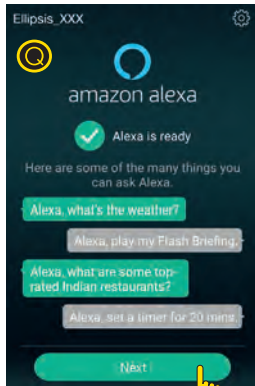

**To change the default location\*** in the Amazon Alexa home screen (S) press the menu symbol top left, tap on tap on settings , tap on "This Device" go to "Device location" and enter your full address on the top line and postcode on the second line.

In settings you can use the menus to connect to apps like Amazon Music\*, Live

Radio, TuneIn, Spotify† and others as well as reviewing your Alexa history and many other options.

\*To use weather, traffic and other "local" services you will need to set your location.

†For some services you will need to open an account.

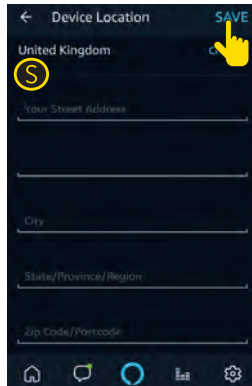
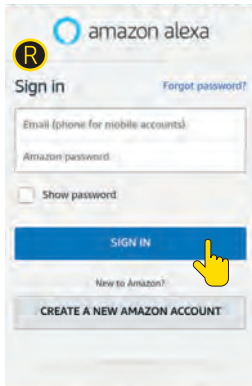

## Alexa - Things to try

### Music:

Alexa, play some Prime Music. Alexa, shuffle my mellow playlist. Alexa, play my Classic Jazz station.

Alexa, what song is this?

Alexa, buy this song.

### Shows, Podcasts, & Radio

Alexa, play the program In Our Time.

Alexa, play BBC 1 radio

### Alarms & Timers

Alexa, set a timer for 30 minutes.

Alexa, set an alarm for 8.15 a.m.

### Shop Amazon

Alexa, order bin bags.

Alexa, buy more kitchen towels.

### Questions & Answers

Alexa, what Italian restaurants are near me.

Alexa, tell me a joke.

Alexa, Wikipedia Winston Churchill.

### News, Weather, & Traffic

Alexa, what is the latest news?

Alexa, what's the weather forecast?

### Smart Home

Control supported smart home devices like Philips Hue lights. To get started, go to the Alexa App.

Alexa, dim Hue lights to 50%.

Alexa, turn on the fan.

### Use These Anytime

Alexa, pair my Bluetooth.

Alexa, stop.

Alexa, volume five. (1-10)

For more examples, go to "Things to Try" in the Alexa App.

Apart from using the Amazon Alexa app menus on your phone to connect and explore apps like Amazon Music, Live Radio, TuneIn and others. You can review your Alexa history. View shopping lists. Check your purchase history. Check your timer and alarm settings.

## Alexa - Voice control your tunes

Using the Alexa app you can open an Amazon Music account or link to an existing Music & Media (screen T).

Open the Amazon Alexa app. Select Settings, then the Music & Media (screen T). Tap on "CHOOSE DEFAULT MUSIC SERVICES".

Screen (U) will open choose Amazon Music or Spotify and press done.

If you chose Spotify the account is now linked to Alexa. Alexa will now automatically use Spotify as the default music player, so there's no need to specify "on Spotify" with your voice commands.

If you chose Amazon Music as your default, when you ask Alexa to play music by name, artist or album without specifying a service, music from Amazon Music or your music library will be played automatically.

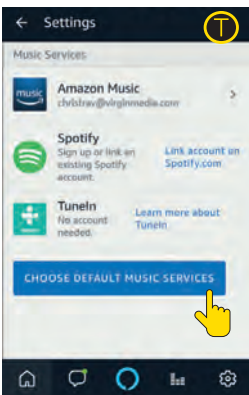

\*To play Spotify tunes on your Ellipsis speaker you will need a Premium Spotify account. For more information go to: [www.spotify.com](http://www.spotify.com) and select your country.

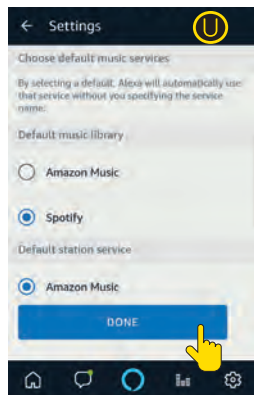

If you prefer not to use voice commands to select and play your music you can open the i-box player app on your phone and play music from your phone library or any service you are registered with.

## Spotify Connect

As an alternative to Alexa voice control, with Spotify Connect you can use the Spotify app on your phone, tablet or laptop to select and play your Spotify tunes sent via Wi-Fi to your Ellipsis speaker. Using your phone as a remote control.



The Spotify Software is subject to third party licences found here: [www.spotify.com/connect/third-party-licenses](http://www.spotify.com/connect/third-party-licenses)

## Using Spotify Connect Control key functions

1. Connect your **i-box Ellipsis** to your Wi-Fi network.
2. Open up the Spotify app on your phone, tablet or laptop using the same Wi-Fi network.
- 3 Play a song and select **Devices Available**.
4. Select your **Ellipsis\_XXXX** and start listening.

**Mic Tap to Talk** ● (1):  
Short press - Activates Alexa ready for voice commands without the need to say Alexa first.

**Mic On/Off** 🎤 (2):  
Short press - disables Alexa function (turns off the mic) press again to enable Alexa function (turn on the mic)  
When Alexa function is Off LED is RED.

**Volume +/-**  
Tap + to increase volume step by step press and hold down to increase volume continuously.  
Tap - to reduce volume step by step press and hold down to reduce volume continuously.

## Grouping speakers using the i-box app

In Wi-Fi mode, switch on the speakers you want to group they will show a solid white LED. In the Device list (A) opposite, you will see “How to switch between solo and multi mode?” tap on this to open the instruction screen (B).

As shown in B, to pair 2 speakers grab and drag one speaker and drop it over another speaker. The speaker you drag becomes the (Secondary) speaker part of a group and plays the same music as the other (Master) speaker. To ungroup, grab and drag the Secondary speaker below the middle line. The Secondary speaker becomes a solo speaker again and can play different music independently.

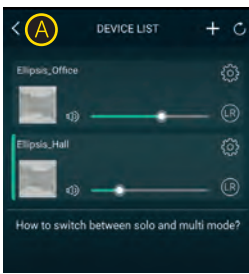

While grouping the LED will flash white on the Secondary speaker when grouped the Secondary speaker LED will change to solid Red.

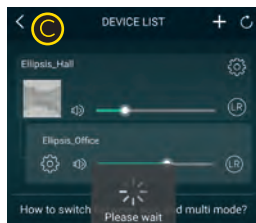

### Grouping 2 speakers

Note: While grouped Alexa facility will only function on the Master speaker. You can make one or more groups.

You can have more than one Secondary speaker grouped with the same Master.

You can simultaneously control the volume of all the speakers in a group by using the Volume buttons of your phone/tablet.

For a group configuration, you can choose which speaker plays Left (L), Right (R) stereo channel or Left/Right (L/R) for mono, by touching the relevant icon.



## Radio presets using the i-box player app

To save internet radio stations to presets follow steps 1-3, to recall a preset, steps 4-5.

1. Go to the TUNEIN screen tap on search and the TUNEIN SEARCH screen will open.

2. Find the station you want to make a preset for and tap on the small speaker symbol beside the station and the PRESET screen will open.

3. Up to 5 presets can be saved, tap on a number to save the preset to it, the station will appear beside it and you will hear a message saying "preset saved".

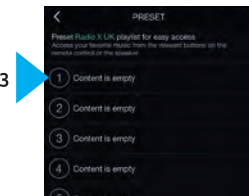
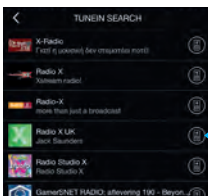
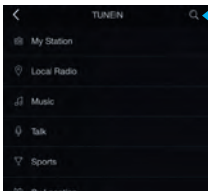

4 & 5. To recall a preset go to the DEVICE LIST tap on settings  select Preset Content.

6. In the PRESET CONTENT screen tap on the preset for the station you want to listen to.

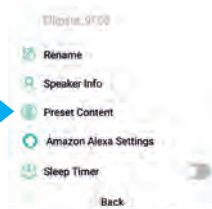
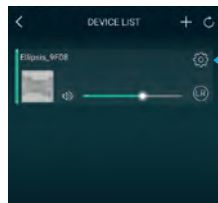

## Speaker reset using the i-box player app

If you need to clear the settings on your speaker you can restore factory settings in the i-box player app:

(1.) In the DEVICE LIST tap on settings (2.) Select SPEAKER INFO and (3.) scroll down and tap “Restore Factory Settings”.

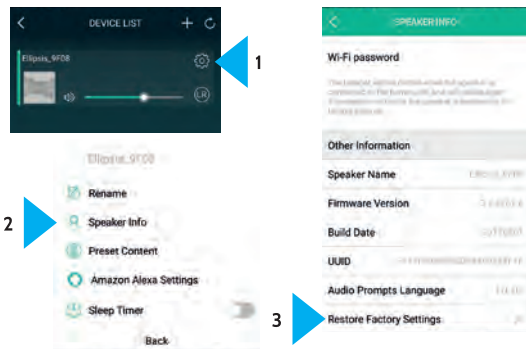

## Troubleshooting

1. There is no response from the speaker.

Make sure your Ellipsis is fully inserted into a mains power socket and the socket is switched on.

2. Your Ellipsis speaker cannot connect to your Wi-Fi network

Switch off the power at the mains socket and switch it back on again then try

making a Wi-Fi connection following the instructions in this guide.

Check if there is an Internet connection problem.

Make sure you have a Wi-Fi connection between your Ellipsis speaker and your phone/tablet.

3. Alexa is not responding

Make sure the microphone is switched on (press the Mic On/Off  button (2).

Make sure you are using correct Alexa requests. Always speak the wake word “Alexa” first when making your request.

Repeat your request. Speak naturally and clearly to Alexa in English.

Make sure your Ellipsis speaker is at least 20cm (eight inches) away from other objects that may cause interference (such as microwave ovens).

## Specifications

Power Input: 110-240V-50/60Hz

Speaker Output: 2 Watt RMS

Driver: 1.5" neodymium full-range

Frequency Response: 60Hz ~ 20KHz ( +/-10 dB)

## Disclaimer

Updates to Firmware and/or hardware components are made regularly. Therefore some of the instructions, specifications and pictures in this documentation may differ slightly from your particular situation. All items described in this guide are for illustration purposes only and may not apply to your particular situation. No legal right or entitlements may be obtained from the description made in this manual.

## Declaration of conformity

Hereby, Philex Electronic Ltd. declares that the radio equipment: model Ellipsis Amazon Alexa Wi-Fi Speaker for radio broadcast reception in domestic premises is in compliance with the Radio Equipment Directive 2014/53/EU.

The full text of the EU declaration of conformity is available at the following internet address: [www.philex.com/doc](http://www.philex.com/doc)

## Technical support

For further help, advice, information or live chat visit [www.iboxstyle.com](http://www.iboxstyle.com)



Amazon, Alexa and all related logos are trademarks of Amazon.com, Inc or its affiliates

All Spotify trademarks, service marks, trade names, logos, domain names, and any other features of the Spotify brand are the sole property of Spotify or its licensors.

© Philex Electronic Ltd 2018.v1  
MK42 ONX

FCC Warning:

FCC ID: 2AO5X-79210PI

Changes or modifications not expressly approved by the party responsible for compliance could void the user's authority to operate the equipment.

This device complies with Part 15 of the FCC Rules. Operation is subject to the following two conditions: (1) this device may not cause harmful interference, and (2) this device must accept any interference received, including interference that may cause undesired operation.

This equipment has been tested and found to comply with the limits for a Class B digital device, pursuant to Part 15 of the FCC Rules. These limits are designed to provide reasonable protection against harmful interference in a residential installation. This equipment generates, uses and can radiate radio frequency energy and, if not installed and used in accordance with the instructions, may cause harmful interference to radio communications. However, there is no guarantee that interference will not occur in a particular installation.

If this equipment does cause harmful interference to radio or television reception, which can be determined by turning the equipment off and on, the user is encouraged to try to correct the interference by one or more of the following measures:

- Reorient or relocate the receiving antenna.
- Increase the separation between the equipment and receiver.
- Connect the equipment into an outlet on a circuit different from that to which the receiver is connected.
- Consult the dealer or an experienced radio/TV technician for help.

This equipment complies with FCC radiation exposure limits set forth for an uncontrolled environment. This equipment should be installed and operated with a minimum distance of 20cm between the radiator & your body. This transmitter must not be co-located or operating in conjunction with any other antenna or transmitter.