

Aermoo

WIRELESS CHARGER W2

PRODUCT INTRODUCTION

W2 is a desktop wireless charger with a stylish appearance and reliable functions. It is compatible with fast charging schemes of Qi-BPP and Samsung, meeting the charging needs of different mobile digital devices. W2 has passed the FCC and CE Certifications so users can feel rest assured when charging their devices.

PRODUCT SPECIFICATION

Input: DC 9V/2A 18W Max
Power Interface: Micro-USB (support QC2.0/QC3.0)
Max Output Power: 10W
Charging Height: 3-8mm
Charging Efficiency: 70%-82%
Charging Area: 10mm*10mm
Defensive Functions: over current / over voltage protection;
over temperature/ short circuit protection; FOD foreign object
detection

PRODUCT COMPOSITION

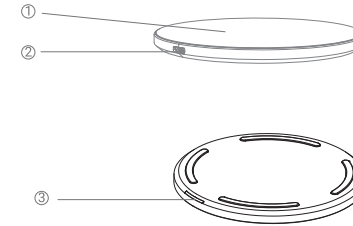

1. Wireless Charging Area
2. USB Interface
3. LED Indicator

INSTRUCTION

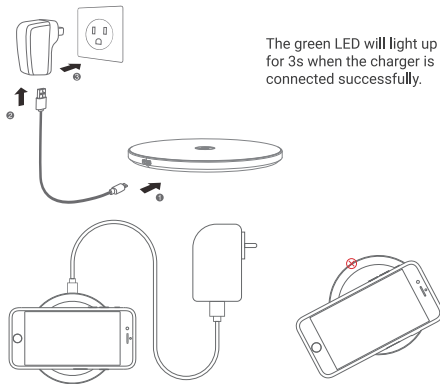

The green LED will light up for 3s when the charger is connected successfully.

LED Indicator Status:

- A: The LED will be always green when charging;
- B: The LED will be off when uncharged or undercharged;
- C: The charging will be interrupted when abnormality occurs;
The light will flash quickly for 1s when the device is out of position.

WARNINGS & NOTES

- Use the charger indoors and in dry environment only; avoid using it in high temperature, wet and oily conditions;
- It is strictly forbidden to use under strong magnetic environment;
- Avoid the areas being accessible to infants and children;
- For your safety, please do not plug the device with wet hands;
- Please stop using if the product exposes to water, dirt or dust;
- Non-professionals please do not disassemble the device without authorization.

PACKAGE CONTENTS

Wireless Charger *1
User Manual *1
USB Cable*1

NOTE

This equipment has been tested and found to comply with the limits for a Class B digital device, pursuant to part 15 of the FCC Rules. These limits are redesigned to provide reasonable protection against

harmful interference in residential installation. This equipment generates uses and can radiate radiofrequency energy and, if not installed and used in accordance with the instructions, may cause harmful interference to radio communications. However, there is no guarantee that interference will not occur in a particular installation. If this equipment does cause harmful interference to radio or television reception, which can be determined by turning the equipment off and on, the user is encouraged to try to correct the interference by one or more of the following measures:

- Reorient or relocate the receiving antenna.
- Increase the separation between the equipment and receiver.
- Connect the equipment into an outlet on a circuit different from that to which the receiver is connected.
- Consult the dealer or an experienced radio/TV technician for help.

Changes or modifications not expressly approved by the party responsible for compliance could void the user's authority to operate the equipment.

This device complies with Part 15 of the FCC Rules. Operation is subject to the following two conditions:
(1) this device may not cause harmful interference, and
(2) this device must accept any interference received, including interference that may cause undesired operation.