



USER MANUAL Version 1.1

Preface

Thank you for choosing our smart watch. You can fully understand the equipment by reading this manual. Use to appreciate the practical functions and simple operation methods.

The company reserves the right to modify the contents of this manual without any prior notice. Subject to notice.

Product configuration

- Smart watch X1
- Packing box X1
- Instruction X1
- Charging stand X1

Note: This product supports IP67 waterproof, rain, hand washing and wearing Hot water bath, but sauna is not feasible and can not prevent steam. The company will not provide free warranty in case of water entering due to failure to follow the prompts. There will be water in the horn hole after cooking in water. Please throw out the water so that the sound can return to normal.

Key operation instructions

START KEY: Long press for switching on/off. For the dial standby interface, short press for bright off screen. For the secondary menu screen, press briefly to illuminate the screen and then return step by step until you return to the dial screen. This button will not stop the chronograph function and will not stop the chronograph screen if the TIME screen is running a chronograph.

TIME KEY: When the standby screen is off, press briefly to light up the screen first. When the other function interface, short press to enter the timer interface. The timer function can save data up to 5 times when it is running, when the timer function stops running you must touch the stop button on the interface to stop the timer.

LEFT KEY: When the standby screen is off, press briefly to light up the screen first. When the other function interface is running, short press to enter the dial interface directly. When the chronograph function is running, press briefly to exit the chronograph interface and return to the chronograph interface automatically after about 3 seconds.

SPORT KEY: When the standby screen is off, press briefly to light up the screen first. If the timer interface, the timer function is running, short press to function. If the chronograph function is not running, press briefly to go directly to the sports mode screen.

TP Touch Gesture Function Description

When the standby dial screen: Left swipe for menu, right swipe for today's data, health check, phone, weather, camera control, music control, breathing exercise in that order. Downward swipe to the shortcut bar, Up swipe for notifications. Enter After entering each function, swipe right to exit step by step.

Dial watch face: In the standby screen, press and hold the screen, the dial selection will appear, select the dial you want by swiping left and right and click to confirm. You can change the dial and set a custom dial on the APP.

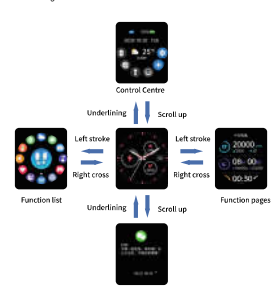

Watch to phone connection

First turn on the Bluetooth function of your phone.

The watch does not support multiple languages, the factory language is English. The mobile phone APP language is automatically synchronized when connected to the mobile phone APP.

Supported mobile app languages are: Android and IOS: Chinese, Traditional Chinese, English, German, Korean, Spanish, Japanese, French, Russian, Arabic, Ukrainian, Italian, Portuguese. Scan the QR code below to download and install the client APP, named "Ea Fit".

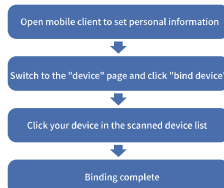

In the watch settings menu - About screen, the watch MAC address will be displayed, you can identify your device by the MAC address of the device list kind; the watch will automatically synchronize the time after successful binding.

In future, every time you open the client, the watch will automatically connect to the phone and the data page of the client will drop down. You can synchronize the data. After the watch is found in the app, you can use the Bluetooth name: RW-S02 in the watch is connected to the mobile phone at the Bluetooth function. After the watch has been successfully connected to the APP, it is also necessary to connect the audio. The Bluetooth name: S02-Call, through which you can play music and make calls from your mobile phone on the watch. The watch is connected to the APP.

Bluetooth auto reconnect: No alert on the watch side when the Bluetooth connection range is exceeded. When the bracket reaches the Bluetooth connection range, the Bluetooth will be automatically reconnected by opening the app.

Watch charging and activation

The watch needs to be charged and activated before it can be used for the first time. Use the supplied magnetic charger to attach to the metal contacts on the back of the watch and connect the other end of the charger to the other end of the charger can be connected to a USB charging head or to a USB port on your computer.

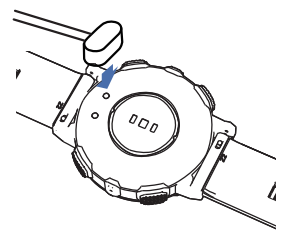

Main features

- Sleep**
The watch records and displays the total number of hours of sleep last night as well as the number of hours of deep sleep and light sleep. It is cleared at 20:00 on the night of sleep.
- Heart rate**
The watch can record and display 24H heart rate values throughout the day. Click on the heart rate screen to view current heart rate value can be measured. You can only see the 24h data for the day, the bracket data The bracket data is cleared in the early hours of the day.
- Campaign information**
The watch records and displays the number of steps taken each day, the number of calories burned and mileage information.
- Exercise**
8 sports modes to choose from including: walking, running, cycling, basketball, football, badminton, jumping rope and swimming. More detailed analysis and data records can be viewed in the client.
- Blood pressure interface**
Click on the blood pressure screen to measure the current blood pressure level. More detailed analysis and data logs can be viewed in the client.
- Oxymetry interface**
Click on the blood oxygen screen to measure the current blood oxygen level. More detailed analysis and data logging can be viewed in the client.



- Weather information**
The weather page displays the current weather, air quality information, and tomorrow's conditions for tomorrow. The weather information is only available if you are connected to the client. If you are disconnected for a long time, the weather information will not be updated.
- Message Push**
The watch can receive push notifications on the display phone and can be switched on and off in the client. Push items can be switched on and off in the client. The watch messages page can store the last 5 message records.
- Camera controls**
When connected to the phone, the watch can act as a remote control for the phone's camera. On the phone after opening the camera on your phone, tap on the watch camera control page to trigger the mobile phone camera shutter.
- Music control**
When connected to the phone, the watch can control the phone's music player.
- Stopwatch**
Click on the stopwatch icon. Access the stopwatch function.
- Smart Alarm Clock**
You can set the watch's smart alarm in the client, with up to 3 alarms. When the time is set, the watch will display the alarm icon and vibrate.

- Theatre mode**
Turning on theatre mode turns off the phone's vibrations and reduces the screen brightness. The watch can be set in the watch control centre.
 - Sedentary reminder**
The watch will prompt you to get up and walk around after you have been sitting for 1 hour. Sedentary reminder The function can be set on and off in the client.
 - Drinking Reminder**
The watch will alert you when it's time to drink at the scheduled drink time. Drinking water The reminder function can be set in the client.
- Frequently asked questions and answers**
- Why do blood pressure values deviate from the blood pressure monitor?**
The deviation between the watch and the sphygmomanometer is due to a number of factors. The sphygmomanometer measures in the brachial artery and the watch measures in the two main branches of the micro-artery. If you use a watch and a blood pressure monitor at the same time, the straps put pressure on the area below the middle of your elbow, temporarily preventing the blood from flowing smoothly to the arterial branches below. This increases the tension in the blood vessels and will cause the upper and lower blood pressure measurements to deviate even more.
 - Why should I not wear my watch in a hot bath?**
The temperature of the bath water is relatively high and produces a lot of water vapor, which is in the vapor phase and has a small molecular radius and can easily seep through the watch casing. When the temperature drops, it will condense again into liquid droplets, which can cause a short circuit in the internal wiring of the watch, damaging the circuit board and thus damaging the watch. This can damage the watch circuit board and damage the watch.

Hardware and platform components	
Hardware Platform	RTL8762DT-BK
Extended FLASH(ROM)	64MB
RAM	128KB
Display size	1.32inch 360*360
TP touch model	Full Touch 8.65V-COF
Heart rate model	True Heart Rate TENECORE 3600
G-sensor	Silan Micro SCA720 3-Axis
Pushbuttons	Four keys (START: switch on/off key E XIT: exit key) TIME:Timer function key SPORT:Sport mode key
Rechargeable	Magnetic suction Charging current 0.5C approx. 110MA
Battery	Polymer battery with lithium protection 220MAH
Encoders	None
Compatible systems	Android/iOS
Bluetooth name	Bluetooth 3.0 S02-Call for calling and playing music etc. Bluetooth 5.0 KW-S02 for connecting to mobile app for health and sports data transfer

- Common Troubleshooting**
1. The watch cannot be turned on: Press the on button for too short a time, more than 3 seconds; the battery power is too low, please use the charging cable to charge.
 2. The watch cannot be charged normally: whether the charging contact is normal and the charger is when the battery is too low, the charging interface will be displayed only when the battery is charged.
 3. Software problems can be solved by restoring the factory function.
- Warranty Description**
1. This product in normal use, if the product quality problems caused by manufacturing, materials, design and other reasons, from the date of purchase, the motherboard within one year free warranty, battery, charger warranty for six months.
 2. No warranty is provided for faults caused by the user's personal reasons, as follows:
 - (1) Unauthorised disassembly, modification of the watch, etc. causing injury.
 - (2) Injuries caused by inadvertent dropping during use.
 - (3) All human damage or third party fault, misuse (e.g. water in the main unit, external shocks, scratch damage to peripheral components, etc.) is not covered by the warranty.
 - When requesting a free warranty, please provide a warranty card with the date of purchase and the stamp of the place of purchase. Warranty card.



FCC Statement

This equipment has been tested and found to comply with the limits for a Class B digital device, pursuant to part 15 of the FCC Rules. These limits are designed to provide reasonable protection against harmful interference in a residential installation. This equipment generates, uses and can radiate radio frequency energy and, if not installed and used in accordance with the instructions, may cause harmful interference to radio communications. However, there is no guarantee that interference will not occur in a particular installation. If this equipment does cause harmful interference to radio or television reception, which can be determined by turning the equipment off and on, the user is encouraged to try to correct the interference by one or more of the following measures:

- Reorient or relocate the receiving antenna.
- Increase the separation between the equipment and receiver.
- Connect the equipment into an outlet on a circuit different from that to which the receiver is connected.
- Consult the dealer or an experienced radio/TV technician for help.

Caution: Any changes or modifications to this device not explicitly approved by manufacturer could void your authority to operate this equipment.

This device complies with part 15 of the FCC Rules. Operation is subject to the following two conditions: (1) This device may not cause harmful interference, and (2) this device must accept any interference received, including interference that may cause undesired operation.

RF Exposure Information

The device has been evaluated to meet general RF exposure requirement. The device can be used in portable exposure condition without restriction.