

USER MANUAL

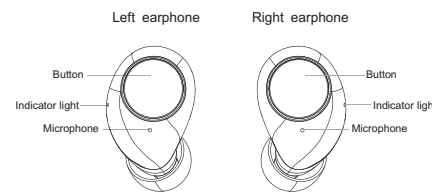

K045



PARAMETER	
Model	K045
Bluetooth version	V5.3
Signal distance	12m
Charging case battery	1200 mAh
Earphone battery	40mAh
Playback time	13-15h
Standby time	>200h
Charging time	4-5-5h
Charging box voltage	DC 5V
Supported cell phone systems	iOS, Android

KEY DEFINITION

Power on	Press and hold the Button for 3s or take out of the charging case	red or blue lights flash with
Power off	Press and hold the touch control key for 3s or put it into the charging case; if there is no connection for 5 minutes, it will be automatically shut down.	The red light flashes for 3 second and goes out with
Answer calls	Click the key	
Hang up calls	Click the key	
Reject calls	Long press for 1.5seconds	
Cancel dialing	Click the key	
Play / Pause	Click the key	
Previous track	double click on the left earphone	
Next track	double click on the right earphone	
Volume +	Triple-click on the left earphone	
Volume -	Triple-click on the right earphone	
Siri	Four-click on the left/right earphone	

BLUETOOTH PAIRING AND CONNECTION

Pairing mode	Press and hold the Power keys of both earphones for 3 seconds, or take them out from the charging case, to turn them on, and the red and blue lights of both earphones flash after turning on. Then both earphones will enter TWS pairing mode. If not paired within 2 minutes, it will turn off automatically.	The red and blue lights on the main ear flash alternately
Connecting Bluetooth devices	Search the earphone in Bluetooth settings on the cell phone and connect. Enter Bluetooth settings and search "K045earbuds".	
Disconnect Bluetooth	Connect the Bluetooth device to the headset beyond the distance or disconnect (turn off) Bluetooth; after Bluetooth is turned on again, support the automatic back connection between Bluetooth and mobile phone.	The red and blue lights on the main ear flash alternately

Remarks:

1. Enter Bluetooth settings and search "K045earbuds".
2. If placing earphones into the charging case while playing music, the earphone will be disconnected from the cell phone and turn off. If open the charging case and take out the earphones, they will automatically turn on and reconnect.
3. The earphones will connect to the cell phone automatically when turning on. If it can't reconnect automatically, press once to reconnect.
4. If the earphones are unable to connect to the cell phone, clear the pairing history, reboot the earphones and reconnect.
5. Please use 5V charger.



CHARGING MODE

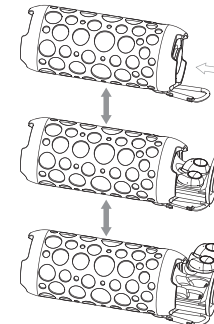

*Push back and forth to open and close the cover. Putting the earphone in and out of the battery compartment

SPEAKER FUNCTION DEFINITION

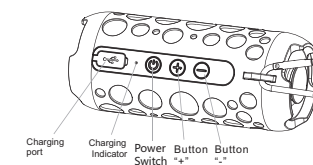

DEFINITION OF SPEAKER BUTTONS

Power on	long press the Power Switch	RGB lights on
Power off	long press the Power Switch	lights off
Answer calls	Click the Power Switch	
Hang up calls	Click the Power Switch	
Play / Pause	Click the Power Switch	
音量 "+"	long press the button "+"	
音量 "-"	long press the button "-"	
Previous track	Short press the Button "+"	
Next track	Short press the Button "-"	

SPEAKER BLUETOOTH CONNECTION

Enter Bluetooth settings and search: K045speaker
After power on, the blue light will be on, when waiting for connection, the RGB breathing light will be on, after the connection is successful Bluetooth play songs follow the music rhythm RGB lights flashing.

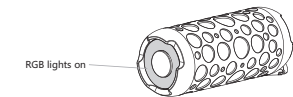

SPEAKER CHARGING MODE

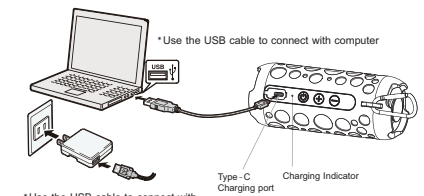

*Use the USB cable to connect with mobile phone charger

WARNING



RoHS Compliant CE MADE IN CHINA

This device complies with Part 15 of the FCC Rules. Operation is subject to the following two conditions: (1) this device may not cause harmful interference, and (2) this device must accept any interference received, including interference that may cause undesired operation.

Changes or modifications to this unit not expressly approved by the party responsible for compliance could void the user's authority to operate the equipment.

NOTE: This equipment has been tested and found to comply with the limits for a Class B digital device, pursuant to Part 15 of the FCC Rules. These limits are designed to provide reasonable protection against harmful interference in a residential installation. This equipment generates uses and can radiate radio frequency energy and, if not installed and used in accordance with the instructions, may cause harmful interference to radio communications. However, there is no guarantee that interference will not occur in a particular installation. If this equipment does cause harmful interference to radio or television reception, which can be determined by turning the equipment off and on, the user is encouraged to try to correct the interference by one or more of the following measures:

- Reorient or relocate the receiving antenna.
- Increase the separation between the equipment and receiver.
- Connect the equipment into an outlet on a circuit different from that to which the receiver is connected.
- Consult the dealer or an experienced radio/TV technician for help.

This device and its antenna(s) must not be co-located or operation in conjunction with any other antenna or transmitter.

Radiation Exposure Statement

The device has been evaluated to meet general RF exposure requirement in portable exposure condition without restriction.