



This device complies with Part 15 of the FCC Rules. Operation is subject to the following two conditions: (1) this device may not cause harmful interference, and (2) this device must accept any interference received, including interference that may cause undesired operation.

This device has been tested and found to comply with the limits for a Class B digital device, pursuant to Part 15 of the FCC Rules. These limits are designed to provide reasonable protection against harmful interference. This equipment generates, uses and can radiate radio frequency energy and, if not installed and used in accordance with the instructions, may cause harmful interference to radio communications.

However, there is no guarantee that interference will not occur in a particular installation, If this equipment does cause harmful interference to radio or television reception, which can be determined by turning the equipment off and on, the user is encouraged to try to correct the interference by one or more of the following measures:

- Reorient or relocate the receiving antenna.
- Increase the separation between the equipment and receiver.
- Connect the equipment into an outlet on a circuit different from that to which the receiver is connected.
- Consult the dealer or an experienced radio/TV technician for help.

Caution: Changes or modifications not approved by Innowi could void the user's authority to operate the device.

FCC RF Exposure Information (SAR)

This device is designed and manufactured not to exceed the emission limits for exposure to radio frequency (RF) energy set

by the Federal Communications Commission of the United States.

During SAR testing, this device is set to transmit at its highest certified power level in all tested frequency bands, and placed in positions that simulate RF exposure in usage near the body. Although the SAR is determined at the highest certified power level, the actual SAR level of the device while operating can be well below the maximum value. This is because the device is designed to operate a multiple power levels to use only the power required to reach the network. In general, the closer you are to a wireless base station antenna, the lower the power output.

The exposure standard for wireless employs a unit of measurement known as the Specific Absorption Rate, or SAR. The SAR limit set by the FCC is 1.6W/kg.

The FCC has granted an Equipment Authorization for this model device with all reported SAR levels evaluated as in compliance with the FCC RF exposure guidelines. SAR information on this model device is on file with the FCC and can be found under the Display Grant section of www.fcc.gov/oet/ea/fccid after searching on FCC ID: **2AO2Y-IWCHTM101**.

For this device, the highest reported SAR value for usage near the body measured at (10 mm) is 0.65 W/kg.

While there may be differences between the SAR levels of various devices and at various positions, they all meet the government requirements.

Battery Service and Recycling

All rechargeable batteries have a limited lifespan and may eventually need to be serviced or recycled. If the device needs to be disposed for any reason, the device should be returned to Innowi or its authorized dealer for proper decommissioning.

Support

For any question and comments, please contact your provider or Innowi at support@innowi.com.



World's First Mobile all-in-one, Payment Phablet Quick Startup Guide

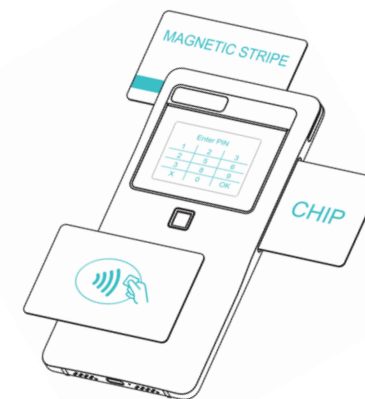

**Payments on-the-go:
Order & Pay Anywhere,
Line Busting,
Mobile Workforce Solutions**

**MSR, EMV Chip &Pin, NFC,
1D/2D barcode scanner
Wi-Fi 2.4G/5G, BT 2.0/4.1
Fingerprint Scanner
Secure PIN**

Smart. Secure. Sophisticated. Simplified.

Setup

SD Card

- a) Use a SD Card Eject tool or a paper clip to remove the SD card into the small hole in the SD Card tray.

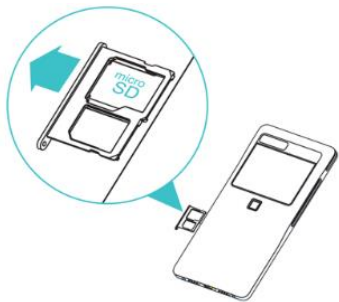

- b) Remove the SD Card tray from the ChecOut M device. When reinserting the SD card, ensure that it is in the proper orientation relative to the tray.

Quick Start Operations Guide

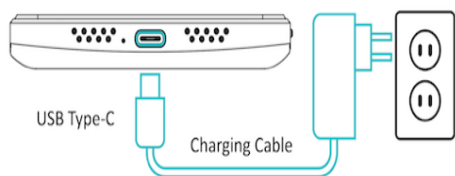

- a) First connect the power adapter cable to the ChecOut M USB-C connector and plug-in to the socket
- b) Turn on the device by pressing the power button for a few seconds. You will see the “ChecOut” display screen turns on and the device begins to power up
- c) For questions related to POS Applications and Payment Processing please visit Innowi website www.innowi.com

ChecOut M Features

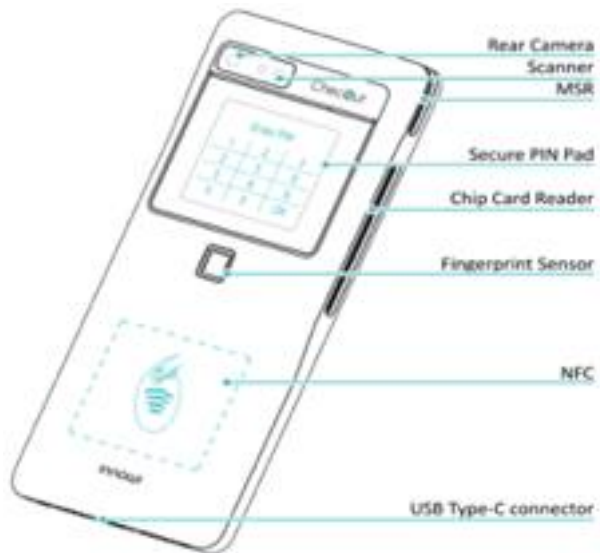
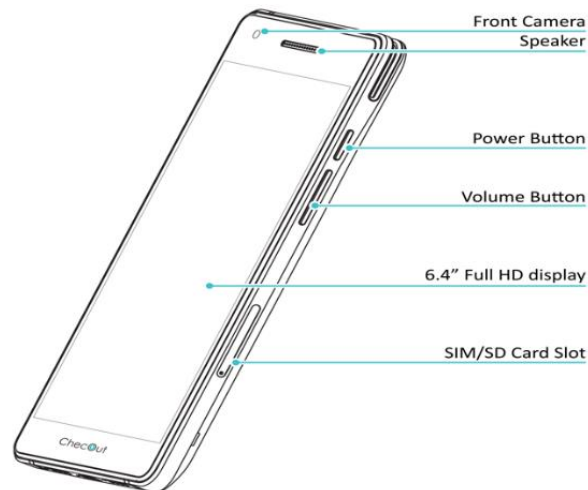

Recommended Usage

ChecOut M phablet is recommended to be held in the non-dominant hand while using your dominant hand to take payments and to carry out other standard phablet operations.

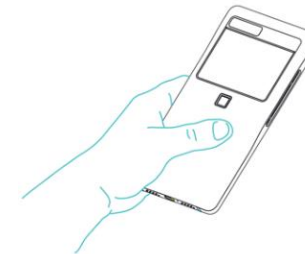

Scanner Operation

Point the ChecOut M phablet towards the barcode on an item for a barcode scan. For best results keep the ChecOut M device within 12 inches from the barcode.



Payment Methods

ChecOut M phablet can be used to take payment using MSR, Chip Card and NFC as shown in the picture below

