

4 in

# wireless speaker

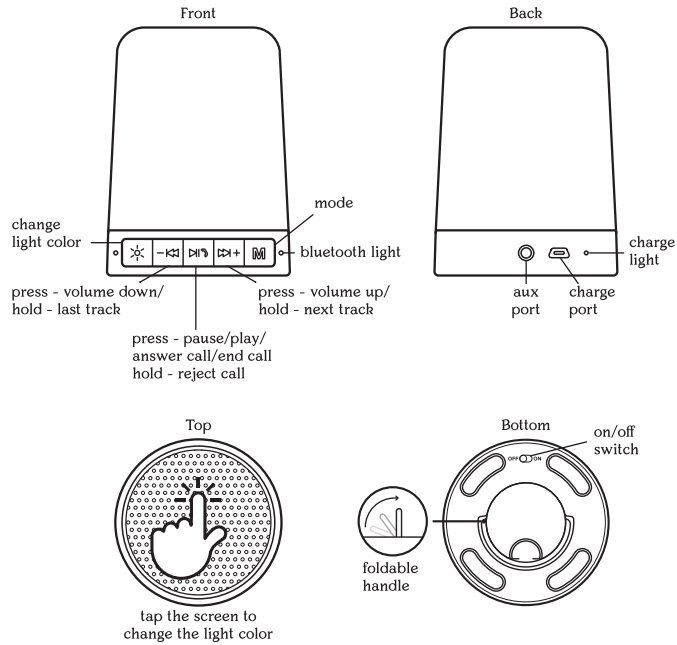

## included

- Bluetooth Speaker
- Micro USB Charging Cable

## pairing

- Power ON speaker using ON/OFF switch
- Rapid flashing white light, followed by a chime
- Use bluetooth settings on your phone to pair with MORE THAN MAGIC O1
- White light turns solid, followed by an echoing chime - pairing successful

front

## indicators

- Solid Red - Charging
- No Red Light - Fully Charged
- Flashing White - Pairing Mode
- Solid White - Bluetooth Connected

- Chirping Tones - Powering on
- Single Chime - Ready to pair
- Echoing Chime - Paired
- Rapid Chirping Tone - Low Battery
- Quick Low Tone - Max Volume/Min. Volume
- Double Chime - AUX Cable Connected

## LED light

- There are 10 options: Soft white, medium white, bright white, red, blue, green, light blue, rainbow, music matching and off

## charging

- Plug micro end of charging cable into back of speaker
- Plug USB end of charging cable into a DC 5V USB power supply

## AUX/mode

- Plug in an AUX cable to override bluetooth
- Switch to bluetooth by pressing mode and unplugging the AUX cable from your device

## troubleshooting

- If the speaker is not working correctly, turn it on/off to reset
- If the speaker won't turn on, recharge the battery and try again
- If the speaker won't charge, make sure the supply works, is 5V>1A, and not damaged
- If the speaker makes no sound or does not show as an available device, make sure it is not paired to another device, if so, unpair the device and re-pair the desired device
- This device does not have a pairing code. If prompted for one make sure you are connecting to the correct device. If you are, "forget" the device and re-pair. If you are still prompted enter 0000

## need some help?

Can't get it to pair? Have a question or comment?



call us at: 877-698-4883 or: 877-MyTgITech

online at: TargetTechSupport.com

## safety

- Do not use near any water source
- Do not modify or repair this device
- Do not use in temperatures or extreme weather
- Do not use chemical detergents to clean your device, use a soft dry cloth

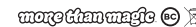

FCC ID: 2A023BTSP46 Model: BTSP46 Input: 5V Max 1A Made in China  
This device complies with Part 15 of the FCC rules. Operation is subject to the following two conditions: 1) this device may not cause harmful interference, and 2) this device must accept any interference received, including interference that may cause undesired operation. Warning: Changes or modifications to this unit not expressly approved by the party responsible for compliance could void the user's authority to operate the equipment.

NOTE: This equipment has been tested and found to comply with the limits for a Class B digital device, pursuant to Part 15 of the FCC Rules. These limits are designed to provide reasonable protection against harmful interference in a residential installation. This equipment generates, uses and can radiate radio frequency energy and, if not installed and used in accordance with the instructions, may cause harmful interference to radio communications.

However, there is no guarantee that interference will not occur in a particular installation. If this equipment does cause harmful interference to radio or television reception, which can be determined by turning the equipment off and on, the user is encouraged to try to correct the interference by one or more of the following measures:

- Reorient or relocate the receiving antenna.
- Increase the separation between the equipment and receiver.
- Connect the equipment into an outlet on a circuit different from that to which the receiver is connected.
- Consult the dealer or an experienced radio/TV technician for help.

Target Corp, Mpls, MN, 55403 Phone: 1-612-304-6073

back

5.6 in