

4 in

desktop tripod

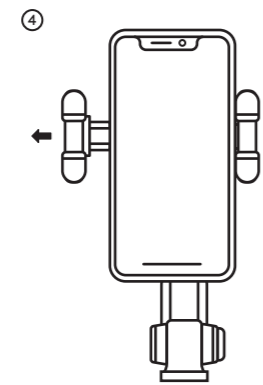
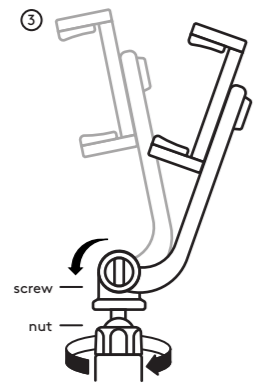
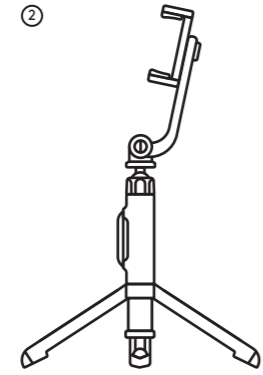
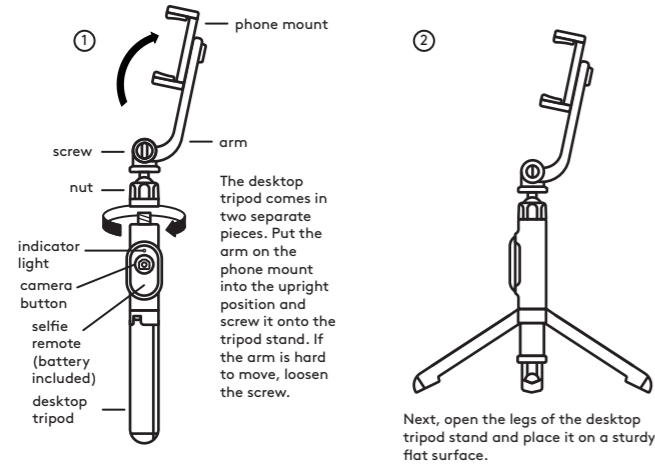

front

included

- Desktop Tripod
- Phone Mount
- Selfie Remote

light indicators

- Flashing White - Ready to Pair
- Solid White - Paired
- Flashing Red - Low Battery

selfie remote

- Remove the selfie remote from the desktop tripod
- Hold the camera button to power on, be sure to remove the protective film on the battery
- The indicator light will flash white when it is ready to pair
- Use the bluetooth settings on your phone to pair with "HEYDAY REMOTE 01"
- The remote is connected when the indicator light turns solid white
- Open the camera on your phone and use the camera button to take pictures
- The remote will enter stand by mode after 10 minutes of no use, it will automatically shut down after 20 minutes of no use; hold the camera button to turn the selfie remote off
- If the indicator light is flashing red the remotes battery is low, replace the CR2032 battery

installation tips

- If the tripod is unstable, try positioning the phone mount over one leg for additional stability
- Be sure not to press down on the tripod stand too forcefully as this may damage the arms
- To avoid damaging your phone, make sure that the nut is fully tightened before placing your phone into the mount
- Always be aware of your surroundings. Do not use the stand as a selfie stick in potentially dangerous situations such as driving, walking, or situations that require your full attention

need some help?

Can't get the stand to stay up? Have a question or comment?



call us at: 877-698-4883 or: 877-MyTgtTech online at: TargetTechSupport.com

WARNING

- Chemical Burn Hazard. Keep batteries away from children. Do not ingest the battery.
- The remote control supplied with this product contains a coin/button cell battery. If the coin/button cell battery is swallowed, it can cause severe internal burns in just 2 hours and can lead to death.
- Keep new and used batteries away from children.
- If the battery compartment does not close securely, stop using the product and keep it away from children.
- If you think batteries might have been swallowed or placed inside any part of the body, seek immediate medical attention.

Battery Warning:

- Insert the battery in the proper direction as indicated by positive (+) and negative (-) markings in the battery holder.
- Remove a depleted battery promptly and recycle or dispose of it in accordance with Local and National Disposal Regulations.
- If a battery leaks, remove it and recycle or dispose of it in accordance with battery manufacturer's instructions and Local and National Disposal Regulations. If fluid from the battery comes into contact with skin or clothes, flush with water immediately.
- Remove the battery if your device is to be stored for an extended period of time without being used.

heyday

FCC ID: 2A023-W518026 Selfie Remote Model: W5-18026 Input: 5V/1A Max. Made in China
 This device complies with Part 15 of the FCC rules. Operation is subject to the following two conditions: 1) this device may not cause harmful interference, and 2) this device must accept any interference received, including interference that may cause undesired operation.
 Warning: Changes or modifications to this unit not expressly approved by the party responsible for compliance could void the user's authority to operate the equipment.
 NOTE: This equipment has been tested and found to comply with the limits for a Class B digital device, pursuant to Part 15 of the FCC Rules. These limits are designed to provide reasonable protection against harmful interference in a residential installation. This equipment generates, uses and can radiate radio frequency energy and, if not installed and used in accordance with the instructions, may cause harmful interference to radio communications. However, there is no guarantee that interference will not occur in a particular installation. If this equipment does cause harmful interference to radio or television reception, which can be determined by turning the equipment off and on, the user is encouraged to try to correct the interference by one or more of the following measures:
 • Reorient or relocate the receiving antenna.
 • Increase the separation between the equipment and receiver.
 • Connect the equipment into an outlet on a circuit different from that to which the receiver is connected.
 • Consult the dealer or an experienced radio/TV technician for help.
 Target Corp, Mpls, MN, 55403 Phone: 1-612-304-6073

RF Exposure Compliance
 This equipment complies with FCC radiation exposure limits set forth for an uncontrolled environment.

back

installation battery

front

back

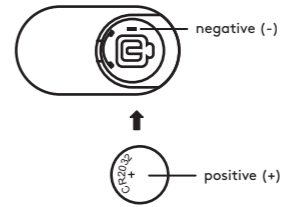
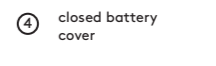
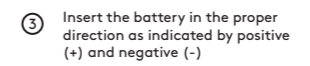
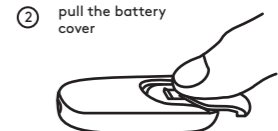
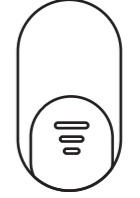
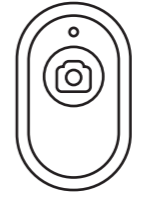

front for additional page

6.67 in