

4.65 inches

Noise Canceling TRUE WIRELESS EARBUDS

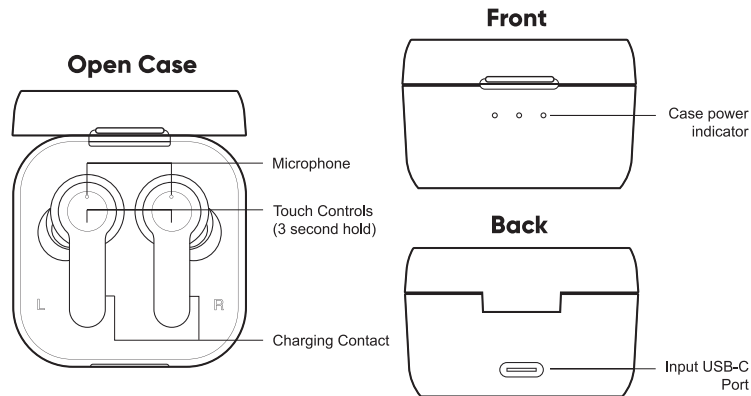

Before you get started:

- High volume may affect your hearing.
- Do not use the unit while driving or cycling or where it's necessary to keep environment awareness. Doing so may cause traffic accidents.
- This product has magnets which may interfere with pacemakers, defibrillators and programmable shunt valves or other medical devices. Do not put this product close to these medical devices and the person who use any of these medical devices.

Whats included:

- TWS Earbuds
- TWS Earbud Case
- USB-C Charging Cable

Indicator:

- Earbud Solid White - Charging
- Earbud No Light - Charging complete
- ⊗ Earbud Rapid Flashing White/Blue - Pairing mode
- ⊙ Earbud Flashing Blue once every 5s - Paired
- ⊙ Earbud Flashing White every 3s - Low power
- ⊙ Case Left Power Indicator Flashing White - Less than 33% charged
- ⊙ Case Left Power Indicator (solid white) and Middle Flashing White - 33%~66% charged
- ⊙ Case Left and Middle Power Indicator (solid white) and Right Flashing White - 66%~99% charged
- ⊙ Case Three Lights - 100% charged

Touch Controls

Quick Tip: the touch sensor is located in the center of the earbud, be sure to touch here so inputs register

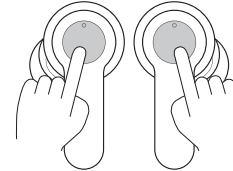

Left earbud	or	Right earbud
⏮ prev. song* 📞 reject call	hold 2 sec.	⏭ next song* 📞 reject call
⏻ turn off	hold 5 sec.	⏻ turn off
⏪ play/pause 📞 answer/end call	• 1 tap	⏪ play/pause 📞 answer/end call
🔊 volume assist	• 2 taps	🔊 volume assist
🗣 voice assist	• 3 taps	🗣 Active ANC/ Ambient

Pairing:

- To pair the earbuds to your device for the first time, Please open the case and take both from case to power on the earbuds.
- The left earbud will flash blue and the right will flash blue and white when they are ready to pair.
- Use the Bluetooth settings on your device to pair with "TWS05". When the earbuds have successfully paired they will flash blue.
- To re-enter pairing mode disconnect from your devices using the bluetooth menu.
- Reset the earbuds to factory settings by turning the earbuds off, and hold the touch controls for 10 seconds.

Troubleshooting:

- If the earbuds are not working correctly place them into the case with the lid open and reset them
- If the earbuds won't turn on, recharge the battery and try again
- If the earbuds won't charge, make sure the power supply works, is 5V>500mA, not damaged and that the case is charged
- If the earbuds still won't charge, make sure the charge pins are clear of debris as this may cause a connection issue; if they are use a soft dry cloth to clean them
- If the earbuds make no sound or do not show as an available device, make sure they are not paired, if so unpair the device and repair to the desired device

Safety:

- Do not use near any water source
 - Do not modify or repair this device
 - Do not use chemical detergents to clean your device, use a soft dry cloth
- WARNING:** The battery (battery or batteries or battery pack) shall not be exposed to excessive heat such as sunshine, fire or the like

FCC ID: 2A023-TWS05 Model: TWS05 Case Input: 5V=500mA Case Output: 5V=240mA Earbud Battery Capacity: 3.7V/40mAh/0.148Wh Case Battery Capacity: 3.7V/380mAh/1.41Wh Made in China
This device complies with Part 15 of the FCC rules. Operation is subject to the following two conditions: 1) this device may not cause harmful interference, and 2) this device must accept any interference received, including interference that may cause undesired operation.

Warning: Changes or modifications to this unit not expressly approved by the party responsible for compliance could void the user's authority to operate the equipment.

NOTE: This equipment has been tested and found to comply with the limits for a Class B digital device, pursuant to Part 15 of the FCC Rules. These limits are designed to provide reasonable protection against harmful interference in a residential installation. This equipment generates, uses and can radiate radio frequency energy and, if not installed and used in accordance with the instructions, may cause harmful interference to radio communications.

However, there is no guarantee that interference will not occur in a particular installation. If this equipment does cause harmful interference to radio or television reception, which can be determined by turning the equipment off and on, the user is encouraged to try to correct the interference by one or more of the following measures:

The device has been evaluated to meet general RF exposure requirements. The device can be used in portable exposure conditions without restriction

- Reorient or relocate the receiving antenna,
- Increase the separation between the equipment and receiver.
- Connect the equipment into an outlet on a circuit different from that to which the receiver is connected.
- Consult the dealer or an experienced radio/TV technician for help.



gemsfindyours.com 7157 Shady Oak RD, Eden Prairie, MN 55344 Distributed by Chug, Inc.

6.5 inches

FRONT

BACK