

■ Pantone Black C

□ Cut Line

magsafe stand/ magsafe pad

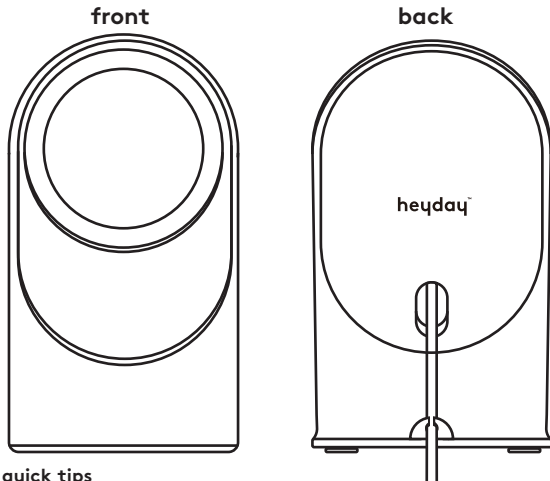

quick tips

- The device should stick firmly to the stand when charging
- Thick phone cases as well as some materials can interfere with MagSafe® charging
- This is a high speed magnetic charging stand, make the most of the charger by using the Power Delivery wall plug that was packaged with it; using a different power source may charge your device at a slower speed

included

- Magnetic charging stand with attached charging cable
- Power Delivery wall plug

charging

- Place the charging stand on a sturdy flat surface
- Connect the Power Delivery wall plug to the wall outlet using the attached USB-C cable (recommended)
- If you need to use a different power source make sure it is a USB power supply of DC 9V 2.22A minimum **warning:** please use UL compliant power supply
- Place your MagSafe® compatible device onto the magnetic charging stand; the device will stick to the stand and the screen will indicate that it is charging (note: MagSafe® compatible device can be placed vertically or horizontally)
- Remove credit cards or any card with a magnetic strip to prevent damage to the cards before charging
- Charge time will vary by device

front

4 in

troubleshooting

- If you're having issues charging use the tips below to help:

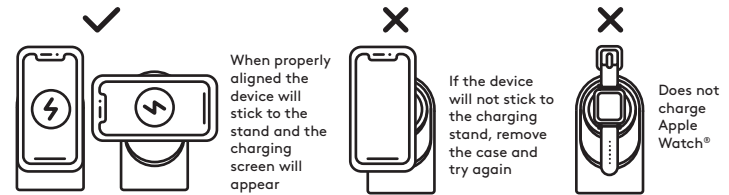

- Double check that the USB-C cable and Power Delivery wall plug are plugged in for best results
- Certain phone cases may interfere with MagSafe® charging; remove the phone case for best results
- Double check the placement of the device on the magnetic charging stand; for best results, the center of the device should be on the center of the magnetic charging stand
- MagSafe® charging is compatible with iPhone® 12 and newer as well as other Qi-enabled devices; please consult your device's user manual if you are unsure if your device is compatible

need some help?

Can't get it to charge? Just have a question?



call us at: 877-698-4883 or: 877-MyTgtTech



e-mail us at: TargetTechSupport.com

safety

- Remove credit cards and other cards with magnetic strips to prevent damage to the cards
- Keep the charger away from heat and direct sunlight
- Do not modify or repair this device
- Do not use in high temperatures or extreme weather
- Do not use chemical detergents to clean your device, use a soft dry cloth
- Immediately unplug it from its power source if it gets wet
- Remove the protective film on the Power Delivery wall plug before using

heyday

FCC ID: 2A023-QIC43 Model: QIC43 Input: DC 9V/2.22A Output: 15W Max. Made in Vietnam
This device complies with Part 15 of the FCC rules. Operation is subject to the following two conditions: 1) this device may not cause harmful interference, and 2) this device must accept any interference received, including interference that may cause undesired operation. Warning: Changes or modifications to this unit not expressly approved by the party responsible for compliance could void the user's authority to operate the equipment.

NOTE: This equipment has been tested and found to comply with the limits for a Class B digital device, pursuant to Part 15 of the FCC Rules. These limits are designed to provide reasonable protection against harmful interference in a residential installation. This equipment generates, uses and can radiate radio frequency energy and, if not installed and used in accordance with the instructions, may cause harmful interference to radio communications.

However, there is no guarantee that interference will not occur in a particular installation. If this equipment does cause harmful interference to radio or television reception, which can be determined by turning the equipment off and on, the user is encouraged to try to correct the interference by one or more of the following measures:

- Reorient or relocate the receiving antenna.
- Increase the separation between the equipment and receiver.
- Connect the equipment into an outlet on a circuit different from that to which the receiver is connected.
- Consult the dealer or an experienced radio/TV technician for help.

This equipment complies with FCC radiation exposure limits set forth for an uncontrolled environment. This equipment should be installed and operated with minimum distance 20cm between the radiator and your body. This transmitter must not be co-located or operating in conjunction with any other antenna or transmitter.

Target Corp. Mpls. MN, 55403 Phone: 612-304-6073

5.7 in

back