

4.65 inches

# Desk Lamp with Wireless Charging

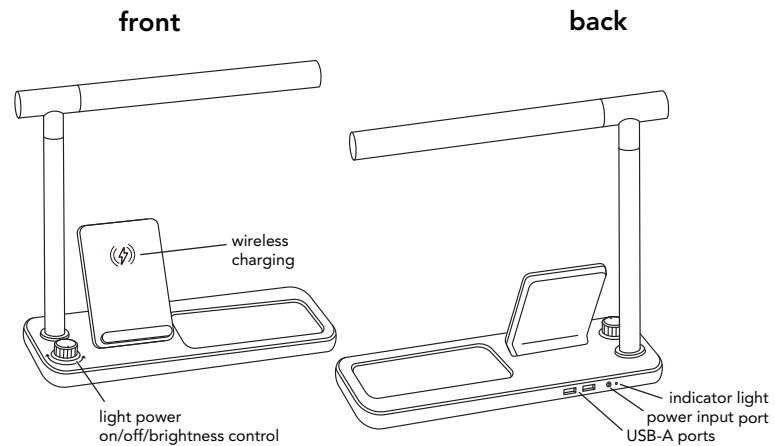

6.75 inches

## Before you get started:

- Make sure that the phone is aligned with the lightning bolt logo on the charging surface for the most efficient charge.
- Thicker or magnetic phone cases as well as some materials like metal may interfere with the ability to wirelessly charge.
- Not all phones can wirelessly charge. If you are unsure if your phone has this capability refer to the manufacturer's user manual.
- If you are using a case that doubles as a wallet be sure to remove credit cards, IDs, and anything with a magnetic strip before charging as they may become damaged.

## Whats included:

- Desk Lamp with Wireless Charging
- Power Supply. Input: 100-240v-50/60Hz 1.2A Output: DC 12V 3A.

## Indicator:

- No Light - Charger is in stand-by mode.
- Solid Blue - Charging your phone.
- Solid Green - Phone is fully charged (Samsung phones only).
- Flashing Blue - Foreign object detection. Pieces of metal or other materials may cause overheating and damage your charger or phone. Remove object immediately.
- Flashing Blue - Over Temperature Protection. The charger has become too warm and is no longer receiving power to ensure charger does not become damaged.

## How to use the light

- Turn the knob to turn the light on and off, as well as control brightness.

FRONT

## How to charge:

- Place the desk lamp on a sturdy flat surface.
- Connect the power supply to the desk lamp and plug it into a grounded wall outlet.
- If you are using a wallet case or wallet pocket remove credit cards or any card with a magnetic strip before charging to prevent damage. If you are using a thicker phone case, a phone case with a metal plate for magnetic accessories, or a case with magnets attached remove them before charging.
- Place your Qi-enabled device onto the wireless charger and align the device with lightning bolt logo of the charging surface or the device may not charge.
- Charge time will vary by device.

## Troubleshooting:

If the charger is not working double check that the power supply is plugged into the desk lamp and a grounded wall outlet.

Certain phone cases may interfere with wireless charging. Remove phone case for best results. Double check the placement of the device on the wireless charger. For best results, the center of the device should be on the lightning bolt logo of the charger. Please refer to the chart below for proper charge placement:

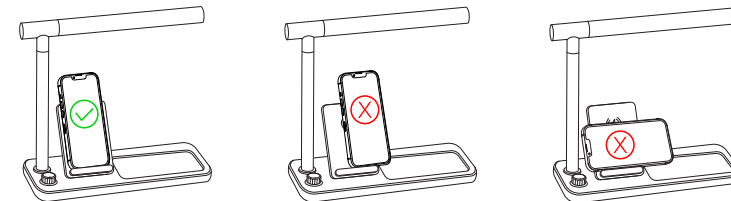

Wireless charging is compatible with iPhone 8 and newer phones as well as other Qi-enabled devices. Please consult your device's user manual if you are unsure if your device is compatible. Note: Apple Watch® is not compatible with this device.

## Safety:

- Remove credit cards and other cards with magnetic strips to prevent damage to them.
- Keep the charger away from extreme heat and direct sunlight.
- Do not modify or repair this device.
- Do not use in high temperatures or extreme weather.
- Do not use chemical detergents to clean your device, use a soft dry cloth.
- Immediately unplug it from its power source if it gets wet.

## THRESHOLD



FCC ID: 2A023-LM3 Model: LM3 Input: DC12V/3A Output: Wireless Charger: 12W Max USB-A: DC 5V/2.4A (each) USB-A total: DC 5V/2.4A Max LED LAMP: 200LM Max. Made in Vietnam

This device complies with Part 15 of the FCC rules. Operation is subject to the following two conditions: 1) this device may not cause harmful interference, and 2) this device must accept any interference received, including interference that may cause undesired operation. Warning: Changes or modifications to this unit not expressly approved by the party responsible for compliance could void the user's authority to operate the equipment.

NOTE: This equipment has been tested and found to comply with the limits for a Class B digital device, pursuant to Part 15 of the FCC Rules. These limits are designed to provide reasonable protection against harmful interference in a residential installation. This equipment generates, uses and can radiate radio frequency energy and, if not installed and used in accordance with the instructions, may cause harmful interference to radio communications.

However, there is no guarantee that interference will not occur in a particular installation. If this equipment does cause harmful interference to radio or television reception, which can be determined by turning the equipment off and on, the user is encouraged to try to correct the interference by one or more of the following measures:

- Reorient or relocate the receiving antenna.
- Increase the separation between the equipment and receiver.
- Connect the equipment into an outlet on a circuit different from that to which the receiver is connected.
- Consult the dealer or an experienced radio/TV technician for help.

This equipment complies with FCC radiation exposure limits set forth for an uncontrolled environment. This equipment should be installed and operated with minimum distance 20cm between the radiator and your body. This transmitter must not be co-located or operating in conjunction with any other antenna or transmitter.

Target Corp. Mpls. MN, 55403 Phone: 612-304-6073

For qualified repair specialists requesting repair information and parts please contact the original manufacturer at customersupport@gemsfindyours.com

BACK