

INCLUDES:  
FREE True Wireless Earbuds  
Charging Case  
Micro USB Charging Cable  
User Manual & Warranty

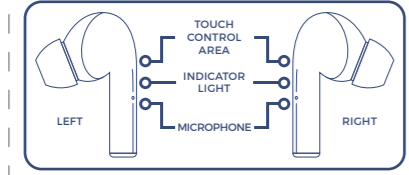

User Manual and Warranty  
MA-3000

### FEATURES STORY



SIMPLE TOUCH CONTROL TO OPERATE ALL FUNCTIONS  
Functions vary depending on your phone, tablet or application.

### FEATURES STORY

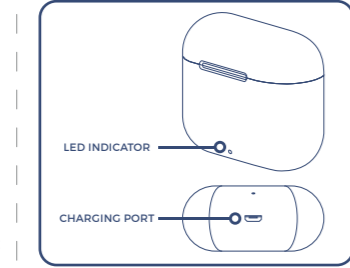

### PRODUCT SPECIFICATIONS

Bluetooth  
Bluetooth profiles  
Connectivity class  
High performance driver  
Frequency response  
Sensitivity  
Impedance  
Charging method  
Battery type  
Battery capacity  
Play time  
Recharge time  
Dimensions

5.0  
A2DP, HSP, HFP, AVRCP  
Bluetooth Class 2 (10 meter)  
2 x Ø8 mm  
20 Hz - 20 kHz  
90dB +/- 3dB at 1kHz  
32 Ω  
Micro USB charging  
Lithium-ion battery  
2 x 30 mAh (earbuds)  
350 mAh (charging case)  
Total 15 hours (Earbuds playtime is 2.5 hours and the charging case can provide 5 times for Earbuds charging)  
Varies by volume level and audio content)  
Approx. 1 hours (earbuds)  
Approx. 1.5 hours (charging case)  
35.8 x 21.8 x 24 mm (LxWxH Earbuds)  
59.6 x 28 x 49.7 mm (LxWxH Charging case)

### OPERATE YOUR EARBUDS

**Bluetooth Connection**  
To use Bluetooth for your audio connection, first pair FREE earbuds with your audio source (music player, smartphone, laptop or other Bluetooth equipped device that can act as audio source). Make sure FREE earbuds is fully charged and turn it on by **take out from the charging box**. When take out both earbuds from the charging box at the same time. The LED indicator light will flash between red and blue, and the left and right earbuds will be paired successfully. At this time, it can be connected to the Bluetooth equipped device. Make sure Bluetooth is enabled on your audio source

and in a few moments 'MUVEACOUSTICS:-FREE' will appear on your list of possible Bluetooth connections. Press 'pair' or 'connect' on your device and after the connection is made, the indicator light will turn to steady blue. (Support single earbud use)  
From now on, when you turn on FREE earbuds, it will automatically search for the last Bluetooth device it was paired with.

### Earbuds Battery Charging

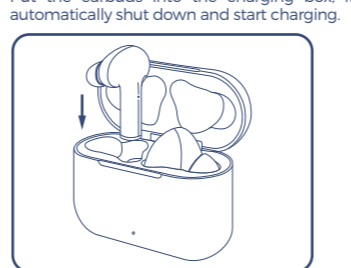

### Charging Case Battery Charging

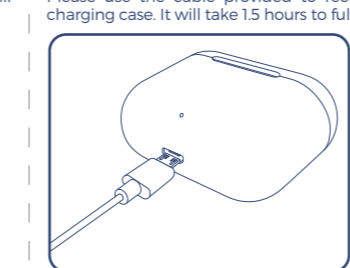

### OPERATIONAL GUIDANCE

Function	Button	Audio	LED
Turn On & the pairing mode	Take out the earbuds from the charging box	N/A	Red/Blue light flashing
Pairing success		2 tones	Blue light
Play / pause	Press the touch control area twice	N/A	N/A
Turn Off	Put the earbuds into the charging box	N/A	LED lights turn off

### OPERATIONAL GUIDANCE

Function	Button	Audio	LED
Incoming call	Press the touch control area twice	N/A	N/A
End a call	Press the touch control area twice	N/A	N/A
Refuse incoming call	Press & hold the touch control area for 2 seconds	N/A	N/A
Voice assistant (depend on the connected device)	Press & hold the touch control area for 2 seconds	1 tone	N/A

### OPERATIONAL GUIDANCE

Function	Button	Audio	LED
Earbuds battery charging	N/A	N/A	Red light goes on constantly (Charging case Green light goes on constantly)
Earbuds battery fully charged	N/A	N/A	Blue light goes on constantly (Charging case Green light keeps on for 10 seconds)
Charging case battery charging	N/A	N/A	Blue light flashing constantly
Charging case battery fully charged	N/A	N/A	Blue light goes on constantly

### JOIN THE COMMUNITY

Sign up now for  
· special offers  
· events  
· contests  
· access to new products launch

www.muveacoustics.com/community

封面 (cover) 封底 (back cover)

55 mm(H)

Thank you for trusting MUVEACOUSTICS with delivering you excellence in sound. We encourage you to connect with us and become a part of our community!  
SCAN THE QR CODE YOU WILL FIND INSIDE. SHARE WITH US YOUR PRODUCT EXPERIENCE.



MuveAcoustics  
muveacoustics\_  
MuveAcoustics

### SAFETY INSTRUCTIONS

**Warnings**  
• Contains small parts which may be a choking hazard. Not suitable for children under age three.  
• Set a low volume setting before using the earbuds.  
• Long-term exposure to loud music or sounds may cause hearing damage. It is best to avoid high volume levels when using these earbuds, especially for extended periods.  
• Do not use these earbuds when operating a motor vehicle, a bicycle, machinery or where your inability to hear outside sounds may present a danger to you or others.  
**Cautions**  
• Using these earbuds limits your ability to hear

noises around you, regardless of listening volume. Please use caution when using these earbuds.  
• Do not drop, sit on, or allow the earbuds to be immersed in water.  
⌚ This symbol indicates that this product shall not be treated as household waste. Instead it shall be handed over to the applicable collection point for the recycling of electrical and electronic equipment.  
⚠ Unsuitable for children under three years because it might, for instance, contain small parts.  
⚠ To prevent possible hearing damage, do not listen at high volume levels for long periods.

⚠ The input voltage to the product is 5V 1A. For your safety, please always use appropriate 5V input charger/Adapter to charge the product. DO NOT USE Quick Charging USB Adapter to charge the product, as it might damage the product. Only charge the product at ambient temperatures between 10 deg °C / 50 deg °F and 40 deg °C / 104 deg °F. Do not heat above 70 deg °C / 158 deg °F. Do not expose to sunlight or throw into fire. Switch off the product after use. Please note that we won't take any responsibility for any wrong operation (eg. Voltage higher than 5V) as this may result in severe injury or loss of property, and we cannot control the operating process during

the time the user using this product. In extreme cases, abuse or misuse of Lithium battery pack can lead to explosion, heat generation, fire development or smoke development.  
**FCC Statement**  
NOTE: This equipment has been tested and found to comply with the limits for a Class B digital device, pursuant to part 15 of the FCC Rules. These limits are designed to provide reasonable protection against harmful interference in a residential installation. This equipment generates uses and can radiate radio frequency energy and, if not installed and used in accordance with the instructions, may cause harmful interference to radio

communications. However, there is no guarantee that interference will not occur in a particular installation. If this equipment does cause harmful interference to radio or television reception, which can be determined by turning the equipment off and on, the user is encouraged to try to correct the interference by one or more of the following measures:  
Reorient or relocate the receiving antenna.  
- Increase the separation between the equipment and receiver.  
- Connect the equipment into an outlet on a circuit different from that to which the receiver is connected.  
- Consult the dealer or an experienced radio/TV technician for help.

Changes or modifications not expressly approved by the party responsible for compliance could void the user's authority to operate the equipment. This device complies with Part 15 of the FCC Rules. Operation is subject to the following two conditions: (1) this device may not cause harmful interference, and (2) this device must accept any interference received, including interference that may cause undesired operation. The device has been evaluated to meet general RF exposure requirement. In portable exposure condition without restriction.

**MUVEACOUSTICS ONE-YEAR LIMITED WARRANTY**  
MUVEACOUSTICS FREE earbuds have been subjected to a thorough series of tests to ensure the highest level of dependability. It is unlikely that you will experience any problem, but if a defect should become apparent during the use of this product. MUVEACOUSTICS warrants to the original purchaser that this product will be free from defects in material and workmanship for a period of 12 months from the date of your original purchase from an authorized dealer. If a defect covered by this warranty occurs,

MUVEACOUSTICS, at its option, will repair or replace the product purchase at no repair charge (postage charges will apply). If a replacement is necessary and your product is no longer available, a comparable product may be substituted at the sole discretion of MUVEACOUSTICS.  
This warranty does not cover normal wear and tear, abusive use or misuse, modification, tampering or by any other cause not related to either materials or workmanship. This warranty does not apply to product used for any industrial, professional or commercial purposes.

**CUSTOMER SERVICES**  
For service on any defective under 12 months warranty policy, please contact Consumer Support.  
Email: consumersupport@zeeva.com  
Keep all relevant information for future reference  
Imported and distributed by Zeeva Electronics Private Limited. All rights reserved.  
901-902, Trade World C wing Kamlia Mill Compound, Senapati Bapat Marg, Lower Parel West, Mumbai-400013  
20202905

55 mm(W) 3 mm(W) thickness of booklet

面 (front)

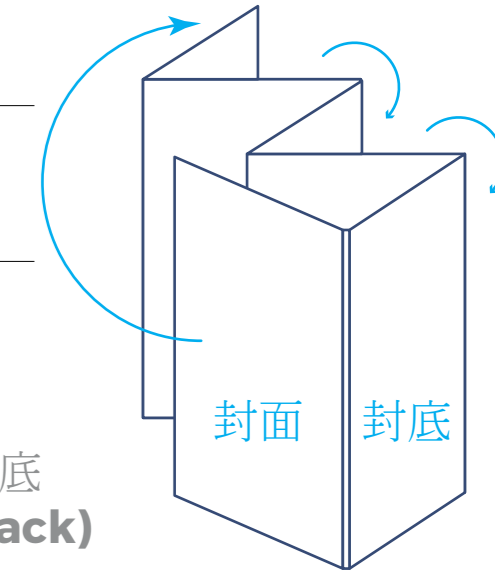

底 (back)

摺法示意图