

# HUDWAY DRIVE FIRST USE GUIDE

## SEE WHAT'S IN THE BOX

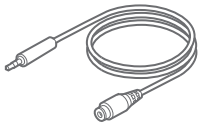

AUX to RCA cable

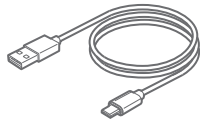

USB to Micro B cable



Power adaptor



Cable clips

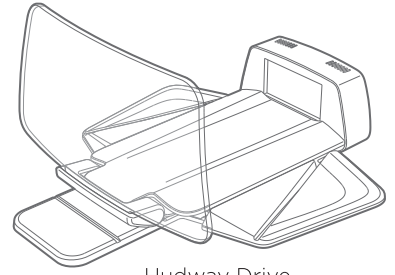

Hudway Drive

## DEVICE INSTALLATION

1. Place the device on the dash in front of you and open its lens at 90°.
2. Adjust the device position so that the rectangle image appears centered on the lens.

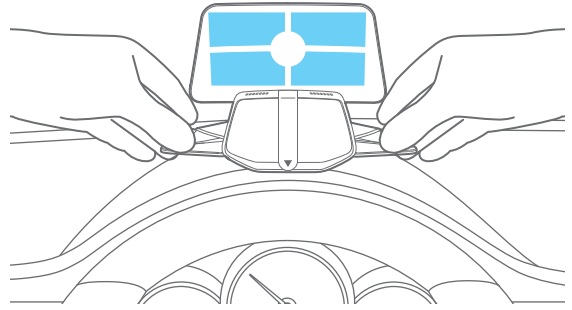

3. Stick the marker strip onto the dash under the device so that the triangle marks on both strips are aligned. This will mark the center of the device position for installation.

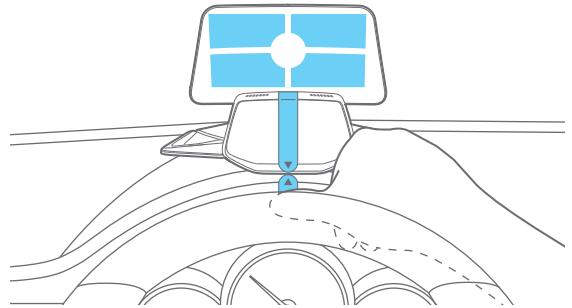

4. Plug the USB to Micro B cable in the mount port.

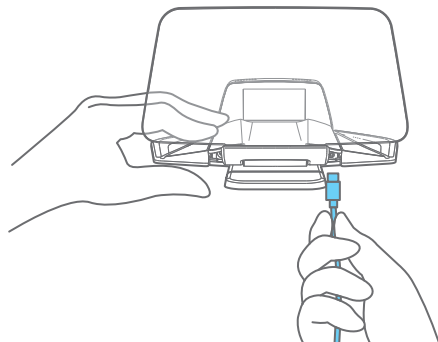

5. Remove the protective layer from the bottom of the mount.
6. Align the device with the sticker and gently press the mount flaps to affix the device to the dash.

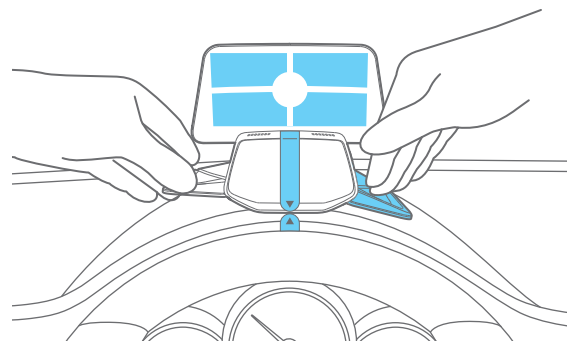

7. Dismount the device from the mount not to damage it while further fixing the mount on the dash.

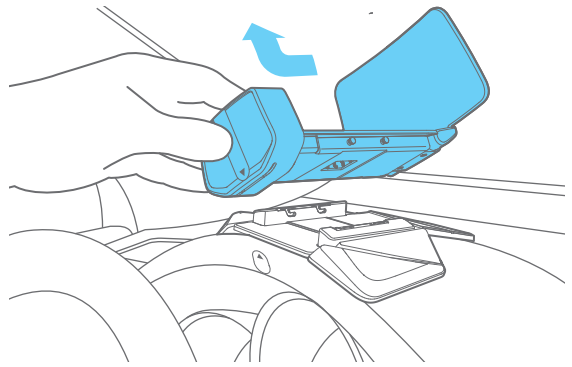

8. Keep pressing the mount gently from the center out to the flaps until it's fixed firmly.

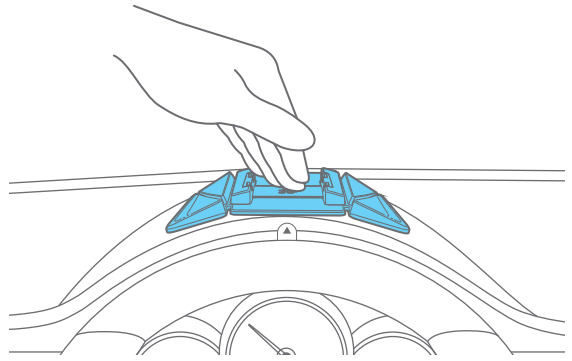

9. Affix the cable using the cable clips.  
10. Remove the stickers and the protective film from the lens.

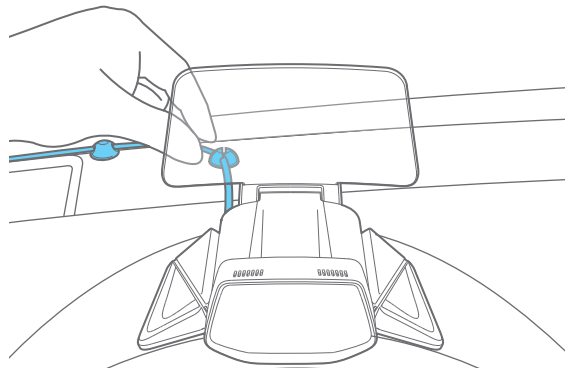

## POWER IT ON AND CONNECT TO YOUR SMARTPHONE

1. Plug the cable running from the mount into the power adaptor, and then plug the latter in the cigarette lighter receptacle.
2. Launch HUDWAY Drive app on your smartphone to connect to the device.
3. Preset the widgets and notifications to appear on HUD, or select to mirror your phone screen.

**You're all set! Enjoy your ride!**



You can connect external cameras to the device using the enclosed AUX to RCA cable. Learn how to do it on [hudway.co/cameras](https://hudway.co/cameras)

## HUDWAY SUPPORT SERVICE



Scan the code to access the most recent information about new features and updates, detailed set-up guides and FAQ in HUDWAY Drive Help Center or go to [hudway.co/drive/hc](https://hudway.co/drive/hc).

Still can't figure it out? Email us at [support@hudway.co](mailto:support@hudway.co) for help.

## **FCC STATEMENT :**

This device complies with Part 15 of the FCC Rules. Operation is subject to the following two conditions:

- (1) This device may not cause harmful interference, and
- (2) This device must accept any interference received, including interference that may cause undesired operation.

**Warning:** Changes or modifications not expressly approved by the party responsible for compliance could void the user's authority to operate the equipment.

NOTE: This equipment has been tested and found to comply with the limits for a Class B digital device, pursuant to Part 15 of the FCC Rules. These limits are designed to provide reasonable protection against harmful interference in a residential installation. This equipment generates uses and can radiate radio frequency energy and, if not installed and used in accordance with the instructions, may cause harmful interference to radio communications. However, there is no guarantee that interference will not occur in a particular installation. If this equipment does cause harmful interference to radio or television reception, which can be determined by turning the equipment off and on, the user is encouraged to try to correct the interference by one or more of the following measures:

- Reorient or relocate the receiving antenna.

- Increase the separation between the equipment and receiver.

- Connect the equipment into an outlet on a circuit different from that to which the receiver is connected.

- Consult the dealer or an experienced radio/TV technician for help.

## **FCC Radiation Exposure Statement:**

This equipment complies with FCC radiation exposure limits set forth for an uncontrolled environment. This equipment should be installed and operated with minimum distance 20cm between the radiator & your body.