

PEIKER | CEE

Communication Device

CEEEOACH^{PLUS}

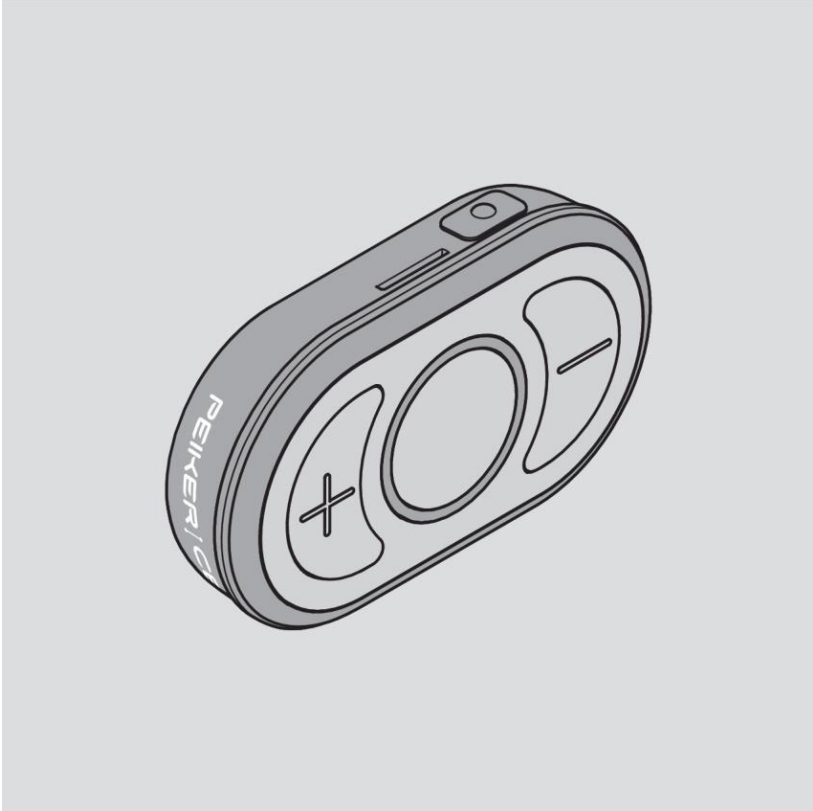

Instruction manual

English translation of the original instruction manual

09/2020

Table of contents

Notes on the manual and the manufacturer	3
Keep manual available	3
Online available information	3
Design features in the text.....	3
Copyright.....	4
Manufacturer address	4
Security.....	5
Intended use	5
Basic Safety Instructions.....	5
Design features of the warning notices	7
Design features of the indications of material damage.....	7
Description	8
Scope of delivery.....	8
Task and function.....	9
Control Elements.....	10
Indications in the light ring.....	11
Unpacking and checking the scope of delivery	12

Putting the device into operation.....	13
Connect device to a Bluetooth headset	14
Wear the device on your belt.....	16
Attach the device to the upper arm.....	18
Switching the device on and off.....	19
Switch microphone on and off (mute function).....	20
Adjust volume	21
Create a group.....	22
Charge device	25
Resetting the device to the basic setting.....	27
Troubleshooting.....	28
Cleaning the device	29
Store and transport the device.....	30
Dispose of the device.....	31
Technical data	32
Guarantee statements	34
EU Declaration of Conformity.....	35
FCC-Note	36
RF Radiation Exposure Statement.....	37
Canada, Industry Canada (IC) Notices.....	38

Notes on the manual and the manufacturer

These instructions will help you to use the CEECOACH ^{PLUS} device safely with 01.00.xx or higher versions.

The device CEECOACH ^{PLUS} is called "device" in the following.

Keep manual available

This manual is part of the device.

Make sure that this manual is always available for you.

Always download the latest manual after an update.

Online available information

Information about new features and updates for the device can be found in the newsletter and social media as well as at www.peiker-cee.de.

Design features in the text

normal text

- Enumeration

Action steps

 Tips contain additional information.

Copyright

This manual contains information that is subject to copyright. This manual may not be copied, printed, filmed, processed, duplicated or distributed in any form, either in whole or in part, without the prior written consent of peiker CEE GmbH.

©2020 peiker CEE GmbH

All rights reserved.

Manufacturer address

peiker CEE GmbH

Gartenstraße 25

D-61352 Bad Homburg

Phone: +49-6172-1797-500

E-mail: info@peiker-cee.de; ceecoach@peiker-international.com

Internet: www.peiker-cee.de; www.peiker-international.com

Security

Intended use

The device is used for group communication in the sports and leisure sector. A maximum of 16 participants can communicate in a conference with the device.

The range between the participants is up to 500 meters.

Reading and understanding this manual is also part of the intended use. Furthermore, you must observe and follow all information in this manual, especially the safety instructions. Any other use is expressly considered improper.

Basic Safety Instructions

Avoid serious injury or death from explosions

The device has no approval according to the ATEX directive for use in potentially explosive atmospheres.

- ▶ Only use the device in areas where there are no special requirements for explosion protection exist.

Avoid danger of suffocation

Small parts are included in the delivery. Children can use the small parts at Play swallow and suffocate.

- ▶ Make sure that the small parts do not get into the hands of children.

Avoid hearing damage

Too high volume levels can irreparably damage your hearing.

- ▶ Avoid continuous exposure to sound at maximum volume.

Avoid environmental damage

- ▶ Dispose of the device and its components according to the regulations in force at the place of use applicable provisions.

Avoid headset cable break

- ▶ Only touch the cable at the plug for insertion or removal.

Avoid damage to the device due to incorrect cleaning

Cleaning with harsh cleaning agents can damage the device.



- ▶ Only use a soft cloth to clean the device when it is slightly dirty.
- ▶ Use only gentle cleaning agents for heavy soiling. Make sure that the cleaning agent does not attack the housing parts and buttons by trying it out on a concealed area.

Avoid damage to the device due to improper repair

- ▶ Never open the housing of the device.
- ▶ Have the device repaired by qualified personnel only.

Design features of the warning notices

 WARNING	
	Notes with the word WARNING warn of a dangerous situation that could possibly lead to death or serious injury.

 CAUTION	
	Notes with the word CAUTION warn of a situation, which can lead to light or medium injuries.

Design features of the indications of material damage

ATTENTION!	
	These notes warn of a situation that could lead to material damage and limited functionality.

Description

Scope of delivery

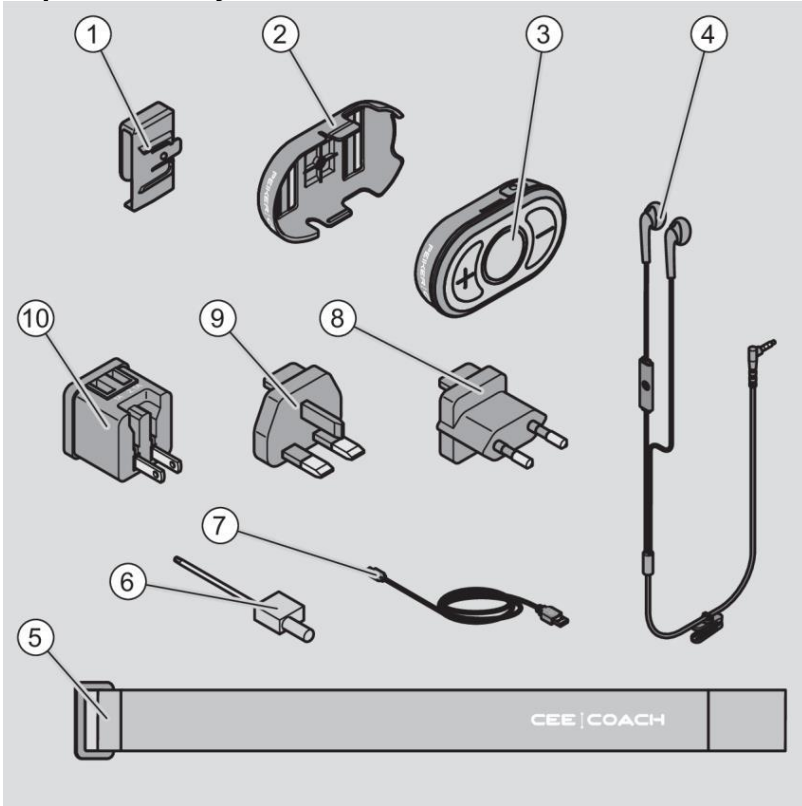

No.	Designation
1	Belt clip (x2 in the Duo Set)
2	Mount (x2 in the Duo Set)
3	Device (x2 in the Duo Set)
4	Headset (x2 in the Duo Set)

No.	Designation
5	Velcro (x2 in the Duo Set)
6	Screwdriver
7	USB C cable (x2 in the Duo Set)
8	Plug (country-specific)
9	Plug (country-specific)
10	Battery Charger

Task and function

The device is used for group communication in sports and leisure time. A maximum of 16 participants can communicate with the device in one conference.

The range between the participants is up to 500 meters.

Control Elements

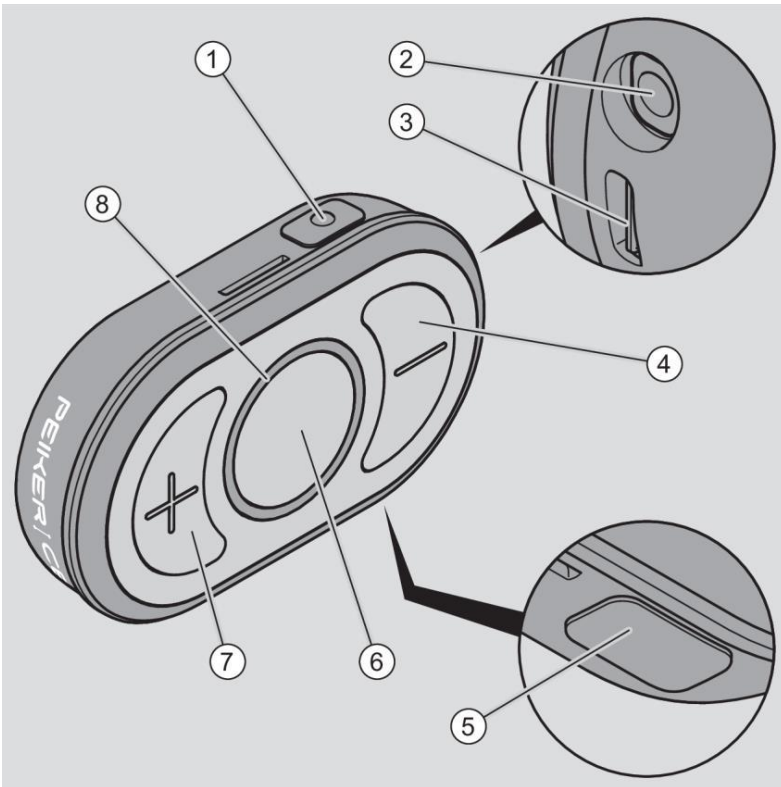

No.	Designation
1	Function key for connecting the device to other devices
2	Connection socket for headset
3	USB socket for USB-C cable
4	Minus key: decrease volume
5	Function key for connecting the device to other devices or with the Bluetooth headset
6	Main key: Switch device on and off Switch microphone on and off
7	Plus key: Increase volume
8	illuminated ring

Indications in the light ring

Color	Meaning
Red	Battery almost empty (less than 30 % charged)
Yellow	Battery charged between 30 and 70
Green	Battery more than 70 % charged Device is connected and at least one device is in transmit and receive range
White	There is no connection to the other devices
Cyan	Device is connected, but there is no other device in the transmit and receive area
Blue	Device can be connected to a Bluetooth headset
Magenta	The microphone is switched off

Unpacking and checking the scope of delivery

WARNING



Small parts are included in the delivery.

Children can swallow the small parts while playing and choke on it.

Make sure that the small parts do not fall into the hands of children.

- ▶ Remove the parts of the device from the original packaging.
- ▶ Keep the original packaging for possible return.
- ▶ Check that all parts of the device have been supplied.
- ▶ Check that the parts are in perfect condition.
- ▶ Contact the manufacturer if parts are missing or are damaged

Putting the device into operation

- ▶ Switch the unit on (see section "Switching the unit on and off").
- ▶ Use the headset as described in the GA of the respective manufacturer.
- ▶ When using a Bluetooth headset, proceed as described in the "Connecting Device to a Bluetooth Headset" .
- ▶ Connect the device to an other devices you want to use.

You can share the device with up to 15 other devices in a group.

- ⓘ The devices in the Duo Set are connected to each other in the delivery condition.

Connect device to a Bluetooth headset

- ▶ Switch the unit on (see section "Switching the unit on and off").
- ▶ Switch the Bluetooth headset on.
- ▶ Make sure that the Bluetooth headset is in pairing mode. Follow the instructions in the Bluetooth headset user manual.
- ▶ Press the function key (1) on the device.

The light ring shines blue in a circular pattern. During this time you can with a Bluetooth headset.

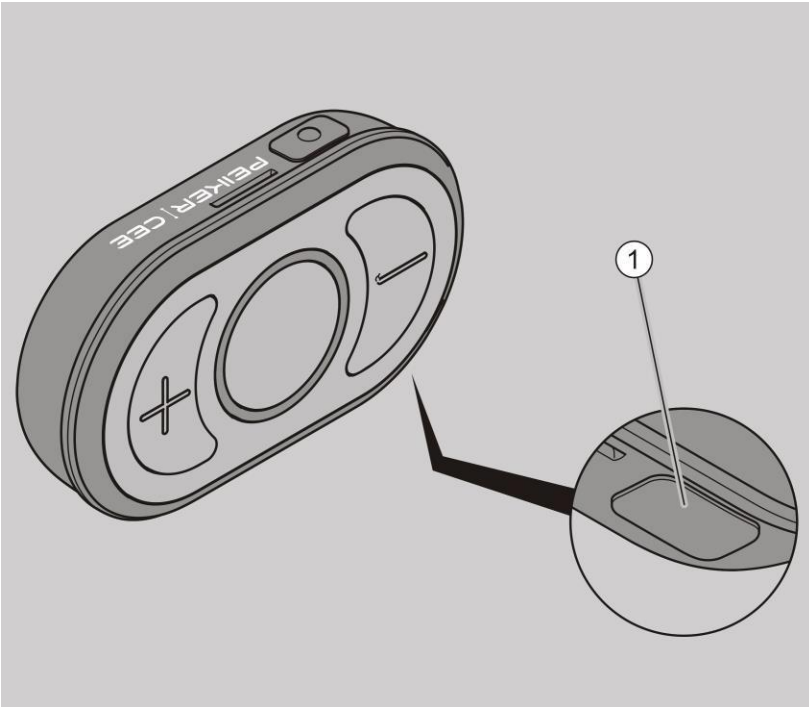

If the connection is not successful, this could be have the following causes:

- The Bluetooth headset does not allow pairing.
 - The battery of the Headset is discharged.
- ▶ Make sure that the Bluetooth headset allows pairing.
- ▶ Proceed as described in the operating instructions for the Bluetooth headset.

Wear the device on your belt

ATTENTION!

Damage to the device due to incorrect wearing is possible.
If possible, attach the device to the belt with the supplied belt clip
or wear it securely on your upper arm.
Do not drop the device.
Avoid shock loads.

- ▶ Attach the holder to the device.
- ▶ Push the belt clip (1) over the holder (2) until the locking lever (5) audibly engages.
- ▶ Hook the device together with the belt clip (2.) on the belt (3).

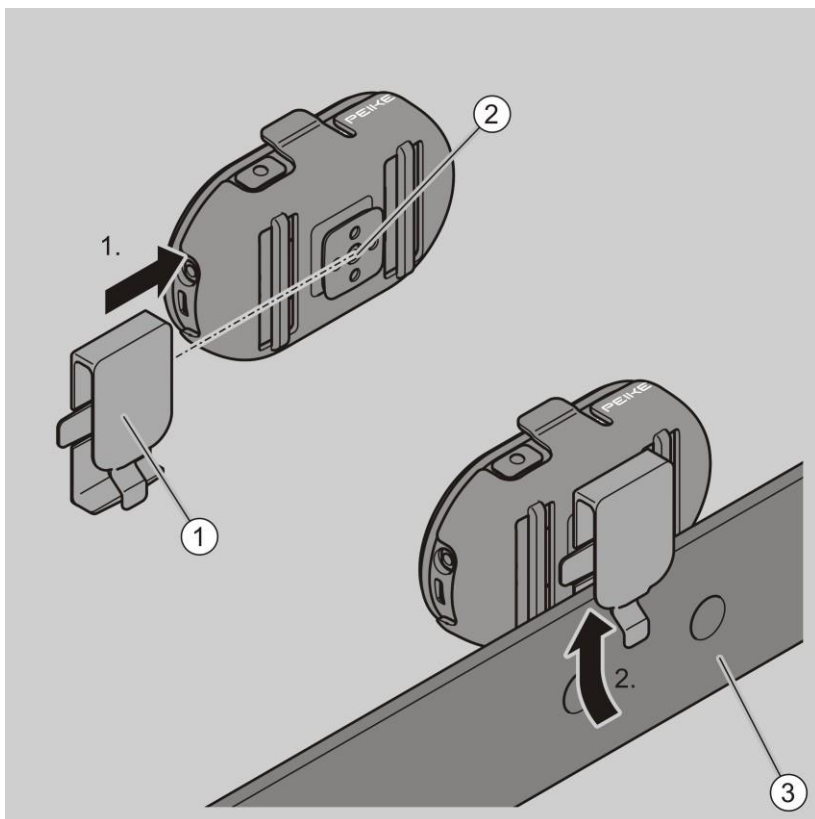

i Alternatively, you can thread the belt through the belt clip.

- ▶ To remove, lift the nose of the belt clip and pull the device together with the belt clip off the belt.
- ▶ To remove the belt clip, pull the locking lever upwards and remove the belt clip from the device.

Attach the device to the upper arm

- ▶ Remove the holder (1.) on the bracket. Use the supplied screwdriver.
- ▶ Guide the Velcro tape (2) through the loops (1) as shown (2.) and pull it through to the end.
- ▶ To attach the device to your upper arm, pass the velcro through the flap.
- ▶ Put your arm through the loop and fix the device with the Velcro on your upper arm.

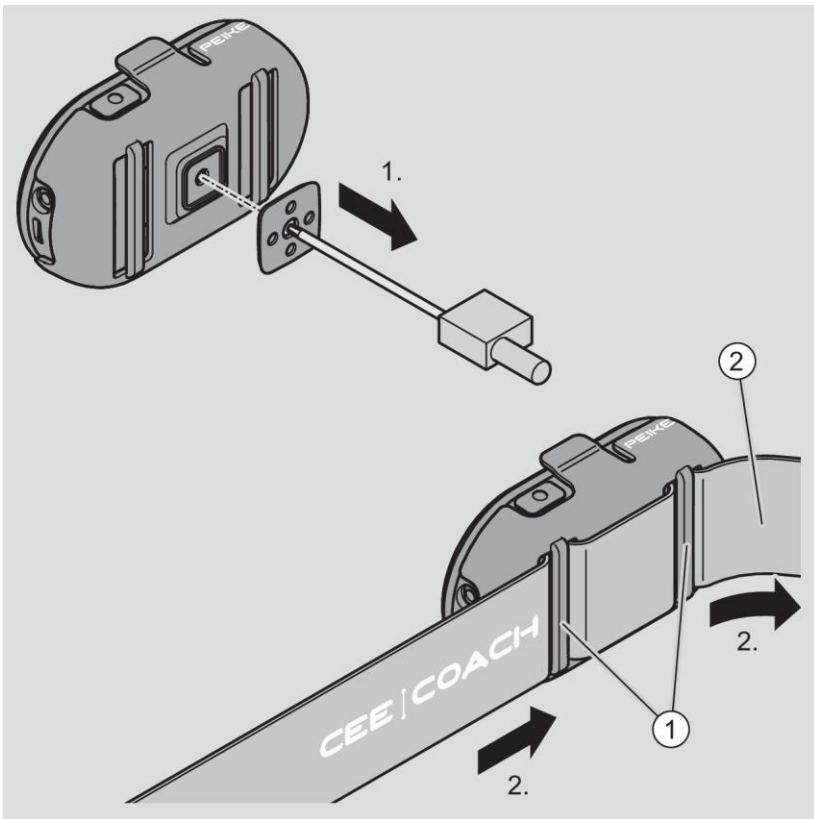

Switching the device on and off

- ▶ To switch on the device, press and hold the main button for at least 3 seconds.

The light ring then displays a color for 3 seconds (depending on the battery charge: green, orange, or red). You will also hear the message "Power on". The light ring flashes 3 times in cyan or white if the device is not connected to any other device. Then the light ring flashes green once every 3 seconds if the device is connected to other devices.

- ▶ To switch off the device, press and hold the main button again for at least 3 seconds.

The light ring then displays a color for 3 seconds (depending on the battery charge: green, orange, or red). You will also hear the message "Power off".

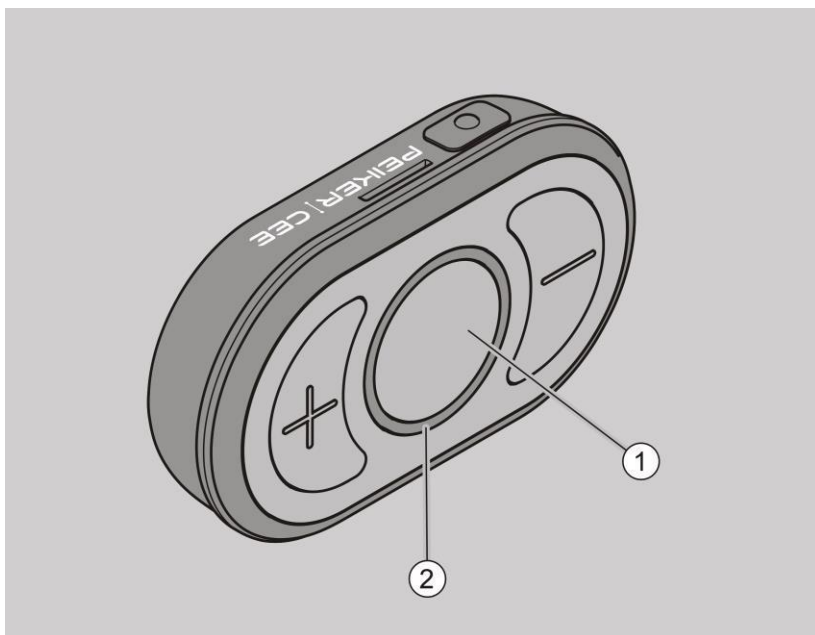

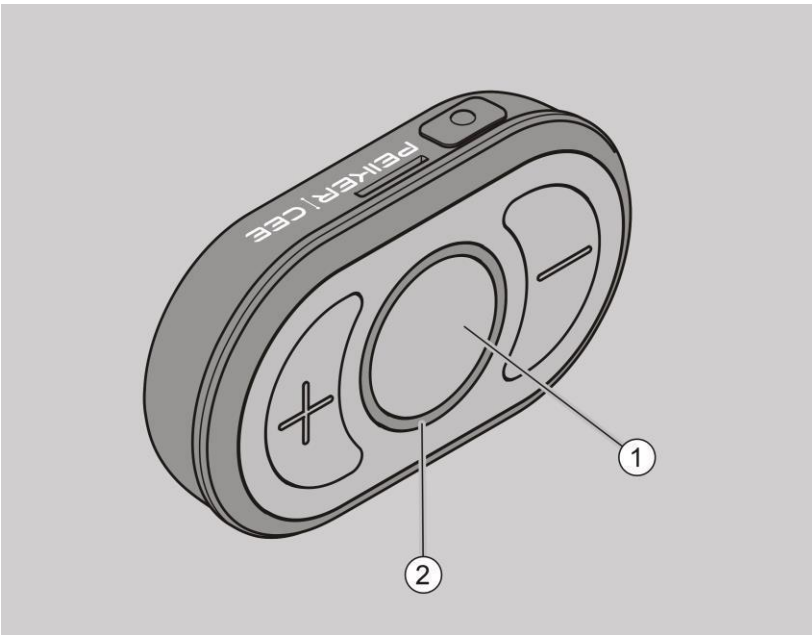

Switch microphone on and off (mute function)

- ▶ To mute the microphone, press the main button briefly. You will hear the message “Muting on”. The light ring flashes magenta. Now you will not be heard by other connected participants.
- ▶ To unmute the microphone, press the main button briefly again. You will hear the message “Muting off”. Now you will be heard by the connected participants again.



Adjust volume

 CAUTION	
	Damage to hearing possible due to too loud noises. Avoid continuous exposure to sound at maximum volume.

- ▶ To increase the volume, press the Plus key step by step.

The device becomes louder in 1/12 steps. The color display in the light ring becomes larger. At maximum volume, the light ring lights up completely green.

- ▶ To reduce the volume, press the Minus key step by step.

The device becomes quieter in 1/12 steps. The color display in the light ring will

smaller. At minimum volume only one LED is lit.

- ▶ To change the volume quickly, hold the Plus or Minus key pressed.

Create a group

You can create a group with up to 15 other devices. The distance between the devices must be under 30 ft while connecting.

- ▶ Make sure that the devices to be connected are within range.
- ▶ Switch on the devices (see "Switching the device on and off" from page 6).
- ▶ Press the function buttons on the devices (1, 2) simultaneously for at least one second to put the unit into pairing mode.

The light ring fills up with a color for 30 seconds and connects with all other devices currently in pairing mode. Then through your headset, you will hear the message "Device is connected" if at least one other device has been successfully connected. The light ring flashes green. If no other connection has been made, the light ring flashes white. If this occurs, repeat all previous steps with all units.

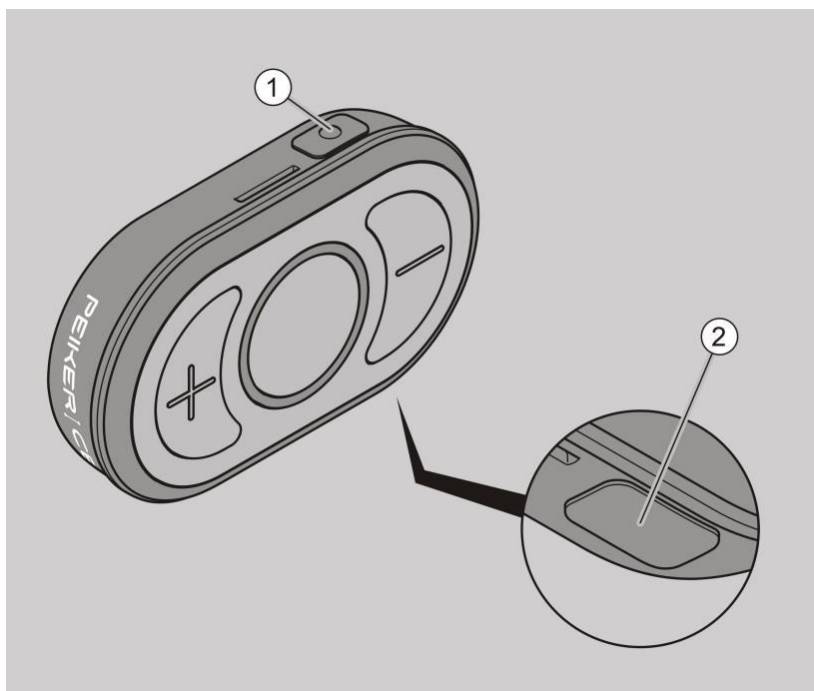

Charge device

WARNING



Fire possible due to overheated components.
Never charge the battery unattended.

You want to check the charge status of your device

- switch the device on or off, during this process the loading status is displayed.

If the battery is less than 30% charged, you should charge the device.

Plug the USB-C cable plug (2) into the USB socket (1).

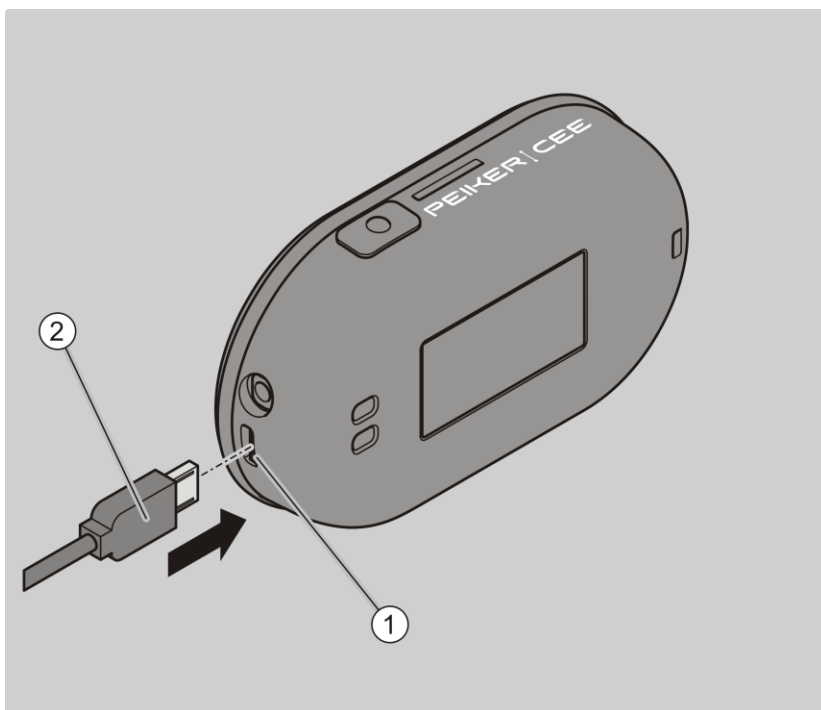

- ▶ Connect the other USB plug to the charger.
- ▶ Connect the charger to a suitable power socket.

The charging time depends on the ambient temperature and the Power of the charger.

When the battery of the device is charged, the light ring will light up green when the device is switched off.

Resetting the device to the basic setting

- ▶ Make sure that the device is switched on.
- ▶ Press the main key (1) and the plus and minus key simultaneously and hold for more than five seconds.

The light ring (2) shines green twice, white once and then orange. The device is switched off.

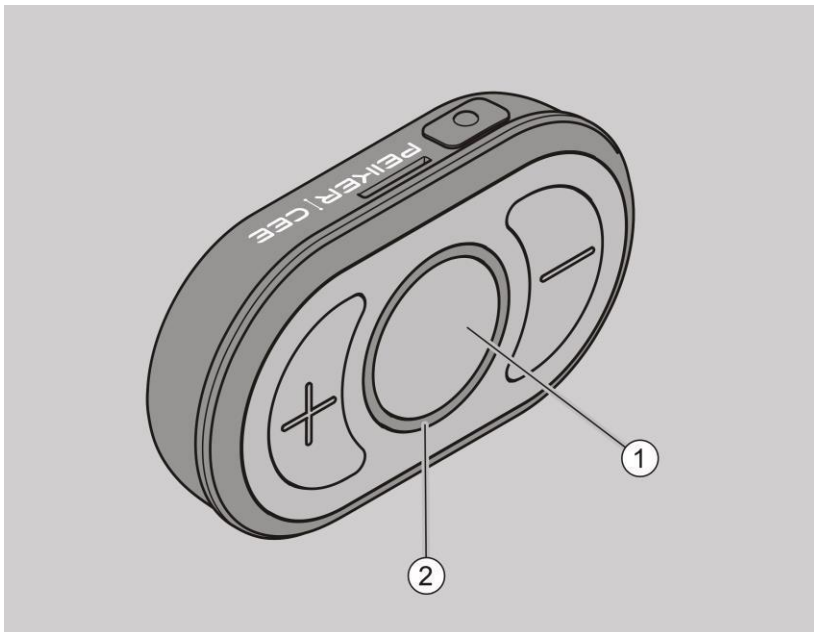

The following settings are deleted, among others:

- existing connections to the other devices
- existing connection to the Bluetooth headset.

Troubleshooting

Problem	Possible cause	Remedy
Device cannot be connected to the other devices	<ul style="list-style-type: none"> The other devices are out of range. 	Make sure that the devices are within the maximum distance of 10 m.
Communication does not work	<ul style="list-style-type: none"> Microphone is switched off Participants are not in the send and receive mode Reception area 	<p>Make sure that the microphone is switched on.</p> <p>Make sure that you are in the transmitting and receiving area.</p>
Device cannot be paired with the Bluetooth headset	<ul style="list-style-type: none"> The Bluetooth headset does not allow pairing The Bluetooth headset is not loaded 	<p>Make sure that the Bluetooth headset allows pairing</p> <p>Make sure the Bluetooth headset is charged. Repeat the process.</p>

i On the peiker CEE Internet page you will find a list of frequently asked Questions (FAQ), which is constantly updated. Also check there if there is an answer for your problem.

Cleaning the device

ATTENTION!

Damage to the device possible by using strong cleaning agents.

Use only mild detergents for heavy soiling cleaning agent.

- ▶ Clean the device and the headset if necessary with a light moistened cloth.
- ▶ If the device is heavily soiled, clean it only with mild Cleaning agents, e.g. dishwashing detergent.

Store and transport the device

- ▶ Store the device and its components in a dry, dust-free place.
- ▶ Use for storage and transport for example the optionally available transport bag.

Dispose of the device

At the end of its service life, the device and its components must be disposed of in an environmentally friendly manner.

- ▶ Dispose of the device in accordance with the regulations applicable at the place of use.
- ▶ In case of doubt, contact your city or municipal administration.

The device consists of:

- Housing made of plastic
- Electronic components
- Batteries (Li-Ion)



Technical data

Number of users	2-16 participants
Dimensions (W x H x D)	97 x 57 x 22 mm
Weight	96 g
Mounting	Clip can be locked in 90° steps
Display	illuminated ring with 12 LEDs, multicolor
Number of keys	5 buttons
Headset connection	Bluetooth headset or standard 3.5 mm jack
Device connection	USB-C
Connection charger	USB-A
Call time (/operating time)	up to 14 hours
Charging time / charging time	up to 3 hours
Ambient temperature for charging the battery	+5°C to +45°C
Operating temperature	-10°C to 45°C
Protection class	IP67 certification (splash-proof, dustproof, shockproof)
Reach	up to 700 m in free field
Radio standards	Bluetooth® 4.2, HSP, HFP
Housing color	black / green or yellow or black
Key color	black
Power supply	Lithium-ion battery, 2000 mAh
Update	via USB
Certification	CE (Europe), FCC (USA), ISED (Canada), ACMA (Australia)

PEIKER | CEE

Guarantee statements

peiker CEE GmbH (peiker Consumer Electronics Evolution GmbH) grants a manufacturer's warranty of two years from the date of purchase on all parts included in the scope of delivery within the scope of legal regulations (proof of purchase receipt). Improper handling or incorrect use shall exclude liability for defects.

EU Declaration of Conformity

Hereby peiker CEE GmbH (peiker Consumer Electronics Evolution GmbH) declares that the device complies with the requirements and other relevant regulations of the directive RED 2014/53/EU.

You can find further information at: <https://www.peiker-cee.de/doc>

FCC-Note

This equipment has been tested and found to comply with the limits for a Class B digital device, pursuant to part 15 of the FCC Rules. These limits are designed to provide reasonable protection against harmful interference in a residential installation. This equipment generates, uses and can radiate radio frequency energy and, if not installed and used in accordance with the instructions, may cause harmful interference to radio communications. However, there is no guarantee that interference will not occur in a particular installation. If this equipment does cause harmful interference to radio or television reception, which can be determined by turning the equipment off and on, the user is encouraged to try to correct the interference by one or more of the following measures:

- Reorient or relocate the receiving antenna.
- Increase the separation between the equipment and receiver.
- Connect the equipment into an outlet on a circuit different from that to which the receiver is connected.
- Consult the dealer or an experienced radio / TV technician for help.

Note regarding FCC 15.21

Warning: Changes or modifications not expressly approved by peiker CEE GmbH void user's authority to operate equipment.

Note regarding FCC 15.19

This device complies with Part 15 of the FCC Rules. Operation is subject to the following two conditions:

- (1) this device may not cause harmful interference, and
 - (2) this device must accept any interference received,
- (3) including interference that may cause undesired operation.

RF Radiation Exposure Statement

This equipment complies with the FCC/IC radiation exposure limits set fourth for portable transmitting devices operation in an uncontrolled environment. End users must follow the specific operating instructions to satisfy RF exposure compliance.

- This transmitter must not be co-located or operation in conjunction with any other antenna or transmitter.
- Any changes or modifications not expressly approved by the party responsible for compliance could void the user's authority to operate this equipment.

Model: CEECOACH ^{PLUS}
FCC ID: 2ANUY-CEECPLUS

Canada, Industry Canada (IC) Notices

This device complies with Industry Canada's licence-exempt RSS-102, RSS-247. Operation is subject to the following two conditions:

- (1) This device may not cause interference; and
- (2) This device must accept any interference, including interference that may cause undesired operation of the device.

L'émetteur/récepteur exempt de licence contenu dans le présent appareil est conforme aux CNR d'Innovation, Sciences et Développement économique Canada applicables aux appareils radio exempts de licence. L'exploitation est autorisée aux deux conditions suivantes :

- (1) L'appareil ne doit pas produire de brouillage;
- (2) L'appareil doit accepter tout brouillage radioélectrique subi, même si le brouillage est susceptible d'en compromettre le fonctionnement.

Model: CEECOACH ^{PLUS}

IC: 23265-CEECPLUS

M/N: CEECOACH ^{PLUS}