

TX-50RF USER MANUAL

UHF/RF FM Stereo Transmitter

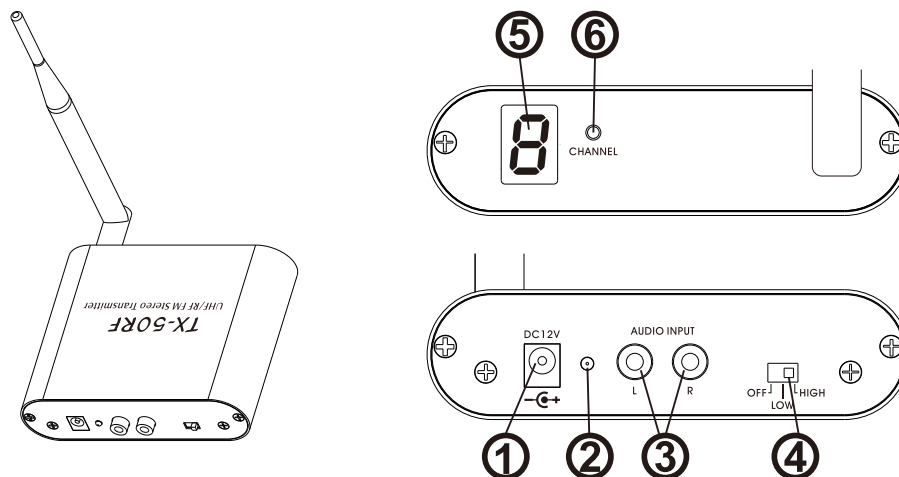

- ① Power input
- ② Power Indicator
- ③ Audio input RCA connector

- ④ The power on/off and low/high switch
- ⑤ LED Indicator for transmit channel
- ⑥ Button for transmit channel selection

Technical Specifications

- 1) System: UHF/RF
- 2) Modulation: FM
- 3) Mode: stereo
- 4) Channel; 1,2,3 or 4 channels
- 5) Operation distance: 200 meters(LOW) / 500 meters(HIGH) open air
- 6) Channel separation: >50dB
- 7) Distortion : <1%
- 8) Frequency response: 30-20.000Hz
- 9) Power supply of transmitter: DC12V 1.3A(included)

Using the transmitter

1. Switch ON audio /video component connected to the transmitter. When the audio signal input to the transmitter, turn on LOW / HIGH switch of the transmitter and the Power indicator illuminate. 'LOW' for 200 meters range and 'HIGH' for 500 meters range.
2. Slide the Power OFF Switch to power off the transmitter when it's not in use
3. The channel option will be displayed on the screen.
4. Do not keep the transmitter very close to the headphones, especially for 'HIGH' output.

warn

This device complies with part 15 of the FCC Rules. Operation is subject to the following two conditions: (1) This device may not cause harmful interference, and (2) this device must accept any interference received, including interference that may cause undesired operation.

Any Changes or modifications not expressly approved by the party responsible for compliance could void the user's authority to operate the equipment.

Note: This equipment has been tested and found to comply with the limits for a Class B

digital device, pursuant to part 15 of the FCC Rules. These limits are designed to provide reasonable protection against harmful interference in a residential installation. This equipment generates uses and can radiate radio frequency energy and, if not installed and used in accordance with the instructions, may cause harmful interference to radio communications. However, there is no guarantee that interference will not occur in a particular installation. If this equipment does cause harmful interference to radio or television reception, which can be determined by turning the equipment off and

on, the user is encouraged to try to correct the interference by one or more of the following measures:

- Reorient or relocate the receiving antenna.
- Increase the separation between the equipment and receiver.
- Connect the equipment into an outlet on a circuit different from that to which the receiver is connected.
- Consult the dealer or an experienced radio/TV technician for help.