

# BELLING DOORBELL



Quick Start Guide  
V1.0.1

## I Product Interface

Interface	Instruction	Interface	Instruction
Battery Power	6000mAH	USB Power	USB-Micro DC 5V/2A
External Power	DV/AC 9V-48V	Doorbell Volume	≤75dB
Lens Angle	Level 160°	Infrared Distance	5M
Wi-Fi Distance	Barrier-free 20M	Chime Distance	Barrier-free 30M

### Interface

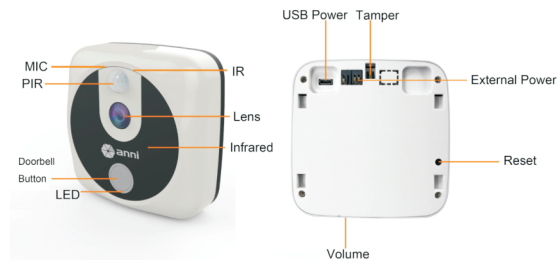

-1-

## II Doorbell Use Instruction

### FITTINGS



Power Adapter



Power Cable



Chime

## III Install APP

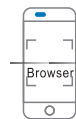

The phone connected to your Wi-Fi network.  
A: Scan QR code  
B: Search "Belling" from Google Play or App Store to download app, and then install it.

**This manual to IOS as an example.**

-2-

## IV Configure Wi-Fi

### Step 1: Activate the Doorbell

First-time use, The device is using battery power.  
Press the doorbell button to activate the doorbell to boot.  
When activated, The doorbell LED lights up.



Press

### Step 2: Register an account and Login

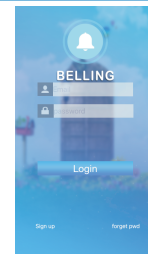

You need to register an account the first use after installing app.  
Please use the correct email registration.

-3-

### Step 3: Quick Configuration Wi-Fi

1. Add a name to the device.
2. Press and release the button on the back of your doorbell. the doorbell white LED will turn around.

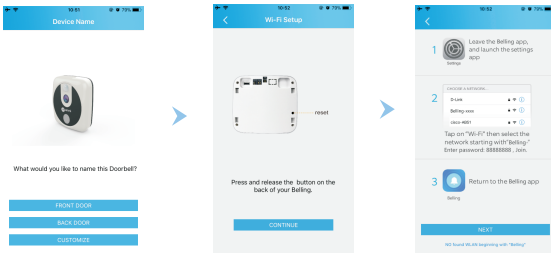

3. a. Leave the Belling app, and launch the settings app.  
b. Tap on "Wi-Fi" then select the network starting with "Belling-".  
c. Enter password: 88888888 , Join, and return to the Belling app.
4. Next, select your Wi-Fi and enter the password. (Does not support 5G Wi-Fi )
5. Wait for the doorbell to connect Wi-Fi, and prompting success.

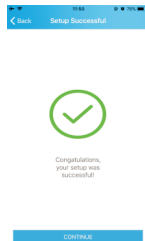

### Setup Didn't Complete

What is your Belling Doorbell doing?

a. Top Always Light Blue  
Wi-Fi connection failed, need to reset and reconfigure.

b. White Light Turns  
Wi-Fi connection failed, need to reconfigure.

### Step 4: Activate Chime

Chime connected to 220V power supply.  
Long press chime match key until chime's led lights have been flashing.  
Press the doorbell once to activate chime.

### Step 5: Charge

Battery charging, blue LED shows progress.  
When the battery is fully charged, the blue LED is on.  
It takes about 6 to 8 hours to fully charge.

**Note:**  
The first time, please be fully charged.



## V Features

### Main interface

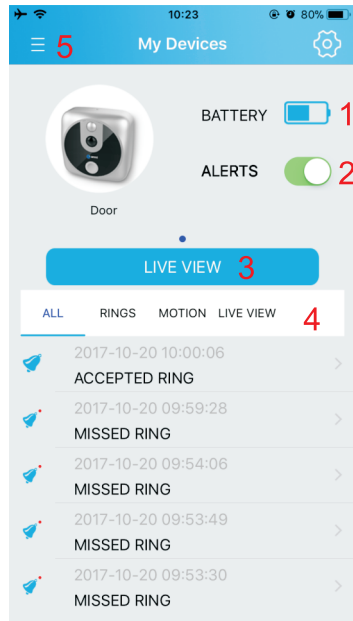

1. BATTERY
2. ALERTS (Do Not Disturb)
3. LIVE VIEW
4. Event Message
5. MENU

### Device Settings

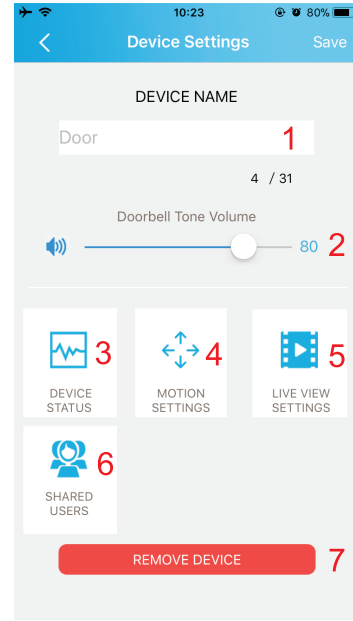

1. Device Name
2. Doorbell Tone Volume
3. Device Status
4. Motion Settings
5. LIVE VIEW Settings
6. Shared Users
7. Remove Device

### **FCC Statement**

This equipment has been tested and found to comply with the limits for a Class B digital device, pursuant to part 15 of the FCC rules. These limits are designed to provide reasonable protection against harmful interference in a residential installation. This equipment generates, uses and can radiate radio frequency energy and, if not installed and used in accordance with the instructions, may cause harmful interference to radio communications. However, there is no guarantee that interference will not occur in a particular installation. If this equipment does cause harmful interference to radio or television reception, which can be determined by turning the equipment off and on, the user is encouraged to try to correct the interference by one or more of the following measures:

- Reorient or relocate the receiving antenna.
- Increase the separation between the equipment and receiver.
- Connect the equipment into an outlet on a circuit different from that to which the receiver is connected.
- Consult the dealer or an experienced radio/TV technician for help.

To assure continued compliance, any changes or modifications not expressly approved by the party.

Responsible for compliance could void the user's authority to operate this equipment. (Example- use only shielded interface cables when connecting to computer or peripheral devices).

This equipment complies with Part 15 of the FCC Rules. Operation is subject to the following two conditions:

- (1) This device may not cause harmful interference, and
- (2) This device must accept any interference received, including interference that may cause undesired operation.

RF warning statement:

The device has been evaluated to meet general RF exposure requirement. The device can be used in portable exposure condition without restriction.