

REPLACING BATTERIES IN THE WIRELESS CONTROLLER

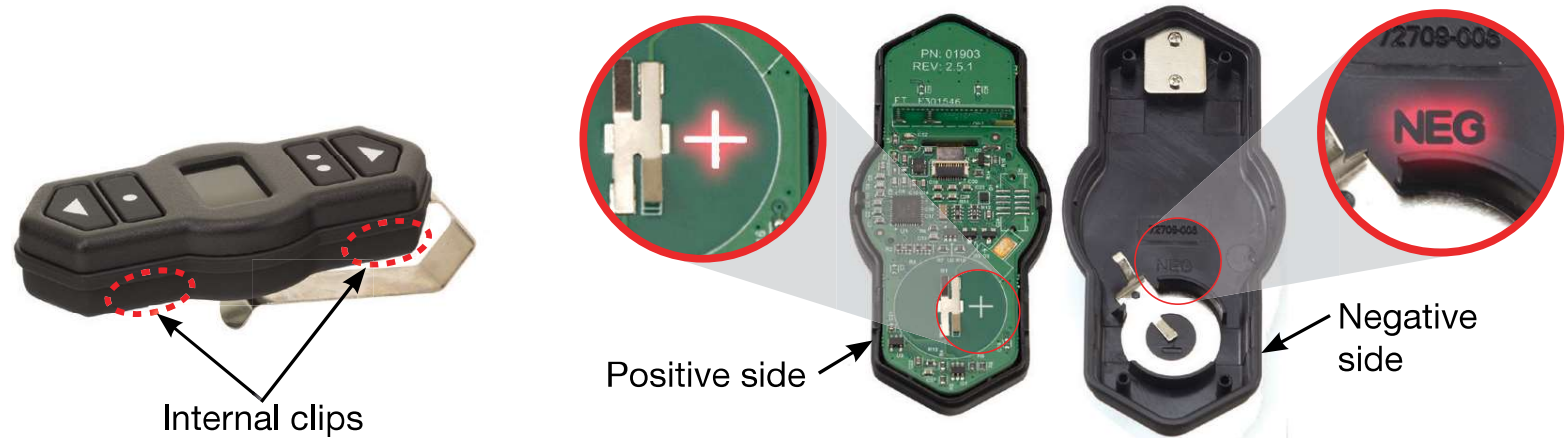

1. To install the two CR2032 batteries in the wireless controller, use a small flat screwdriver to separate the two halves of the controller by prying apart the internal clip locations.
2. Stack the batteries positive to negative inside the rear cover with the positive end pointed in the direction of the circuit board. Take note of “NEG” on the case and “+” symbol on the circuit board.
3. Snap the front cover/circuit board onto the rear cover.

FCC AND INDUSTRY CANADA INFORMATION TO USER

This device complies with Part 15 of the FCC Rules and with Industry Canada license-exempt RSS standard(s). Operation is subject to the following two conditions: (1) This device may not cause harmful interference, and (2) This device must accept any interference received, including interference that may cause undesired operation.

Le présent appareil est conforme aux CNR d'Industrie Canada applicables aux appareils radio exempts de licence. L'exploitation est autorisée aux deux conditions suivantes : (1) l'appareil ne doit pas produire de brouillage, et (2) l'utilisateur de l'appareil doit accepter tout brouillage radioélectrique subi, même si le brouillage est susceptible d'en compromettre le fonctionnement.

Note: Changes or modifications not expressly approved by the party responsible for compliance could void the user's authority to operate the equipment.

Remote

FCC ID: 2ANLC-0MQ228171

IC: 23130-0MQ228171