

## 01 Product Info

### a.Front

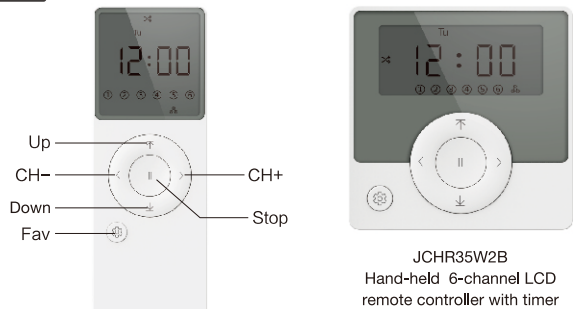

JCHR35W1B  
Hand-held 6-channel LCD  
remote controller with timer

JCHR35W2B  
Hand-held 6-channel LCD  
remote controller with timer

### b.Back

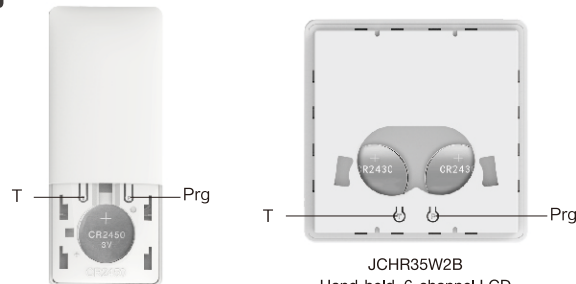

JCHR35W1B  
Hand-held 6-channel LCD  
remote controller with timer

JCHR35W2B  
Hand-held 6-channel LCD  
remote controller with timer

## 02 Models & Parameters (more info please refer to the nameplate)

Electrical Specification	Standard	
Battery Type	Hand-held:CR2450*3V*1	Wall-mounted: CR2430*3V*2
Working Temperature	-10°C~50°C	
Radio Frequency	433.92M ± 100KHz	
Transmit Distance	≥30m indoor	

## 03 Caution!



- The transmitter should not be exposed to moisture or impact, so as not to affect its life
- During use, when the remote control distance is significantly shorter or less sensitive, please check whether the battery needs to be replaced.
- When the battery voltage is too low, the LCD screen will show a low voltage prompt, prompting to replace the battery.
- Please properly dispose of used batteries according to the local garbage classification and recycling policy

## 04 Instruction

### a.Channels & Groups Toggling

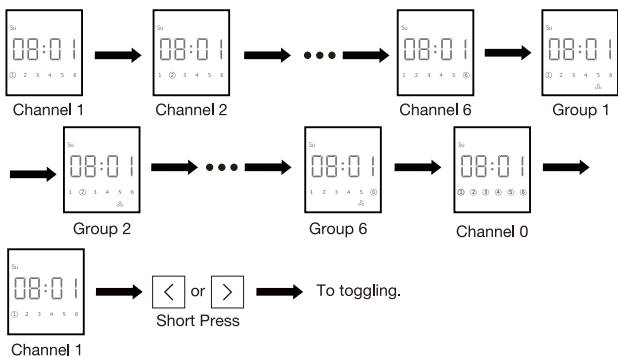

Note: Channel 0 is pre-set control of All Groups within the multi-channel controller. Channels in groups can be set accordingly.

### b.Number of Channels Setting

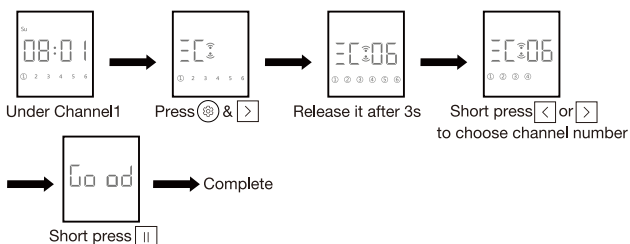

Note: Max&Min number is 6&1 when it's set under channel 1-6.

### c.Number of Groups Setting

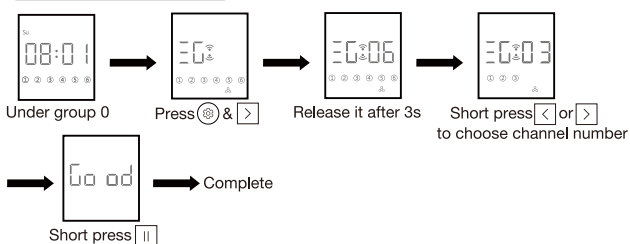

Note: Max&Min number is 6&1 when it's set under channel 0.

### d.Channel in Group Setting

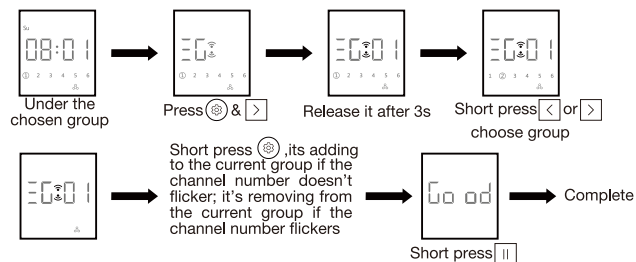

Note: Channel in groups setting is under GROUP 1-6.

### e.Check the channels in groups

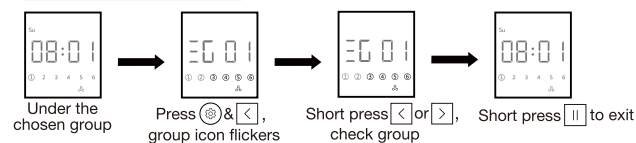

### f.Prohibit dual-key operation

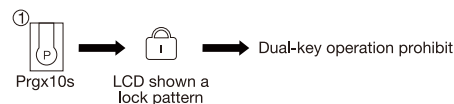

② Repeat the above, dual-key operation activated

Note: When dual-key operation prohibited, these programming setting functions are not allowed.

### g.Position percent setting

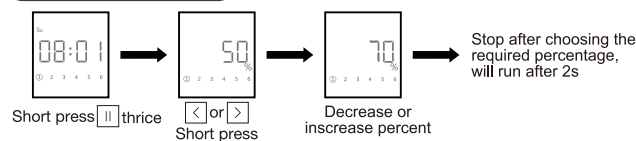

Note: All the shades under same group will run to same position after percent setting.

### h.Modes Toggling

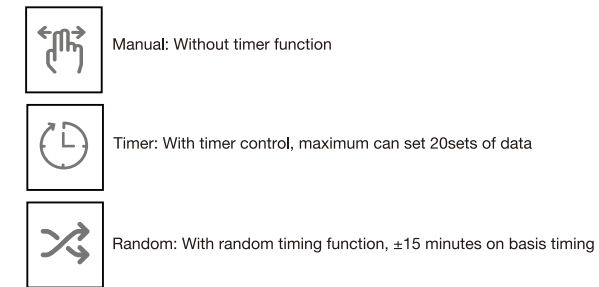
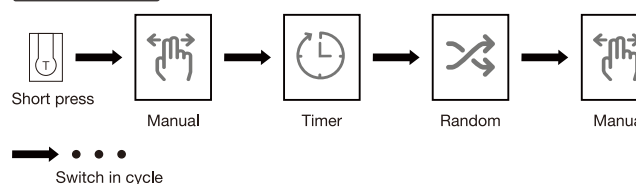

### i.Local time setting

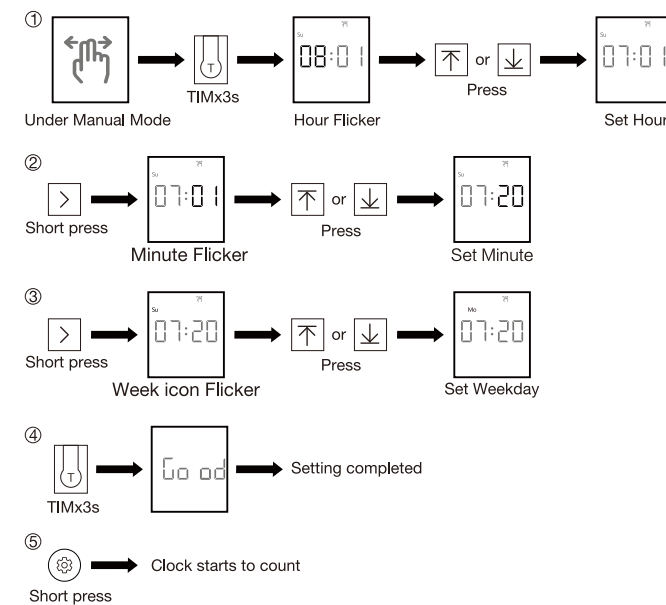

### j.Timer control

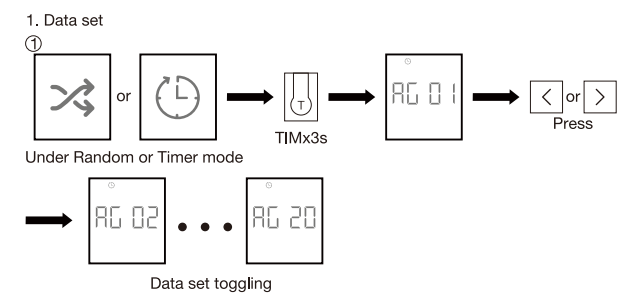

Note: 1. Press Up&Stop, LCD shown CL00, means current data cleared  
2. Press Down&Stop, LCD shown CL01, means first data set copied to current set

## 2. Timer setting

### ① Channel setting

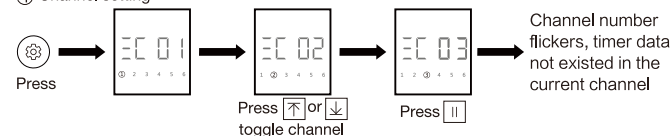

### ② Weekday setting

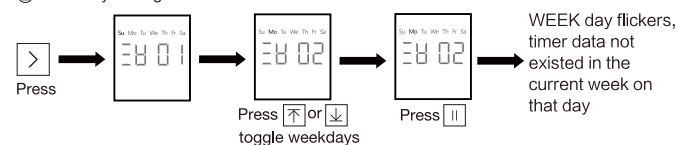

### ③ Timer setting

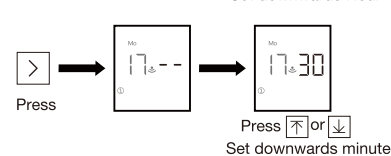
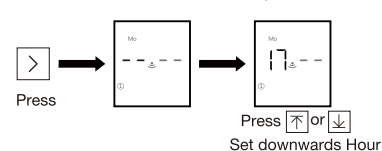
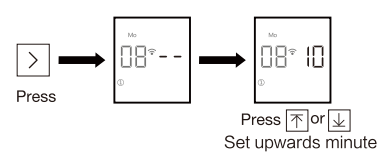
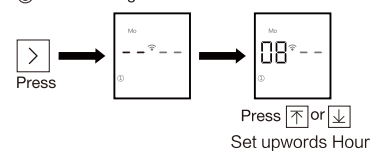

### 3. To toggle data sets

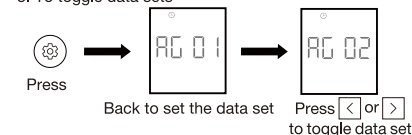

### 4. To save timer setting

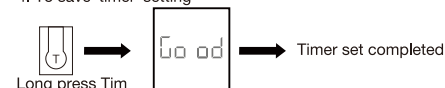

Note: If it shows , timer setting is null.

## 06 Caution!

This device complies with Part 15 of the FCC. Operation is subject to the following two conditions: (1) this device may not cause harmful interference, and (2) this device must accept any interference received, including interference that may cause undesired operation.

Any changes or modifications not expressly approved by the party responsible for compliance could void the user's authority to operate the equipment.

This equipment has been tested and found to comply with the limits for a Class B digital device, pursuant to part 15 of the FCC Rules. These limits are designed to provide reasonable protection against harmful interference in a residential installation. This equipment generates uses and can radiate radio frequency energy and, if not installed and used in accordance with the instructions, may cause harmful interference to radio communications. However, there is no guarantee that interference will not occur in a particular installation. If this equipment does cause harmful interference to radio or television reception, which can be determined by turning the equipment off and on, the user is encouraged to try to correct the interference by one or more of the following measures:

- Reorient or relocate the receiving antenna.
- Increase the separation between the equipment and receiver.
- Connect the equipment into an outlet on a circuit different from that to which the receiver is connected.
- Consult the dealer or an experienced radio/TV technician for help.

This device complies with Industry Canada's license-exempt RSSs. Operation is subject to the following two conditions:

- (1) This device may not cause interference; and
- (2) This device must accept any interference, including interference that may cause undesired operation of the device.

Le présent appareil est conforme aux CNR d'Industrie Canada applicables aux appareils radio exempts de licence. L'exploitation est autorisée aux deux conditions suivantes : (1) l'appareil ne doit pas produire de brouillage, et (2) l'utilisateur de l'appareil doit accepter tout brouillage radioélectrique subi, même si le brouillage est susceptible d'en compromettre le fonctionnement.

# JCHR35W1B/2B

## 6-channel LCD remote controller with timer

### USER MANUAL

#### Headquarter: Xinchang

ADD : No. 2 Laisheng Road, Provincial High-tech industrial Park, Xinchang county, Zhejiang Province

EMAIL : jc35@jiecang.com

TEL : +86-575-86297980

FAX : +86-575-86297960