

说明书尺寸: 95X95mm

TRIANGLE SMART POWER STRIP

Parameters

- Input supply voltage: 110V-125V AC
- Max. working current: 10A
- Max. working power: 1250W
- Input frequency: 50Hz/60Hz
- 3 USB output parameter: DC5V 3.1A
- WIFI Requirement: 2.4GHz
- Product Size: 103*103*59 (mm)

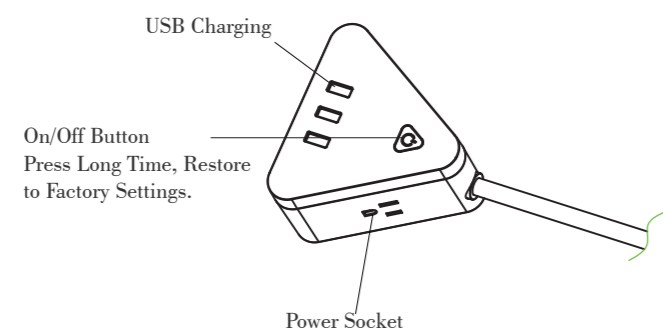

Part 1: Download & Registration

- Scan the QR code to download "Smart Life" app or search and download app directly from APP Store or Google Play.
- Enter the register/login interface; input the phone No. / Email and password to log, or tap at the bottom of page connected to related authorization interface, input the phone No./Email for getting verification code to register.
- Note: Our APP only supports 2.4 GHz WI-FI networks.

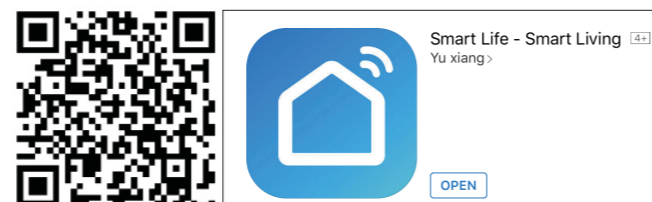

Part 2: Add Plug

Preparations :

The socket default setting is turned off, Long press on/off button about 5s until green indicator light quickly flashes, then open the APP to enter "Home" interface.

- Make sure the phone connect with WIFI successfully.
- Tap "add device" or the icon "+", and then choose "Electrical outlet".
- Tap "Confirm indicator rapidly blink".
- Input WIFI password, then tap "Confirm".
- Wait for configuring successfully, then tap "Done".
- User could rename the device through tapping the top right icon "..."

(As the picture shows)

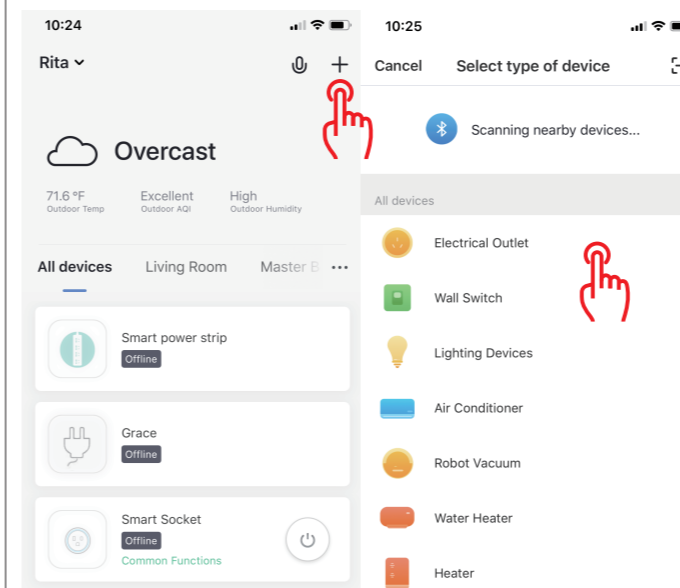

Part 3: Profile

Profile is the entrance for the user to manage personal information, mainly show the following information (see chart):

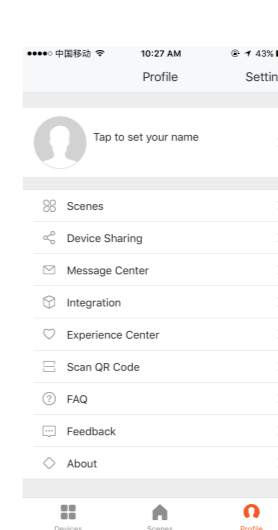

Notice

- Please check if there is damage caused by transportation. If broken, please contact supplier for replacement.
- Please follow the specification instruction and notice to keep product in a good and safe use condition.
- Put the socket in proper condition and out of reach of children.
- Plug in fully to the socket when using.
- The total power of being electric connected appliances could not bigger than the maximum power of the socket.
- Do not disassemble or reinstall the socket, otherwise it may cause security risks.

Using Amazon Echo Quick Guide

Preparation

- Amazon Alexa APP
- Amazon Alexa account (users need to register their own account)
- Smart Life APP
- Smart Life APP account (users need to register their own account, select region as "The United States".)
- Echo, Echo Dot, Tap and other Amazon voice-operated devices Our smart device (For example, smart plug)

Rename the device after configuring successfully, and then name of the device is recommended to use easy pronunciation of the English words.

Set your Echo speaker by Alexa APP

- Sign in with Alexa account & password (If not registered, sign up first). After login, click the menu, at the top left, then click the "Settings", and choose "Set up a new device".
- Choose a device (for example, Echo). When the right page appears, long press the small dot on your Echo device until the lights turn to be yellow. Then click "Continue" on APP. (Note: at this time the mobile phone can not open a variety of VPN software.)

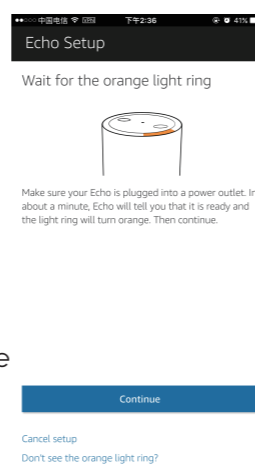

- Choose user's WiFi and wait for a few minutes.
- After an introduction video, click next step. It will go to "Home" page automatically. Now the echo is connected to Alexa APP through WIFI successfully.

Enable our skill in Alexa APP

- Choose "Skills" in the options bar, and then search "Smart Life APP" in the input box; Select "Smart Life APP" in the search results, and then click "Enabled Skill". (Note: There will be the interface on the right, which indicates that the account has been bound. If there is more than one test, you can click on the "Disable Skill" to remove the binding, and then click on the "Enable Skill" to continue to bind a new "Smart Life APP account".)

- Input the user name and password that you had previously registered (Only support the account in the United States), when you see the right page. It means the Alexa account is linked with Smart Life APP account.

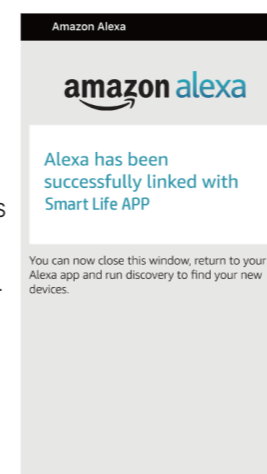

Control Device via Alexa APP

After the previous operation is successful, you can control socket via Echo. Discover device: Firstly, users need to say to Echo: Echo(or Alexa), discover my device," Echo will start to find the device which is added in Smart Life APP, it will take about 20 seconds to show the result. Or click "Discover devices" in Alexa APP, it will show the devices that found successfully.

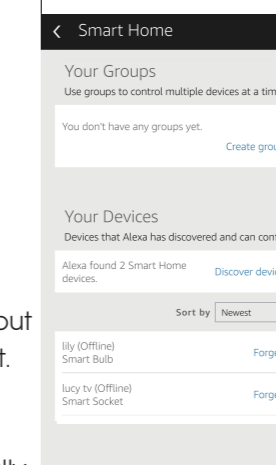

Note: "Echo" is one of the wake-up names, which can be any of these three names (Settings): Alexa/Echo/Amazon.

- Support Skill List
Users can control devices by instructions like below:
Alexa, turn on [bedroom socket]
Alexa, turn off [bedroom socket]
Note: The name of the device must be consistent with the addition of Smart Life APP.



FCC Statement

This equipment has been tested and found to comply with the limits for a Class B digital device, pursuant to part 15 of the FCC rules. These limits are designed to provide reasonable protection against harmful interference in a residential installation. This equipment generates, uses and can radiate radio frequency energy and, if not installed and used in accordance with the instructions, may cause harmful interference to radio communications. However, there is no guarantee that interference will not occur in a particular installation. If this equipment does cause harmful interference to radio or television reception, which can be determined by turning the equipment off and on, the user is encouraged to try to correct the interference by one or more of the following measures:

- Reorient or relocate the receiving antenna.
- Increase the separation between the equipment and receiver.
- Connect the equipment into an outlet on a circuit different from that to which the receiver is connected.
- Consult the dealer or an experienced radio/TV technician for help.

Responsible for compliance could void the user's authority to operate this equipment. (Example- use only shielded interface cables when connecting to computer or peripheral devices).

This equipment complies with Part 15 of the FCC Rules. Operation is subject to the following two conditions:

- (1) This device may not cause harmful interference, and
- (2) This device must accept any interference received, including interference that may cause undesired operation.

FCC Radiation Exposure Statement:

Any Changes or modifications not expressly approved by the party responsible for compliance could void the user's authority to operate the equipment.

The equipment complies with FCC Radiation exposure limits set forth for uncontrolled environment. This equipment should be installed and operated with minimum distance 20cm between the radiator and your body.