

## Veiligheidsinstructies

Om de veiligheid van u en anderen te garanderen, dient u het volgende veiligheidsadvies te lezen voordat u dit product gebruikt. Let op de voorzorgsmaatregelen die in de handleiding worden aangegeven. Controleer het product voor gebruik en gebruik geen beschadigde onderdelen.



## Productoverzicht

Deze videolamp biedt continue verlichting en is ontworpen met een hoogwaardige, duurzame behuizing van aluminiumlegging. Het ondersteunt 3 bedrijfsmodi: CCT, scène en HSI. Het kan op afstand worden bediend via een mobiele app en ondersteunt ook 2.4 GHz-ontvangstbediening voor extra gemak.

## Verpakkingsinhoud

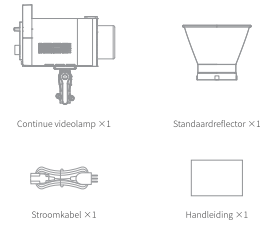

NL

37

## Productdiagram

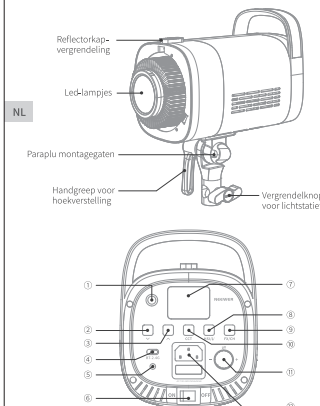

NL

38

## Productdiagram

- ① 2.4 GHz-antenne
- ② Helderheid "+"
- ③ Stroomindicator
- ④ Beeldscherm
- ⑤ FX-modus/ kanaal-aanpassing
- ⑥ Schakelen tussen modi/instellingen aanpassen
- ⑦ Helderheid "-"
- ⑧ Infinity/2.4GHz-schakelaar
- ⑨ Aan/uit-schakelaar
- ⑩ HSI-modus/ temperatuurcontrole
- ⑪ CCT-modus/ Infinity-reset
- ⑫ Voedingsinterface

※ Houd de "CCT"-knop 5 seconden lang ingedrukt om de Infinity-functie te resetten.

## Installatie

### 1. De lamp installeren

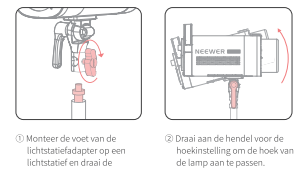

## Installatie

### 2. De standaardreflector en paraplu voor fotografieverlichting installeren

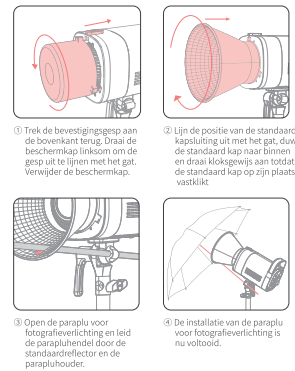

※ De paraplu voor fotografieverlichting is niet inbegrepen bij de accessoires en moet apart worden aangeschaft.

## Instructies

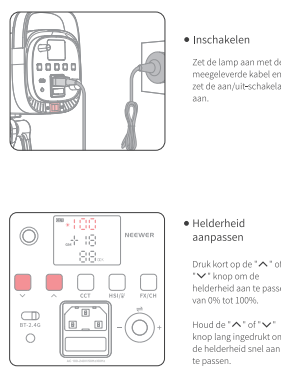

NL

39

## Instructies

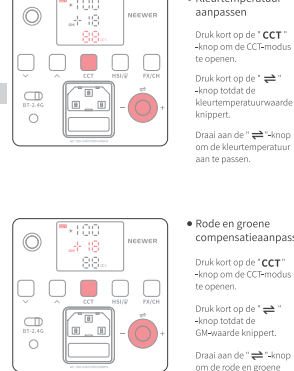

NL

40

## Instructies



## Instructies

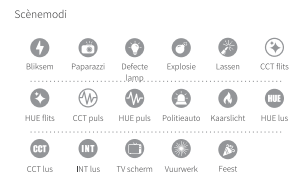
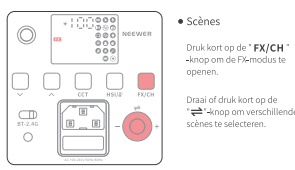

## Instructies

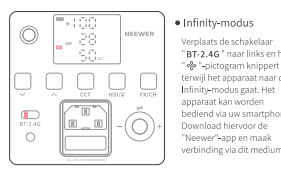

Scan voor gedetailleerde instructies de QR-code van de "App Guide Page" op de app-promptkaart.

※ Reset de Infinity voordat u verbinding maakt met de app. Houd de "CCT"-knop 5 seconden lang ingedrukt om de Infinity-functie te resetten.

NL

41

## Instructies

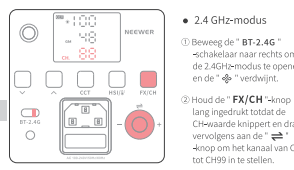

③ Stel in de 2.4GHz-modus meerdere lampen in op hetzelfde kanaal, bijvoorbeeld CH88. Bij het afstellen van een van de lampen, veranderen dan tegelijk ook de andere lampen op hetzelfde kanaal.

NL

## Opmerkingen

- Laat het product niet vallen en stel het niet bloot aan een sterke fysieke impact.
- Kijk tijdens gebruik niet direct in het licht om mogelijke schade aan uw gezichtsvermogen te voorkomen.
- Plaats het product niet in de buurt van ontvlambare en explosieve materialen.
- Gebruik het product niet in een vochtige omgeving.
- Raak het product niet aan met natte handen.
- Schakel de stroom uit wanneer deze niet in gebruik is.
- Verwijder de beschermhoes voor gebruik.
- Als het product gedurende lange tijd niet wordt gebruikt, dient het op een goeventleerde, droge plaats bewaard te worden, uit de buurt van warmtebronnen en magnetische velden.

## Specificaties

Model	CB60 RGB
Stroomvoorziening	AC 100-240V, 50/60Hz
Maximaal vermogen	70W
Maximale Kleurweergave-index	CRI 97
Maximale verlichtingssterkte	18000Lux/1m
Helderheidsbereik	0%-100%
Kleurtemperatuurbereik	2700K-6500K
GM-waardebereik	-50-50
Tintbereik	0-360
Verzamigingsbereik	0-120
Scenemodi	17
Kanaalbereik	CH0-CH99

42

### 安全说明

为确保您和他人的安全,请在操作本产品之前仔细阅读以下安全信息。请注意本说明书手册中突出显示的注意事项。始终在使用前检查设备,不要使用已损坏的零配件。



请勿将易燃材料放置在影楼灯附近。



请勿在雨、潮湿的环境或其他不利天气条件下使用。



使用吹风机扇子或湿毛巾的薄纸去除尘上和灯壳。



使操作区域没有易燃物,请将本产品放在儿童和宠物接触不到的地方。



请勿长时间触摸,在触摸前,请取下电源,或拆卸配件时请先关闭电源。



维护前,请先关闭电源,或拆卸配件时请先关闭电源。



使用时请勿触摸通风孔,请勿长时间高功率运行。



请勿将化学药品或液体滴落在灯上,请勿将本机的任何部分浸入液体中。



请勿尝试自行拆卸或维修本机。



影楼灯在使用过程时发热,切勿用手触摸。

### 产品概述

本产品是一款RGB常亮影楼灯,采用优质的铝合金外壳设计,坚固耐用。支持3种工作模式: CCT模式、场景模式、HSI模式,可使用手机APP远程控制,支持2.4G从属控制,操作简单方便。

### 包装清单

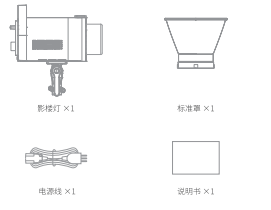

### 产品图示

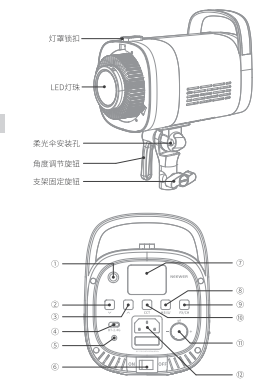

### 产品图示

- ① 2.4G天线
- ② 亮度“+”
- ③ 亮度“-”
- ④ Infinity/2.4G切换
- ⑤ 电源指示灯
- ⑥ 电源开关
- ⑦ 显示屏
- ⑧ 模式切换/参数查看
- ⑨ 灯罩模式/温度调节
- ⑩ CCT模式/Infinity重置
- ⑪ 模式切换/参数查看
- ⑫ 电源接口

\* 长按“CCT”键5S可重置Infinity功能。

### 安装说明

#### 1. 安装影楼灯

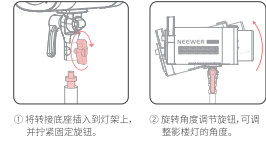

### 安装说明

#### 2. 安装标准罩、柔光伞

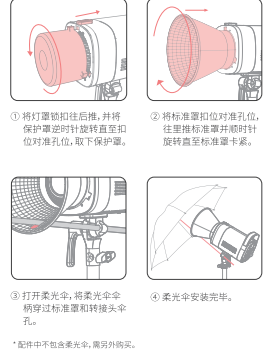

### 使用说明

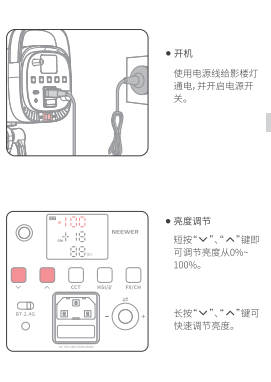

### 使用说明

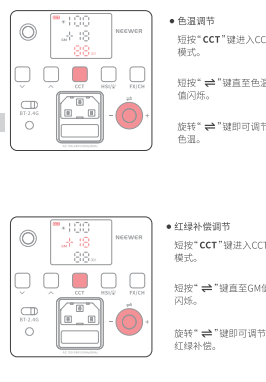

### 使用说明

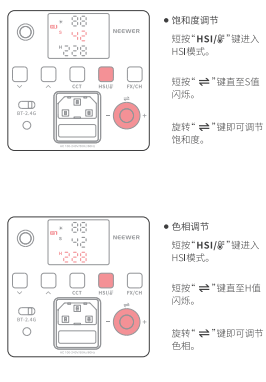

### 使用说明



### 使用说明



### 使用说明

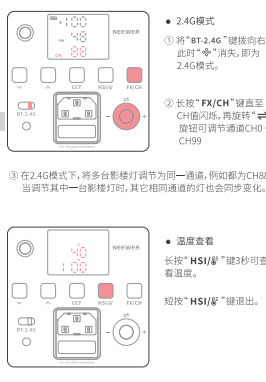

### 注意事项

1. 请勿让产品落到地面,受到碰撞或强烈冲击。
2. 使用时,请勿直视灯光,直视光线会导致视力受损。
3. 请勿将产品放置在易燃易爆物品附近。
4. 请勿在雨中和潮湿的环境中使用产品。
5. 请勿用手触摸产品。
6. 不使用时,请关闭电源开关。
7. 使用前请先取下保护罩。
8. 如长时间不使用,应将产品放在通风、干燥、远离热源和磁场的地方。

### 产品参数

产品型号	CB60 RGB
电源输入	AC 100-240V, 50/60Hz
最大功率	70W
最大显色指数	CRI 97
最大亮度	18000Lux/1m
亮度范围	0%-100%
色温范围	2700K-6500K
GM值范围	<math>-50-50</math>
色相范围	0-360
饱和度范围	0-100
场景模式	17
通道范围	CH0-CH99

### FCC Statement

This device complies with Part 15 of the FCC Rules. Operation is subject to the following two conditions: (1) This device may not cause harmful interference, and (2) This device must accept any interference received, including interference that may cause undesired operation.

CAUTION: The user is cautioned that changes or modifications not expressly approved by the party responsible for compliance could void the user's authority to operate the equipment.

NOTE: This equipment has been tested and found to comply with the limits for a Class B digital device, pursuant to part 15 of the FCC Rules. These limits are designed to provide reasonable protection against harmful interference in a residential installation. This equipment generates, uses and can radiate radio frequency energy and, if not installed and used in accordance with the instructions, may cause harmful interference to radio communications. However, there is no guarantee that interference will not occur in a particular installation. If this equipment does cause harmful interference to radio or television reception, which can be determined by turning the equipment off and on, the user is encouraged to try to correct the interference by one or more of the following measures:

- Reorient or relocate the receiving antenna.
- Increase the separation between the equipment and receiver.
- Connect the equipment into an outlet on a circuit different from that to which the receiver is connected.
- Consult the dealer or an experienced radio/TV technician for help.

This equipment complies with FCC's RF radiation exposure limits set forth for an uncontrolled environment. The antenna(s) used for this transmitter must be installed and operated to provide a separation distance of at least 20 cm from all persons and must not be collocated or operating in conjunction with any other antenna or transmitter. Installers must ensure that 20cm separation distance will be maintained between the device (excluding its handles) and users.

### IC Warning Statements

#### - English Warning Statement

"This device complies with Industry Canada licence-exempt RSS standard(s). Operation is subject to the following two conditions: (1) This device may not cause interference; and (2) This device must accept any interference, including interference that may cause undesired operation of the device." The digital apparatus complies with Canadian CAN ICES-3(B)/NMB-3(B).

This radio transmitter has been approved by Industry Canada to operate with the antenna types listed with the maximum permissible gain indicated.

#### - French Warning Statement

"Le présent appareil est conforme aux CNR d'Industrie Canada applicables aux appareils radio exempts de licence. L'exploitation est autorisée aux deux conditions suivantes: (1) l'appareil ne doit pas produire de brouillage, et (2) l'utilisateur de l'appareil doit accepter tout brouillage radioélectrique subi, même si le brouillage est susceptible d'en compromettre le fonctionnement." Cet appareil numérique de la classe B est conforme à la norme NMB-3(B) du Canada.

Le présent émetteur radio a été approuvé par Industrie Canada pour fonctionner avec les types d'antenne énumérés ci-dessous et ayant un gain admissible maximal. Les types d'antenne non inclus dans cette liste, et dont le gain est supérieur au gain maximal indiqué, sont strictement interdits pour l'exploitation de l'émetteur.

Lors de l'installation et de l'exploitation de ce dispositif, la distance entre le radiateur et le corps est d'au moins 20 cm.

If you have any questions about product, we are glad to help.

US +1 732-623-9777  
UK +44 (0) 3330113494

Send us an email  
vip@neweer.com

www.neweer.com

**UK REP**  
Lingfeng Electronic (UK) Ltd  
International House, 10 Churchill Way, Cardiff,  
CF10 2HE, United Kingdom

**EC REP**  
NW Formations GmbH(for authorities only)  
Hofenstrasse 9B, 71636 Ludwigsburg, Germany

**Shenzhen Newer Technology Co.,Ltd.**  
Room 1903, Block A, Lu Shan Building No. 3023  
Chungfeng Rd Luo Hu District, Shenzhen  
Guangdong 518001, China



名称:CB60 RGB 影楼灯说明书  
尺寸:143\*103mm  
材质:105g双面铜板纸  
印刷:四色双面印刷  
装订:骑马钉