

Oittm

WiFi
Smart Plug
Intelligent Home
Solutions



Parameters

On/off Button
Press LONGtime Restore
to Factory Settings.

Power socket

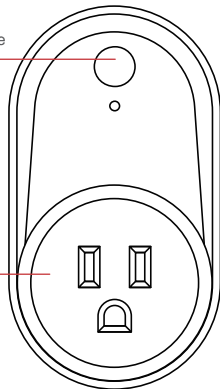

Product Specification:

Power Rating: 100-240V AC 10A
AC Frequency: 50/60Hz
Operating temperature: -10°C~ +40°C
Wi-Fi Standard: Wi-Fi 2.4GHz b/g/n
App Support: Android 4.1 and IOS8.0 or higher

1.Add device

1.1Download Tuya Smar APP



Please scan the QR Code, or get Tuya Smart downloaded from App Store or Android Market.

1.2.Download & Registration

- Scan the QR code to download "Smart Life" Application
- Enter the register/login interface, input the phone number for getting verification code to register or through other methods at the bottom of page connecting to related authorization interface to log in.



1.3. Easy Mode(Recommend)

Preparation: Device has connected with electricity, long press on/off button for 5 seconds until indicator light quickly flashes, the application already stepped into "My Device" interface.

- Phone has connected to Wifi router and been able to connect to Internet.
- Tap the icon "+" on the top right corner of "My Device", choose your device type, enter into "Add Device"
- Make sure the indicator light is flashing quickly, then tap the related button in application.
- Choose the local Wifi and enter the correct password, tap "Next".
- Wait for configuring successfully, then tap "Complete".

Attention: the blue light flashing slowly shows have not Internet connected.

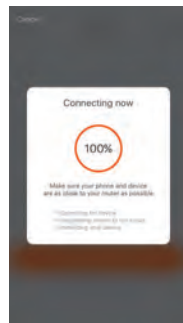

2.Enable tuya Smart skill in Alexa APP

Choose "Skills" in the options bar, and then search "Tuya Smart" in the input box.

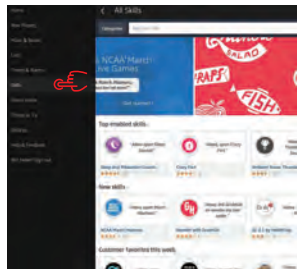

Select Tuya Smart in the search results, and then click "Enable Skill".



Then input the user name and password that you had previously registered. Only support the account in the United States.

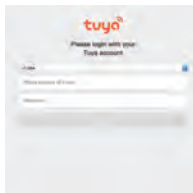

3.Control Smart Bulb by Voice

After the above operation is successful,you can control the bulb via Echo.

3.1.Discover devices

Firstly, you need to say to Echo:

Echo(or Alexa),discover my devices.

Echo will start to find the devices which is added in Tuya Smart APP, which will take about 20 seconds, then it will tell you the result.

You can also click "Discover devices" in Alexa APP, then it will show the devices that found successfully.

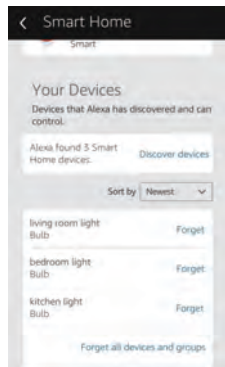

3.2.Control devices by voice

Attention: The name of the device must be consistent with the addition of Tuya Smart app.

You can also group the bulbs and give instructions to control them together.

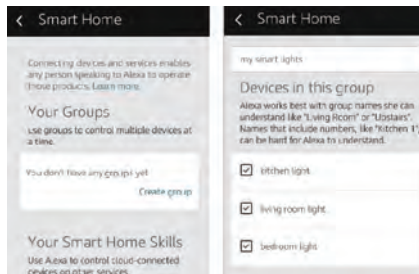

Attention:

Echo is one of the wake-up names, which can be any of these three names(Settings):**Alexa,Echo,Amazon**

3.3. Support Skill list

You can control devices by instructions like these:

- 1) Alexa(or echo), turn on [bedroom light]
Alexa(or echo), turn off [bedroom light]
- 1) Alexa(or echo),set [bedroom light] to 50 percent
Alexa(or echo),increase [bedroom light] to 50 percent
- 1) Alexa(or echo),decrease [bedroom light] to 50 percent
Alexa(or echo), set [smart heater] to 34
- 1) Alexa(or echo), raise [smart heater] by 4
Alexa(or echo), lower [smart heater] by 2

FCC Caution:

This device complies with part 15 of the FCC Rules. Operation is subject to the following two conditions: (1) This device may not cause harmful interference, and (2) this device must accept any interference received, including interference that may cause undesired operation.

Any Changes or modifications not expressly approved by the party responsible for compliance could void the user's authority to operate the equipment.

Note: This equipment has been tested and found to comply with the limits for a Class B digital device, pursuant to part 15 of the FCC Rules. These limits are designed to provide reasonable protection against harmful interference in a residential installation. This equipment generates uses and can radiate radio frequency energy and, if not installed and used in accordance with the instructions, may cause harmful interference to radio communications. However, there is no guarantee that interference will not occur in a particular installation. If this equipment does cause harmful interference to radio or television reception, which can be determined by turning the equipment off and on, the user is encouraged to try to correct the interference by one or more of the following measures:

- Reorient or relocate the receiving antenna.
- Increase the separation between the equipment and receiver.
- Connect the equipment into an outlet on a circuit different from that to which the receiver is connected.
- Consult the dealer or an experienced radio/TV technician for help.

This equipment complies with FCC radiation exposure limits set forth for an uncontrolled environment. This equipment should be installed and operated with minimum distance 20cm between the radiator & your body.