

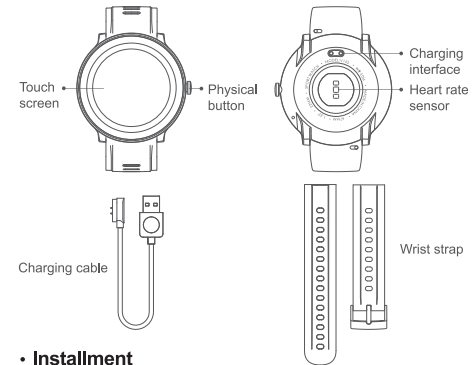

USER MANUAL

• Product Description

EN



• Installment

Insert the lugs on the wrist strap into the ear holes in the main body, until you feel and hear a "click", that is the installation is successful.

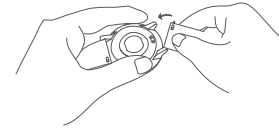

• Wear

Wear the device to a finger-wide distance from the wrist bone, and adjust the tightness of the wrist strap to a comfortable position. In order to get a best measurement results, the back of the device needs to be in contact with the skin.

• On/Off

Power on: Long press the power button to power on or automatically power on when charging.

Shut down: Long press the power button to shut down or switch to the shutdown interface and click shutdown.

• Connect APP

Open the APP, and follow the APP instructions to pair the device. After paired, there will be an interface prompt on the device side. During the pairing process, please make sure that the mobile phone Bluetooth is turned on and the device is close to the mobile phone.

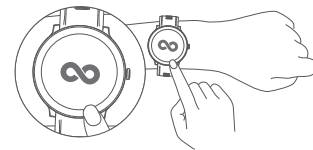

△ When the pairing is abnormal, please try the following:

1. If it is an Android phone, please open the location permission.
2. Please make sure that the mobile phone network is normal, and restart the bluetooth of the mobile phone system.

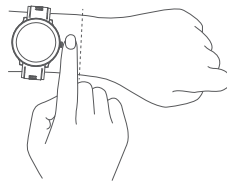

3. Close the APP background, and then reopen the APP.
4. Reset the watch.
5. Re-pair the device with the APP.

• Basic operation

Swipe up, down, left and right to view the interface of each function. Slide right return to the previous interface.

Short press the physical button to display the dial interface/menu interface.

• Charge

Make sure the metal contacts back of the device touch matching on the charging metal. When the power is connected, a charging prompt will appear on the screen.

△ Note:

Please use the charge cable in the package for charging. Please dry the charging port before charge; when not charge, pull out the charging cable and cut off the power to avoid the contact accidentally touch the metal object and cause fire.

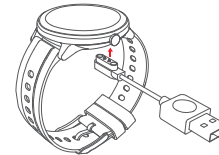

• Water proof

The device's Water resistance rating is IP68 for life waterproof, and it supports normal use in life scenarios such as hand washing, cold shower, rain, swimming, and surfing.

The waterproof function of the device is not permanently effective and may weaken over time.

The following conditions may affect the water resistance of the equipment, so you should pay attention to it when using:

1. The equipment is dropped, bumped or subjected to other shocks;
2. The equipment is in contact with soap, shower gel, detergent, perfume, lotion, oil, etc.
3. Take hot baths, saunas and other high-temperature and high-humidity scenes.

Equipment damage caused by liquid entering is not covered by the free warranty.

• Precautions

1. This equipment is not a medical device, and the test data cannot be used as a basis for judging whether to seek medical treatment or for other medical purposes.

The data and information provided are for reference only.

2. The storage space of the device is limited and can save 7 days of data. To avoid data loss, it is recommended to connect to the APP for synchronization every day.

FCC Warning Statement

Changes or modifications not expressly approved by the party responsible for compliance could void the user's authority to operate the equipment. This equipment has been tested and found to comply with the limits for a Class B digital device, pursuant to Part 15 of the FCC Rules. These limits are designed to provide reasonable protection against harmful interference in a residential installation. This equipment generates uses and can radiate radio frequency energy and, if not installed and used in accordance with the instructions, may cause harmful interference to radio communications. However, there is no guarantee that interference will not occur in a particular installation. If this equipment does cause harmful interference to radio or television reception, which can be determined by turning the equipment off and on, the user is encouraged to try to correct the interference by one or more of the following measures:

- Reorient or relocate the receiving antenna.
- Increase the separation between the equipment and receiver.
- Connect the equipment into an outlet on a circuit different from that to which the receiver is connected.
- Consult the dealer or an experienced radio/TV technician for help.