

## KEYPAD PROGRAMMING INSTRUCTIONS

Step  
1

PRESS THE OPERATOR'S  
LEARN BUTTON

PRESS THE OPERATOR'S  
FOR 15 SECONDS

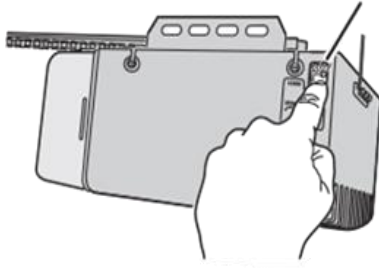

NOTE: PRESSING THE LEARN BUTTON FOR  
MORE THAN 10 SECONDS WILL ERASE ALL  
KEYPAD CODES AND REMOTE CONTROLS

Step  
2

WHILE THE LEARN  
LIGHT IS ON, ENTER  
A 1-6 DIGIT KEYPAD  
CODE AND PRESS  
THE KEYPAD'S  
START/STOP KEY



OPERATOR LIGHTS  
FLASH WHEN THE  
KEYPAD CODE IS  
ACCEPTED

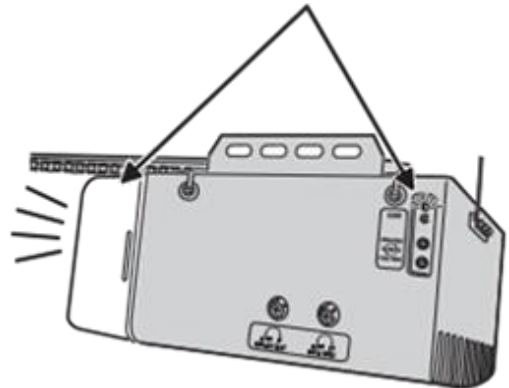

Step  
3

REPEAT STEPS 1 & 2  
FOR ANY ADDITIONAL  
KEYPAD CODES

Please take attention that changes or modification not expressly approved by the party responsible for compliance could void the user's authority to operate the equipment.

This device complies with Part 15 of the FCC Rules. Operation is subject to the following two conditions:

- (1) This device may not cause harmful interference, and
- (2) This device must accept any interference received, including interference that may cause undesired operation.