

Make time for your love

Contact us at CH 4008-622-062  
[www.burabi.com](http://www.burabi.com)

## Smart Formula Milk Maker

### Operating Instructions

Model: 02S-GW/1707



# Contents

Technical Support & Important Information	2
Safety Precautions	3
Product Description	4
Before Use	5
Bottle Preparation	8
Maintenance and Cleaning	9
FAQ and Troubleshooting	12
Product Specifications	13

## | Introduction

Thank you for purchasing the Burabi Smart Formula Milk Maker . For proper usage and maintenance, please read these instructions carefully before you use the appliance, especially the **Safety Precautions**. Keep this Operating Instructions for further use.

The Operating Instructions only applies to the Burabi Smart Formula Milk Maker, which is manufactured by Shenzhen Qianhai Zoomer Technology Co.,Ltd . And the company claims the right of final interpretation. If you have further questions about the Operating Instructions and the appliance, welcome to contact the Customer Service. Thank you.

(\*Subject to change without notice)





## | Technical Support



Scan the QR code to download the app **Burabi+** and **Operation Instructions**, to contact **Customer Service**, and to watch **operation videos**.

## | Important Information

For your baby' s health, we highly suggest you to:

- a**  Clean the funnel after every use with clean, purified water.
- b**  Clean the hole on underside of powder container with the cleaning brush after every use.
- c**  Refill the water tank with still water or purified water, and clean inside of water tank thoroughly with clean, purified water weekly.
- d**  Clean the powder container and components with clean, purified water weekly.

2

## | 1. Safety Precautions

1. Please do not place the appliance on uneven surface.
2. The appliance is Y connection, and make sure the voltage of the appliance (AC200~240V· 50Hz) is the same as your local supply.
3. In order to prevent accidents or injuries, do not use the appliance if the mains lead, the mains plug or other component is damaged, and do not repair or disassemble the appliance by yourself. Please contact the Customers Service.
4. If the appliance is damaged, please go to qualified and authorized service facility for examination and repair.
5. Please do not remove the funnel, the powder container or the water tank while the appliance is working.
6. Parts contacting with water and formula are made of food-grade approved materials. To avoid deformation or damage, do not put any parts of the appliance into high temperature equipments like microwave oven or sterilizer.
7. Please do not puts any parts of the appliance in dishwasher.
8. Please use purified water to clean detachable parts like the funnel, the powder container and the water tank. Do not clean them by boiling, firing or other heating way.
9. Please unplug the appliance before cleaning. Do not immerse the appliance in water or other liquid.
10. Please do not use coarse dishcloth, steel wool or corrosive liquid to clean the appliance.
11. Please keep children away from the appliance.
12. To avoid contamination or damage of the powder container, please do not fill other substance except dry, instant powder.
13. To avoid contamination or damage of the water tank, please do not fill other liquid except still water or purified water.
14. The appliance is intended for household or personal use only.
15. To avoid malfunction caused by overheating, please place the appliance in a cool, dry place instead of exposing to direct sunlight.

3

## 2. Product Description

### Parts Names

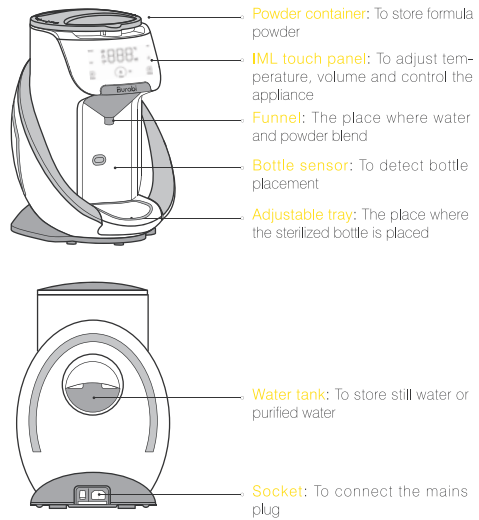

### Accessories

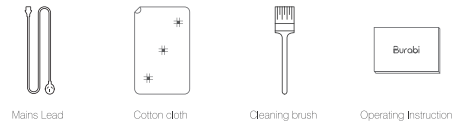

### Panel Display

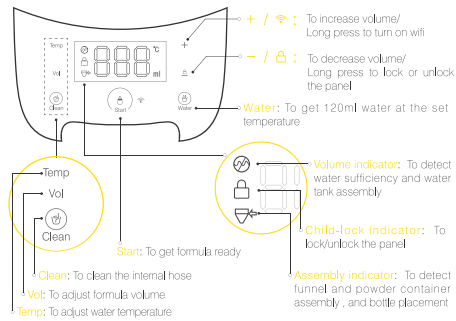

**\*Note:** After pressing the Temp or Vol button, the panel will be locked for 3 seconds automatically in case of misoperation.

4

## 3. Before Use

### Placement

Place the appliance on a dry, firm and flat worktop steadily. And then plug it in.

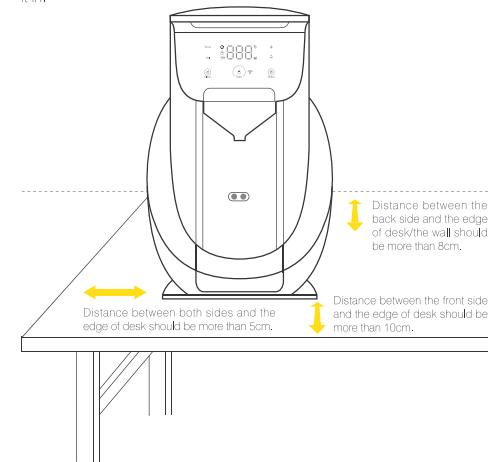

**\*Note:** For the first time use, please clean the funnel, the powder container and the water tank thoroughly (See Maintenance and Cleaning).

5



### A Pour Milk Powder

**\*Note:** Please make sure the container is completed dry before adding milk powder.



Turn the lid to open.

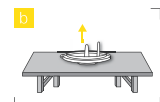

Keep the lid upward.



Add milk powder into the powder container.



Turn the lid to close.

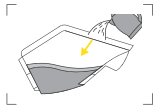

**B Pour Still Water Or Purified Water**

\*Note: please do not fill other liquid except still water or purified water.



Hold the handle and tilt the water tank slightly to remove it.

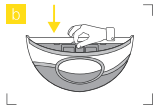

Fill the tank to **MAX** line with still water or purified water , and close the lid.

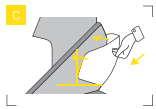

Push the water tank back by tilting it a little.

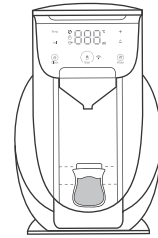

**C Place A Bottle On The Tray**

\*Note: Please make sure the bottle is sterilized and dry.

According to different sizes of bottles, adjust the tray flexibly.



**D Check The Panel**

\*Note: With the safety induction system, the appliance begins to work only when water is sufficient , and all parts and components have been placed properly.

Ensure all parts are placed correctly by checking indicator lights on the panel.

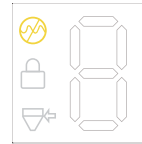

**Volume indicator** : Flashing means water is not enough or the water tank is misplaced.



**Child-lock indicator** : Flashing means the panel is locked.

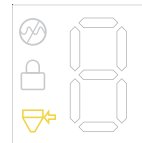

**Assembly indicator** : Flashing means the funnel or the powder container is misplaced, or no bottle on the tray.

## 4. Bottle Preparation

\*Note: For the first time use, please press the Water button on the panel to activate the adjustment.

### A-APP Control



For first-time users, click **Formula Selection** in the app, and scan the QR code on the formula can or input formula information manually. The appliance can prepare formula based on advised temperature and powder amount automatically.



Select formula volume and then click **Start**, and formula will be ready in seconds.

### B- Panel Control

According to the Instructions for Preparation & Use shown on formula can, adjust water temperature and formula volume through the panel.

\*Note:

\*Please adjust formula concentration via app **Burabi+**.

\*If there is no previous concentration setting in the app, the appliance will prepare formula in default proportion (100ml:15g).



Then press **Start** button on the panel to prepare formula.

8

## 5. Maintenance and Cleaning

\*Note: Remove these parts before cleaning.

### A - Powder Container

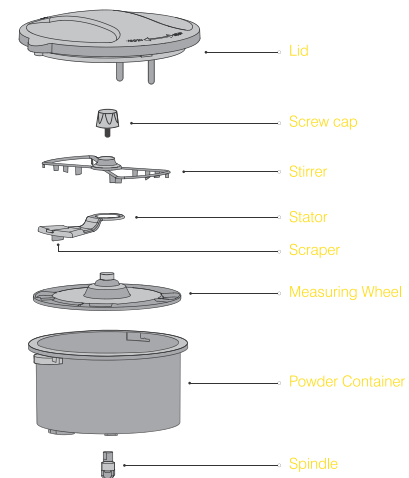

To remove

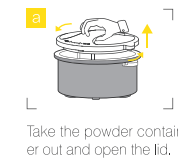

Take the powder container out and open the lid.

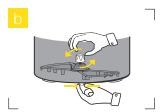

Hold the spindle and turn on the screw cap.



Take out the screw cap, the stirrer, the stator and the measuring wheel respectively.

To set up

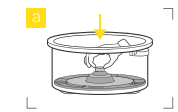

Place the measuring wheel flatwise.

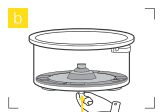

Insert the spindle properly.

9



Place the stator, and insert its front part into the slot above the hole of powder container.



Ensure the screw cap is tight enough to turn the measuring wheel.



**Before:** Before closing the lid

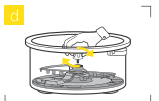

Put the stirrer and twist the screw cap clockwise.



Turn the lid clockwise to lock into place.



**After:** After closing the lid

### B. Water tank

#### To remove



Hold the handle and tilt the water tank slightly to remove it.

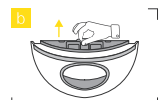

Hold the lid and take it out.

#### To set up

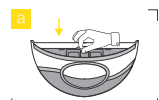

Close the lid by pressing it.

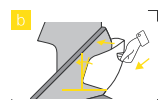

Push the water tank back by tilting it a little.

### C. Funnel

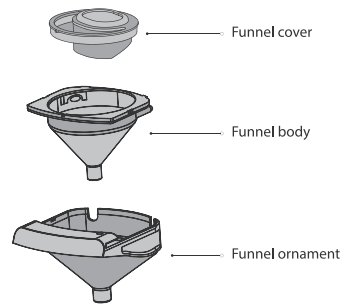

#### To remove



Lift up the funnel



Push the funnel body out from the bottom of funnel ornament.

#### To set up



Snap the funnel body into place.



Put the cover back correctly.

### D. Adjustable tray

#### To remove



Hold the front part of the tray and pull it out.

#### To set up



Hold the front part of the tray and insert it into the slot.

## 6. FAQ and Troubleshooting

### FAQ

Q: Can I use the appliance without installing the app Burabi+?

A: Yes. Through the panel you can prepare formula and adjust water temperature & formula volume. However, if there is no previous concentration setting in the app, the appliance will prepare formula in default proportion (100ml:15g).

\*Note: We highly suggest you to install the app and bind on account.

Q: Can the same one appliance be connected by multiple phones?

A: Yes.

Q: What is the effective distance between my phone and the appliance?

A: You can control the appliance through your phone as long as they are connected to the same Wi-Fi network.





Q: What can I do if the app can not find my formula after scanning the QR code?

A: You can input formula information manually, and report the problem in the app.

### Troubleshooting

Problem	Solution
Indicator lights on the panel are not on after plugging in appliance.	Check the switch behind the appliance.
The appliance does not work after pressing the Start button.	Check indicators and lights on the panel.
	Volume indicator flashes: Water is not enough or the water tank is misplaced.
	Child-lock indicator flashes: The panel is locked.
Milk Powder leaks out while filling the powder container.	Assembly indicator flashes: The funnel or the powder container is misplaced, or no bottle on the tray.
	Check the assembly of stator in powder container (See <a href="#">Maintenance and Cleaning</a> ).

The product is powered by AC power, The rated voltage is: AC220V~240V 50/60Hz; Max power:1600W, Standby power: 1W.

Error display	Situation	Cause	Solution	Error display	Situation	Cause	Solution
E01	Beeps 3 times after pressing Clean/Start/Water button	Voltage is not stable.	Contact Customer Service		Beeps 3 times after pressing Clean/Start/Water button	Water volume is less than the minimum.	Refill enough still water or purified water.
E02	Beeps 3 times after pressing Clean/Start/Water button	The heating unit NTC is abnormal.	Contact Customer Service		Only icon - lights on and no other response	The panel is locked.	Long press to unlock the panel.
E03	Beeps 3 times after pressing Clean/Start/Water button	The cold water NTC is abnormal.	Contact Customer Service		Beeps 3 times after pressing Clean/Start/Water button	The funnel or the powder container is misplaced, or no bottle on the tray.	Check the assembly and placement of these parts.
C01	Beeps 3 times after pressing Clean/Start/Water button	Bulk temperature is over 100°C.	Turn off the power, and try again after 30mins. If it is still not working, contact Customer Service.		Beeps 3 times after pressing Clean/Start/Water button	Water temperature in the water tank is 5°C higher than the set temperature.	Let the water cool down or refill cooler water, and try again after 3mins.
C02	Beeps 3 times after pressing Clean/Start/Water button	Water temperature in the water tank is over 70°C.	Let the water cool down or refill cooler water, and try again after 3mins.				

## 7. Product Specifications

Name:	Burabi Smart Formula Milk Maker	Powder container capacity:	400g	Water tank volume:	1.7L
Model number :	O2-GN/1067	Rated voltage :	AC220-240V	Transmission mode:	Wi-Fi
Dimensions :	376*246*312mm	Standby power:	1W	Weight:	4.2Kg
System requirement:		IOS7.0 above/Android4.3		Max power :	1600W
Materials:		Tritan Ex401, silica gel, ABS		Rated frequency:	50-Hz

Product Standard:GB4706.1-2005 GB4706.30-2008 GB4706.19-2008



## FCC Caution:

Any changes or modifications not expressly approved by the party responsible for compliance could void the user's authority to operate this equipment.

This device complies with Part 15 of the FCC Rules. Operation is subject to the following two conditions:

- (1) This device may not cause harmful interference, and
- (2) this device must accept any interference received, including interference that may cause undesired operation.

This device and its antenna(s) must not be co-located or operating in conjunction with any other antenna or transmitter.

This equipment should be installed and operated with minimum distance 20cm between the radiator and your body.

### NOTE:

This equipment has been tested and found to comply with the limits for a Class B digital device, pursuant to Part 15 of the FCC Rules.

These limits are designed to provide reasonable protection against harmful interference in a residential installation. This equipment generates, uses and can radiate radio frequency energy and, if not installed and used in accordance with the instructions, may cause harmful interference to radio communications.

However, there is no guarantee that interference will not occur in a particular installation.

If this equipment does cause harmful interference to radio or television reception, which can be determined by turning the equipment off and on, the user is encouraged to try to correct the interference by one or more of the following measures:

- Reorient or relocate the receiving antenna.
- Increase the separation between the equipment and receiver.
- Connect the equipment into an outlet on a circuit different from that to which the receiver is connected.
- Consult the dealer or an experienced radio/TV technician for help.

FCC ID: 2AN8K-O2SGW