

Instruction manual

SmartDate[®]X30



Printer overview



Local user interface



Start/Stop the printer



Selecting a job



Menu



Printhead maintenance



Consumables



Troubleshooting -
Information



markem·image

a **DOVER** company

Printer overview

■ Printer Components

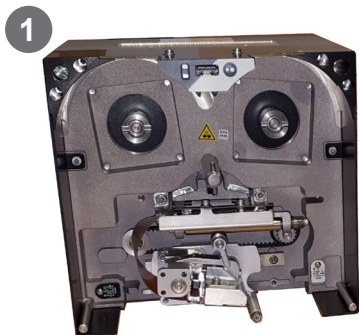

1 Printer

2 Ribbon Cassette

3 Detachable Hand-held terminal (HHT)

4 Hand-held terminal USB connecting cable



■ Printer Type

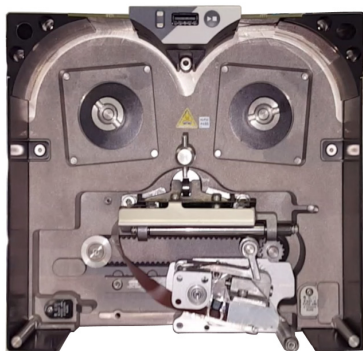

SmartDate X30 Continuous

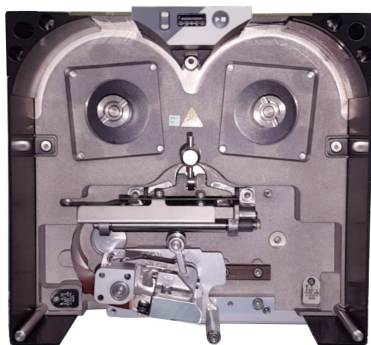

SmartDate X30 Intermittent



Power connection

■ Connecting the Power

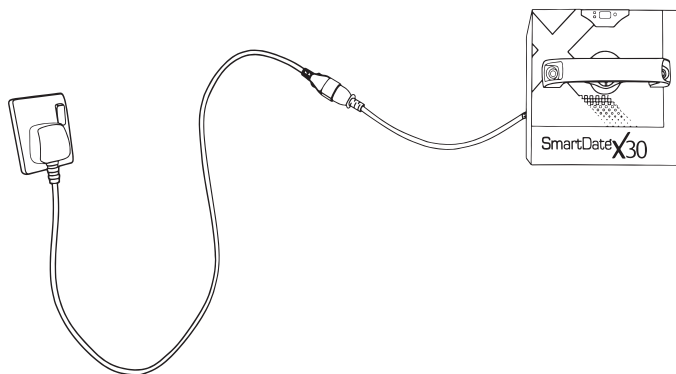

Power On

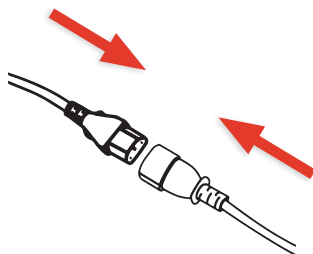

Power Off

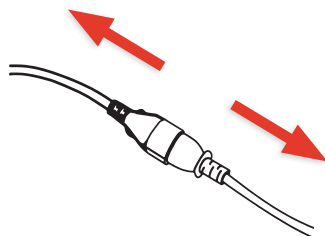



Producing



Not Producing/Fault



Warning



Busy



Local user interface

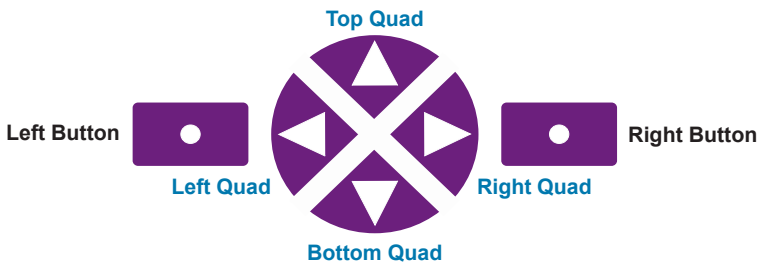
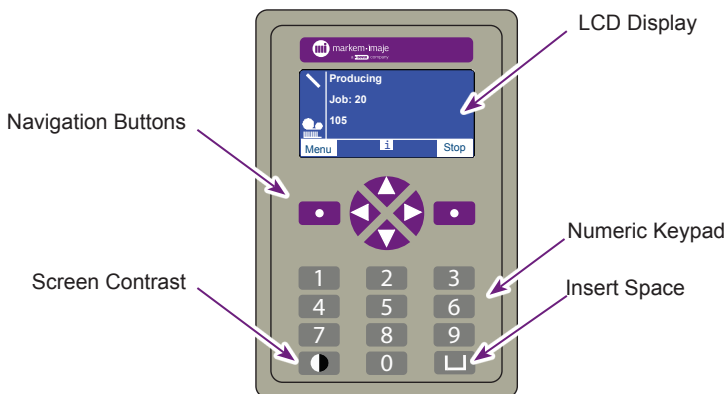

■ Starting the Printer

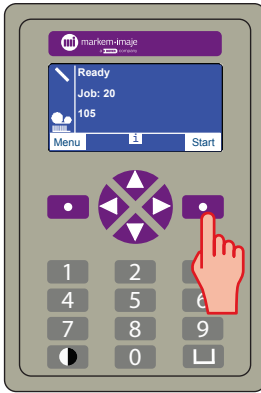

OR



■ Stopping the Printer



OR



Selecting a job

■ Using the Smartdate X30 Database

1



2

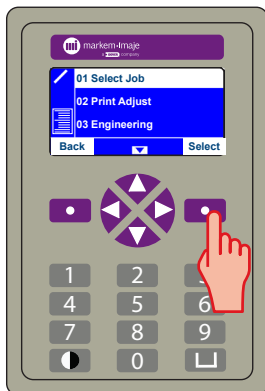

3

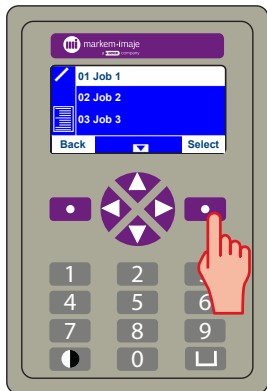

4

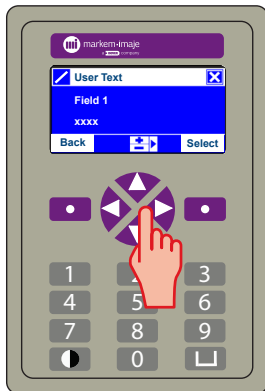

5

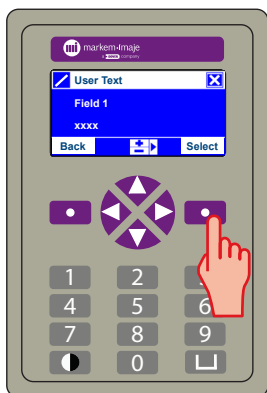

6



■ Using a USB Memory Stick Database

Note: The SmartDate X30 must be configured to use the USB memory stick database.

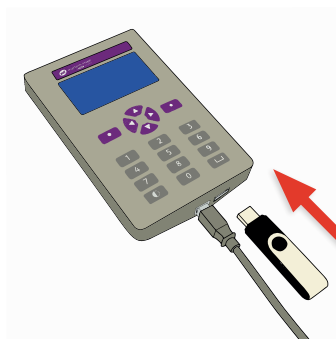

Insert the USB memory stick into the hand-held terminal and select a job following the same procedure as above.



Selecting a job

■ Using CoLOS Job Database

Note: The SmartDate X30 must be configured to use the CoLOS job database.

1



2

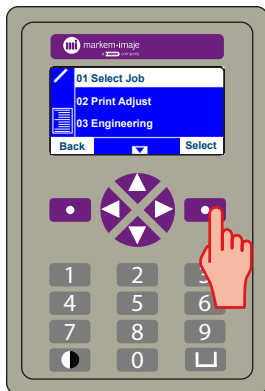

3

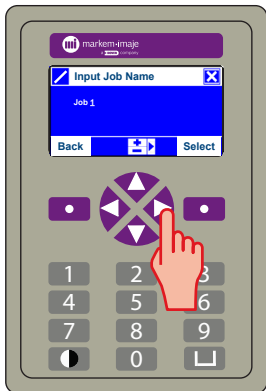

4

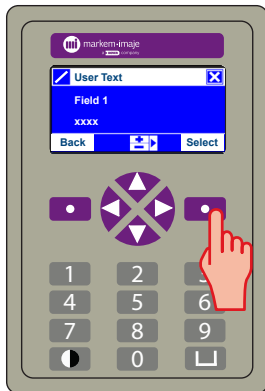

5



Printer menus

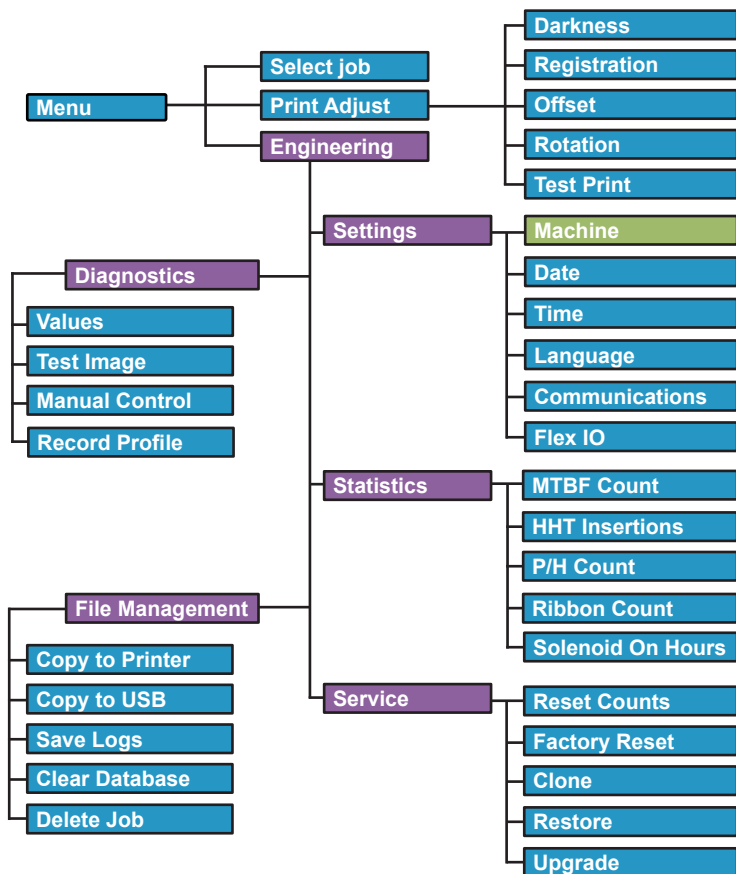



Cleaning the Printhead

Clean the printhead regularly using Markem-Imaje printhead wipes.

1

Remove the cassette and allow the printhead to cool to normal room temperature.

2

Use a Markem-Imaje printhead cleaning wipe to remove any residue from the printhead as shown.

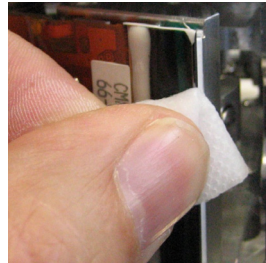

Do not use abrasive materials or tools such as screwdrivers or knives to clean the printhead.



Changing the ribbon

1 Opening the cassette

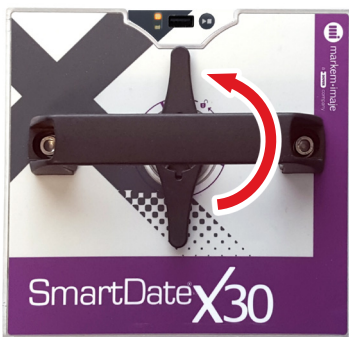

Do not use force or tools if the latch does not turn.

2 Remove the used ribbon.

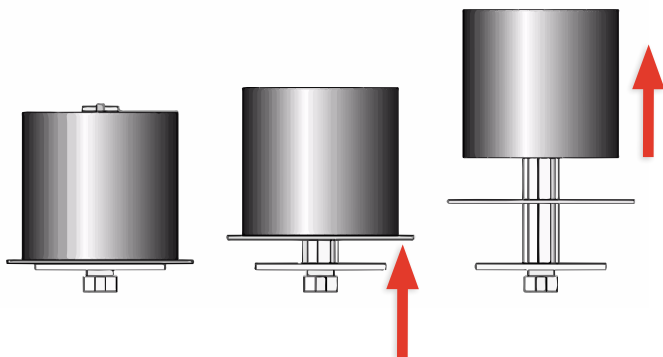

Changing the ribbon



Markem-Imaje ribbon only



Ribbon Path

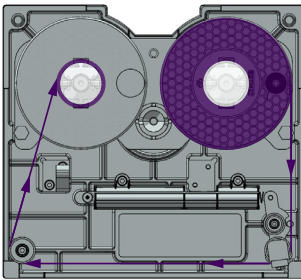

Left Hand Cassette

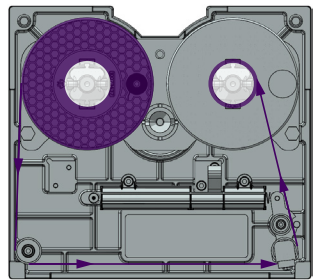

Right Hand Cassette



Changing the ribbon

3

Loading the new ribbon (LH cassette shown)

3a



3b

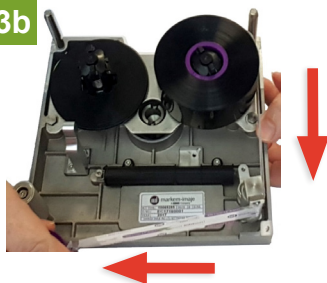

3c

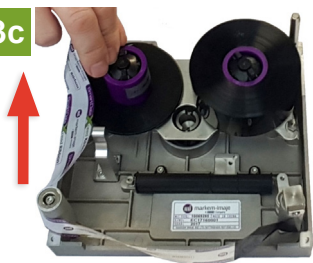

3d

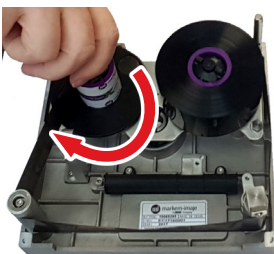

■ Faults

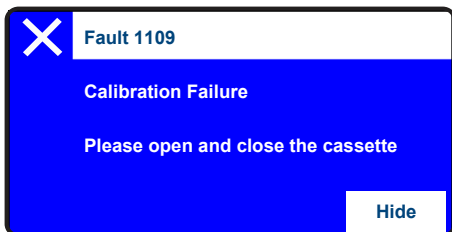

A fault will stop the printer. The fault causing the condition must be fixed before printing can continue.

■ Warnings

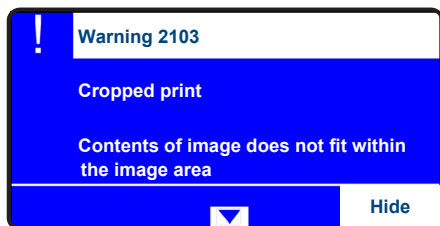

A warning does not stop the printer immediately but does indicate a condition that may require attention.

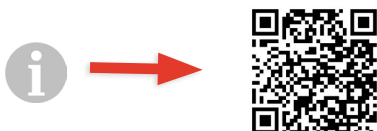

www.markem-imaje.com

Faults and Warnings

■ Common Faults and Warnings

LOW RIBBON

The ribbon will soon run out, prepare a new ribbon.

CASSETTE OPEN

The cassette latch is open, close it.

CALIBRATION FAILED

The ribbon has broken during calibration, reload the ribbon and try again.

RIBBON BREAK DETECTED

The ribbon has broken during printing reload the ribbon.





S/N: Serial number: _____

Ribbon type: _____



For Marking & Coding Equipment. Photographs and drawings are not binding in detail. This document was originally written in English. The English text of this document shall alone be authentic and shall prevail in the event of a dispute. Markem-Imaje reserves the right to modify the specifications of its products without prior notice. Any reproduction, even partial, of this document is prohibited. Original manual.

© 2019 Markem-Imaje All Rights Reserved. English version





markem·imaje

a **DOVER** company

Redefine the possibleSM

TSS - User Documentation

Markem-Image Limited
Nottingham Science Park
University Boulevard
Nottingham NG7 2QN
UK

www.markem-imaje.com

10082287-AB 01/2019

en