



Explanation of Graphical Symbols



The lightning flash with arrowhead symbol within an equilateral triangle is intended to alert the user to the presence of uninsulated "dangerous voltage" within the product's enclosure that may be of sufficient magnitude to constitute a risk of electric shock to persons.



The exclamation point within an equilateral triangle is intended to alert the user to the presence of important operating and maintenance (servicing) instructions in the literature accompanying the product.

IMPORTANT SAFETY INSTRUCTIONS

- 1 Read these instructions.
- 2 Keep these instructions.
- 3 Heed all warnings.
- 4 Follow all instructions.
- 5 Do not use this apparatus near water.
- 6 Clean only with dry cloth.
- 7 Do not block any ventilation openings. Install in accordance with the manufacturer's instructions.
- 8 Do not install near any heat sources such as radiators, heat registers, stoves, or other apparatus (including amplifiers) that produce heat.
- 9 Do not defeat the safety purpose of the polarized or grounding-type plug. A polarized plug has two blades with one wider than the other. A grounding type plug has two blades and a third grounding prong. The wide blade or the third prong are provided for your safety. If the provided plug does not fit into your outlet, consult an electrician for replacement of the obsolete outlet.
- 10 Protect the power cord from being walked on or pinched particularly at plugs, convenience receptacles, and the point where they exit from the apparatus.
- 11 Only use attachments/accessories specified by the manufacturer.
- 12 Use only with the cart, stand, tripod, bracket, or table specified by the manufacturer, or sold with the apparatus. When a cart is used, use caution when moving the cart/apparatus combination to avoid injury from tip-over.
- 13 Unplug this apparatus during lightning storms or when unused for long periods of time.
- 14 Refer all servicing to qualified service personnel. Servicing is required when the apparatus has been damaged in any way, such as power-supply cord or plug is damaged, liquid has been spilled or objects have fallen into the apparatus, the apparatus has been exposed to rain or moisture, does not operate normally, or has been dropped.



WARNING
 TO REDUCE THE RISK OF FIRE OR ELECTRIC SHOCK, DO NOT EXPOSE THIS APPARATUS TO RAIN OR MOISTURE.

(502-M01 UL 60065-1 en 01)

PRECAUTIONS

PLEASE READ CAREFULLY BEFORE PROCEEDING

Please keep this manual in a safe and handy place for future reference.

WARNING

Always follow the basic precautions listed below to avoid the possibility of serious injury or even death from electrical shock, short-circuiting, damages, fire or other hazards. These precautions include, but are not limited to, the following:

Power supply

- Do not place the USB cable near heat sources such as heaters or radiators. Also, do not excessively bend or otherwise damage the cord, or place heavy objects on it.
- Do not touch the product or the power plug during an electrical storm.
- Use only the correct voltage specified for the product. The required voltage is printed on the name plate of the product.
- Use the specified USB AC adaptor (page 20).
- Use only the supplied USB cable/plug. Do not use the USB cable/plug for other products.
- Check the power plug periodically and remove any dirt or dust which may have accumulated on it.
- Insert the power plug firmly all the way into the AC outlet. Using the product when it is not plugged in sufficiently can cause dust to accumulate on the plug, possibly resulting in fire or skin burns.
- When setting up the product, make sure that the AC outlet you are using is easily accessible. If some trouble or malfunction occurs, immediately turn off the power switch and disconnect the plug from the outlet. Even when the power switch is turned off, as long as the USB cable is not unplugged from the wall AC outlet, the product will not be disconnected from the power source.
- Do not connect the product to an electrical outlet using a multi-plug outlet extender. Doing so can result in lower sound quality, or possibly cause overheating in the outlet.
- When disconnecting the power plug, always hold the plug itself and not the cord. Pulling by the cord can damage it and cause electric shocks or a fire.

- If not using the product for long periods of time, be sure to pull the power plug from the AC outlet.

Do not disassemble

- This product contains no user-serviceable parts. Do not attempt to disassemble the internal parts or modify them in any way.

Water warning

- Do not expose the product to rain, use it near water or in damp or wet conditions, or place on it any containers (such as vases, bottles or glasses) containing liquids which might spill into any openings or places where water may drop. A liquid such as water getting into the product may cause a fire, electric shocks, or malfunctions.
- Use the USB AC adaptor indoors only. Do not use in any wet environments.
- Never insert or remove a power plug with wet hands.

Fire warning

- Do not place any burning items or open flames near the product, since they may cause a fire.

Wireless unit

- Radio waves from this product may affect electro-medical devices, such as a heart pacemaker implant or defibrillator implant.
 - Do not use the product near medical devices or inside medical facilities. Radio waves from this product may affect electro-medical devices.
 - Do not use the product within 15 cm (6 in.) of persons with a heart pacemaker implant or a defibrillator implant.

(Lithium ion) battery

- Do not disassemble this product. Failure to do so might result in battery fluid leakage. If the contents of the battery get on your hands or in your eyes, it can cause blindness, chemical burns, and damage to the product.
- Do not dispose of this product in fire. Doing so may result in the battery bursting, causing a fire or injury.
- Do not expose this product to high temperatures, such as direct sunlight or a fire. Doing so may result in the battery bursting, causing a fire or injury.
- Do not subject this product to mechanical shock. It may result in damage caused by batteries, electric shock, or malfunction.
- If the batteries do leak, avoid contact with the leaked fluid. If the battery fluid should come in contact with your eyes, mouth, or skin, wash immediately with water and consult a doctor. Battery fluid is corrosive and may possibly cause loss of sight or chemical burns.
- Do not place this product in a place where the air pressure is extremely low.
- For details on charging the battery, be sure to read the battery manual and follow the instructions. Failure to do so may result in fire, overheating, explosion or malfunction.

If you notice any abnormality

- If any of the following problems occur, immediately turn off the power switch and disconnect the power plug from the outlet. If you are using batteries, remove all batteries from the product.
Finally have the device inspected by Yamaha service personnel.
 - The USB cable or plug becomes frayed or damaged.
 - Unusual smells or smoke are emitted.
 - Some object, or water has been dropped into the product.
 - There is a sudden loss of sound during use of the product.
 - Cracks or other visible damage appear on the product.



CAUTION

Always follow the basic precautions listed below to avoid the possibility of physical injury to you or others, or damage to the product or other property. These precautions include, but are not limited to, the following:

Location

- Do not place the product in an unstable position or a location with excessive vibration, where it might accidentally fall over and cause injury.

Connections

- Before connecting the product to other electronic components, turn off the power for all components. Also, before turning the power on or off for all components, set all volume levels to minimum.
- Be sure to set the volumes of all components at their minimum levels and gradually raise the volume controls while playing the product to set the desired listening level.

Handling

- Do not rest your weight on, or place heavy objects on the product, and do not use excessive force on the buttons, switches or connectors.
- Keep small parts out of the reach of infants or small children who may accidentally swallow them.
- Do not use the product or headphones for a long period of time at a high or uncomfortable volume level, since this can cause permanent hearing loss. If you experience any hearing loss or ringing in the ears, consult a physician.
- If the headphones irritate your skin, stop use immediately.
- Remove the power plug from the AC outlet before cleaning the unit. Failure to observe this may cause electric shocks.
- Before moving the product, remove all connected cables, to prevent damage to the cables or injury to anyone who might trip over them.



(Lithium ion) battery

- Charge only with a specified charger. Charging with an unspecified charger may cause leakage, overheating, explosion, or malfunction.
- Charge only within the specified charging temperature range. Charging at a temperature outside the range may cause leakage, overheating, explosion, or malfunction.

Notices

■ Battery-related notes

This product contains a lithium-ion battery.



The lithium-ion battery contained in this product is a consumable item. To extend the life of the battery as long as possible, use caution regarding the following.

- If the product is not used for a long period of time, the charging time may get longer.
- When storing the product for a long time, charge the product around once every six months to avoid excessive discharge.
- When the battery fails to hold a charge or only has useful power for a very short time, the life of the battery is over.
- Lithium-ion batteries can be recycled. After usage, you may recycle the battery, but never attempt to remove it by yourself. Have the device inspected by qualified Yamaha service personnel. If there are no Yamaha service personnel in your area, dispose of it properly according to relevant environmental laws and disposal rules in your area.
- This product contains a battery that contains perchlorate material. Perchlorate Material - special handling may apply, See www.dtsc.ca.gov/hazardouswaste/perchlorate.

■ Handling this product

- Depending on the condition of surrounding radio waves, the product may possibly malfunction.
- Always turn the power off when the product is not in use. Even when the [] (power key) switch is in standby status (power LED is off/ status is off), electricity is still flowing to the product at the minimum level. When you are not using the product for a long time, make sure you unplug the power cord from the wall AC outlet.

■ Maintenance

When cleaning the product, use a soft and dry (or slightly damp) cloth. Do not use paint thinners, solvents, alcohol, cleaning fluids, or chemical-impregnated wiping cloths.

Yamaha cannot be held responsible for damage caused by improper use or modifications to the product.

Information

■ About the contents of this document

- This document is an owner's manual intended for the readers who will use this product.
- The illustrations and screens as shown in this document are for instructional purposes only.
- Software may be revised and updated without prior notice.

■ Trademarks

Bluetooth®

- The **Bluetooth®** word mark and logos are registered trademarks owned by Bluetooth SIG, Inc. and any use of such marks by Yamaha Corporation is under license.
- The company names and product names in this manual are the trademarks or registered trademarks of their respective companies.

The graphic below indicates the location of the name plate. The model number, serial number, power requirements, etc., are located on this plate. You should note this serial number in the space provided below and retain this manual as a permanent record of your purchase to aid identification in the event of theft or loss.

Model No.

Serial No.

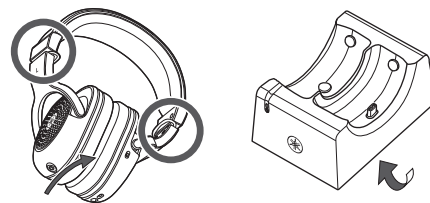

(bottom_en_02)

Table of Contents

PRECAUTIONS	4
Notices	7
Information	7
Product Overview	9
Main Features	9
Packing Contents	9
Part Names	10
Setting Up	11
Connecting the Transmitter to Other Devices by Cables	11
When connecting to a digital musical instrument or audio interface	11
When connecting to a guitar amp	11
Connecting the Power Adaptor	12
Charging the Headphones	12
Basic Operations	13
Using the Headphones	13
Adjusting the Volume	13
Checking the Audio Input Status	13
Checking Remaining Battery Power	14
After Using the Headphones	14
Connecting by Cable	14
Advanced Features	15
Using Simultaneously with Bluetooth Devices	15
Registering a Bluetooth device	15
Connecting to a Bluetooth device	16
Disconnecting from a Bluetooth device	17
Using Additional Headphones	17
Troubleshooting	18
Appendix	20
Specifications	20
List of Operations	21
List of Audio Messages and LED Indicator	21
Audio messages	21
LED displays	22

Product Overview

Main Features

This product is a set of wireless headphones with a companion transmitter. The input jack of the transmitter can be connected to the headphone jack of a device (such as a digital keyboard, guitar amplifier, audio interface, etc.), enabling wireless connection of exceptionally low latency. Since this product can also be connected to a Bluetooth device, you can play your instrument simultaneously along with music playback from your Bluetooth device, such as a smartphone.

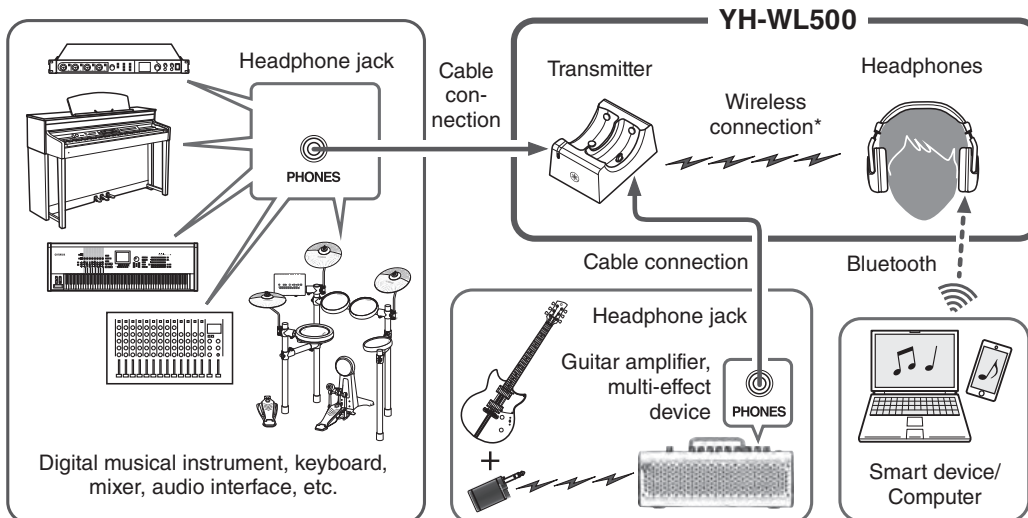

* This is a dedicated connection using Yamaha's original 2.4 GHz transmitter and achieves exceptionally low delay. A transmission channel is automatically set up simply by removing the headphones from the transmitter.

Packing Contents

Make sure that all of the following are enclosed with this product.

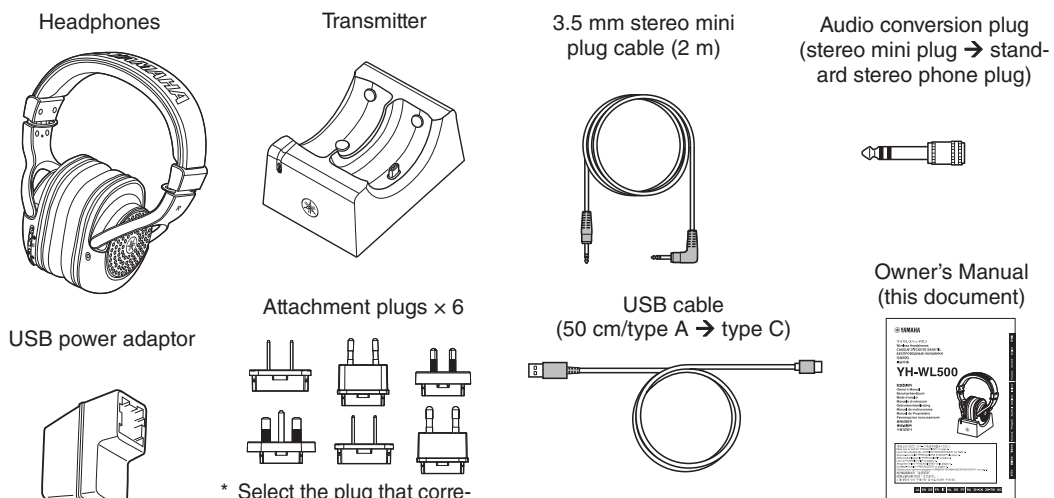

* Select the plug that corresponds to the shape of the AC outlet in your area.

Product Overview

Part Names

Headphones

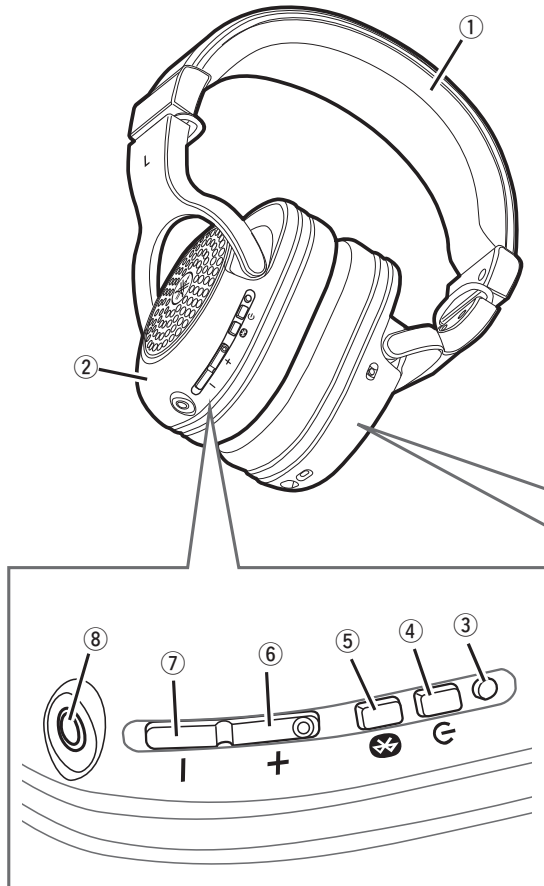

- ① Headband
- ② Housing
- ③ Power LED
- ④ Power key
- ⑤ Bluetooth key
- ⑥ + key
- ⑦ - key
- ⑧ Cable input jack
- ⑨ Charging LED
- ⑩ USB charging connector
- ⑪ Connector A
Connect to Connector B of the transmitter.

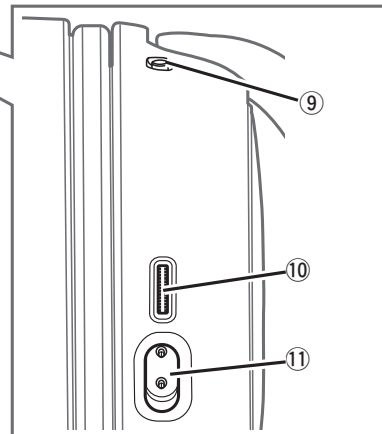

Transmitter

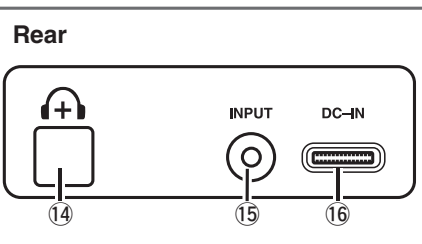
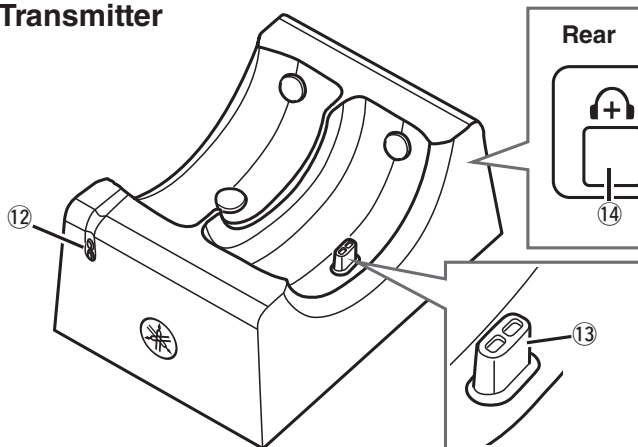

- ⑫ Status LED
- ⑬ Connector B
- ⑭ Additional headphones key
- ⑮ Input jack
- ⑯ DC IN

Setting Up

Connecting the Transmitter to Other Devices by Cables

Before using the headphones, connect the headphone jack of your particular device (digital musical instrument, guitar amp, or audio interface, etc.) to the transmitter's input jack (stereo mini jack), by using the stereo mini plug cable included with this product.

When connecting to a digital musical instrument or audio interface

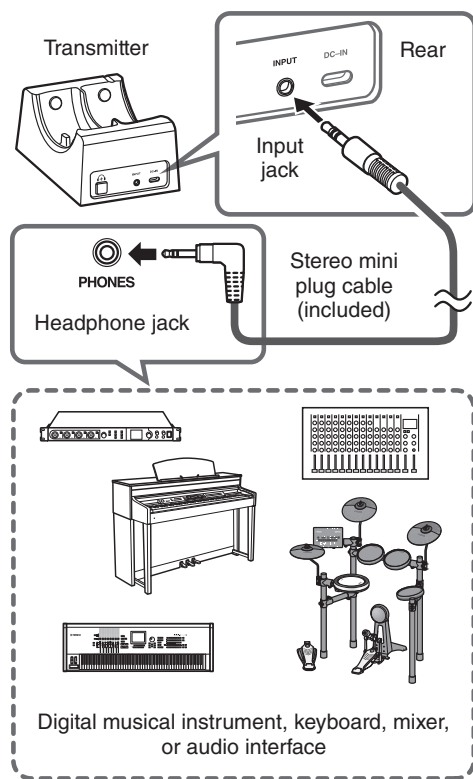

Use the attached audio conversion plug depending on the headphone jack of your particular device.

3.5 mm stereo mini plug cable

Audio conversion plug (standard stereo phone plug → stereo mini plug)

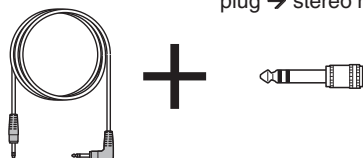

When connecting to a guitar amp

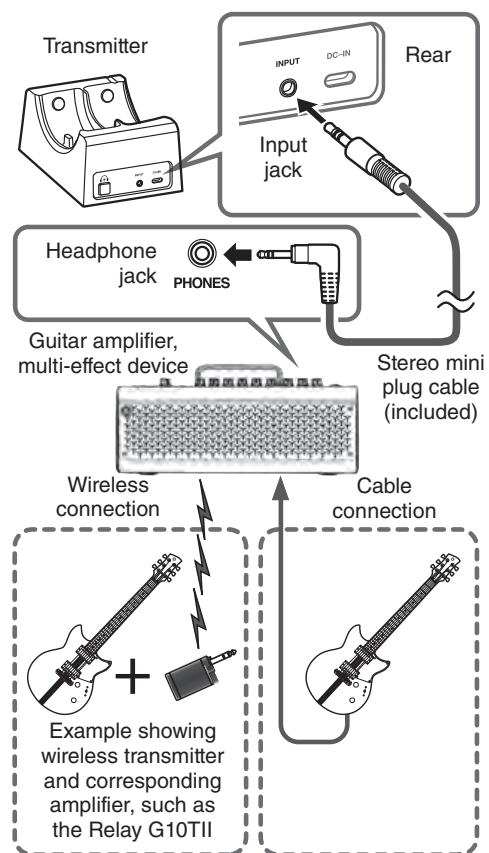

NOTE

- When using a commercial stereo mini plug cable for connection with the transmitter, make sure to use one having no (zero) resistance.

Setting Up

Connecting the Power Adaptor

1. Attach the attachment plug that corresponds to the shape of the AC outlet in your area to the USB power adaptor.

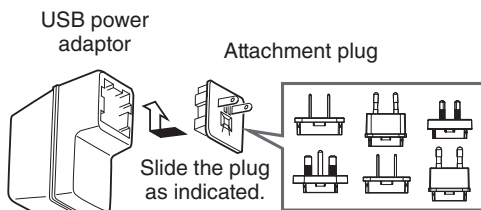

For details, refer to the separate "Attachment Plug Converter Table" leaflet.

2. Connect the USB power adaptor in the order shown in the illustration.

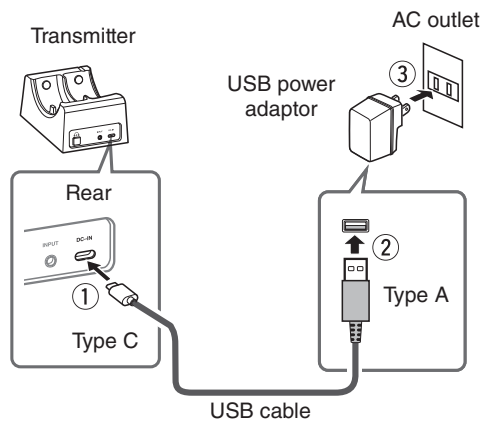

WARNING

- Be sure to use the attached USB power adaptor only.
- When using the USB power adaptor with a removable plug, make sure to keep the plug attached to the USB power adaptor. Using the plug alone can cause electric shock or fire.
- Never touch the inner metallic section when attaching the attachment plug to avoid electric shock, short circuit, or damage. Also, be careful that no dust accumulates between the USB power adaptor and plug.

NOTE

- To disconnect the USB power adaptor, follow steps 2 ① to ③ in reverse order.

Charging the Headphones

Make sure to charge the headphones before using.

1. Set the headphones on the transmitter.

Make sure that connector A of the headphones fits securely on connector B of the transmitter.

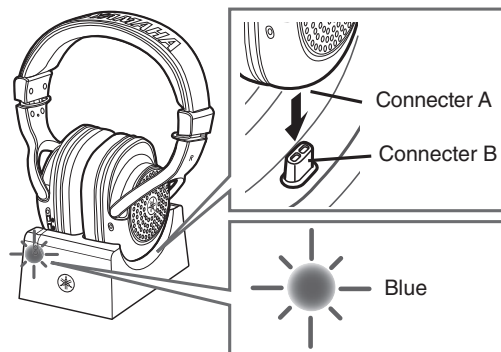

If the headphones are set correctly, the status LED of the transmitter flashes in blue, and then lights continuously in blue.

When the status LED does not light up in blue, check whether connector B of the transmitter is correctly inserted in connector A of the headphones.

2. Make sure that the charging LED of the headphones is lit up in red.

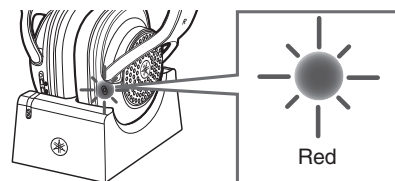

The charging LED lights up in red during charging, and turns off when charging is completed.

The charging LED will not light up when the headphones are already fully charged.

Setup is now completed.

NOTE

- You may not be able to charge if you use a USB cable other than the one included with this product.
- You can also charge directly from the AC outlet by connecting the USB cable with a USB power adaptor instead of setting on the transmitter.
- During charging, no buttons can be used, and wireless connection is canceled.

Basic Operations

Using the Headphones

1. **Turn on the power of your connected devices.**
Also in this step, lower the volume of those devices.
2. **Remove the fully charged headphones from the transmitter.**
The status LED of the transmitter and the power LED of the headphones flash in blue and a wireless channel is set up automatically.
If successfully connected, you will hear a "Pairing Successful" audio message, and then the power LED lights continuously in blue.

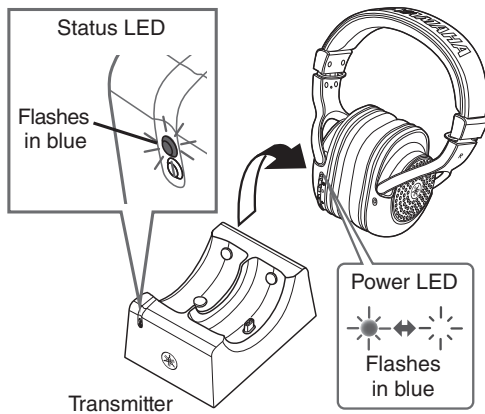

3. **Put the headphones on.**
Check the markings for the left and right sides to make sure the headphones are positioned correctly when you put them on.



4. **Adjust the volume of your device as desired.**

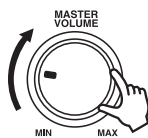

Adjusting the Volume

Follow the steps below to adjust the volume.

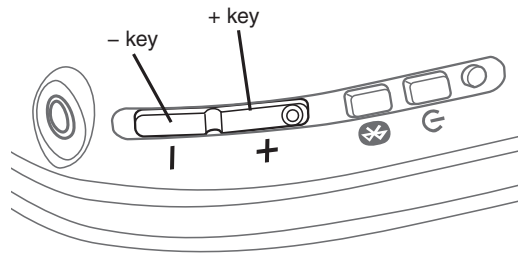

- Turning the volume up:
Press the + key.
- Turning the volume down:
Press the - key.
- Turning the volume up continuously:
Hold down the + key.
- Turning the volume down continuously:
Hold down the - key.

NOTE

- When volume reaches the maximum, you will hear a "beep" sound.

Checking the Audio Input Status

While using this product, you can check the status of the audio input from the status LED of the transmitter.

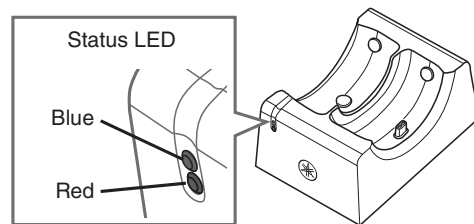

When the audio input is too high, the status LED lights up in red. Lower the volume of the connected device.

Basic Operations

Checking Remaining Battery Power

While you are using the headphones, you can check how much battery power is left from an audio message.

■ Audio message

- Battery Low: small amount of charge remaining

After Using the Headphones

1. When you are finished using the headphones, make sure to turn the power off by holding down the power key.

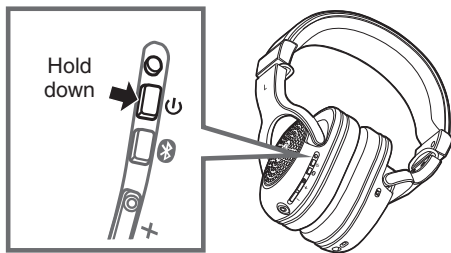

2. Charge the headphones by setting them on the transmitter (p.12).

Connecting by Cable

By connecting this product directly to a device by cable, you can use it conventionally without having to use the power supply.

1. Turn the power of this product off by holding down the power key.
2. Lower the volume of your equipment.
3. Connect the headphone jack of your equipment to the input jack of the headphones by using the 3.5 mm stereo mini-plug cable (included).

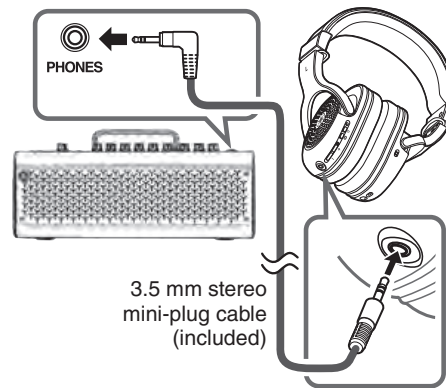

4. Adjust the volume of the connected device as desired.

Use the attached audio conversion plug according to the shape of the headphone jack of your equipment.

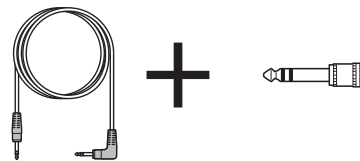

NOTE

- The following functions are not available when connecting via cable.
 - Adjusting the volume by pressing the + key (or the - key)
 - Wireless connection
- When using this product with the cable connected, you cannot use it with the power turned on. Use the headphones after turning off the power by holding down the power key.

Advanced Features

Using Simultaneously with Bluetooth Devices

During wireless connection, you can also listen to music (for example, musical accompaniment) from a Bluetooth-compatible smart device or computer.

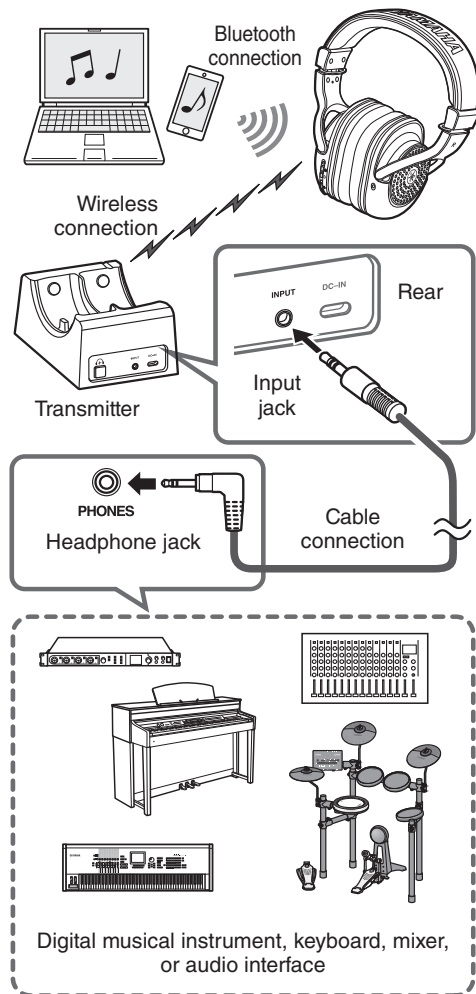

Start playback of the musical accompaniment from your smart device, after registering and connecting as a Bluetooth device (described at right). At that time, adjust the volume of the music from the smart device.

NOTE

- The volume of the music from your smart device via Bluetooth connecting cannot be adjusted by pressing the + key (or the - key) of this product.

Registering a Bluetooth device

When first connecting this product to a Bluetooth device, follow the steps below to register this product with that device.

1. **Set this product to registration standby mode.**

With the power turned on, hold down the Bluetooth key until the power LED flashes as shown in the illustration below. The headphones will enter registration standby mode.

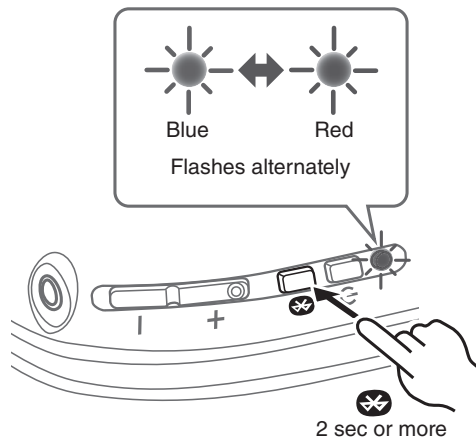

2. **Activate the Bluetooth function on the Bluetooth device.**
A list of Bluetooth devices that can be connected will be shown.
3. **Select this product from this list on your Bluetooth device.**

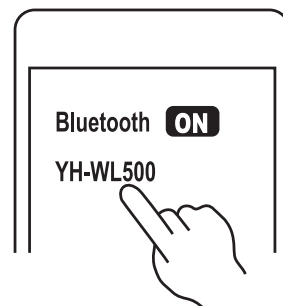

If successfully connected, you will hear a "Connected" audio message.

Advanced Features

NOTE

- Registration standby mode will automatically end after about thirty seconds. To register again, start from step 1.
- Up to 8 devices can be registered with this product. From the 9th device on, older registrations will be deleted (the oldest is deleted first).
- If a passkey is required when connecting, input "0000."



CAUTION

- **Be sure to set the volume of the Bluetooth device to the minimum level and gradually raise the volume while playing the Bluetooth device to set the desired listening level.**
Failure to do so can damage your hearing.

Connecting to a Bluetooth device

Connect this product to the Bluetooth device with which it has already been registered.

When you press the Bluetooth key briefly, this product will search for all previously connected Bluetooth devices, sequentially from the latest registered one, and will connect it automatically.

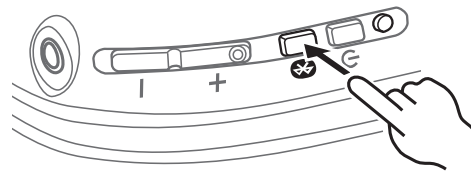

If this product does not automatically connect to a Bluetooth device, it is waiting for connection. Make connection from the Bluetooth device itself to properly connect with this product.

When this product is not able to connect with the Bluetooth devices (a maximum of eight) connected in the past, the waiting for connection status is once reset. Briefly press the Bluetooth key again and redo connection from the beginning of these steps.

If successfully connected, you will hear a "Connected" audio message.

NOTE

- This product connects to a single Bluetooth device, and cannot connect to multiple devices at the same time.
- When no wireless communications are made for ten minutes and Bluetooth is disconnected for one minute, the power of the headphones automatically turns off. In that case, press the power key again to turn on the power.
- The volume of the music from your smart device via Bluetooth connecting cannot be adjusted by pressing the + key (or the - key) of this product. Adjust the volume of the music directly from the smart device.

Advanced Features

Disconnecting from a Bluetooth device

Follow the steps below to disconnect a Bluetooth device.

- **Turn the Bluetooth device's power off.**
This product enters a waiting-for-connection status (from a Bluetooth device).
- **Turn the power of this product off.**

Using Additional Headphones

You can add two or more headphones to a single transmitter, and they can simultaneously be used wirelessly.

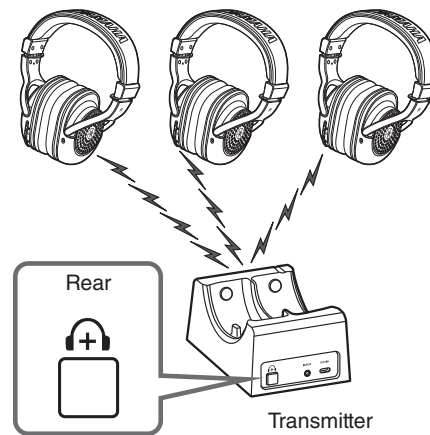

- 1. Press the additional headphones key of the transmitter.**

The status LED of the transmitter flashes in blue.

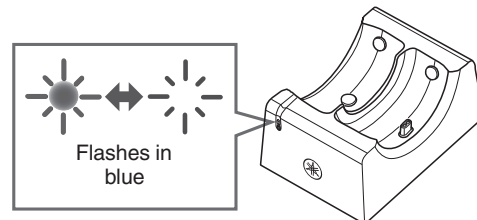

- 2. Briefly press the power key on the headphones twice.**

The power LED of the headphones flashes in blue and this product starts pairing. The status LED will light up in blue when pairing is completed.

NOTE

- Currently (as of December, 2022), headphones-only sales are not available.

Troubleshooting

Read this first

If this product does not operate normally while you are using it, first check the following.

- **Turn the power off and then on again.**
- **Make sure that this product has been sufficiently charged.**
 - “Charging the Headphones” (p.12)
- **Also, check the following.**
 - “Power will not turn on” (p.18)
 - “The product cannot be charged” (p.18)
 - “No sound can be heard” (p.18)
 - “The sound is distorted, noisy or choppy” (p.18)
 - “Cannot connect the headphones and the transmitter” (p.19)
 - “Cannot connect to a Bluetooth device” (p.19)
 - “The product does not operate or play back” (p.19)
 - “Problem still not resolved” (p.19)

Power will not turn on

- **There may not be enough battery power left.**

Charge this product.

 - “Charging the Headphones” (p.12)

The product cannot be charged

- **Your computer is not turned on (when charging from your computer).**

Turn the power of your computer on, and then charge this product.

* Charging from a PC is not guaranteed.
- **You may have been using a USB cable other than the one included with this product.**

Use the included USB cable to make sure the product correctly charges.
- **Some foreign substance may have accumulated between connectors A and B.**

Check the connectors and make sure that no foreign substance has accumulated there.

No sound can be heard

- **The headphones are not connected to the transmitter.**

Pair this product once again. Set the headphones on the transmitter once, and remove them after the status LED changes from flashing in blue to continuously lit in blue (pp. 12–13). Otherwise, press the additional headphones key of the transmitter, and then briefly press the power key of headphones twice (p.17).

- **This product is not connected to a Bluetooth device.**

Pair this product.

- “Connecting to a Bluetooth device” (p.16)

- **The volume is too low.**

Raise the volume.

- “Adjusting the Volume” (p.13)

- **The music stopped playing back.**

Start playback of the music from the connected Bluetooth device.

- “Using Simultaneously with Bluetooth Devices” (p.15)

- **The cable may not be correctly connected (when using wireless connection).**

Connect the 3.5 mm stereo mini-plug cable jack of this product correctly to your external device.

- “Connecting the Transmitter to Other Devices by Cables” (p.11)

- **The cable containing resistance is being used.**

Use the included 3.5 mm stereo mini-plug cable when connecting this product to a device by cable. If you are using a commercial stereo mini-plug cable, make sure to use one that has no (zero) resistance.

- **The volume of the external device is low when using wireless connection.**

Raise the volume on your external device.

- “Using Simultaneously with Bluetooth Devices” (p.15)

- **The volume of the external device is low when connecting to a Bluetooth device.**

Raise the volume on your external device.

- “Using Simultaneously with Bluetooth Devices” (p.15)

- **The volume of the external device is low when using a 3.5 mm stereo mini-plug cable.**

Raise the volume on your external device.

- “Connecting by Cable” (p.14)

The sound is distorted, noisy or choppy

- **The signal of wireless connection may not be coming in clearly, making the connection unstable.**

Pair this product once again. Set the headphones on the transmitter once, and remove them after the status LED changes from flashing in blue to continuously lit in blue (pp. 12–13).

- **The signal of Bluetooth connection may not be coming in clearly, making the connection unstable.**

Move away from wireless devices such as access points, or appliances that produce electromagnetic waves such as microwave ovens.

Troubleshooting

Try placing the connected Bluetooth device as close to this product as you can.

Devices with wireless network connectivity may transmit signals that obstruct Bluetooth communications. In this case, turn off the wireless network connectivity feature on your Bluetooth device.

The product does not operate or play back

- **This product may be charging.**

You cannot use this product while it is charging. Use the headphones after charging is finished.

- **There is no remaining battery power on this product.**

Charge this product.

- “Charging the Headphones” (p.12)

- **The product is temporarily not functioning.**

Turn the power off and then on again. When it becomes impossible to turn the power off by normal operation, hold down the power key for about six seconds or more in order to perform a hardware reset. When the power LED turns off, the reset operation is complete.

- **The 3.5 mm stereo mini-plug cable may be connected.**

No button operations are possible while using this product with cable connection. Remove the 3.5 mm stereo mini-plug cable from the headphones.

Cannot connect the headphones and the transmitter

- **The headphones and the transmitter may be too far apart.**

Move the headphones closer to the transmitter.

- **A device that emits electromagnetic waves (such as a microwave oven, access point and so on) might be nearby.**

Do not use this product near other devices that emit electromagnetic waves.

- **The signal of wireless connection may not be coming in clearly**

Pair this product once again. Set the headphones on the transmitter once, and remove them after the status LED changes from flashing in blue to continuously lit in blue (pp. 12–13). Otherwise, press the additional headphones key of the transmitter, and then briefly press the power key of headphones twice (p.17).

Cannot connect to a Bluetooth device

- **This product and your Bluetooth device may be too far apart.**

Move this product closer to the Bluetooth device.

- **A device that emits electromagnetic waves (such as a microwave oven, access point and so on) might be nearby.**

Do not use this product near other devices that emit electromagnetic waves.

- **The connection information for the registered Bluetooth device may not be working properly.**

Delete the connection information of this product from the Bluetooth device, and then pair this product with the device.

- “Registering a Bluetooth device” (p.15)

- **The registration information for the Bluetooth device that was registered on this product may have been deleted.**

Pair this product once more.

- “Registering a Bluetooth device” (p.15)

- **This product may already be connected to another Bluetooth device.**

Disconnect that Bluetooth device, and then connect this product with the new device.

- “Disconnecting from a Bluetooth device” (p.17)

Problem still not resolved

If the trouble still cannot be solved, please contact Yamaha for product support as shown below.

- **For customers within Japan**

Please contact the store where you purchased this product, or the Product Support Center as listed in the included “warranty sheet.”

- **For customers outside of Japan**

Please contact your nearest authorized Yamaha dealer or service center.

Appendix

Specifications

Headphones

Driver type: Dynamic, open air / over-ear
Driver unit: 40 mm
Impedance: 32 Ω
Wired input jack: 3.5 φ stereo mini-jack
USB charging connector: USB Type-C (USB 1.1)
Weight: 315 g

■ Bluetooth

Radio frequency: 2402 MHz to 2480 MHz
Maximum output power (EIRP): 6.46 dBm
Bluetooth version: 4.2
Supported profiles: A2DP, AVRCP
Supported codecs: SBC
Maximum number of pairable devices: 8
SAR observed value: 0.15 w/kg

Transmitter

Input jack: 3.5 φ stereo mini-jack
DC IN: USB Type-C (USB 1.1)
Weight: 400 g
Maximum power Consumption:
 2.55W (5.1 VDC × 500mA)

■ Wireless communication functions

Digital format: Original format (equivalent to 24-bit)
Radio frequency (operational frequency):
 2402 MHz to 2478 MHz
Maximum output power (EIRP): 2.43 dBm
Maximum communication range: 7 m in optimum conditions, though this may differ depending on the condition of surrounding radio waves.

Power supply

■ Rechargeable battery

Internal rechargeable battery: Lithium-ion battery
Charging time (to full capacity):
 Approximately 3 hours
Charging temperature: +5 to +40 °C
Operating Temperature: 0 to +40 °C
Battery run time (continuous playback time):
 Approximately 9 hours

■ USB power adaptor

Model number: UNXBU3012-050020SA
Input: 100 VAC to 240 VAC
Output: 5.1 VDC/2A (USB-A)

* The contents of this manual apply to the latest specifications as of the printing date.
 To obtain the latest manual, access the Yamaha website, and then download the manual file.

Information for users on collection and disposal of old equipment:



This symbol on the products, packaging, and/or accompanying documents means that used electrical and electronic products should not be mixed with general household waste.

For proper treatment, recovery and recycling of old products, please take them to applicable collection points, in accordance with your national legislation.

By disposing of these products correctly, you will help to save valuable resources and prevent any potential negative effects on human health and the environment which could otherwise arise from inappropriate waste handling.

For more information about collection and recycling of old products, please contact your local municipality, your waste disposal service or the point of sale where you purchased the items.

For business users in the European Union:

If you wish to discard electrical and electronic equipment, please contact your dealer or supplier for further information.

Information on Disposal in other Countries outside the European Union:

This symbol is only valid in the European Union. If you wish to discard these items, please contact your local authorities or dealer and ask for the correct method of disposal.

(58-M02 WEEE en 01)

List of Operations

The main operations of this product are as shown below.

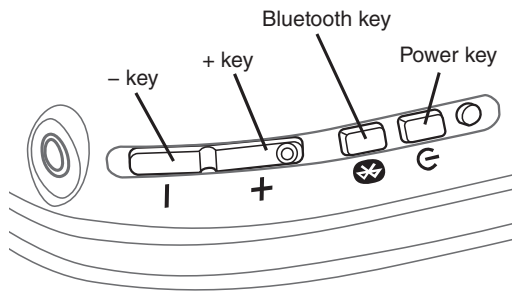

Power	
Power on	Power key
Power off	Power key (hold down for one second)
Volume	
Volume up	+ key
Volume down	- key
Volume up continuously	+ key (hold down)
Volume down continuously	- key (hold down)
Wireless communication	
Start pairing	Power key (twice)
Bluetooth	
Start registration	Bluetooth key (hold down)
Start connecting	Bluetooth key

List of Audio Messages and LED Indicator

Audio messages

The audio messages on this product are shown below.

Power	
Power Off	Power off
Battery	
Battery Low	Battery Low
Wireless communication	
Pairing Successful	Pairing Successful
	Finished connecting
Pairing Failed	Pairing unsuccessful
Bluetooth	
Connected	Finished connecting to Bluetooth device
	Finished connecting again
Disconnected	Disconnected from Bluetooth device
	Disconnected by the condition of surrounding radio waves

Appendix

LED displays

The LED displays on this product are shown below.

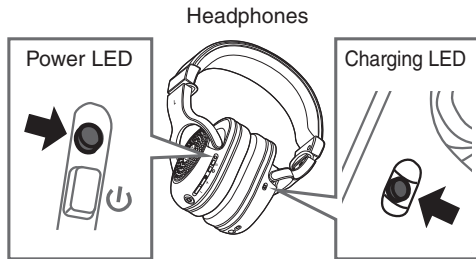

■ Power LED

Power		
Power on	Lights up (blue)	Blue
Power off	Lights off	
Wireless communication		
With no abnormalities	Lights up (blue)	Blue
Communication error	Flashes for one minute (red)	
Searching for paired Bluetooth device	Flashes (blue) for less than about 10 seconds	
Bluetooth		
Standby mode for pairing with Bluetooth device	Flashes (between red and blue alternately)	Blue Red
Firmware update		
Updating	Flashes (between red and blue alternately)	Blue Red

■ Charging LED

Battery		
Under charge	Lights up (red)	Red
Finished charging	Lights off	

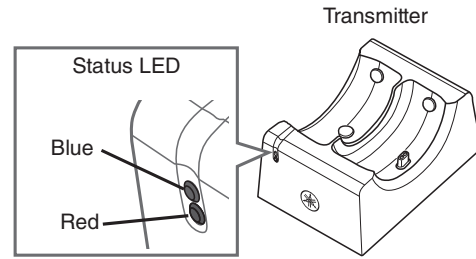

■ Status LED

Power		
Power on	Lights up (blue)	Blue
Power off	Not lit	
Audio input		
An audio input is too large	Lights up (red)	Red
Wireless communication		
With no abnormalities	Lights up (blue)	Blue
Searching for RSSI frequency (when setting the headphones to transmitter)	Flashes (blue) → Lights up (blue)	Blue → Blue
Searching for radio channels (when removing the headphones from transmitter)	Flashes for 20 seconds (blue)	
Standby mode for pairing with the headphones (when holding down the additional key)	Flashes for two minutes (blue)	
Firmware update		
Updating	Flashes (between red and blue alternately)	Blue Red

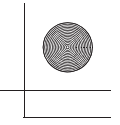
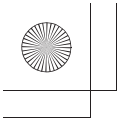

MEMO

