

Quick Guide of SIEGES



Function Key and Indicator Description

- Short press the power button, red indicator lights up means power on, red indicator lights off means power off.
- Long press the power button for about 5 seconds, blue indicator flashes means the product begin enter into the distribution network mode.
- Blue indicator flashes slowly means the network connection is abnormal, please check the router or network configuration.

Use your phone to scan the QR code below or search “smart life” in application market to download and install the APP



Step 1: Registration and login “smart life” APP.

If you don’t have the account of “Smart life” APP,register an account or sign in with cellphone number + verification code.This page describes the Registration process.

- 1.Tap “Register” in the upper right(pic 1)
- 2.The system automatically determines your country / area.You can also select your country code by yourself. Enter the cellphone number/E-mail and tap “Next” (pic 2)
- 3.If you enter the mobile cellphone number,enter the verification code in the message (pic 3), and enter the password, tap “Confirm” to finish your registration.
- 4.If you enter the E-mail,enter the password (pic 4), tap “Confirm” to finish your registration.



Make sure your phone is connected to WiFi in your home. Click “+” in the upper right corner of the homepage and select “Electrical outlet” from the device type.



Step 2: Connect with the power supply, long press the power button more than 5 seconds until the blue indicator enters into the fast flash mode.Select confirm indicator rapidly blinks.(pic 1)

Step 3: Enter your WiFi password for your phone and click “Confirm” to enter the page of the search device. (pic 2,3)

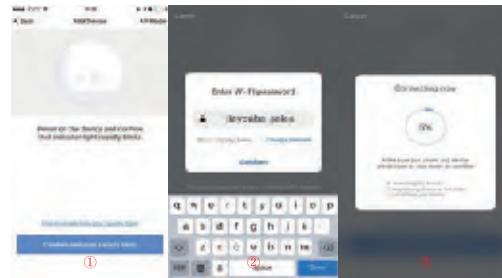

Step 4: Enter the device page, then complete the configuration

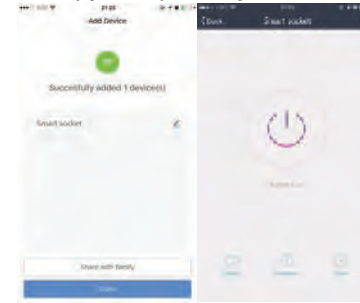

How to use Amazon Echo to control your Smart devices

Step 1: Open the “Amazon Alexa” APP,then find the “Skills” button on the menu. Press it.(pic 1)

Step 2 : Search the “Smart life” and choose the first one, then Enable it.(pic 2,3,4)



Step 3: Select your country code and Enter your “Smart life” APP Account and Password, then press the “Link Now” button. When the Account success to login press the “Done” button.



Step 4: Back to the menu, and press the “Smart home” button, then choose the “Devices”, then press the “Discover” button.



Step 5:Control your smart devices with Amazon Echo

Now, you can use Amazon Alexa to control your smart device. Take “plug one” as an example, the instructions supported include (Amazon Alexa only supports instructions in English by now):

- Alexa, turn on the plug one
- Alexa, turn off the plug one

How to use Google Home to control your Smart devices

1. Configure Google Home and enable Smart Life in Home Control

● A smart phone is needed to configure Google Home. Configuration steps are slightly different between Android and iOS system. Minimum requirement for mobile phone system is Android4.2 or iOS8.This manual will elaborate on Android phone.

● Before configuring Google Home please make sure to change the system language to English US, otherwise it will fail.

2. Configuring Google Home with an Android smart phone

1. Make sure that your Google Home has been energized.

2. Connect the phone to the Wi-Fi network which is accessible to Google service.

3. Open the Google Home APP on your phone.

4. Select "**Accept**" at the lower right corner to agree with Google's terms of service and privacy policy (Pic 1)

5. Select "**Allow**" to agree with the locating function so that the APP can find and connect devices nearby.(pic 2)



6.Click "**SIGN IN**" on the new page and enter your phone number that is associated with your Google Home account or create a new one .

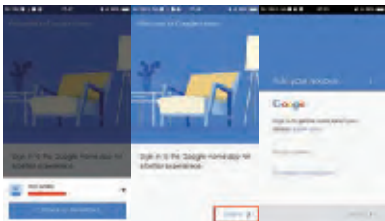

7.After logging into the Google account, the Google Home APP will try to scan surrounding Google Home devices that have been powered on. If the APP fails to find Google Home, please restart Google Home, try again, and move your phone closer to the Google Home. (Pic 1)

8. Click "**CONTINUE**" when you find the device. (Pic 2)



If you find multiple Google devices in the list, please find yours correctly, and click "**SET UP**"

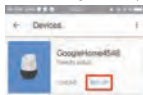

9. Then try your phone connect to Google Home. If fails, please move your phone closer to the Google Home. (pic 1)

10. After connecting to Google Home successfully, click "**PLAY TEST SOUND**", it will send you a tone to make sure that you are connected to correct equipment. If you hear the tone, click "**I HEARD IT**". (Pic 2.3)



11. Select the room in which the Google Home is located to distinguish it from other Google devices. Then click "**CONTINUE**". (pic 1)

12.Select the Wi-Fi that you want to connect to Google Home (usually is the Wi-Fi that you are using now), click "**OK**" to allow Google Home to get your Wi-Fi password automatically, then click "**CONTINUE**". You can also enter your Wi-Fi password manually. (Pic 2, 3)



13.Google Home will try to connect to the Wi-Fi network and click "**CONTINUE**" after connection is done.



14. You need to log in Google account again so that Google Assistant can respond to your requirement, click "**SIGN UP**", select the Google account you want to use, and click "**CONTINUE AS XXX**".

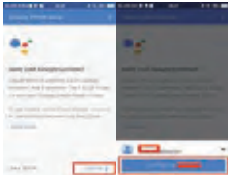

15. If you want Google Home to get your calendar and provide custom services, click "**ALLOW**", otherwise click "**SKIP**". (Pic 1)

16. Set the geographical location of Google Home, and then click "**SET LOCATION**". (Pic 2)



17. Select music service you need (Google Play Music by default), click "**CONTINUE**", otherwise "**NO THANKS**". (Pic 1, 2)

18. Click "**SKIP TUTORIAL**" to skip the tutorial. Click "**CONTINUE**" if you want to watch the tutorial. At this point, Google Home setup is completed.



3. Link Smart Life APP to Google Home

1.Click the sidebar menu in the upper left corner on Google Home APP, and select "**Home Control**".



2.Select "**SmartLife**" among the list, and click the "**add**" icon at the lower right.



3.In the login page, select the country where your Smart Life APP account if located, enter your account name and password, and click "**Link Now**". You may assign a room for your devices, and your devices will be listed in the Home Control devices.



4. Control your smart devices with Google Home

Now, you can use Google Home to control your smart devices. Take "plug one" as an example, the voice commands supported include (Google Home supports commands in English only by now):

● OK Google, turn on/off the plug one .

FCC Statement

This equipment has been tested and found to comply with the limits for a Class B digital device, pursuant to part 15 of the FCC rules. These limits are designed to provide reasonable protection against harmful interference in a residential installation. This equipment generates, uses and can radiate radio frequency energy and, if not installed and used in accordance with the instructions, may cause harmful interference to radio communications. However, there is no guarantee that interference will not occur in a particular installation. If this equipment does cause harmful interference to radio or television reception, which can be determined by turning the equipment off and on, the user is encouraged to try to correct the interference by one or more of the following measures:

- Reorient or relocate the receiving antenna.
- Increase the separation between the equipment and receiver.
- Connect the equipment into an outlet on a circuit different from that to which the receiver is connected.
- Consult the dealer or an experienced radio/TV technician for help.

To assure continued compliance, any changes or modifications not expressly approved by the party.

Responsible for compliance could void the user's authority to operate this equipment. (Example- use only shielded interface cables when connecting to computer or peripheral devices).

This equipment complies with Part 15 of the FCC Rules. Operation is subject to the following two conditions:

- (1) This device may not cause harmful interference, and
- (2) This device must accept any interference received, including interference that may cause undesired operation.

FCC Radiation Exposure Statement:

The equipment complies with FCC Radiation exposure limits set forth for uncontrolled environment. This equipment should be installed and operated with minimum distance 20cm between the radiator and your body.

.