

pure acoustics®

USER MANUAL



Model: S6BH-1

In the box

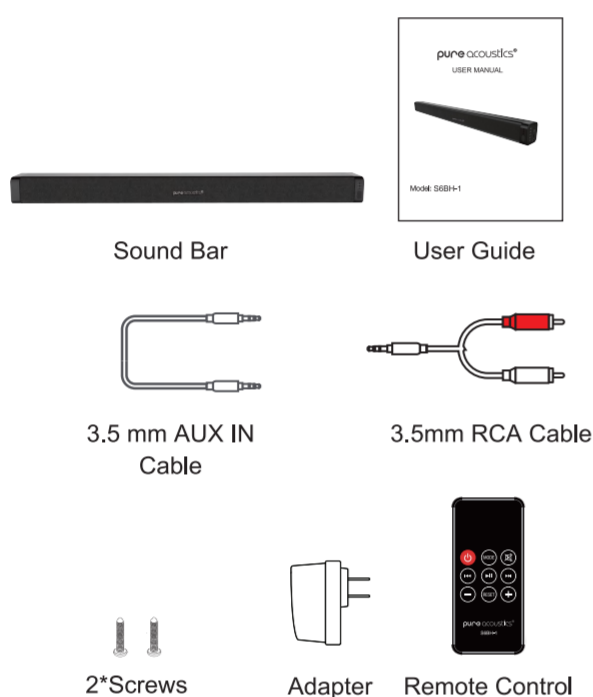

Location of controls

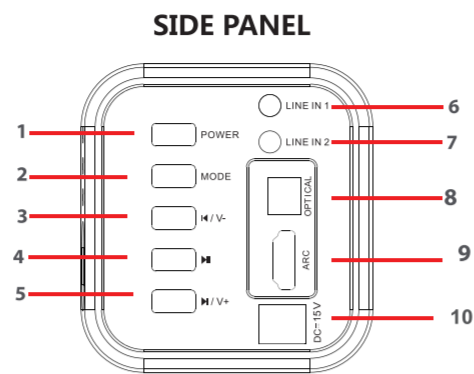

1. [POWER] button : Power ON/OFF
2. [MODE] button : Switch modes
3. [M / V-] button :decrease volume/skip to previous track
4. [M / V+] button: Play/Pause track
5. [M / V+] button: increase volume/skip to next track
6. [LINE IN 1] Input : Input LINE IN 1
7. [LINE IN 2] Input : Input LINE IN 2
8. [OPTICAL] Input : Input OPTICAL
9. [ARC] : Input ARC
10. [DC = 15V] : DC 15V IN jack

FRONT PANEL

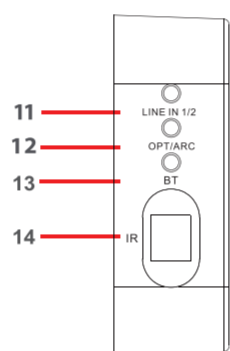

11. [LINE IN 1/2] : Input LINE IN 1/2 LED indicator light
12. [OPTIARC] : Input OPT/ARC LED indicator light
13. [BT] : BT LED indicator light (The flashing blue lights)
14. [IR] : Infrared sensor

REMOTE CONTROL

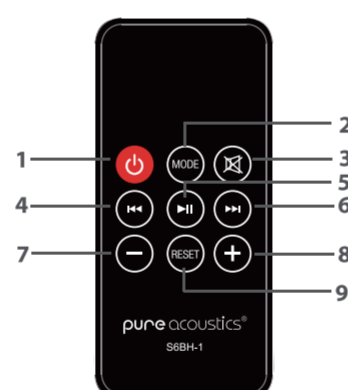

1. [] Button : Standby Power ON/OFF
2. [MODE] Button : Switch modes
3. [] Button : Mute volume
4. [] Button : Skip to previous track
5. [] Button : Play/pause track
6. [] Button : Skip to next track
7. [-] Button : Decrease volume
8. [+] Button : Increase volume
9. [RESET] Button : Restore settings

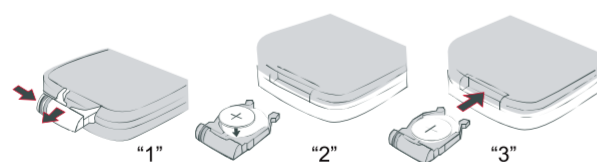

Installing the battery

The battery for the remote control (1 CR2025 Lithium Battery) is included. To replace the battery, push and slide out the battery door on the remote control. Replace the battery with a new CR2025 battery with the positive (+) polarity facing up. Slide the battery door back in to the remote control.

NOTE: The remote control is packaged with a plastic protection tab. Before operating the remote, gently pull the protective tab extending out of the remote control's battery door.

Mounting the speaker

1. Measure a width of 26.77 inches on the wall.
2. Mark the position of the mounting screws on the wall using a pencil.
3. Drill the supplied screws directly into the marks that you have made on the wall and leave approximately 0.3 inch length to hook the Wireless Sound Bar.
4. Put the Wireless Sound Bar onto the mounting screws. Make sure they are firm and stable.

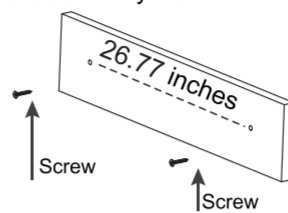

Operation process

1. Connect the DC power cord into a wall socket.
2. Turn the speaker on by pressing the [POWER] button on the speaker or remote control.

3.1 Bluetooth mode operation

- 3.1.1 Press the [MODE] button on the speaker or the remote control. When [BT] bluetooth indicator lights flashes blue and a "drip" sound is heard, then go into bluetooth pairing mode.
- 3.1.2 During the pairing process, keep the speaker and bluetooth device within 10 meters of each other.
- 3.1.3 Set your phone or other bluetooth device to bluetooth status.

Bluetooth Connection Method for Android system:

1. Go to SETTINGS> BLUETOOTH(make sure bluetooth is turned ON)
2. When your bluetooth enabled device finds the speaker, select "Pure S6BH-1" from the list of found devices. When pairing is successful, you will hear "beep, beep." [BT] Bluetooth indicat or light appears.While playing music the blue LED light will stay turned on.

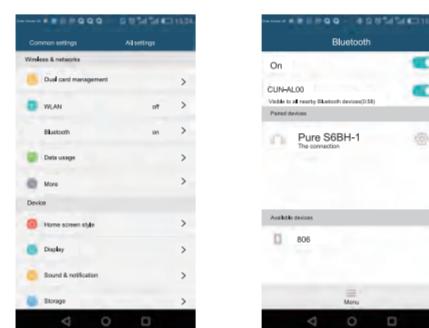

Bluetooth Connection Method for iPhone IOS system:

1. Go to SETTINGS> BLUETOOTH(make sure bluetooth is turned ON)
2. When your bluetooth enabled device finds the speaker, select "Pure S6BH-1" from the list of found devices. When pairing is successful, you will hear "beep, beep." [BT] Bluetooth indicat or light appears.While playing music the blue LED light will stay turned on.

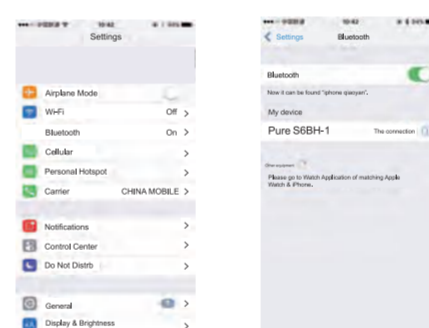

3.2 LINE IN mode operation

- 3.2.1 Insert one of the connection ports of the audio cable into the [LINE IN 1] jack, and then insert another connection port into the socket of the media playback device.
- 3.2.2 Press the [MODE] button on the speaker or the remote control. When [LINE IN 1/2] indicator light turns red ,enter LINE IN 1 state
- 3.2.3 Insert one of the connection ports of the audio cable into the [LINE IN 2] jack, and then insert another connection port into the socket of the media playback device.
- 3.2.4 Press the [MODE] button on the speaker or the remote control. When [LINE IN 1/2] indicator light turns blue ,enter LINE IN 2 state.

3.3 Optical/ARC mode operation

- 3.3.1 First please set TV to PCM mode
- 3.3.2 Please insert one connection port of OPTICAL fiber into the 8 [OPTICAL] fiber input jack or 9 [ARC] fiber input jack first, and then insert another connection port into the socket of media playback device.
- 3.3.3 Press the [MODE] button on the speaker or the remote control. When 12 [OPT/ARC] indicator light turns red , then enter the OPTICAL fiber mode state. When 12 [OPT/ARC] indicator light turns blue, then enter the ARC fiber mode state.

3.4 Volume control operation

- 3.4.1 Short press the [M / V-] button on the speaker or the [-] button on the remote control to reduce the volume.
- 3.4.2 Short press the [M / V+] button on the speaker or the [+] button on the remote control to increase the volume.

3.5 Skipping and play/pause Songs operation

- 3.5.1 Long press the [M / V-] button on the speaker or the [] button on the remote control to skip to the previous song.
- 3.5.2 Long press the [M / V+] button on the speaker or the [] button on the remote control to skip to the next song.
- 3.5.3 Press the [] button on the speaker or the remote control to play or pause music.

Specification

- ◆ Size : 810* 70* 74mm
- ◆ BT working distance : 10m
- ◆ S/N: ≥ 65db
- ◆ BT IC:5.0
- ◆ Output power : 0.9mW
- ◆ Power DC : DC 15V 1A
- ◆ Frequency Response : 65Hz~20KHz ±3dB
- ◆ Distortion: <0.5%
- ◆ Driver Size : 2.5**2

Malfunction analysis:

Consult the after-sale service for help.

Legal information:

Any copy, changes or modifications of the user manual not expressly approved unless dealer's permission.

Caution:

1. Do not take this apparatus apart or repair it.
2. Do not use near water or under humid conditions.
3. Clean only with a dry cloth.

Limited Warranty:

You may within 1 year from your original date of purchase return it to the authorized service for repair.

Cautions and warnings:

1. Do not use the Bluetooth speaker near water or under humid conditions,do not use near bathtubs, sinks, swimming pools or other water sources.
2. Do not install the Bluetooth speaker in hot or cold environments.
3. Do not expose the device in the sunshine directly.
4. Do not use the device near fire, such as, stove, candle or fireplace and so on.
5. DO not use abrasive cleaning solvents to clean the bluetooth speaker.

FCC Requirement

Any changes or modifications not expressly approved by the party responsible for compliance could void the user's authority to operate the equipment. This device complies with Part 15 of the FCC Rules. Operation is subject to the following two conditions:
(1) this device may not cause harmful interference, and
(2) this device must accept any interference received, including interference that may cause undesired operation.

Note: This equipment has been tested and found to comply with the limits for a Class B digital device, pursuant to Part 15 of the FCC Rules. These limits are designed to provide reasonable protection against harmful interference in a residential installation. This equipment generates, uses, and can radiate radio frequency energy, and if not installed and used in accordance with the instructions, may cause harmful interference to radio communications. However, there is no guarantee that interference will not occur in a particular installation. If this equipment does cause harmful interference to radio or television reception, which can be determined by turning the equipment off and on, the user is encouraged to try to correct the interference by one or more of the following measures:

- Reorient or relocate the receiving antenna.
 - Increase the separation between the equipment and receiver.
 - Connect the equipment into an outlet on a circuit different from that to which the receiver is connected.
 - Consult the dealer or an experienced radio/TV technician for help.
- This equipment complies with FCC radiation exposure limits set forth for an uncontrolled environment. This equipment should be installed and operated with a minimum distance of 20cm between the radiator & your body. This transmitter must not be co-located or operating in conjunction with any other antenna or transmitter.

备注：送大货样，工程部确认尺寸、颜色及丝印内容后方可做大货

料号：416-0S6BH091-HHY04R

生产单号：	型号：S6BH-1
料号：416-0S6BH091-HHY04R	物料名称：说明书
其它要求：105g铜版纸，黑白 正反面印刷 需按要求折叠，折叠后成品尺寸：85*110mm 内容以工程承认样品为准	
美 工	结构
电 子	审核