

wavecastRX

Bluetooth Receiver



User Guide

User Guide

Congratulations on your purchase of the WavecastRX Bluetooth wireless receiver! WavecastRX receivers are true auto connect (i.e. Bluetooth-enabled) systems which can auto connect to any Bluetooth-enabled source device, such as cell smartphones, MP3 players, etc. Now you can stream music through your favorite audio system, without being tethered to music.

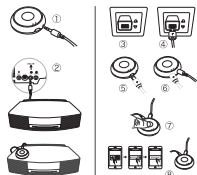

1. Product Overview

- ⓐ Main function button (MFB) = Power on / Power Mode / Play / Pause / Power off
- ⓑ Bluetooth LED indicator
- ⓒ 3.5 mm audio jack
- ⓓ USB Type-C charging port
- ⓔ Dual connection indicator

2. Package Contents

- ⓐ 1 x WavecastRX receiver (U.S. version)
- ⓑ 1 x 3.5mm audio cable
- ⓒ USB Type-C charging cable
- ⓓ User Guide

2. INITIAL SETUP

Please see the following steps in reference for the steps below:

1. Connect the 4-core 3.5mm auxiliary cable to the 3.5mm port on WavecastRX (reference to Product Overview)
2. Connect the other end of the 3.5mm auxiliary cable to the audio device's 3.5mm jack (Please please ensure that you connect to the Aux In port and not the output port marked with a headphone icon on your speaker and/or the head phone to jack)
3. Insert the attached power adapter to add power.
4. Insert the USB charging cable into the power adapter.
5. Plug the USB Type-C end of the charging cable into the WavecastRX's USB Type-C charging port (reference to Product Overview)
6. If this unit took the factory cable and USB Type-C charging cable should be changed into the WavecastRX. This will automatically put the WavecastRX into pairing mode.

7. Pressing and holding the Multifunction button (reference to Product Overview) for 2 seconds will also switch the device on and just a few pairing mode. To confirm that the device is paired, you can find the pairing mode "open" and "pairing".
8. Navigate to Bluetooth settings on your phone or tablet, and search for the new device. Once WavecastRX appears, select it and follow the prompts to complete the pairing process. Once successfully paired, you will hear the phrase "successfully connected".

3. POWER OFF

1. Press and hold the Multifunction button for 3 seconds to switch WavecastRX off. You can also press the power "Sleep" off.
2. Remove the USB Type-C cable from the WavecastRX to power the unit off.

4. PAIRING WITH TWO DEVICES

1. Put the first device to WavecastRX using the steps outlined above.
2. Switch off Bluetooth on the first device. WavecastRX should now be successful to be paired successfully. Once both devices are successfully connected, the second LED will light up blue.

5. RECONNECTING TO A PREVIOUSLY PAIRED DEVICE

1. Remove the WavecastRX's power source, and automatically reconnect to the last paired and successful device.
2. To pair the WavecastRX to a second device, press and hold the Multifunction button for approximately 3 seconds or until you hear the phrase "pairing", then follow the instructions above.

6. FUNCTION DESCRIPTION

| Function | Indicator | LED |
|------------|---|--------------------------|
| Power On | Change the WavecastRX via USB Type-C | Blue LED flashes rapidly |
| Power Off | Using the USB Type-C cable from WavecastRX | N/A |
| Paired | Press and hold the Multifunction button for 3 seconds. The device stops in pairing mode for 30 minutes. If not paired during this time, check the LED | Blue LED flashes rapidly |
| Play mode | If music is played, press the Multifunction button once to start playing the music | Blue LED ON |
| Pause mode | To pause music, press the Multifunction button once | Blue LED ON |
| Standby | Connected to a Bluetooth device, but in auto-streaming | Blue LED ON |

7. RESETTING THE WAVECASTRX

If the WavecastRX is working abnormally, it may require a factory reset. Once the reset is complete, all existing pairing information is lost, and all previously paired devices will have to be paired again using the steps outlined above.

Note: Please make sure that the WavecastRX is powered on in each device prior to doing the factory reset.

- To do a factory reset, press the Multifunction button for approximately six seconds, or until you hear the phrase "Sleep off" followed by a beep.

8. PRODUCT SPECIFICATIONS

- Bluetooth Version: V5.0+ EDR
- Operating Range: 100m (32.8 ft) (no obstacles)
- Supported Profiles: A2DP, L2CAP, AVRCP, VLD
- Supported Channels: AAC, SBC, MP3
- Advanced Support: USB Connection to Two Devices

9. WARRANTY

The WavecastRX Bluetooth receiver ships with a 1-year warranty. If you do encounter any issues during the trial, you can initiate a warranty claim by contacting us via email at support@tascam.com or by mail. See Contact Us page on our website. (<https://www.tascam.com/page/contact-us>)

NOTE: This equipment has been tested and found to comply with the limits for a Class B digital device, pursuant to part 15 of the FCC rules. These limits are designed to provide reasonable protection against harmful interference in a residential environment. This equipment generates and receives radio frequency energy and, if not installed and used in accordance with the instructions included in the user manual, may cause interference to radio communications. This equipment does not warrant interference to radio or television reception, which can be determined by testing the equipment and/or by the user's responsibility to re-connect the interference by one or more of the following measures:

- Reorient or relocate the receiving antenna.
- Increase the separation between the equipment and receiver.
- Connect the equipment to an outlet on a circuit different than that to which the receiver is connected.
- Consult the dealer or an experienced radio/TV technician for help.

Changes or modifications not expressly approved by the party responsible for compliance could void the user's authority to operate the equipment.

This device complies with Part 15 of the FCC Rules. Operation is subject to the following conditions:

- 1) This device may not cause harmful interference, and
- 2) This device must accept any interference received, including interference that may cause degraded operation.