

REMOTE CONTROL AIRCRAFT SERIES

1. CONTROLLER COMPONENTS:

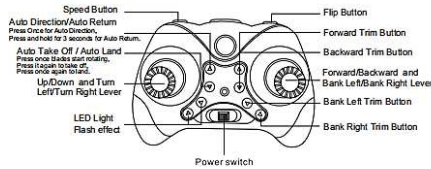

2. SETTING UP THE CONTROLLER / DRONE:

INSTALLING THE CONTROLLER BATTERIES

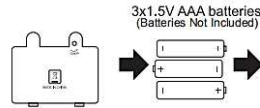

NOTE:
1. Always have an adult install the batteries
2. Always use Alkaline Batteries
3. Never mix old and new batteries

- Unscrew the battery cover, and insert 3 AAA batteries (Batteries Not Included), making sure you insert them following the correct polarity as shown.
- Re-tighten the battery cover.

2

CHARGING YOUR DRONE BATTERY

IMPORTANT – READ BEFORE CHARGING:

BATTERY WARNING:

Lithium Polymer batteries can expand, burst or catch fire if used incorrectly, causing both property damage and/or personal injury. It is essential that you follow all the included instructions and safety warnings in full. The manufacturer, distributors and retailers will assume no liability for the failure to comply with these safety instructions and warnings.

INSTRUCTIONS WHEN CHARGING:

- The battery must be removed from the product prior to any charging.
- If the battery has just been used, please let it cool back down to room temperature before charging.
- Charging must only be undertaken by an Adult, and only using the charger included with this product.
- Always charge the battery on a non flammable heat resistant surface with non flammable surroundings.



- Connect the battery to the USB charging cable making sure you insert the T shaped battery plug into the T shaped socket in the USB charging cable. Then connect the other side of the USB cable to your USB charging device (laptop, computer, USB plug charger etc.). The RED LED on the USB charger will be ON while charging, and will Turn Off once fully charged. Remove the battery from the charger cable as soon as the LED turn off, or after 60 minutes whichever is first. NEVER charge the battery for more than 60 minutes. Never continue to charge the battery after the LED has turned off. Always disconnect the USB cable after charging.
- Lithium Polymer batteries do not last forever. If your battery becomes damaged in a crash or no longer charges properly, immediately replace it with a new battery. To prolong the life of your battery, it is always best to retain a bit of charge in your battery prior to charging it.

IMPORTANT BATTERY CARE INSTRUCTIONS:

If your battery ever starts to smell, change colour or look swollen, you must stop using it immediately and must not attempt to recharge it. If the battery ever starts to smell, change colour or expand whilst charging, you must stop charging immediately, remove the battery from the charger and place the battery on a non flammable heat resistant surface. Do not attempt to charge the battery. Be advised that the battery may be hot so be careful when handling it. Disposal of any battery should be done at your local recycling centre.

3

3. SAFE FLIGHT ENVIRONMENT:

- Make sure the surrounding area is free of all people, pets or other obstacles before you start to fly.
- The Drone Pilot is an Indoor / Outdoor flyer, but care should be taken outside if flying in wind. Do not fly when wet.
- Leave 1.5 metres between you and the Drone at all times.

4. SETTING UP THE SIGNAL CONNECTION:

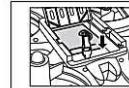

Step 1

Slide open the battery cover on the drone. Insert the battery, connecting the battery cable into the drone plug point, making sure to connect following the right T fit. Slide the battery cover closed, turn the switch on the drone to ON, and place it down onto a flat surface making sure the drone is facing AWAY from you.



Step 2

Now turn on the controller power switch, and you will hear four BEEPS sound. Raise the Up/Down Throttle lever all the way to TOP position, and then lower it all the way to the BOTTOM position. The controller should then BEEP twice and your controller and drone are now paired. Then the next step you can Press the Auto Take off / Auto Land Button to start the flight.



Step 3

Always turn the power switch on the drone to OFF after flight.



Step 4

Always turn the power switch on the controller to OFF after flight.

5. AUTO TAKE OFF / AUTO LAND:

Press the Auto Take off / Auto Land Button once and the drones blades will start to rotate slowly, then

Option 1) You can press it again to lift the drone into the air at a height of about 1.5 metres and keep hover at around that height, which you can use the UP/DOWN and Turn left/Turn right Lever to control if going up or down as you wish.

Option 2) You can push up the UP/DOWN and Turn left/Turn right Lever slowly to lift the drone into the air slowly to a certain height which you prefer, and then keep it hover around at that height.

Important: Please Make sure you or anyone else is not leaning over the drone, or getting close to look down on the drone while you start to press the buttons.

Emergency Stop Button:

If for any reason you ever want the blades of the drone to stop for any reason, either on the ground or in the air, push both control levers to the positions shown in the picture. Make sure no one is underneath the drone if you use the Emergency Stop Button whilst in the air.

4

6. FLIGHT CONTROL:

ALWAYS PRACTICE THE MOVES OF FLYING A DRONE ON THE FLOOR BEFORE TAKING OFF FOR THE FIRST TIME.

Place the Drone on a flat surface, making sure the GREEN LED light is pointing away from you. The GREEN LED will always indicate the FORWARD Flying direction.

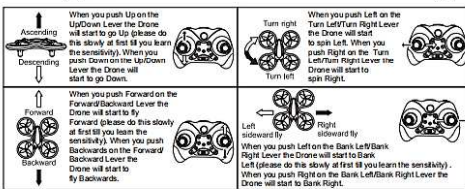

TIP: It is much easier when you start to learn to fly the Drone, to ignore Turn Right / Turn Left. By using Up/Down, Forward/Backward, Bank Left/Bank Right, the Drone will still be able to fly anywhere. Also by keeping the GREEN LED facing forwards at all times, it is much easier to know which direction you will go in.

7. HOW TO DO A 360 FLIP:

- Make sure the Drone is flying at least 1.5 metres above the floor, or 1.5 metres below a ceiling.
- Press the Flip Button on the controller. The controller will make a "BEEP" sound, then flick the right hand lever in any direction, and the Drone will flip in that direction.
- You may need to push up on the Up/Down Lever after the flip, if your battery is low on power in order to keep the Drone high in the air after the Flip.

8. AUTO DIRECTION/AUTO RETURN:

Sometimes when you fly your drone a long way away it is hard to see what direction it is facing, and this can make it very hard to control. If you want to make your drone controls simpler when you first start flying, or if you are going on a long distance flight, the AUTO DIRECTION mode can help. Quick press the AUTO DIRECTION/AUTO RETURN button, and wait till you hear two BEEPS and the lights on the drone will start to flash. You are now in AUTO DIRECTION mode. In AUTO DIRECTION mode, whatever direction the drone is facing, pushing forward will fly it away from you, and pushing backwards will fly it towards you, making it simpler to fly. To exit the mode, press the button again, the controller will make a BEEP sound and the drone will stop flashing.

This drone also has an AUTO RETURN button that will return the drone back in your direction at any point in the flight. To activate AUTO RETURN just long press and hold the AUTO DIRECTION/AUTO RETURN button.

WARNING: For the AUTO RETURN button to work, you must always remain facing in the same direction throughout your flight that you were facing when you connected the drone. If you have changed your facing direction, the drone will return to the wrong position when you press the button. Also the drone will not stop flying when it gets to your position and you will have to stop it manually by pushing the Forward direction.

5

9. FEATURES:

SPEED CONTROL: When you first turn on your Drone, it is set to 40% speed, you will hear ONE beep. When you press the SPEED Button, you will hear TWO beeps and the speed will be increased to 60%. Pressing the SPEED Button again you will hear THREE beeps and the speed will increase to 100%. Pressing again will bring you back to 40% speed and you will hear ONE beep. Always learn to fly at 40% speed, and then you can increase it as you get better at flying.

10. FLIGHT ADJUSTMENT SECTION:

When you lift your Drone into the air, and don't use any of the other control levers, it should just HOVER in one spot. If it doesn't, you can follow the below instructions to bring your Drone back to a perfect HOVER.

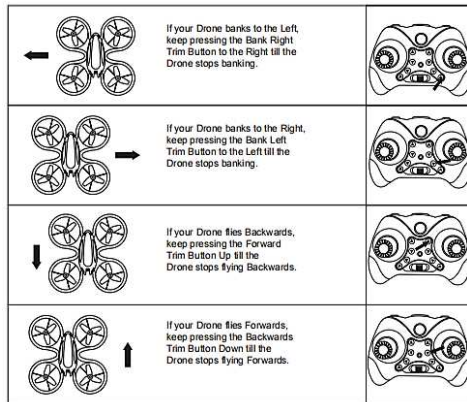

6

11. RESETTING THE DRONE:

Push both control levers to the positions shown in the picture, and hold them for few seconds, the controller will make a BEEP sound, the lights on the drone will begin to flash. After the lights stop to flash, the drone is recovered to its original factory settings and ready to fly again.

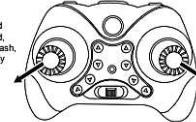

12. REPLACING BLADES AND FIXING ISSUES:

1. BLADE REPLACEMENT: Your Drone blades are very strong, but sometimes they can get damaged with a bad crash. You have spare blades in the box, and to replace them it is as easy as just placing a new one back on over the motor bar. You must always replace an A Blade with an A Blade, and a B Blade with a B Blade.

2. DRONE NOT LIFTING OR NOT FLYING IN YOUR CHOSEN DIRECTION:

- The most common reason for a Drone not lifting or flying in your chosen direction properly is that you have hair and debris wrapped around one or more of the blades. This is simple to remove, just take off the blade. Remove the debris, and place the blade back on.
- The batteries in either the Drone or Controller may need charging (or replacing if its the batteries in the controller).
- You may have knocked your Trim Button settings out of sync. Follow the instructions earlier in this booklet to reset them back to the factory settings, and then re-trim as desired.

13. WARNINGS:

- The Drone is designed for 8+
- Adult Supervision is always recommended.
- Always ensure your flight area is free of all obstacles, and always flown in excess of 1.5 meters from yourself and others.
- Charging always to be undertaken or overseen by an Adult, and only ever with the charger cable supplied.
- Do not plug in or charge this product till you have read and fully understood the battery charging section of the instructions included.
- Always charge on a non-flammable surface, with non-flammable surroundings
- Never leave unattended whilst charging, and never over charge.
- Never expose the drone or its battery to excess heat.
- Never touch the blades whilst they are in motion.
- If your drone becomes damaged, stop using it immediately.

7

FCC Statement

WARNING: Any changes or modifications not expressly approved by the party responsible for compliance could void the user's authority to operate this equipment.

NOTE: This equipment has been tested and found to comply with the limits for a Class B digital device, pursuant to Part 15 of the FCC Rules. These limits are designed to provide reasonable protection against harmful interference in a residential installation. This equipment generates uses and can radiate radio frequency energy and, if not installed and used in accordance with the instructions, may cause harmful interference to radio communications. However, there is no guarantee that interference will not occur in a particular installation. If this equipment does cause harmful interference to radio or television reception, which can be determined by turning the equipment off and on, the user is encouraged to try to correct the interference by one of the following measures:

- Reorient or relocate the receiving antenna.
- Increase the separation between the equipment and receiver.
- Connect the equipment into an outlet on a circuit different from that to which the receiver is connected.
- Consult the dealer or an experienced radio/TV technician for help.

8