

Solar Robotic Pool Skimmer

HVIN: Peng Plus

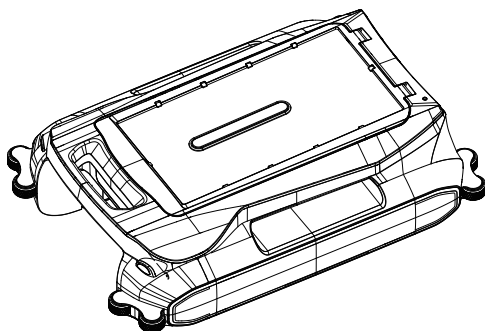

User Manual

(Note: Please read this manual carefully before use to avoid danger or damage to the product due to improper operation)

FCC STATEMENT :

This device complies with Part 15 of the FCC Rules. Operation is subject to the following two conditions:

- (1) This device may not cause harmful interference, and
- (2) This device must accept any interference received, including interference that may cause undesired operation.

Warning: Changes or modifications not expressly approved by the party responsible for compliance could void the user's authority to operate the equipment.

NOTE: This equipment has been tested and found to comply with the limits for a Class B digital device, pursuant to Part 15 of the FCC Rules. These limits are designed to provide reasonable protection against harmful interference in a residential installation. This equipment generates uses and can radiate radio frequency energy and, if not installed and used in accordance with the instructions, may cause harmful interference to radio communications. However, there is no guarantee that interference will not occur in a particular installation. If this equipment does cause harmful interference to radio or television reception, which can be determined by turning the equipment off and on, the user is encouraged to try to correct the interference by one or more of the following measures:

- Reorient or relocate the receiving antenna.

- Increase the separation between the equipment and receiver.

- Connect the equipment into an outlet on a circuit different from that to which the receiver is connected.

- Consult the dealer or an experienced radio/TV technician for help.

FCC Radiation Exposure Statement:

This equipment complies with FCC radiation exposure limits set forth for an uncontrolled environment. This equipment should be installed and operated with minimum distance 20cm between the radiator & your body.

catalogue

1. Safety statement

2. Product description

2.1 Part name

2.2 Product parameter

3. Instructions for use

3.1 Operation guide

3.2 APP connection

3.3 Product maintenance

4. Common Faults

5. Replaceable modules

Safety statement

Please read the following safety instructions and follow all usual safety precautions before using this product

Please read this manual carefully and keep this manual

Any operation inconsistent with this instruction manual may cause damage to the product

Host and accessories related safety precautions

warn

01. Do not disassemble, repair or modify the machine yourself, otherwise it will damage the product and cause danger.
02. Do not use this product in an environment where there is a possibility of fire or explosion.
03. Do not stand or sit on the product or it may cause damage to the product or fall.

Look out

01. When the garbage basket is full, please empty the garbage before using the machine.
02. The use temperature range of this product is 0 degrees Celsius to 40 degrees Celsius, do not use in high or low temperature environment.
03. This appliance can be used by children aged from 8 years and above and persons with reduced physical, sensory or mental capabilities or lack of experience and knowledge if they have been given supervision or instruction concerning use of the appliance in a safe way and understand the hazards involved. Children shall not play with the appliance. Cleaning and user maintenance shall not be made by children without supervision.
04. Please remove the battery from the machine before scrapping the product. When removing the battery, please ensure that the product is not connected to the power supply.
05. The recycled batteries are centrally placed in the battery recycling bins or harmful garbage bins set up in communities, hotels, schools, large shopping malls, supermarkets, etc., and collected by professional recycling agencies. Waste product batteries must be removed and discarded in accordance with local laws and regulations.
06. If not used for a long time, please turn off the power switch and recharge regularly.
07. This appliance must only be supplied at safety extra low voltage corresponding to the marking on the appliance.
08. This appliance contains batteries that are only replaceable by skilled persons.

Safety statement

How to remove the battery

- ① Remove the six screws on the bottom cover and remove the bottom cover.
- ② Remove 52 screws from the left and right shell assembly and the front shell assembly, then remove 8 screws from the motor assembly on both sides, and finally remove 12 screws from the battery assembly and remove the battery assembly.
- ③ Remove the screws from the battery compartment and remove the battery.

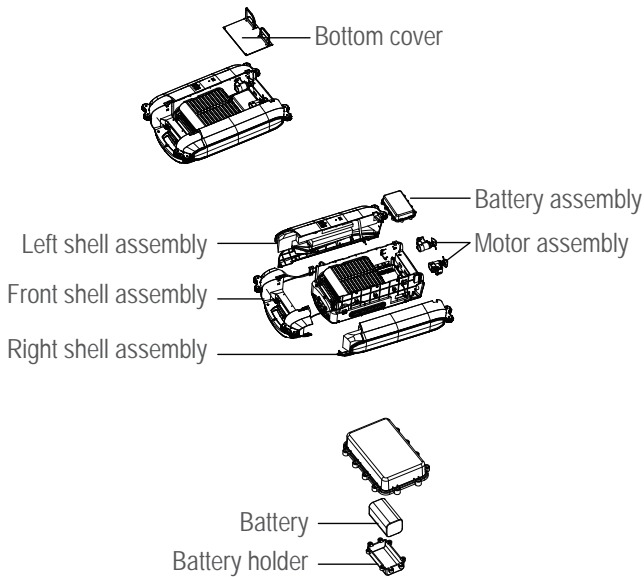

Product composition

2.1Part name

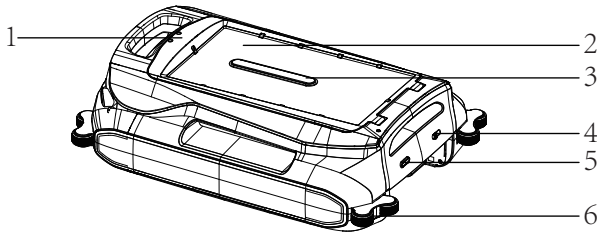

1.Flip open button
4.Power switch

2.Solar panels
5.Rear LED light

3.Trash basket detection port
6.Guide wheel

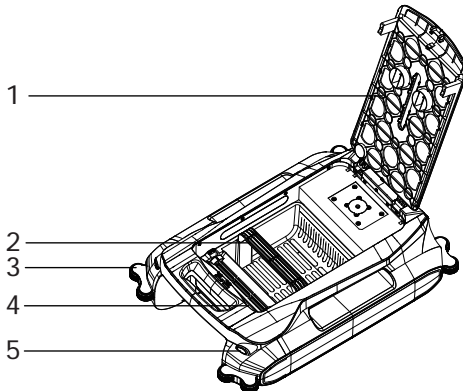

1.Fliptop 2.Trash basket 3.Guide wheel 4.impeller 5.Front LED light

Product composition

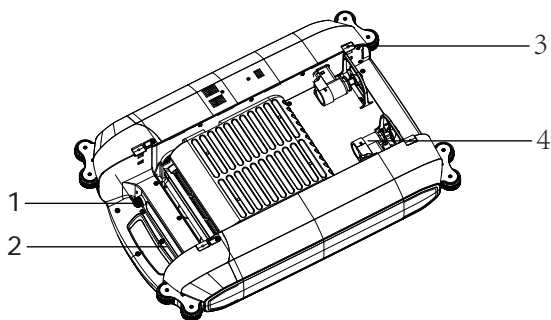

1. TYPE-C- charging port seal cover
3. Anti-kick rod

2. Ultrasonic obstacle avoidance sensor
4. Propeller motor



Product composition

2.2Product parameters

Structure

Dimensions of the main unit	663*453*193mm
Net weight of the main unit	6kg

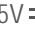
Electronic

Charging port input	5V  2A
Rated power	3W
Rated voltage	7.2V 
Battery rated capacity	4800mAh
Typical battery capacity	5100mAh
Type C charging time	5.5h

Accessory

Trash basket capacity	4.5L
Basket size	305*245*135mm

Instructions for use

3.1 Operational Guidelines

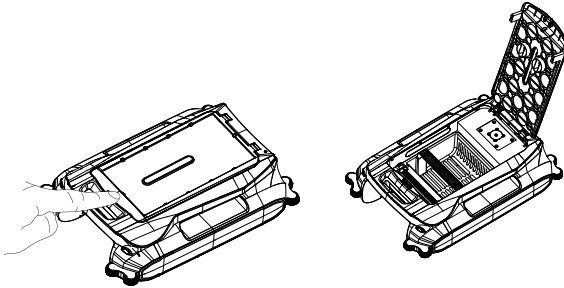

Press the flip open button before use to check that the trash basket is in place.

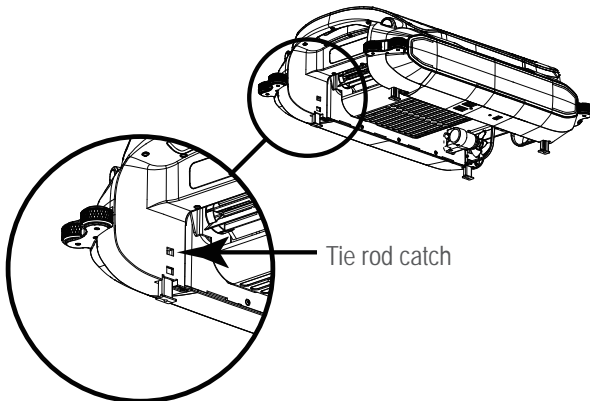

There is a boundary anti-kara rod around the bottom of the machine, if the water surface of the pool is close to the level of the pool shore, you need to press tie rod catch and pull out the tie rod.

The machine needs to be placed gently on the water. It should not be thrown or dropped as this will cause the machine's solar panels to pop off.

Instructions for use

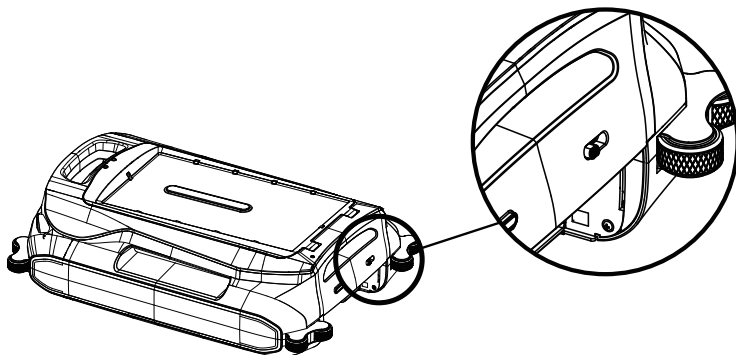

Turn on the power switch of the machine, the machine will turn on the green indicator light, and the machine will start to work forward automatically within 3 to 5 seconds. Automatically avoid turning when encountering obstacles ahead.

In the outdoor scene, when the power is less than 20%, the machine automatically finds the area with strong sunlight intensity, suspends the previous work for charging, and the machine will automatically continue to work when the power is charged to 30%.

When the ambient light intensity is insufficient, the machine defaults to night and will stop working to enter sleep mode. When the ambient light intensity is sufficient, the machine will automatically wake up and start working automatically.

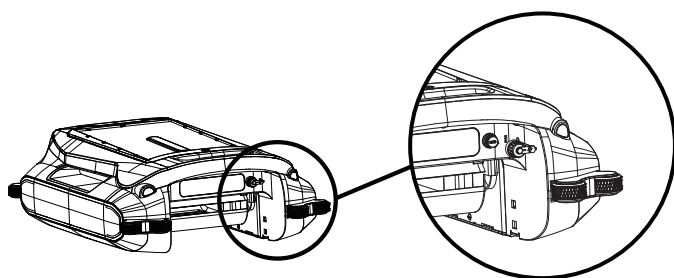

The machine works in an outdoor setting with 100% of its electricity coming from solar energy. In summer, the machine can be fully used for daytime work by converting solar energy into electricity. In the winter, the machine needs more time to charge, which will reduce the working time.

The machine works in indoor scenarios and needs to be charged with a 5V \equiv 2A adapter. Before charging make sure that the machine Type C charging port is free of water stains, turn counterclockwise to open the charging cover, and connect the Type C charging cable. While charging, the machine will stop working. Please keep the power switch on during charging. After charging, be sure to tighten the charge cover clockwise.

Instructions for use

LED indicator

01. When the APP remote control machine turns, the green light flashes quickly.
02. When the machine automatically cleans the pool, the green light flashes slowly.
03. Breathing flashes red when garbage basket is full.
04. Flash the red light when the machine power is low.
05. When the machine is charging type C, the red light flashes slowly. Turn off the lights when the charge is full.
06. When the machine is faulty, the red light is steady on.
07. When the machine is in standby state, it is steady green. Turn off the lights after sleep.

troubleshooting

When a foreign body clogs the impeller or propeller, resulting in a slow motor speed, the LED light on the machine will be steady red. The machine is in the stopped state, need to clean the blockage, switch the machine again to activate the machine.

When the battery is low, the LED on the machine will flash red. The machine should be placed in a place with ambient light intensity for solar charging or type C charging.

The ultrasonic sensor is dirty and water stained, which will affect the ranging, resulting in the machine constantly rotating in the working mode. Wipe the ultrasonic sensor clean with a towel and return to normal.

Instructions for use

3.2APP connection

APP settings

Scan QR code of Figure 1 , then download and install "LIBOS HOME" APP or Search for LIBOS HOME on the App Store or Android App platforms. Then, download and install it.



Figure1

Open the "LIBOS HOME" App and log in. There are two ways to log in: by verification code or by password.

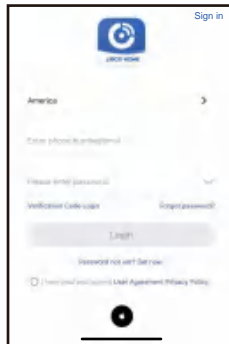

Figure2

After logging in, click "+" in the upper right corner of Figure 3 to add equipment. Select "Pool Cleaner" and follow the instructions on the page to connect.

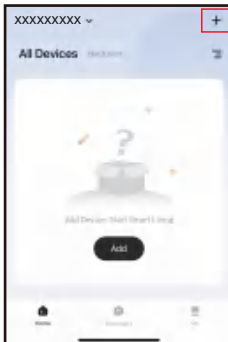

Figure3



Figure4

The final interface is subject to the actual product, thank you.

Instructions for use

Follow the page prompts to turn on your device and keep it within range and turn on your phone's Bluetooth. After confirming the completion of the above steps and the status of the device, click Next. Wait for the device to be bound.



Figure5

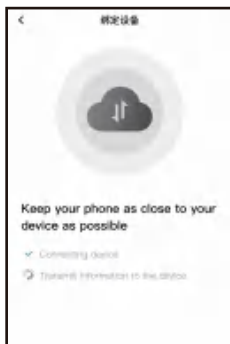

Figure6

After successful binding, you can control the device.

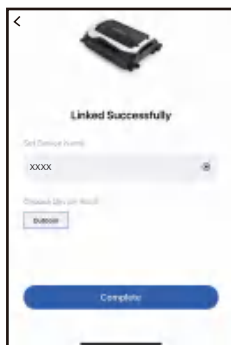

Figure7

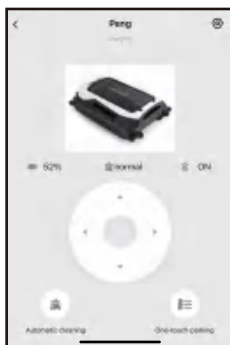
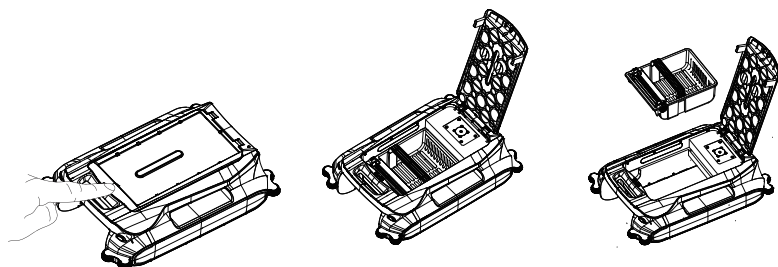

Figure8

Instructions for use

3.3 Product maintenance



Press the flip open button to remove the trash basket.

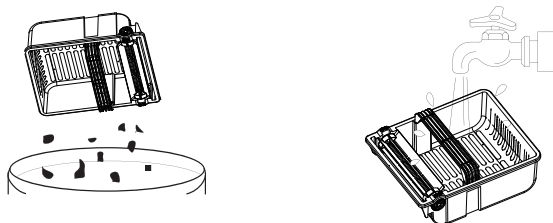

Clean out the trash in the trash basket, clean it with water, and put it back into the machine.

Instructions for use

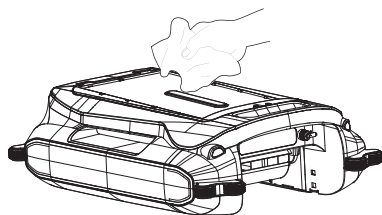

In order to ensure the efficiency of solar charging, it is necessary to regularly clean up dust, fallen leaves and other debris. The solar panel can be rinsed with water and wiped clean.

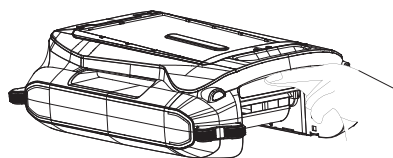

For ultrasonic sensors, dust should be cleaned regularly. If there is dirt and water stains, it will affect the distance measurement of the machine, causing the machine to keep rotating. Use a clean towel to wipe clean and return to normal.

Common Faults

Faults Description

Faults	Possible Reasons	Solution
Machine does not work	The power switch at the rear of the machine is not turned on	Turn the power switch on
	The machine is out of power or the power is not enough	Please use the adapter to fully charge or put it under the sunlight to charge (the machine will work automatically after charging to 30%)
	The machine triggers an alarm fault	According to the indicator status or APP prompts, troubleshooting
	The waste basket is full, the light flashes red.	The machine needs to be switched on and off again to activate the machine after clearing the blockage
	The machine is in non-automatic cleaning mode	Enter auto-cleaning mode in APP or switch on the machine again.
The product cannot be charged	The power switch at the rear of the machine is not turned on	Turn the power switch on
	The charging plug of Type C cable is not fully inserted	Please check whether the charging cable is plugged in properly
	Outdoor sunlight is not enough	Please use the Type C adapter to charge the machine.
Machine rotates in place	The ultrasonic sensor surface is dirty or excessively waterlogged	Please wipe the ultrasonic sensor with a towel

Replaceable modules

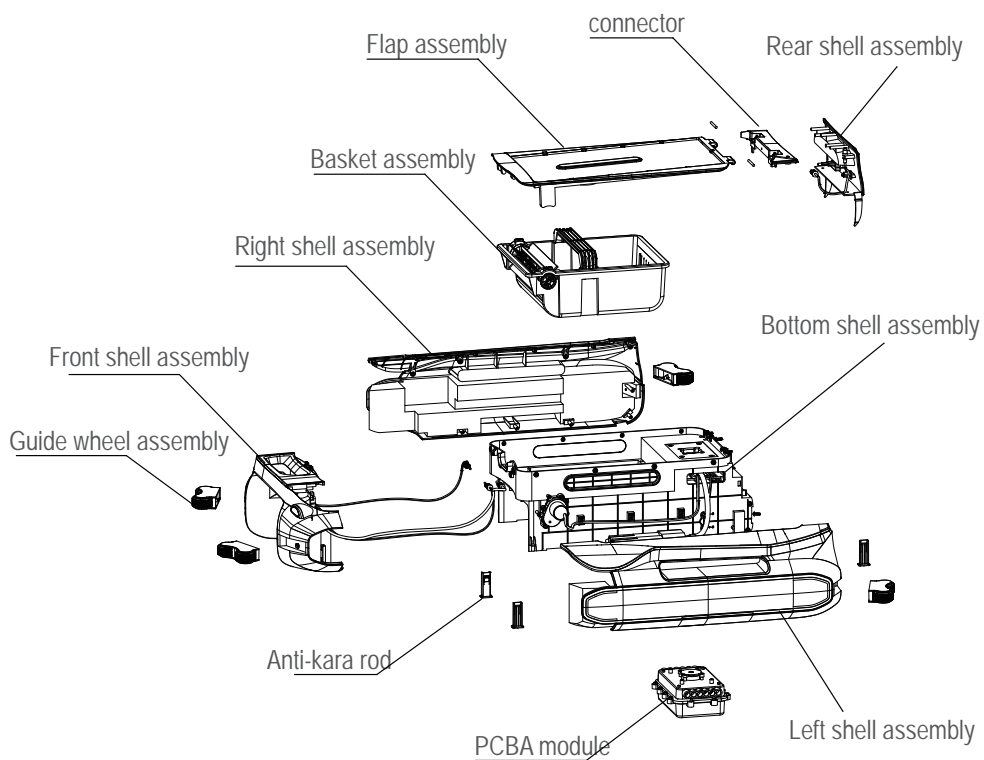

IC Warning

This device complies with Industry Canada's licence-exempt RSS standard(s). Operation is subject to the following two conditions:

- (1) this device may not cause interference, and
- (2) this device must accept any interference, including interference that may cause undesired operation of the device.

Le présent appareil est conforme aux CNR d'Industrie Canada applicables aux appareils radio exempts de licence. L'exploitation est autorisée aux deux conditions suivantes:

- (1) l'appareil nedit pas produire de brouillage, et
- (2) l'utilisateur de l'appareil doit accepter tout brouillage radioélectrique subi, même si le brouillage est susceptible d'en compromettre le fonctionnement.

This Class B digital apparatus complies with Canadian ICES-003.

Cet appareil numérique de la classe B est conforme à la norme NMB-003 du Canada.

IC RF Statement:

When using the product, maintain a distance of 20cm from the body to ensure compliance with RF exposure requirements.

Déclaration IC RF:

Lors de l'utilisation du produit, maintenez une distance de 20 cm du corps pour garantir conformité aux exigences d'exposition aux RF.