

# User Manual

SM9110 main unit

SM9110 remote control



## Introduction

Congratulations on your purchase of the Wireless device. The Wireless can help relieve pain wirelessly with a touch screen remote control without having to use lead wires. This device utilizes cutting-edge TENS technology to help relieve pain in various areas of the body. This TENS & EMS device is wireless, user-friendly, safe to use, and best of all, is completely drug-free! This wire-free TENS devices is portable and allows users to manage pain and lead a more active lifestyle without the use of medication.

## TENS & EMS Massage Areas

Users can select specially designed modes for specific parts of the body and can control the intensity for their own customized TENS & EMS Experience.

### Specially designed stimulation areas include:

Neck, Shoulder, Upper Back,  
Lower Back, Sciatica,  
Pelvic, Hip, leg, Biceps,  
Forearm, Thigh and Knee

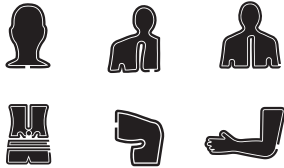

**Please note:** Each intensity mode are recommendations for each body part however it can be used with any body part shown.



Device Operation

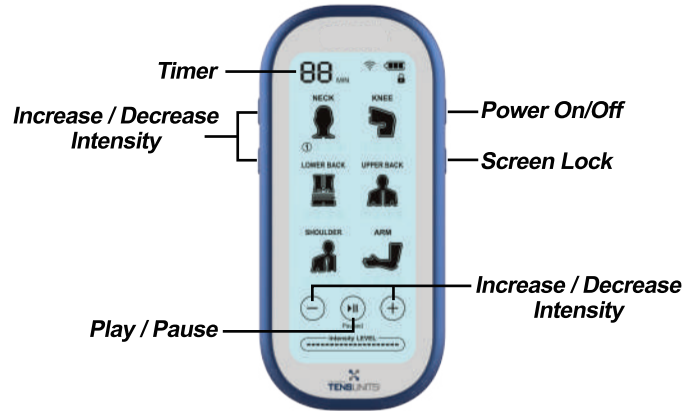

## Device Setup & Usage Guideline

1. Use a damp towel or alcohol prep pads to clean the area of skin to remove any excess oils, cosmetics or dirt before placement of pads on skin (This will help prolong the life of the electrode pads). The targeted pain area must be clear of any dirt and excess oils to proceed. Do not use electrode pads on unhealthy skin.

2. Connect electrode pad(s) (large butterfly pad or small square pads) to the wireless round host device with snap pin connectors. (If using small electrode pads the lead wire will be required) Do not activate device before placing electrodes.

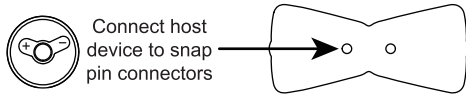



3. Peel off the protective film on the pads. Keep the protective film strips as this film must be reapplied to the electrodes to store them after use. (Try to avoid having the electrode pad adhesive surface from touching anything other than the body area it is being applied to. Doing so will prolong the lifespan of the electrodes.)

Warning: Do not touch or connect the electrode pads together. (each side of butterfly pad or two separate small

pads)

4. Place the device over the desired pain area. Ensure that the electrodes are in full contact with the skin.

5. Press the center power button on the wireless host. Blue light will activate and flash on device.

6. Press the remote control's power button which is the top right side button on the remote. (Make sure remote is charged and Icon on the top right of remote screen) The device will turn on. The Neck Mode will be on by default. Once the host device is successfully connected to the remote control, the connection symbol  will display on the remote control screen and the Head Icon  will flash. If the remote control is not operated or connected within two minutes, it will automatically power down.

7. Stimulation will end on its own after 30 minutes. Stimulation can be stopped anytime by pressing power button on the host or remote control. DO NOT attempt to remove the device from the body during stimulation.

8. **Set the Mode.** Press the body parts on the touch screen on the remote control to set the mode OR quickly tap the power button on the host device to set the mode. For safety, when the mode is changed, the intensity will

automatically decrease to the lowest setting. After you change modes you **must again increase the Intensity**. Press the “+” to increase intensity or the “-” button to decrease intensity on the screen or on the left side of the remote.

**Timer setting.** Press remote's top left number to set time. Stimulation can be set between 10-60mins in increments of 10 mins. **Pause Unit:** Press the ►|| on remote control to pause and/or continue the stimulation.

**9.** To power off device during stimulation, press down the power button on the top right side of the remote control for 3 seconds or press and hold the power button on the host device for 3 seconds.

**OPTIONAL small wired electrode pads. For smaller body part areas** (Device can be used as a standard wired TENS device).

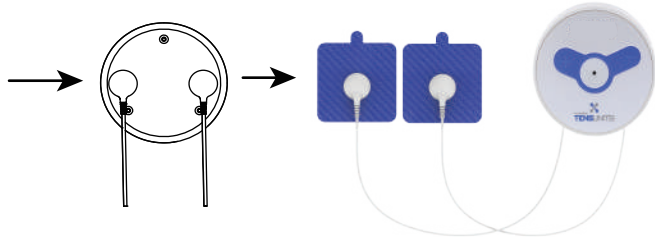

## Included in Package

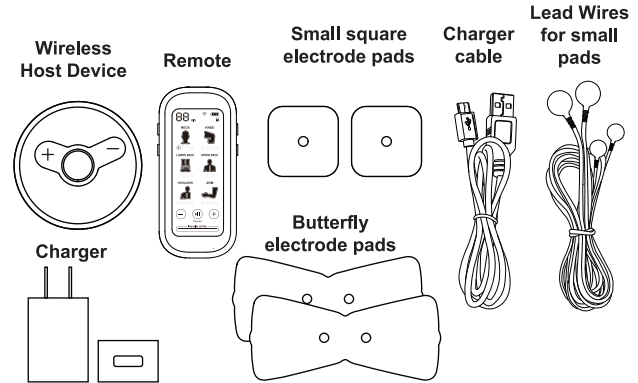

**Note:** Control Host unit only compatible with Omega Wireless Large Pads.

- 1 Wireless TENS & EMS
- 1 Remote controller
- 1 Pair small square electrode pads
- 1 Charger and USB charging cord
- 1 Optional Lead wire
- 2 Pairs of large gel snap connector electrode pads
- 1 User manual

**Note:**

1. This Tens Unit is only compatible with Wireless Snap Connector Electrode Pads.
2. When host is used by itself the remote control can be added mid-stimulation, and the strength will reset to the default starting value after the remote is connected.

**Unit Storage & Maintenance**

- It is recommended that this unit be charged for more than ten hours after the battery is fully depleted to prolong the life of the built-in lithium ion battery. Unplug charger from power outlet when charging is complete. DO NOT operate this device while it is charging.

- Use a damp cloth with mild soap to gently wipe down and clean the unit.

Note: This unit has water detection technology. Do not expose or submerge this unit in water or any other liquids. Water damage to the device or its components will void the warranty.

- This unit should be operated, transported and stored at temperatures between 50° F and 104° F (10° C and 40° C), with relative humidity between 30% - 85%. All values have +/- 10% tolerance.

- Store the device, remote control, and electrodes in original packaging between stimulation sessions.

- Immediately discontinue use if the device is not working

properly. Do not modify or disassemble this unit.

- Replace protective film on adhesive part of electrodes for storage and keep in sealed bag to prevent from drying out

**Notice**

- Do not use this device if you are pregnant or have a cardiac pacemaker, implanted defibrillator, or other implanted metallic or electronic devices. Use with these conditions can result in electric shock, burns, electrical interference and/or death.

**Warnings**

- Do not allow children to handle, swallow or ingest accessories or parts.

- Do not use the device across or through your chest because the electrical currents introduced into the chest may cause rhythm disturbances.

- Do not use this device if you are susceptible to rhythm disturbances to the heart unless under the direction of your physician.

- Do not use this device over your eyes, mouth, face, front of neck, head, chest, carotid or across your heart because this could cause severe muscle spasms resulting in difficulty in breathing and other adverse effects.

- Consult with your physician before using this device if

you are in the care of a physician.

- Consult with your physician before using this device if you have had medical or physical treatment for your pain.
- Stop using this device and consult your physician if your pain does not improve, becomes more than mild, or continues for more than five days.
- Do not use this device while driving, operating machinery, or during any activity in which electrical stimulation can put you at risk of injury.
- Do not use this device over open wounds, rashes, swollen, red, infected, inflamed areas or skin eruptions (e.g., phlebitis, thrombophlebitis, varicose veins).
- Do not use this device over, or in proximity to, cancerous lesions.
- Do not use this device on children.
- Do not use the device in the presence of electronic monitoring equipment (e.g., cardiac monitors, ECG alarms) which may not operate properly when the electrical stimulation device is in use.
- Do not use the device when in the bath, shower or other sources of moisture.
- Do not use this device while sleeping.
- Do not use this device on abnormal skin that is not clean & healthy.

### **Precautions**

DO NOT START stimulation of the device prior to application of the electrode pads to your skin.

- Keep this device out of the reach of children.
- Do not use this device if you are pregnant, or suspect that you are pregnant unless under the direction of your physician.
- This device should not be applied on or across your head or face.
- If you have suspected or diagnosed heart disease, you should follow precautions recommended by your physician.

DO NOT use for:

- (1) Muscle reeducation
- (2) To prevent muscle atrophy or spasms
- (3) Improving range of motion
- (4) Blood flow deficiencies / venous thrombosis

### **Possible Reactions**

- 1) Isolated cases of skin irritation or burns may occur due to electrical stimulation or the adhesive gel material on electrodes pads.
- 2) Stop using the device and consult with your physician if you experience adverse reactions from use of this device.

### **What Does TENS Stimulation Feel Like?**

Users may experience different sensations with Omega Wireless Device. Most users will feel a slight tingling sensation and/or a feeling of being warmed and/or a massaged feeling on and around the pain area. Small contractions of muscles are common especially in EMS modes. The Omega Wireless works best at a level of intensity where pain relief is achieved but before muscles begin to contract.

You may notice that while this unit maintains a steady intensity, the pulsation pattern will vary to achieve the maximum effectiveness during stimulation.

### **Learn More!**

Please visit [www.TensUnits.com](http://www.TensUnits.com) for further information. For questions, please contact us by phone at: 1-866-237-4013 or email us at [cstu@TensUnits.com](mailto:cstu@TensUnits.com).

### **Technical Specifications**

Product Model: SM9110

Product name: Wireless TENS&EMS

Working mode: 24 modes

Working strength: 20levels

Maximum Output Current (mA): 128.48

FCC Caution:

### Part 15.21

Any Changes or modifications not expressly approved by the party responsible for compliance could void the user's authority to operate the equipment.

### Part 15.19

This device complies with part 15 of the FCC Rules. Operation is subject to the following two conditions: (1) This device may not cause harmful interference, and (2) this device must accept any interference received, including interference that may cause undesired operation.

FCC RF Radiation Exposure Statement:

1. This Transmitter must not be co-located or operating in conjunction with any other antenna or transmitter.
2. This equipment complies with RF radiation exposure limits set forth for an uncontrolled environment.
3. The device has been evaluated to meet general RF exposure requirement. The device can be used in portable exposure condition without restriction.

### Part 15.105

Note: This equipment has been tested and found to comply with the limits for a Class B digital device, pursuant to part 15 of the FCC Rules. These limits are designed to provide reasonable protection against harmful interference in a residential installation. This equipment generates, uses and can radiate radio frequency energy and, if not installed and used in accordance with the instructions, may cause harmful interference to radio communications. However, there is no guarantee that interference will not occur in a particular installation. If this equipment does cause harmful interference to radio or television reception, which can be determined by turning the equipment off and on, the user is encouraged to try to correct the interference by one or more of the following measures:

- Reorient or relocate the receiving antenna.
- Increase the separation between the equipment and receiver.
- Connect the equipment into an outlet on a circuit different from that to which the receiver is connected.
- Consult the dealer or an experienced radio/TV technician for help.