

PD700 User Guide

Brand

Model

Plug In Dimmer

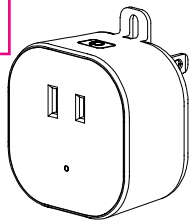

This product speaks with other Z-Wave certified devices

INTRODUCTION

PD700 is a Z-Wave Plus® certified device with S2 security and SmartStart features. You can now add this device securely and with ease using QR code on the product with compatible gateways supporting S2 and Smart Start. The PD700 is a member of the Z-Wave family and communicates with other Z-Wave certified devices in a control network. It can be used to turn any plug in lamps On, Off, or control dimming of any lamps with dimmable light bulbs. Each Z-Wave device also serves as a node to repeat the signal in the network, thus, extending the overall Z-Wave mesh wireless network range. Different types and brands of Z-Wave devices can be associated with the PD700 in your system and they will work together to optimize and expand the coverage of your Z-Wave network.

FEATURES

- Works with incandescent and most dimmable fluorescent (CFL), or LED lighting
- 700 Series Z-Wave module
- LED to indicate ON/OFF status
- Remotely or manually turns ON or OFF, or DIM lights
- Z-Wave Plus Certified with S2 security and SmartStart (QR code on bottom of device)
- Safety tab to secure unit to AC outlet
- Compact design - does not block the 2nd AC outlet
- Over-The-Air firmware upgrade available, if supported by controller
- Supports Network Wide Inclusion (through a repeater), if supported by controller.
- Functions as a Z-Wave signal repeater

! WARNING !

RISK OF FIRE, ELECTRICAL SHOCK & BURNS
DO NOT USE WITH MEDICAL AND LIFE SUPPORT INSTRUMENT
No user serviceable parts are in this module

To reduce the risk of electric shock, this product has a grounding type plug that has a third (grounding) pin. This plug will only fit into a grounding type power outlet. If the plug does not fit into the outlet, contact a qualified electrician to install the proper outlet. Do not change the plug in any way

CAUTION: To Reduce the Risk of Overheating And Possible Damage To Other Equipment, Do Not Install To Control A Motor-Operated Appliance, A Non-Dimmable Fluorescent Lighting Fixture, Or A Transformer-Supplied Appliance
The lighting devices connected to this Z-Wave module must not exceed 2.5A, 300W incandescent, 65W dimmable CFL/LED.

SETUP

Step 1 Plug in a lamp with 2-pin AC plugs to the receptacle of the PD700

Step 2 Insert the module's 3-pin plug into an AC outlet in the same room as your gateway. In normal operating mode, the LED on the front panel will be lit.

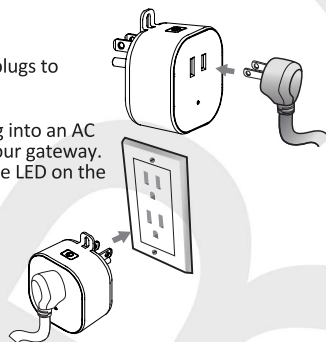

Step 3 Inclusion/Exclusion: Add or remove the device into your network by a Z-Wave certified controller. The PD700 supports the latest S2 security and SmartStart offered by Z-Wave certified controllers. If your controller supports S2 or SmartStart, please refer to the user guide of the controller for detailed instructions on adding or removing devices to/from the network. You should be able to add the PD700 into your network using the unique QR code or the DSK 5 digit pin located on the product or packaging. In addition, the device can be added or removed using the traditional method for Z-Wave as follows:

1. Place your network controller into inclusion mode by following the controller manufacturer's instructions.
2. When the controller is ready, single click the button on the top of the PD700. The controller should indicate that the new device was added successfully.
3. Once the PD700 has been successfully added to your home network, you can move it to the preferred location in the home.

If the controller shows it failed, repeat the procedure.

Manual Reset

If Inclusion still fails after the 2nd attempt, you need to first reset the PD700 before repeating the above step. The manual reset method is as follows:

1. Unplug the PD700 from the AC outlet and also unplug the power plug of the appliance from the PD700 (if plugged in).

2. Press and hold the button on the PD700.

3. Plug the PD700 back into the AC outlet with the button pressed

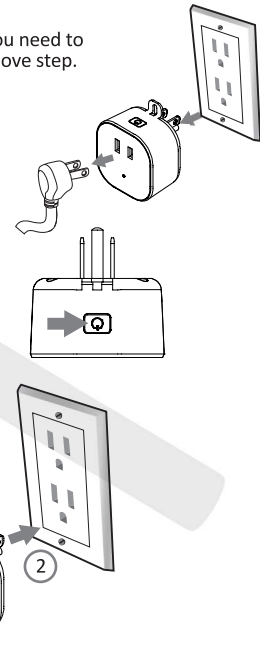

After 3 seconds, release the button. If you see the LED blink, that means that the PD700 has been reset successfully and you may retry Step 3 above to add the module into your network. Otherwise, please repeat the manual reset procedure.

Note: If the PD700 was previously Added (Included) in your network, resetting it locally does not mean it has been removed from your controller software. If you wish to remove the PD700 from your controller software you will need to Remove (Exclude) the module from the network by your controller. If the PD700 is removed from the network supporting S2 security, the only way to add the device back into the network is using the QR code or the DSK code. Therefore, please store the QR code on the product as well as copy of the full DSK printed on the package in a safe location.

Use the manual reset procedure only in the event that the network primary controller is lost or otherwise inoperable.

BASIC OPERATION

The connected lamp can be controlled manually with a push button or wirelessly via the software from your controller.

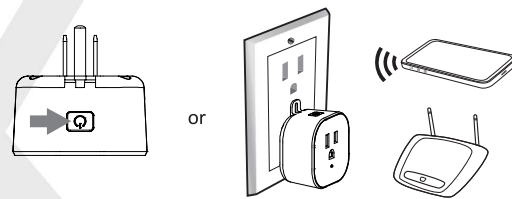

A Z-Wave certified controller is capable of setting up products in your desired network. Once the device is added, you may assign it to a Group.

In the event of a power failure, the device will return to the last dimming level after the power is restored.

About the push button:

There is a single button on the PD700 for manual operation that:

- A) Manually turns the connected lighting ON/OFF by pressing the button. It functions as a toggle switch; if the light is ON, pressing the button turns the light OFF and vice versa.
- B) Adjust the brightness level of the connected lighting by pressing and holding the button. Release the button when the desired level is reached. It functions as a toggle switch as well. The lighting keeps dimming until the minimum level is reached or the button is released. When you press the button again and hold, the brightness of the light will keep increasing until the maximum level is reached or when the button is released.
- C) Adds (Includes) or Deletes (Excludes) your PD700 to/from your Z-Wave network. Please refer to the instructions manual of your gateway or remote controller for detail procedures on how these actions can be done.

PD700

Size: 5cm x 10 cm, total: 20cm x 30cm (H)

PD700 User Guide

ADVANCED CONFIGURATION

Configurable Parameter Settings: If your controller supports Z-Wave configurable parameters, the following settings can be modified.

Parameters				
#	Description	Values	Default	Bytes
3	Nightlight	When value = 0, the LED indicator will be OFF when the connected appliance is ON, and the LED indicator will be ON when the connected appliance is OFF. If value = 1, the LED indicator will be OFF when the connected appliance is OFF, and the LED indicator will be ON when the connected appliance is ON. If value = 2, the LED indicator will be always OFF regardless of the load status.	0	1
9	Dimming Resolution Level	Valid Values: 1-99, indicates the number of dimming levels.	1	1
10	Dimming Resolution Speed	Valid Values: 1-255, indicates the time duration of each level.	3	1
X	Load Status (after power outage)	0 = Last status before power outage (default) 1 = Always on 2 = Always off	0	X

Depending on the capability of your controller or gateway software, the following simple to advanced operations can be performed. Please refer to the controller's or gateway manual for details.

Association:

1. The PD700 supports group one for lifeline communication.
2. You can only associate one Z-Wave device to group one.
3. Lifeline association only supports the "manual reset" event.
4. For instructions on how to "set lifeline associate", please refer to your controller/gateway instructions.

SPECIFICATIONS

Model	PD700
Input power	120 VAC, 60 Hz.
Max output loading	2.5A, 300W Incandescent, 65W Dimmable CFL/LED
Radio frequency	908.4/916 MHz.
Wireless range	Up to XXXft line of sight between the controller and the other available nodes.
Normal operating temperature	0 - 40°C

FOR INDOOR USE ONLY

Interoperability with Z-Wave devices

A Z-Wave network can integrate devices from various classes of products, and these devices can be made by different manufacturers. The product introduced in this instructions manual has a Z-Wave certification which allows such an interoperability.

Purpose of control: Operating Control
Construction of control: Portable Direct Plug In Type
Type 1 Action
Pollution Degree: 2
Impulse Voltage: 1500 V
Not Suitable for Appliances which only allowed to be plugged into wall outlet or a single outlet circuit, such as room heaters and window air conditioners.

FCC ID: XXXXXXXXXX

Supplier's Declaration of Conformity 47 CFR 2.1077 Compliance Information

Model: PD700

Responsible Party – US Contact Information

XXXXXXXXXXXX

XXXXXXXXXXXX

XXXXXXXXXXXX

United States

XXXXXXXX@XXXX.com

FCC Compliance Statement (Products subject to Part 15)

This device complies with part 15 of the FCC rules. Operation is subject to the following two conditions: (1) this device may not cause harmful interference, and (2) this device must accept any interference received, including interference that may cause undesired operation.

NOTE: The manufacturer is not responsible for any radio or TV interference caused by unauthorized modifications or changes to this equipment. Such modifications or changes could void the user's authority to operate the equipment.

NOTE: This equipment has been tested and found to comply with the limits for a Class B digital device, pursuant to part 15 of the FCC Rules. These limits are designed to provide reasonable protection against harmful interference in a residential installation. This equipment generates uses and can radiate radio frequency energy and, if not installed and used in accordance with the instructions, may cause harmful interference to radio communications. However, there is no guarantee that interference will not occur in a particular installation. If this equipment does cause harmful interference to radio or television reception, which can be determined by turning the equipment off and on, the user is encouraged to try to correct the interference by one or more of the following measures:

- Reorient or relocate the receiving antenna.
- Increase the separation between the equipment and receiver.
- Connect the equipment into an outlet on a circuit different from that to which the receiver is connected.
- Consult the dealer or an experienced radio/TV technician for help

IC: XXXXX-XXXX

This device complies with Part 15 of the FCC Rules and with RSS of Industry Canada. Operation is subject to the following two conditions:

- (1) This device may not cause harmful interference, and
- (2) this device must accept any interference received, including interference that may cause undesired operation.

Le présent appareil est conforme aux CNR d'Industrie Canada applicables aux appareils radio exempts de licence. L'exploitation est autorisée aux deux conditions suivantes :

- (1) l'appareil ne doit pas produire de brouillage, et
- (2) l'utilisateur de l'appareil doit accepter tout brouillage radioélectrique subi, même si le brouillage est susceptible d'en compromettre le fonctionnement.

This Class B digital apparatus complies with Canadian ICES-003.

Cet appareil numérique de la classe B est conforme à la norme NMB-003 du Canada.

Z-Wave is a registered trademark of Sigma Designs.

WARRANTY

XXXXXX warrants to the original purchaser of this product that for the warranty period, this product will be free from material defects in materials and workmanship.

The foregoing warranty is subject to the proper installation, operation and maintenance of the product in accordance with installation instructions and the operating manual supplied to customer.

Warranty claims must be made by customer in writing within 30 days of the manifestation of a problem. XXXXX sole obligation under the foregoing warranty is to repair, replace or correct any such defect that was present at the time of delivery or during the warranty period. The warranty does not extend to consequential or incidental damage to other products that may be used with this product. For inquiry and customer service, email XXXXXXX@XXXX.com. All brand names shown are trademarks of their respective owners.

Warranty period: limited 1 year from date of purchase.